

VAP amore®
THE LOVE OF STEAM



Patent Number D652185

MR100
PRIMO

**STEAM CLEANER
INSTRUCTION BOOK AND USER GUIDE**

SAFETY INFORMATION



FAILURE TO FOLLOW SAFETY INFORMATION AND WARNINGS MAY CAUSE PERMANENT DAMAGE AND VOID PRODUCT WARRANTY.

1. Do not leave the steam cleaner unattended when plugged in. Unplug from socket when not in use.
2. To prevent electric shock use only with a grounded outlet.
3. Not to be used as a toy. Close supervision is necessary when used near children.
4. Use only as described in this manual.
5. Do not use with a damaged cord or plug. If the supply cord and/or plug is damaged, they must be replaced by Vapamore in order to prevent a fire hazard.
6. Do not pull or carry by the cord, use the cord as a handle, allow the cord to come into contact with hot or sharp surfaces or close a door on the cord.
7. Do not unplug by pulling on the cord.
8. Do not handle the plug or steam cleaner with wet hands.
9. Do not pull or drag steam cleaner using the steam gun and hose.
10. Only carry the steam cleaner by the handle.
11. Turn off all controls before unplugging.
12. Steam cleaner must be level and on the floor during use.
13. Do not use an extension cord.
14. Do not attempt to remove blockages with sharp objects as they may cause damage.
15. Store indoors, put away after use to prevent tripping accidents.
16. Using improper voltage may result in damage to the steam cleaner and possible injury to the user. The correct voltage is listed on the label.
17. Drain water tank prior to shipping, transporting.
18. A hazard may occur if the steam cleaner runs over the power supply cord.
19. Accessories become hot during use - allow them to cool down before handling.
20. Never immerse the steam cleaner in water or other liquids.
21. Keep the steam cleaner away from rain and moisture. The steam cleaner is not suitable for outdoor use.
22. Only use the steam cleaner in containers / pools that are not filled with water or other liquids.
23. Do not operate the steam cleaner without water in the tank. Always top off with water when needed.
24. Only use distilled water. Using hard water can cause calcium or mineral build up and void the warranty.
25. Never use additives such as perfumes, stain removers, or other chemicals in the water tank as they will void the warranty, cause permanent damage, and be dangerous.
26. Always remove the main plug from the socket and allow the steam cleaner to cool down completely before storage.
27. Do not overfill the tank. Do not exceed the maximum filling level. Please use the funnel included.
28. Make sure the water tank cap is fully secured before use.
29. Empty the water tank if stored (See cleaning and storage).
30. Do not touch any hot areas on the steam cleaner. It is normal for the steam cleaner to heat up during operation.
31. Do not use the steam cleaner to treat any items of clothing that are still being worn on the body.
32. The force and heat of the steam may have an adverse effect on some materials. Always check whether a surface is suitable for treatment with the steam cleaner by carrying out a test beforehand on a concealed area.
33. Always include these operating instructions if passing the steam cleaner on to a third party.
34. Never aim the steam cleaner at people, animals or plants (risk of scalding)! Do not aim the steam cleaner at electrical systems.
35. Do not leave the steam cleaner on and unattended. Always switch the steam cleaner off and remove plug from wall outlet when unattended.
36. The steam cleaner is fitted with a thermostat and a thermal cut-out as protection against overheating.
- 37.*To provide continued protection against risk of electrical shock, connect to properly grounded outlets only.
38. *Not for space heating purposes.
39. Do not over extend retractable cord past stopping point.

PARTS OVERVIEW

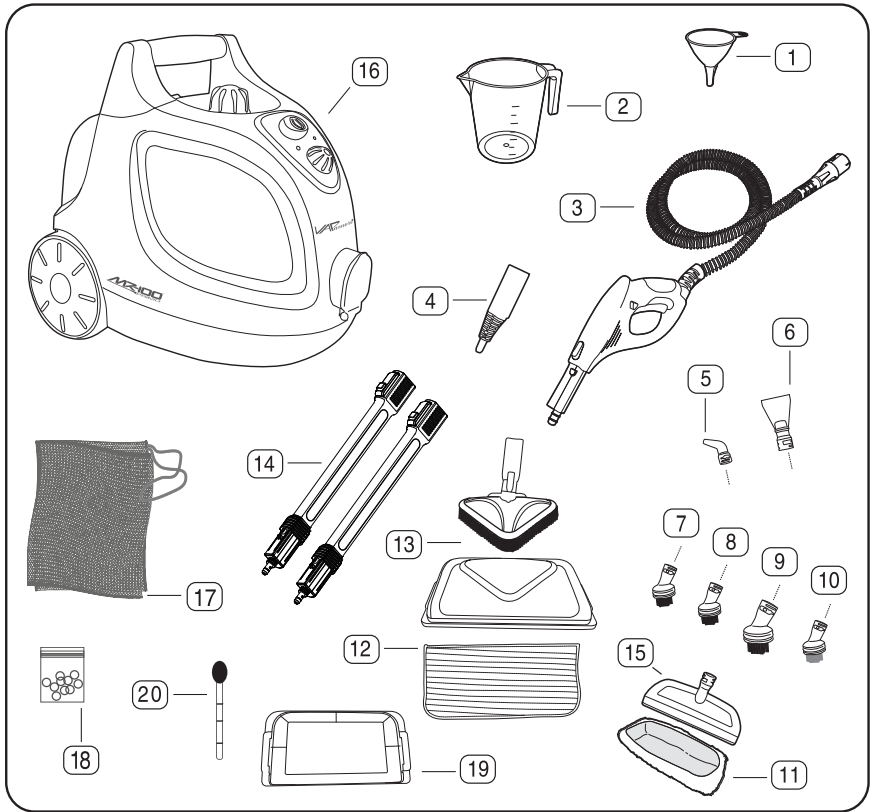

PARTS LIST

- 1 Funnel
- 2 Measuring cup
- 3 Steam gun with hose and connector
- 4 Detail adapter
- 5 Jet nozzle attachment
- 6 Detail scraper
- 7 Nylon grout brush
- 8 Nylon medium duty brush
- 9 Large nylon medium duty brush
- 10 Brass brush
- 11 Cotton cover
- 12 Micro fiber floor pad
- 13 Floor head with triangle brush
- 14 2 Extension tubes
- 15 Clothes / fabric - smooth surface tool
- 16 Steam cleaner
- 17 Accessory storage bag
- 18 Replacement o-ring set
- 19 Floor head carpet slider
- 20 Water level dipstick

TECHNICAL SPECIFICATIONS

Model: MR-100 Primo
 Power supply: 120V 60Hz
 Heating element power: 1500W
 Steam pressure: 3.5 bar (max)
 Permissible pressure: 5 bar
 Volume of water tank: 1.6 litres (max)
 Steam availability: 50 minutes
 Heating time: Approx. 11 minutes
 Steam flow rate: 40g /min (max)
 Sound level: 30 dB(A) during use
 Weight: Appliance without accessories 10.5lbs
 Subject to technical change without notice.

STEAM CLEANER ASSEMBLY

⚠ IMPORTANT: Never unscrew the tank cap during use. The tank is under pressure.

Fig. 1

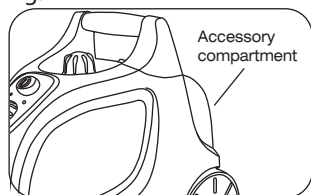

ACCESSORIES

The MR-100 Primo accessory compartment houses the detail adapter, Jet nozzle attachment, dipstick, clothes / fabric tool, micro fiber pad, cotton pad and all brushes. Open the accessory compartment by pulling the accessory cover back, away from the machine. Remove the desired accessory from the accessory compartment and close the accessory cover. (Fig. 1)

Fig. 2

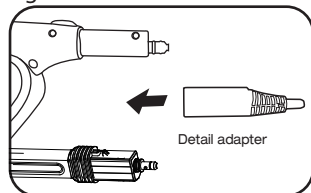

The detail adapter **MUST BE USED** with all accessories. the detail adapter can be used directly to the steam gun or to the extension tubes. Attach the detail adapter by pushing on to the steam gun or extension tube until the lock tab clicks in place. (Fig. 2)

Fig. 3

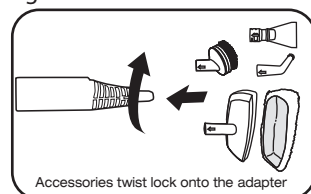

The accessories attach directly to the detail adapter by pushing the accessory straight on the detail adapter and then twist to lock in place. (Fig. 3)

⚠ IMPORTANT: Do not use excessive pressure on the accessory tools. Let the steam do the work with light scrubbing action used on the accessory tool.

STEAM GUN & HOSE

Fig. 4

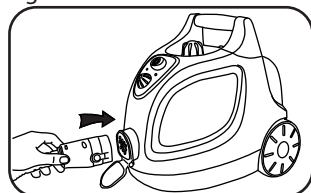

Connect the steam hose to the steam socket on the front of the steam cleaner. To do this flip down the dust cover door and push the connector on the steam hose firmly into the socket until both tabs click into place. To remove the steam hose, press in both release tabs located on the left and right side of the steam hose connector and pull out to release from the socket. (Fig. 4)

Fig. 5

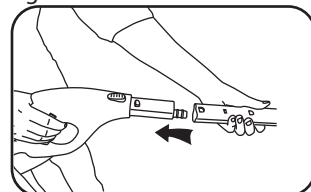

EXTENTION TUBES

Assemble the extension tubes if the steam cleaner is to be used to clean floors or difficult to reach areas. To do this, push the open end of a tube onto the steam gun. Push it onto the steam gun until the release button of the steam gun clicks into place. (Fig. 5)

Fig. 6

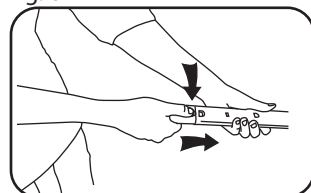

Press in the appropriate release button and pull the tubes apart with a downward movement to take the extension tube off again. (Fig. 6)

FILLING & OPERATION

To fill the water tank, switch the steam cleaner off and remove the plug from the wall outlet. Allow steam cleaner to cool down before removing water tank cap. Unscrew the water tank cap (Fig. 7) by pressing the cap down and simultaneously turning counter clockwise. Check the water level with the supplied dipstick. Use the supplied funnel and measuring cup to fill to the desired level. Never fill more than 1400ml / 1.4 liters. From a completely empty tank fill the measuring cup to the 700ml line two (2) times to equal 1400ml / 1.4 liters. (Fig. 8)

Fig. 7

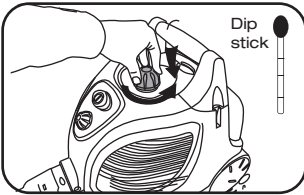

Fig. 8

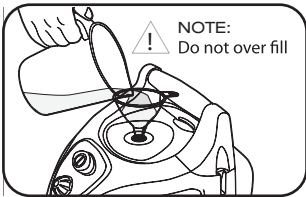

Fig. 9

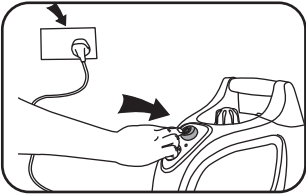

Fig. 10

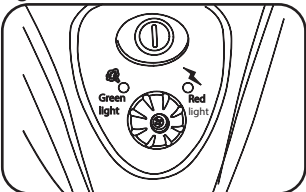
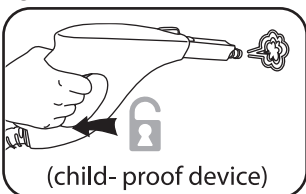

Fig. 11



⚠ IMPORTANT: Always use the dipstick to check the water level! DO NOT overfill past the FULL mark, 1400ml / 1.4 liters. If so turn the machine over and remove water to adjust water level. The dipstick has 3 marks, F is full 1400ml, approx. 1 hour steam time - H is half full 700ml, approx. 30 min steam time - L is low 200ml, approx. 10 min steam time.

⚠ IMPORTANT: Make sure steamer is completely cooled before removing the cap to fill with water. Opening the cap while the steamer is hot can cause scalding and severe burns.

⚠ IMPORTANT: Only fill with distilled water without additives of any kind, such as perfumes or cleaning agents. Using hard water will void the warranty and cause failure.

Replace the water tank cap by pressing down on the cap and simultaneously turning it clockwise. Make sure the cap is fully tight to prevent any steam from leaking out. If steam leaks from the cap area turn the Vapamore off and once cooled down tighten cap further.

Plug the steamer into a proper wall outlet and switch to the on position by pressing the on / off switch. (Fig. 9)

The red light will illuminate when the power button is depressed indicating the unit is heating. The green light will illuminate indicating the unit is fully heated and ready for use (approximately 11 minutes). The green light will cycle on and off with the heater to maintain full temperature during use. (Fig. 10)

⚠ IMPORTANT: Once the green light illuminates the steamer is ready for use. The green and red light will cycle on and off as the heater turns on and off.

continue to use the steamer as you normally would as the lights cycle on and off.

⚠ IMPORTANT: Release the locking device (child - proof device) by sliding the lock down away from the trigger. (Fig. 11)

OPERATION

⚠ NOTE: Always test the steam cleaner first on inconspicuous or invisible areas of the surfaces or fabrics to be cleaned to check their tolerance to hot steam. Steam may result in bleaching of painted / varnished wood. Steam may discolor shiny plastics. Acrylic, velvet and linen react very sensitively to the hot steam.

⚠ NOTE: Vapamore cannot be held responsible for damage to objects, materials, people, animals or plants that occurs due to unsuitable use of hot steam or due to improper use of the appliance.

⚠ NOTE: The Vapamore is fitted with an overheating cut-out. The steam cleaner switches off automatically at a temperature of 250° f to prevent overheating.

Fig.12

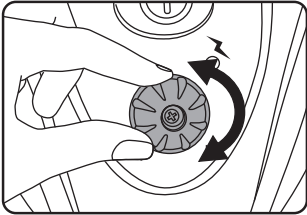

The flow rate of the steam emitted can be regulated by turning the steam controller and can be adjusted to the level required. Turn the steam controller clockwise for more steam and counter clockwise for less steam. (Fig.12)

Do not tip or tilt the steam cleaner during use and ensure that the steamer is always on the floor or flat surface when in operation. A full tank is enough for a maximum of 50 minutes use. Do not leave the machine unsupervised while switched on and if necessary use the child- proof lock to secure the steam switch. To do this, slide the lock up towards the trigger and to release slide the lock down away from the trigger.

⚠ IMPORTANT: The housing and accessories become hot during operation. Use caution when changing the accessories as they may be hot. Never open the tank cap while the steamer is plugged in. The tank is hot and under pressure.

REFILLING WATER

The tank must be refilled when the steam starts to decrease or stop even when the green light is on. This is the signal that the tank is empty and needs to be filled. Turn off the steamer by pressing the on / off switch. The red operation light will turn off. Unplug the steamer and allow the steamer to completely cool down. See "Filling & Operation" on the previous page for complete filling instructions.

⚠ WARNING: Hot steam may escape when opening the cap if the machine is not fully cooled off and / or all the remaining pressure is not released.

OPERATION

Fig.13

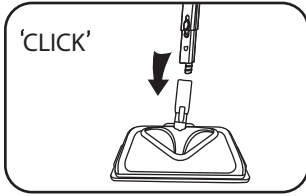

ACCESSORIES / FLOOR CLEANING HEAD

Attach the floor cleaning head to the end of the extension tube (use 1 to 2 tubes as desired). Ensure that the floor cleaning head clicks into place. (Fig.13)

Fig.14

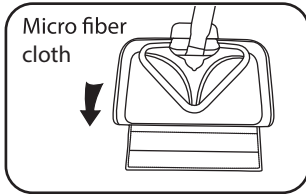

The floor cleaning head is ideal for hard surface floors like tile, stone, wood, vinyl and cement along with any hard surface floors or walls. For hard surface cleaning use the floor head with the micro fiber cloth only. Place the floor head on the Velcro / white side of the micro fiber cloth and attach to the floor head. The micro fiber cloth can be hand or machine washed. ***Air dry only, do not use any fabric softeners.** (Fig. 14)

Fig.15

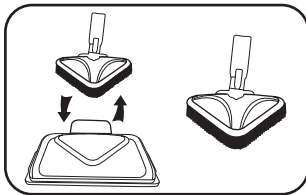

The floor cleaning head has a removable triangle brush attachment that can be used where scrubbing action is needed such as rough surface floors, small tile with grout lines, or any non even surface. To remove the triangle brush from the floor head, push down on the foot plate on the back of the floor head and remove the triangle brush. (Fig. 15)

Fig.16

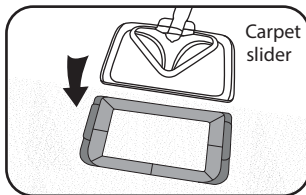

Using the floor head with the carpet slider attachment along with the micro fiber cloth can be used on carpet or rugs to sanitize, deodorize, kill allergens, bedbugs and dust mites. Place the floor head on the Velcro / white side of the micro fiber cloth and attach to the floor head. Snap on the carpet slider onto the bottom of the floor head. The carpet slider allows the floor head to easily slide on the surface of most carpets and rugs. ***The carpet slider is only to be used for carpets and rugs. Do not use the carpet slider for any other surfaces.** (FIG. 16 - 17)

Fig.17

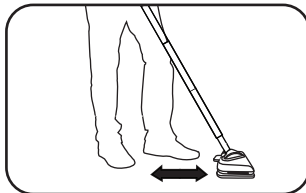

⚠ NOTE: The steam gun, extension tubes, and floor cleaning head can be stored (as shown on the cover page of this instruction manual) by inserting the tab on the floor cleaning head into the slot located on the side of the Vapamore.

OPERATION

Fig. 19

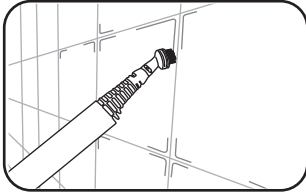

The detail adapter must be used with all brushes scraper tool and angle jet tip tool.

ACCESSORIES / BRUSHES

There are 4 brushes supplied with the MR-100 Primo. Suggested uses (brass brush), Oven grills, BBQ grates, cement stains, machinery, and metal surfaces. (Nylon medium duty and large nylon brush), used for more sensitive materials such as blinds, carpet, furniture, air vents, shoe scuffs, soap scum. (Nylon grout brush), this brush is used for harder less sensitive areas such as grout lines on tile floors, stone, cement, and machinery.

Fig.20

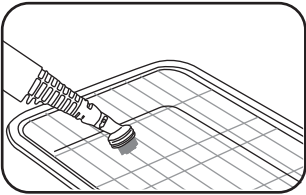

⚠ IMPORTANT : With all brushes it is important to not apply excessive pressure or force. This can cause failure of the adaptor or related parts. When using the brushes let the steam do the work and the brush to help agitate the stain or area being cleaned. (Fig. 19 /20)

Fig. 21

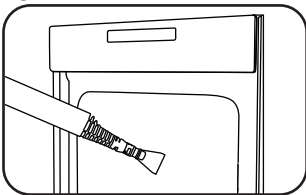

ACCESSORIES / SCRAPER

The scraper tool can be used to defrost freezers, on oven walls and cook top surfaces to remove stuck on food. This tool is also good for removing wall paper, paint and shelf paper. (Fig. 21)

ACCESSORIES / CLOTHES - FABRIC TOOL

Start by installing the supplied cotton cover on the clothes - fabric / smooth surface tool. Now this tool can be used for steaming and sanitizing along with eliminating odors in garments, fabrics, furniture, curtains, drapes, etc.

Fig. 22

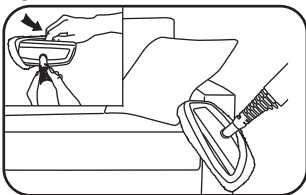

BEDBUGS AND ALLERGENS

Use this tool on bedding, pillows, and furniture by applying light pressure and slowly passing it along the surface to kill Bedbugs, dust mites and other allergens. (Fig. 22)

Fig. 23



ACCESSORIES / SMOOTH SURFACE TOOL

Using the clothes - fabric / smooth surface tool without the cotton cover acts as a squeegee and is great for sanitizing kitchen and bathroom counter tops chemical free along with smooth surfaces such as stone, granite, wood, glass, tile and stainless steel. (Fig. 23)

BEDBUG - DUST MITES - ALLERGENS

The Vapamore MR-100 Primo produces steam with an output temperature between 210° to 220° degrees. Pests such as bedbugs, dust mites and other allergens along with their eggs are killed on contact at a temperature of 180° degrees. Using steam is an extremely effective and chemical free way to kill these pest along with E. Coli, Salmonella, H1N1 and other bacteria or viruses without leaving any harmful chemical residue behind. The tools supplied with the Vapamore MR-100 Primo allow you to treat all areas where these pests can hide such as bedding, sofas, furniture, pillows, carpet, cracks and crevices that are ideal hiding places for pests.

Fig. 25

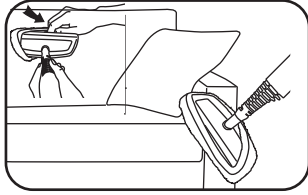

Fig.26

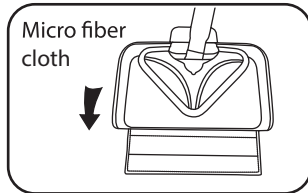

Fig.27

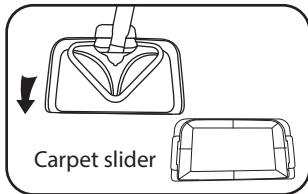

Fig.28

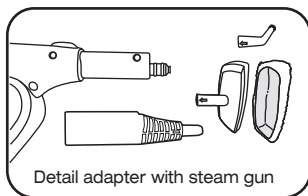
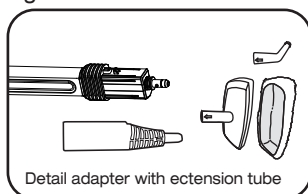

Fig.29



BEDDING / FURNITURE

The clothes / fabric tool with the cotton cover is ideal for treating bedding, furniture, pillows, and carpet areas around bed posts and base boards. Start by installing the supplied cotton cover on the clothes - fabric / smooth surface tool. Apply light consistent pressure and slowly pass it along the surface (1" per second) to insure the area being treated has a chance to come to full temperature killing pests and their eggs. (Fig. 25)

The floor head with micro fiber and carpet slider is also great for treating large surface areas such as bedding, furniture, and carpet areas. Start by installing the micro fiber cover and carpet slider to the floor head. The micro fiber cover thermal core maintains full temperature during use and allows the floor cleaning head to glide over fabric or carpet. (Fig. 26 - 27)

Apply light consistent pressure and slowly pass it along the surface (1" per second) to ensure the area being treated has a chance to come to full temperature killing pests and their eggs.

The steam gun with the detail adapter can be used as a straight jet nozzle tool or along with the 90 degree jet nozzle attachment. These tools are great for cracks and crevices. Make sure to concentrate the steam directly on the area to be treated with as minimal distance as possible, no more than 1" away. The steam will condense and cool off and not be effective to kill pests and their eggs if the jet tip is not directly on the surface being treated. The 90 degree jet nozzle can be attached directly to the steam gun or the extension tubes. (Fig. 28 - 29)

CLEANING /STORAGE

CLEANING / MAINTENANCE

Always ensure before cleaning or maintaining the Vapamore MR-100 Primo that it is switched off and unplugged from the wall outlet. Only clean the outer surface with a slightly, water moistened cloth. Do not use any cleaning agents, abrasives or alcohol since they may damage the housing finish.

Lubricate the threads on the water tank cap with light oil or lubricating spray such as WD-40[®] once every 3 months or when needed.

The included micro fiber cover and cotton cover can be machine washed using normal detergents and wash cycle. *Air dry dry only, do not use any fabric softeners as these will leave a residue on the pad and cause cleaning issues when using the pad.

STORAGE

⚠ IMPORTANT: Only fill with distilled water without additives of any kind, such as perfumes or cleaning agents. Using hard water will void the warranty and cause failure.

Fig.24

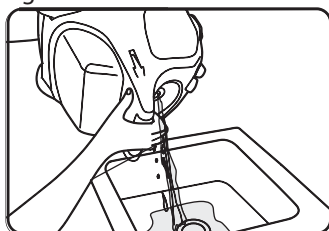

The tank should be emptied before storing for any extended period of time (30 days or more). To empty the tank, make sure the Vapamore is completely cooled down, remove the water tank cap and flip the Vapamore upside down to drain any remaining water from the tank. * The tank has baffles so not all the water will come out when turned upside down. Water can be stored in the tank under 30 days as long as its distilled water being used as instructed. Using / storing hard water will damage the machine and void the warranty. (Fig. 24)

Fig.25

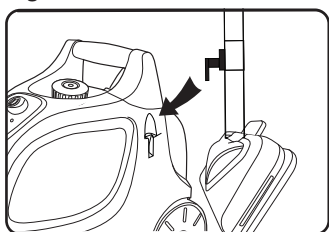

ACCESSORIES

The steam gun, extension tubes and floor head can be stored on the storage slot located on the side of the steamer. Insert the tab located on the extension tube into the storage slot. See the photo on the instruction book cover for an example. (Fig. 25)

Parts, extension tubes and accessories can also be stored in the supplied mesh storage bag.

TIPS

APPLICATION	STEAM VOLUME	ATTACHMENT	TECHNIQUE
FLOORS / CHEMICAL FREE CLEANING WITH NO RESIDUE LEFT BEHIND			
Vinyl Tile Or Vinyl Sheet	Medium - High	Floor Cleaning Head + Micro fiber + Extension Tubes + Nylon Brush.	Sweep or vacuum first. Steam mop with floor cleaning head and micro fiber cover. Corners and baseboards with nylon brush.
Stone Tile, Slate, Ceramic Tile, Grout	High	Floor Cleaning Head + Micro Fiber + Extension Tubes + Nylon Brush + Grout Brush + Nylon Brush Jet Nozzle	Sweep or vacuum first. Steam mop with floor cleaning head, heavy stains use without micro fiber cover. Corners and baseboards with nylon brush. Grout lines use grout brush and / or jet nozzle. Finish with floor cleaning head / micro fiber cover.
Smooth Surface Concrete	High	Floor Cleaning Head + Micro Fiber + Extension Tubes + Grout Brush + Nylon Brush + Metal Brush + Jet Nozzle	Sweep or vacuum first. Steam mop with floor cleaning head, heavy stains use without micro fiber cover. Corners and baseboards with nylon brush. Joint lines use grout or metal brush and / or jet nozzle. Finish with floor cleaning head / micro fiber.
Hardwood	Low - Medium	Floor Cleaning Head + Micro Fiber + Extension Tubes	Sweep or vacuum first. Steam mop with floor cleaning head and micro fiber cover.
CARPETS / SPOT TREATMENT			
Wall To Wall, Rugs, Spot Care	High	Nylon Brush + Jet Nozzle + Paper Or White Cotton Towel	Vacuum area first then steam using brush or jet. Use towels to blot stain away. Chemical cleaner can be used prior to steam treatment.
CARPETS / DEOTERIZE + KILL BEDBUGS - DUST MITES AND ALLERGENS			
Wall To Wall, Rugs	High	Floor Cleaning Head + Extension tubes + Micro Fiber + Jet Nozzle	Vacuum area first then steam using floor cleaning head with micro fiber cover. Pass slowly over area to allow heat to kill pests. Use jet nozzle for corners and cracks.
WALLS, CEILINGS			
Painted, Wood Paneling, Wallpaper	Low - Medium	Floor Cleaning Head + Extension tubes + Micro Fiber + Nylon Brush + Clothes / Fabric tool with cotton cover.	Painted, wood paneling, wallpaper walls are heat sensitive. Always test small area first and be careful not to over heat finish. Use Floor Cleaning head with micro fiber cover or clothes steamer with cotton cover. Use nylon brush for comers and stains.
Wallpaper Removal	High	Nylon Brush, Jet Nozzle, Extension Tubes + Smooth Surface Tool + Scraper	Use at full power to soften glue and remove wallpaper. Wallpaper stripper can be applied first.
Air Vents	Medium -High	Nylon Brush, Jet Nozzle, Extension Tubes, Cotton Towel	Clean using brush and jet tip. Wipe down with clean cotton towel.
UPHOLSTERY / SPOT TREATMENT			
Vinyl, Synthetic, Cotton	Medium - High	Nylon Brush, Jet Nozzle, Clothes Steamer, Cotton Cover, Cotton Towel	Test a small area first. Some synthetic materials will not handle high heat. Use nylon brush with soft pressure for larger stains and jet tip for small stains. Blot with cotton towel. Use clothes steamer with cotton cloth to go over all surfaces to deoterize.
Leather	Low	Clothes Steamer, Cotton Cover, Cotton Towel	Test a small area first. Steam over stained area and then blot with cotton towel. Use clothes steamer with cotton cloth to go over all surfaces to deoterize.
UPHOLSTERY / KILL BEDBUGS - DUST MITES AND ALLERGENS			
Vinyl, Synthetic, Cotton	Medium - High	Jet Nozzle, Clothes Steamer, Cotton Cover	Test a small area first. Some synthetic materials will not handle high heat. Use clothes steamer with cotton cover and slowly pass over area to allow heat to kill pests. Use jet nozzle for cracks and corners.

TIPS

APPLICATION	STEAM VOLUME	ATTACHMENT	TECHNIQUE
WINDOW BLINDS			
Levolor, Venetian, Horizontal, Vertical	Low-Medium	Nylon Brush, Jet Nozzle, Detail Nozzle, Extension Tubes, Cotton Towel	Dust area first. Thin plastic blinds may not be able to handle heat from the steam. Test a small area first. Use jet or detail nozzle from 4" away. Wipe off with cotton towel.
GLASS			
Windows, Mirrors	Medium	Smooth Surface Squeegee, Extension Tubes, Nylon Brush, Paper Towels	Pre-steam glass from 6" away to heat glass. Use brush for edges and bases. Finish with window cleaner squeegee. Do not use if temperature is under 32 degrees to prevent cracking.
Window Screens, Window Frames	Medium -High	Detail Nozzle, Nylon Brush, Extension Tubes	Steam area with detail nozzle. Use brush for edges and corners.
KITCHENS			
Stove Tops, Ovens	Medium - High	Nylon Brush, Brass Brush, Extension Tubes, Paper towels	Use nylon brush over all surfaces and brass brush for interior oven grates. Wipe down with paper towels
Small Appliances	Medium	Nylon Brush, Detail Nozzle, Paper towels	Use brush over all areas and detail nozzle for small corners and seems. Wipe down with paper towels.
Sinks, Faucets, Drains	Medium - High	Nylon Brush, Detail Nozzle, Paper towels	Use brush over all areas and detail nozzle for small corners and seems. Wipe down with paper towels.
Counter Tops	Low- Medium	Smooth Surface Squeegee, Nylon Brush, Detail Nozzle, Paper towels	Use brush over all areas and detail nozzle for small corners and seems. Use smooth surface squeegee to sanitize counter tops by slowly passing over area then wipe area with paper towel for chemical free cleaning.
BATHROOM			
<small>(NOTE: HARD WATER AND CALCIUM STAINS CAN ONLY BE REMOVED WITH CHEMICALS.)</small>			
Tile, Grout	Medium - High	Floor Cleaning Head + Micro Fiber + Extension Tubes + Grout Brush + Jet Nozzle	Sweep or vacuum first. Steam mop with floor cleaning head, heavy stains use without cotton cover. Corners and baseboards with nylon brush. Grout lines use grout brush and / or jet nozzle .Finish with floor cleaning head with micro fiber.
Porcelain Toilets, Chrome Fixtures	Medium - High	Nylon Brush, Detail Nozzle, Paper towels	Use brush over all areas and detail nozzle for small corners, hinges, and seems. Wipe down with paper towels.
Shower, Tubs, Doors	Medium	Nylon Brush, Detail Nozzle, Extension Tubes, Paper towels	Use brush over all areas and detail nozzle for small corners and seems. Wipe down with paper towels.
AUTO, MOTORCYCLE, MARINE			
Interior Areas	Medium - High	Nylon Brush, Jet Nozzle, Clothes Steamer, Cotton Cover, Cotton Towel	Test a small area first. Some synthetic materials will not handle high heat. Use nylon brush with soft pressure for larger stains and jet tip for small stains. Blot with cotton towel.
Detailing, Exterior, Engine	Medium - High	Nylon Brush, Detail Nozzle, Jet Nozzle	Use brush over all areas and detail nozzle for small detail areas.

A vacuum pump is a necessary component on a diesel engine vehicle with vacuum operated components.