

TITAN™ Fuel Tanks

ASSEMBLY ILLUSTRATIONS

Fuel Caddy



Shown with power cord which is not included (to be wired by local electrician). 12 v. version includes battery bracket

TITAN™ Shop Equipment

100 Gallon Fuel Caddy, 110 volt AC (6000003)
100 Gallon Fuel caddy, 12 volt DC (6000004)

NOTE: For 6000003 110 volt AC Fuel Caddy, a local electrician will be required to provide and attach power cord due to local regulations.

Assemble the fuel caddy as per the diagrams shown below.

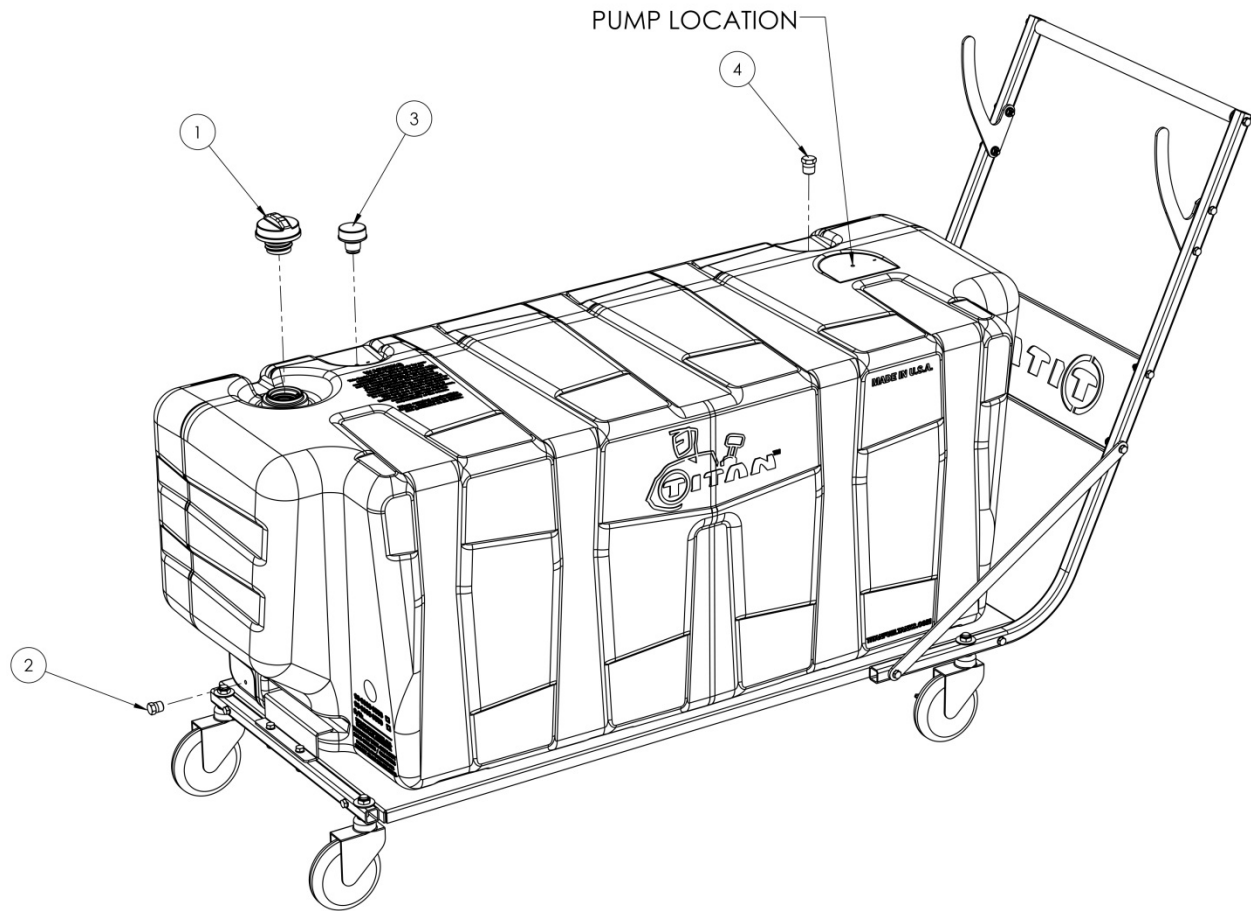

Tank Parts

ITEM NUMBER	PART	QUANTITY
1	Fuel Cap	1
2	3/8 NPT Plug	1
3	Vent Cap	1
4	1/2 NPT Plug	1

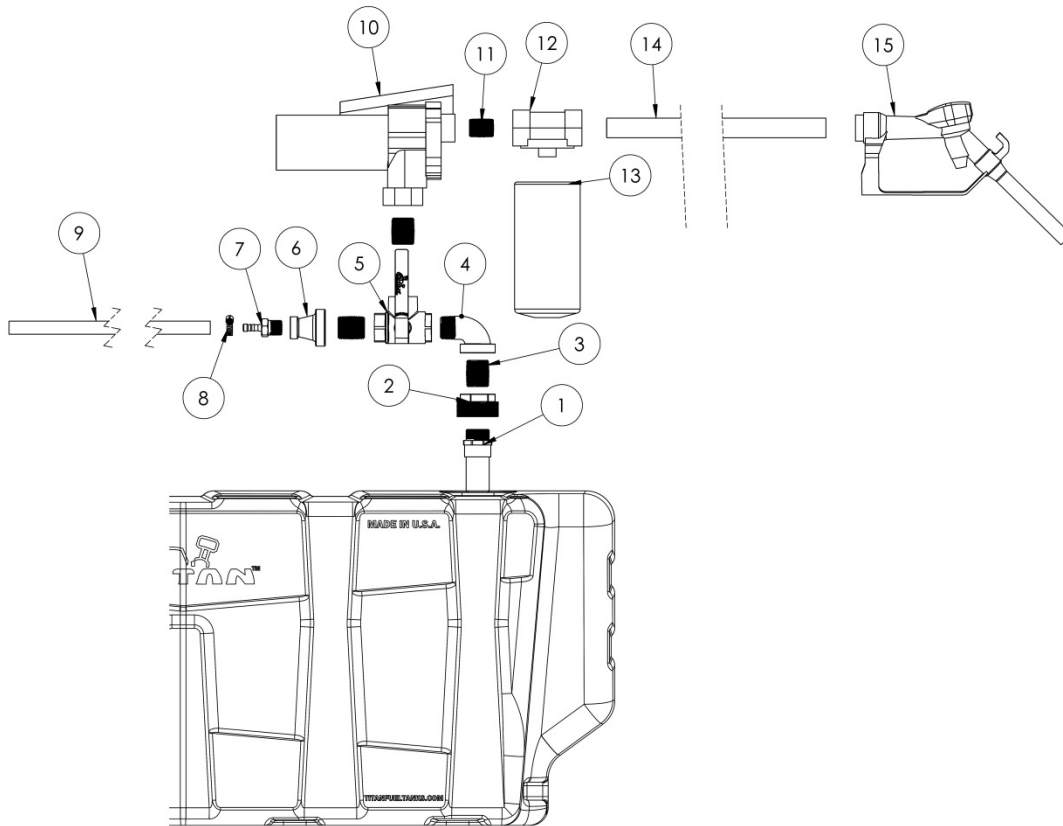

Plumbing Diagram

ITEM NUMBER	PART	QUANTITY
1	Pickup Tube	1
2	2" Threaded Tank Fitting	1
3	1" Pipe Nipple	3
4	1" Street Elbow	1
5	3-Way Ball Valve	1
6	Reducing Coupling	1
7	Pipe to Hose Adapter	1
8	Hose Clamp	1
9	3/8" Hose, 10 ft	1
10	Pump	1
11	3/4" Pipe Nipple	1
12	Filter Adapter	1
13	Water and Particulate Filter	1
14	3/4" Fuel Hose	1
15	Fuel Nozzle	1

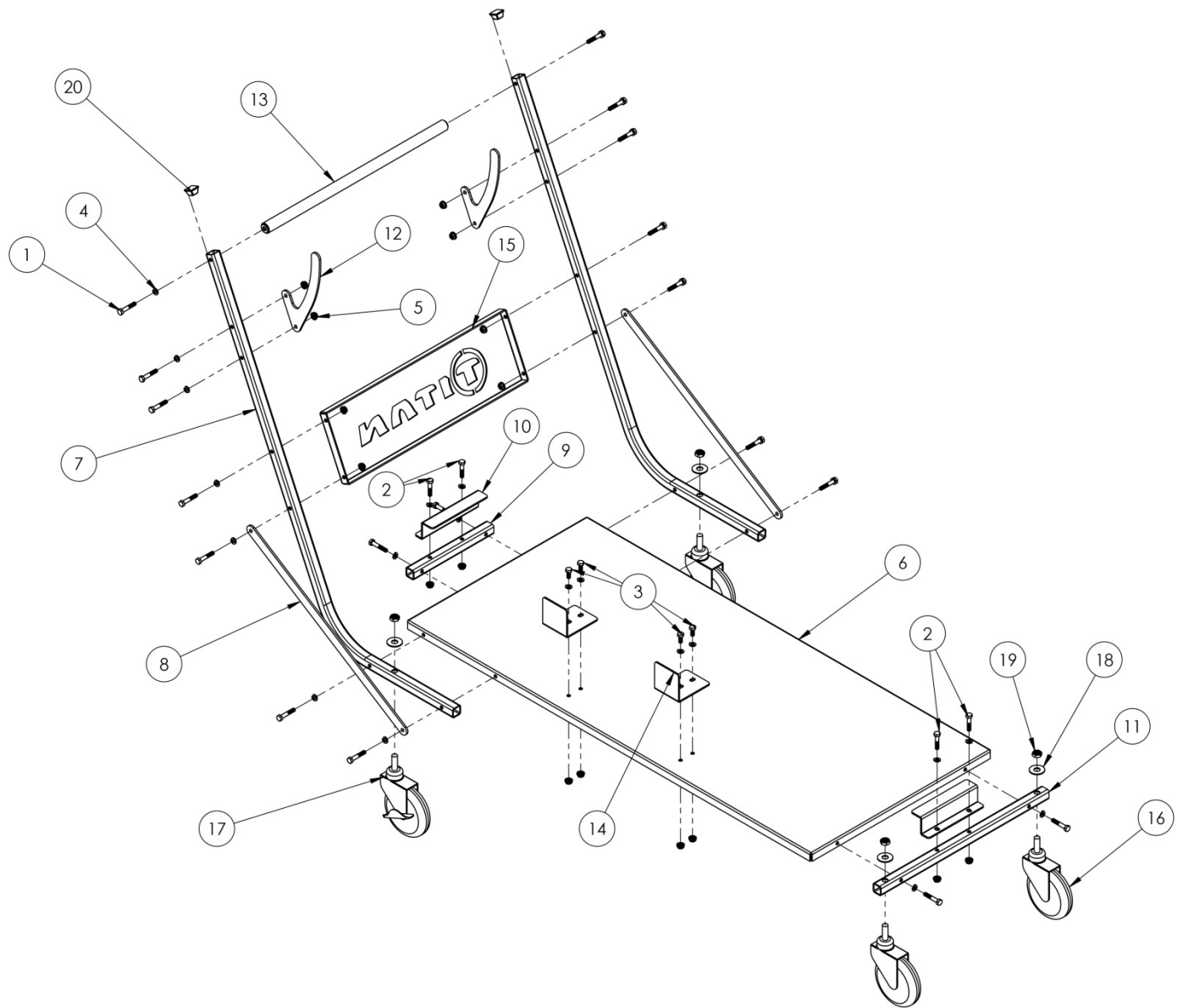

Trolley Assembly

ITEM NUMBER	PART	QUANTITY
1	5/16"-18 X 1-3/4" Length Cap Screw	18
2	5/16"-18 X 1-1/2" Length Cap Screw	4
3	5/16"-18 X 3/4" Length Cap Screw	4
4	5/16" Lock Washer	26
5	5/16" Flanged Locknut	24
6	Trolley Baseplate	1
7	Trolley Handle Support	2

8	Trolley Strut	2
9	Rear Mount Support	1
10	Tank Toe Clamp	2
11	Front Mount Support	1
12	Trolley Hanger Bracket	2
13	Trolley Handle	1
14	Tank Side Support	2
15	"TITAN" Rear Stiffener	1
16	Caster Wheel	2
17	Caster Wheel with Brake	2
18	1/2" Flat Washer	4
19	1/2"-13 Thin Nylon Locknut	4
20	Square Tube Insert	2

