



HT10 Panel Thing - Operation Guide

Use the following procedure to quickly mount hoods, doors, deck lids, lift gates and tailgates:

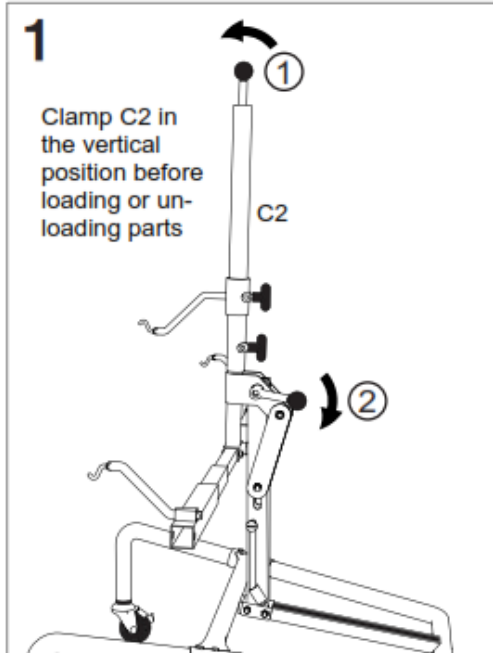

Figure 1

Step 1: Hold the C2 round tube in the vertical position.

Step 2: Tighten aluminum clamping knob to lock C2 in the vertical position.

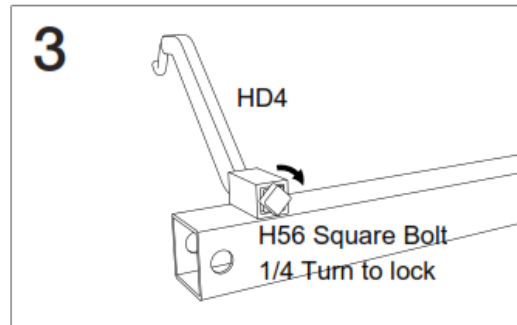

Figure 3 Rotate the H56 square bolt 1/4 turn to lock on the parts adapter arms (HD4 or HD5). This step is most necessary when the arms are pointing downward.

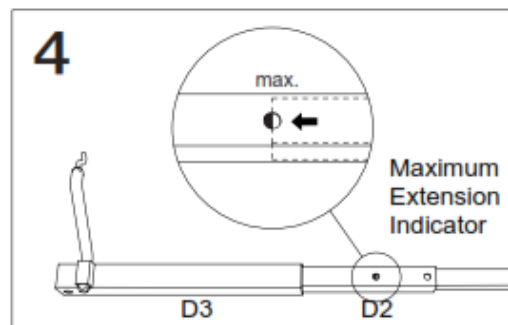

Figure 4 Note the indicator hole showing maximum extension of the D2 horizontal slider.

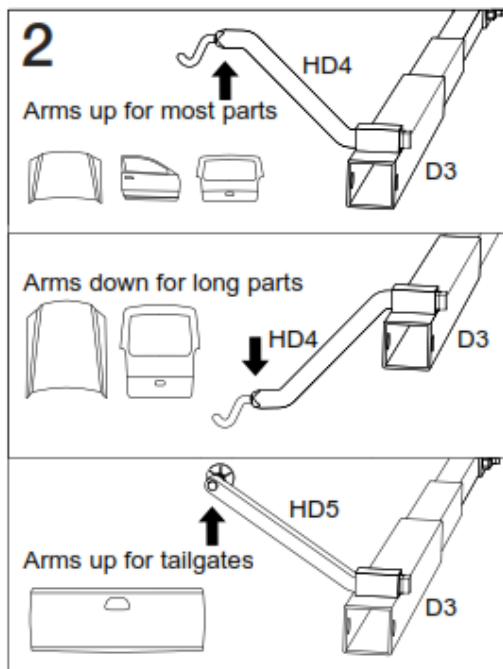

Figure 2 For small to medium hoods, doors, lift gates and deck lids, install the parts HD4 adapter arms pointing upward as shown. For long hoods and lift gates, install the HD4 parts adapter arms horizontal or pointing downward. For pickup truck tailgates, install the HD5 arms pointing upward. **Use the arm position that makes your part balance best for easy rotation**

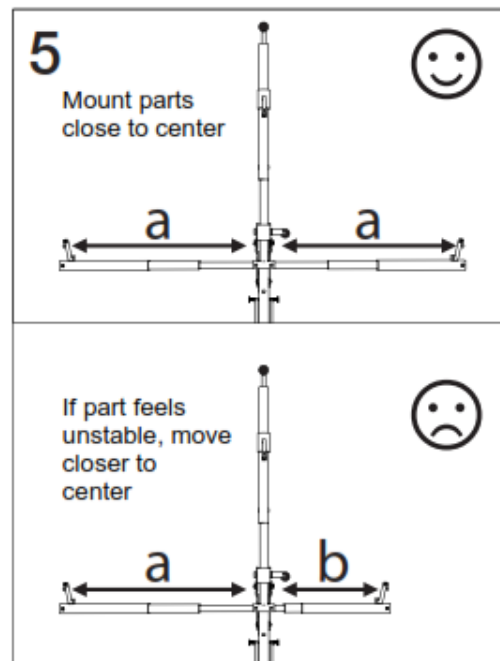

Figure 5 On your body panel, select two holes about equal distance from center and near the bottom edge. You can turn the D3 sliders around to place hooks near the middle of your part, but try to keep both lower hooks roughly the same distance from center.



HT10 Panel Thing - Operation Guide

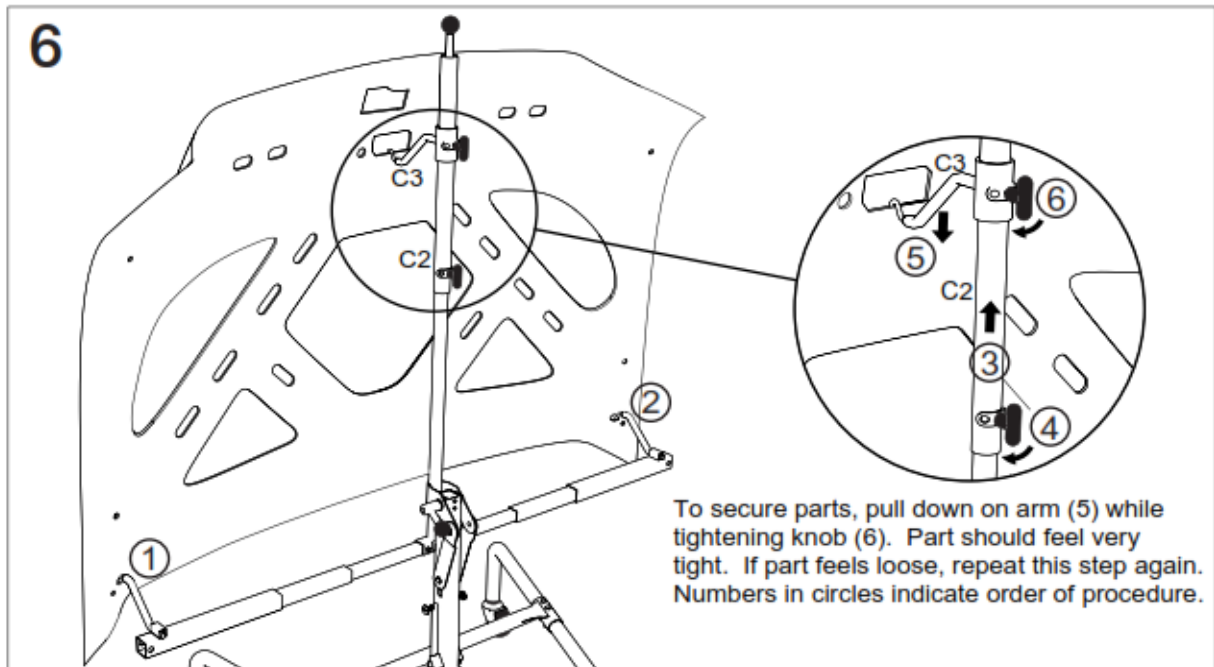

Figure 6 Attaching Body Panels

Steps 1 and 2: Make sure the C2 tube is locked in the vertical position (see Figure 1). Center the body panel roughly side to side and place it onto the lower hooks.

Step 3: While holding the body panel firmly, move the C2 round slider up or down until the upper ball handle is slightly above the panel.

Step 4: Tighten the lower T-knob on the C2 slider.

Step 5: Slide the hook on center arm C3 down into a hole near the center of the body panel. For attachment to doors, you can push the center hook down against the door's top inner edge. You may rotate the C3 center arm a few degrees side-to-side to reach off-center holes.

Step 6: While applying medium down pressure on the C3 center arm, tighten the upper T-knob. As you tighten the upper T-knob, you will see the C3 center arm moving downward. This downward movement will clamp your part very tightly. If the part feels loose when you shake the upper ball knob, loosen the upper T-handle three or four turns, pull the center hook arm down against the panel and retighten the T-handle.

Set rotating friction: Tighten the aluminum clamping knob only enough to hold the panel still when you are not rotating it.

To remove parts, rotate your body panel to vertical and tighten the main clamping knob (see Figure 1). While holding the body panel firmly, loosen the upper T-knob and rotate the C3 center arm out of the way. Along with a helper, lift your panel off the lower hooks.

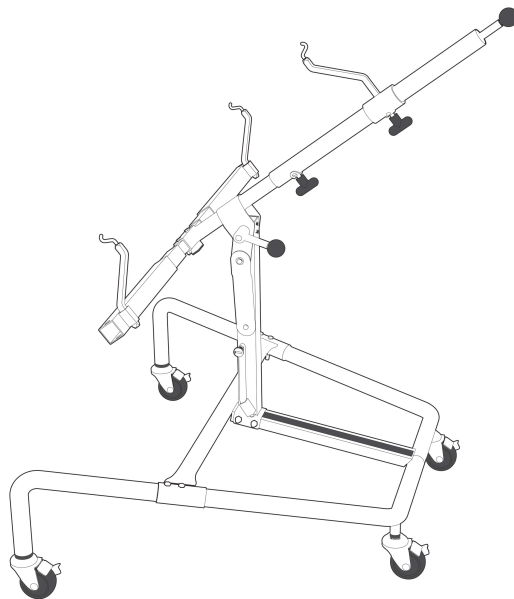

HT10 Panel Thing – Assembly Guide

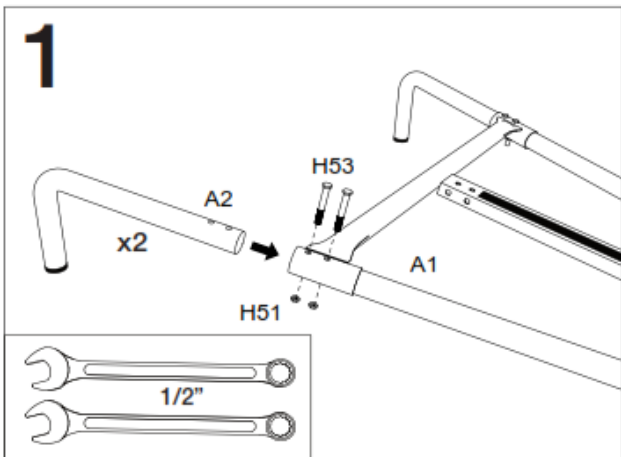

Figure 1: Tap legs (A2) into open ends of base (A1) with dead blow hammer. Attach legs using 5/16" X 2" bolts (H53) and nuts (H51). Tap legs on sides if necessary to make vertical before tightening nuts.

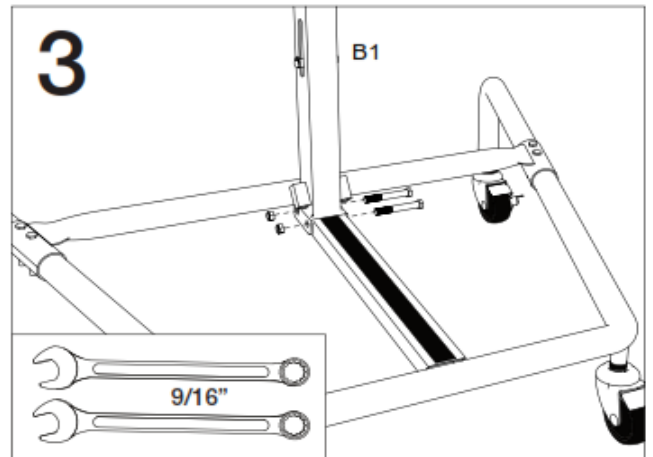

Figure 3 Install upright (B1) using 3/8" X 2-3/4" bolts with nylon insert nuts and tighten with 9/16" wrenches.

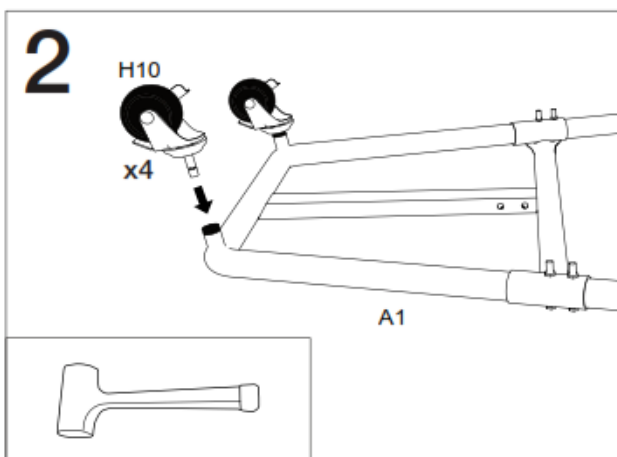

Figure 2: Turn base upside down on floor. Pound swivel casters into sockets using dead blow hammer. Make sure casters stems go in straight to avoid breaking caster sockets.

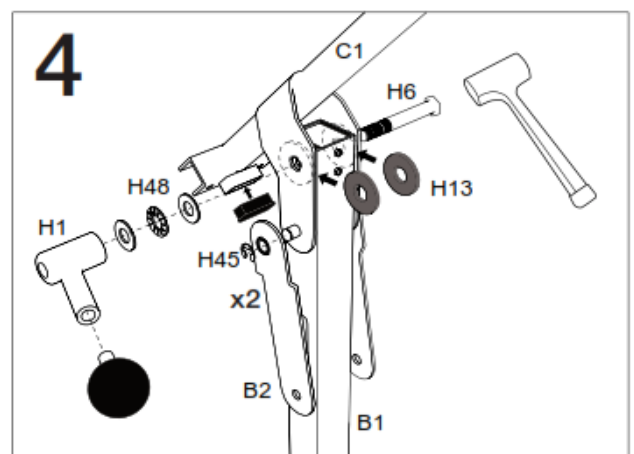

Figure 4 Install pivot assembly (C1) onto upright (B1). Install brown fiber washers (H13) on both sides of upright. Insert 1/2" diameter bolt (H6). Apply a small dab of grease to the thrust bearing (H48) and bolt threads (H6). Place the three-part thrust bearing (H48) onto the H6 bolt before installing the aluminum clamping knob (H1). Slide the flat connecting rods (B2) onto the pins as shown and secure with E-clips (H45).

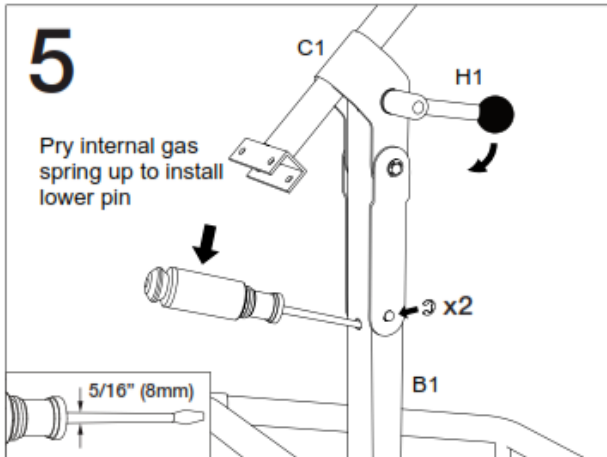

Figure 5 Rotate pivot assembly (C1) to 45 degrees from vertical. Tighten clamping knob (H1). Remove one E-clip from the lower pin (which is pre-installed in the upright). Insert a large blade screwdriver into the hole in the upright (B1). Push down on the screwdriver to pry up the gas spring inside. While holding the gas spring up, slide the pin out. Pry the gas spring up again and re-install the pin through the connecting rods (B2) and the gas spring end fitting. Install the E-clip (H45) back onto the lower round pin.

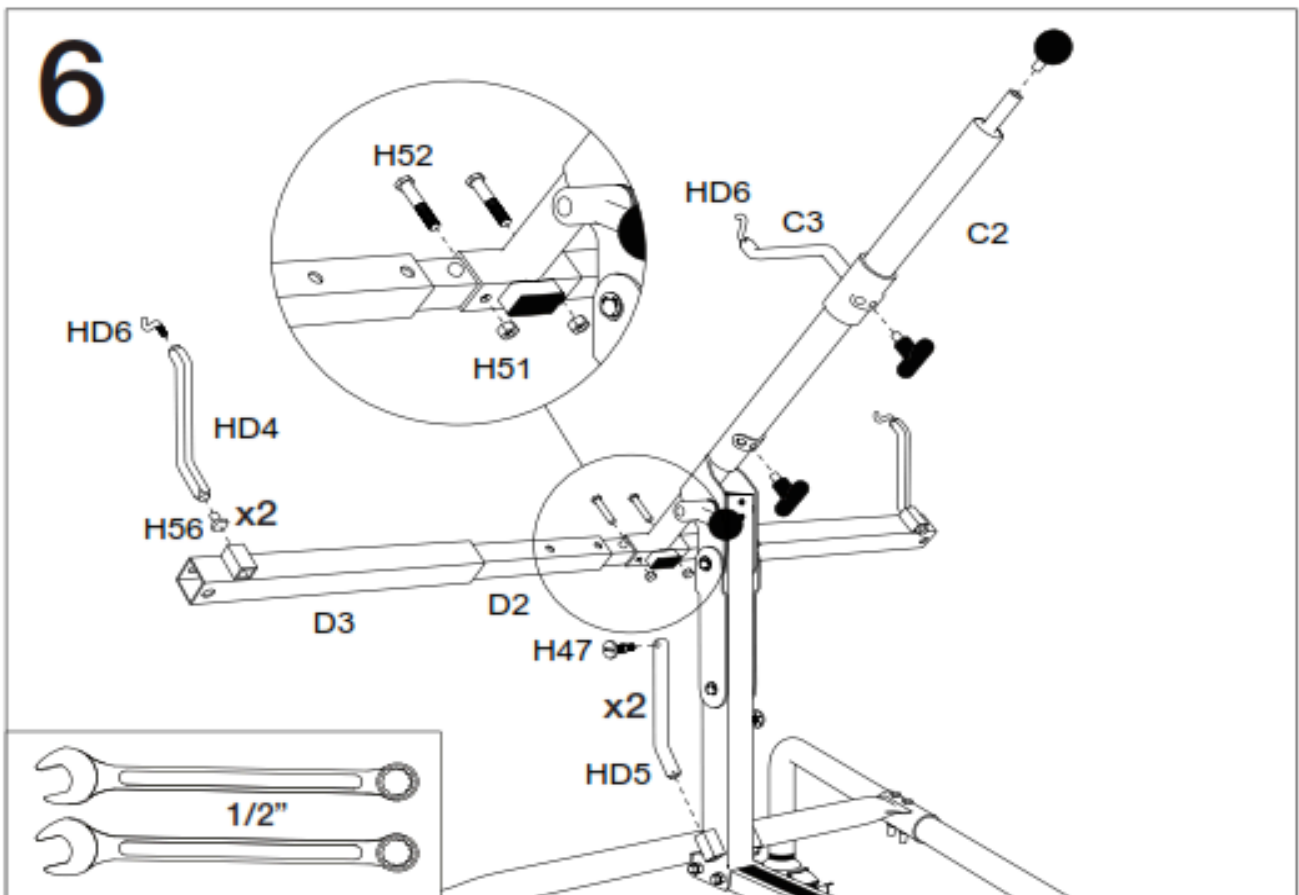

Figure 6 Attach T-bar (D1) onto pivot bracket (C1) using 5/16"X1-3/4" bolts (H52) and nylon insert nuts (H51). The D1 T-bar and C1 Pivot Bracket may be seen on the Parts Guide drawing. Note that the push buttons on the T-bar (D1) point upward. Tighten nuts (H51) with 1/2" wrenches. Install tailgate bolts (H47) with lock nuts onto tailgate adapter arms (HD5). Install square sliders (D2, D3) onto T-bar as shown. Install round sliders (C2, C3) onto round tube of pivot bracket (C1). Slide the parts adaptor arms (HD4) into the D3 sliders as shown pointing upward for holding most body panels. The parts adaptor arms (HD4) may be installed horizontal or downward to bring larger hoods into balance. Install T-knobs, ball knobs and tube plugs as shown. Always use tailgate arms (HD5) in the upward pointing direction.