



- 11050**  
1/4" DR. 10-50 IN. LBS. 60T TORQUE WRENCH
- 30250**  
3/8" DR. 50-250 IN. LBS. 48T TORQUE WRENCH
- 31080**  
3/8" DR. 10-80 FT. LBS. 48T TORQUE WRENCH
- 20250**  
1/2" DR. 30-250 FT. LBS. 48T TORQUE WRENCH
- 40600**  
3/4" DR. 110-600 FT. LBS. 48T TORQUE WRENCH



**SPECIFICATIONS**

1/4" Torque Range . . . . . 10-50 in. lbs.	Torque Accuracy . . . . . CW±3%, CCW±6%
3/8" Torque Range . . . . . 50-250 in. lbs.	Torque Accuracy (1/4" Dr.) . . . . . CW/CCW±6%
3/8" Torque Range . . . . . 10-80 ft. lbs.	Unit Selection . . . . . In. lbs./Ft. lbs., N-m
1/2" Torque Range . . . . . 30-250 ft. lbs.	Head Type . . . . . Fixed
3/4" Torque Range . . . . . 110-600 ft. lbs.	Gear Teeth . . . . . 48 (1/4" Dr. 60)

**!WARNING**

Some dust created by power sanding, sawing, grinding, drilling, and other construction activities contains chemicals known to cause cancer, birth defects or other reproductive harm. Some examples of these chemicals are:

- lead from lead-based paints,
- crystalline silica from bricks and cement and other masonry products, and
- arsenic and chromium from chemically-treated lumber.

Your risk from these exposures varies, depending on how often you do this type of work. To reduce your exposure to these chemicals: work in a well ventilated area, and work with approved safety equipment, such as those dust masks that are specially designed to filter out microscopic particles.

**!WARNING**

- READ THIS MANUAL BEFORE OPERATING TOOL
- ALWAYS WEAR SAFETY GOGGLES (INCLUDING BYSTANDERS)
- DO NOT USE A "CHEATER BAR"
- DO NOT SUBMERGE THIS UNIT IN ANY FLUID

# ⚠ WARNING

## FAILURE TO OBSERVE THESE WARNINGS COULD RESULT IN INJURY

THIS INSTRUCTION MANUAL CONTAINS IMPORTANT SAFETY INFORMATION.



READ THIS INSTRUCTION MANUAL CAREFULLY AND UNDERSTAND ALL INFORMATION BEFORE OPERATING THIS TOOL.

- Read and understand all instructions. Failure to follow all instructions listed below, may result in electric shock, fire, explosion and/or serious personal injury. It is the responsibility of the owner to make sure all personnel read this manual prior to using the device. It is also the responsibility of the device owner to keep this manual intact and in a convenient location for all to see and read. If the manual or product labels are lost or not legible, contact Sunex Tools® for replacements. If the operator is not fluent in English, the product and safety instructions shall be read and discussed with the operator in the operator's native language by the purchaser/owner or his designee, making sure that the operator comprehends its contents.
- To safeguard torque accuracy avoid keeping tool set at high loads for long periods of time. When finished reset back to zero.
- Do not operate without eye and hand protection (users and bystander).
- Keep body working stance balanced and firm. Do not overreach when operating the tool.



- Keep fingers and hands away from pinch point region of this tool at all times.
- Do not force tool beyond its rated capacity. Overtorquing can cause breakage.
- Use of a "cheater bar" or leverage multipliers will result in an inaccurate reading and can possibly damage the wrench. Use of unapproved accessories could push the unit beyond its rated capacity and will void your warranty.
- Do not use torque wrench to loosen fasteners.
- The wrench should be sent in for calibration once every year or every 5,000 cycles for re-calibration.
- The wrench should be cleaned and stored properly after every use. Do not submerge this unit in any fluid.
- Wrenches should be re-calibrated if dropped or accidentally mishandled.
- The torque wrench should be "exercised" a minimum of three times at 100% of full scale before use.
- Do not remove any labels. Replace damaged labels.
- This product may contain one or more chemicals known to the State of California to cause cancer and birth defects or other reproductive harm. *Wash hands thoroughly after handling.*
- Failure to heed these warnings may result in personal injury and/or property damage.

## PARTS REFERENCE

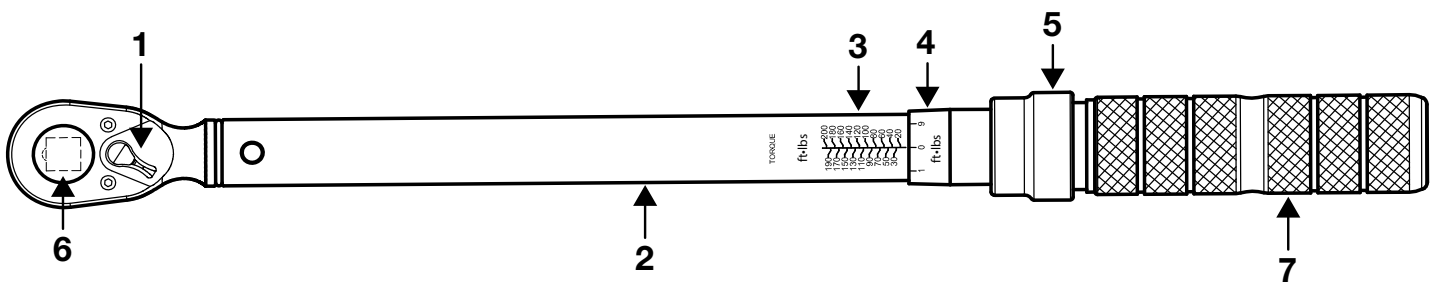

1. Reversible Ratchet Head
2. Wrench Body
3. Major Scale
4. Minor Scale
5. Adjusting Ring
6. Ratchet Drive
7. Anti-slip Handle

No internal parts are available to purchase due to the sensitivity of this professional model. Please utilize the repair facility listed under the warranty statement for all repairs in and out of warranty.

# OPERATIONS

# FEATURES

# NOTE

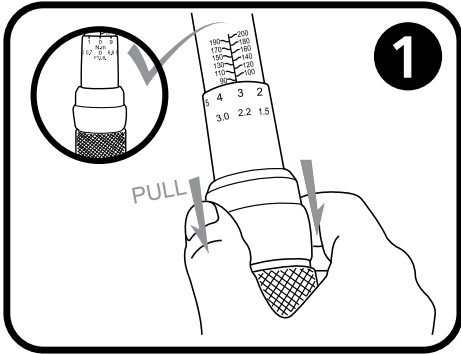

Pull down the adjusting ring

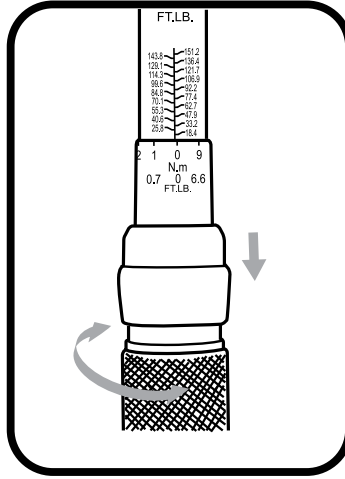

Adjusting Ring

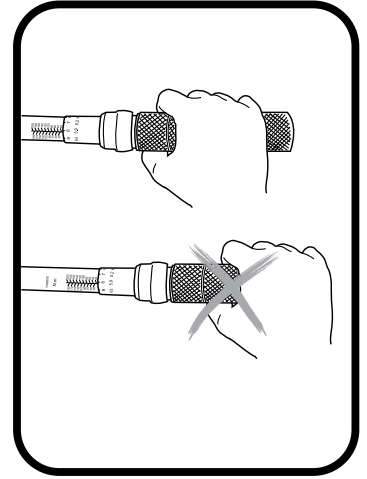

Grip the middle of the handle

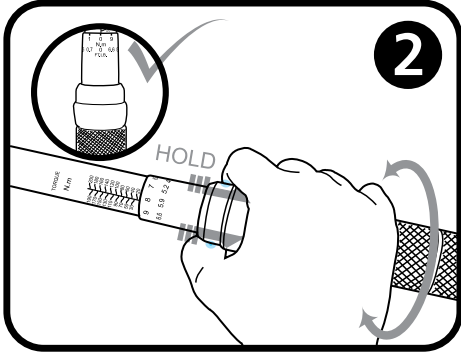

Make sure the ring table indicates the expected torque number, release the adjusting ring

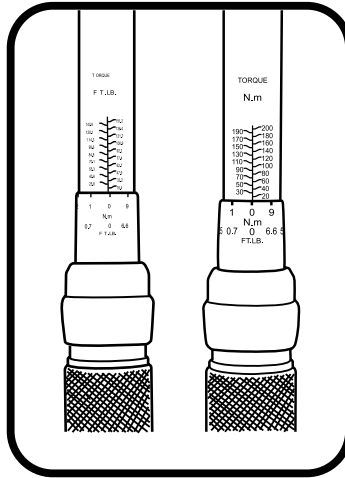

Two Units

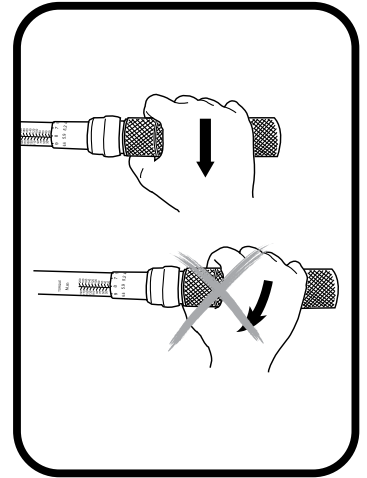

Operate vertically

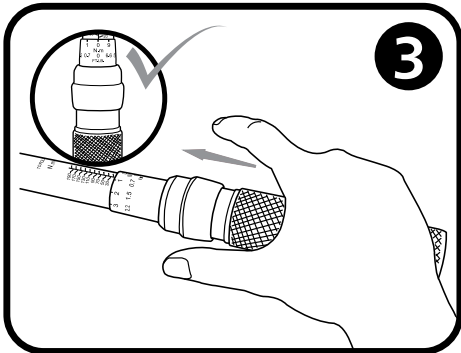

Keep the ring down and rotate the ring to the expected torque number according to the scale

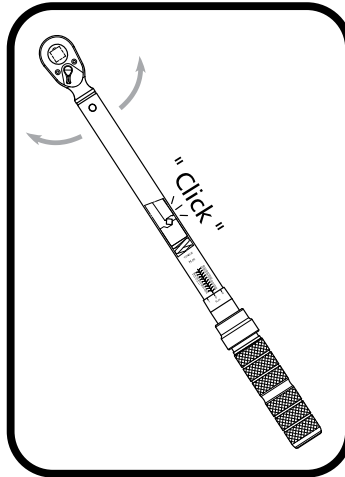

Dual-direction click-type

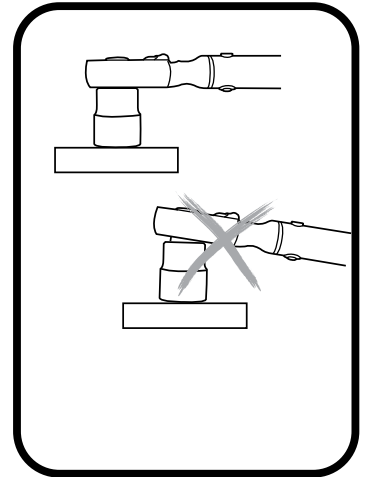

Insert the driver firmly on the socket before operating

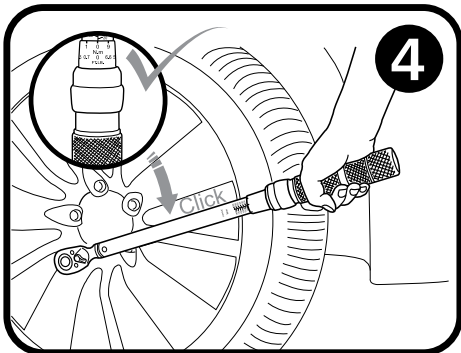

Then operate the Torque Wrench properly

**IMPORTANT:** ALWAYS reset the major scale torque measurement back to "ZERO" when you are finished using the wrench. This will ensure the internal body spring maintains accurate tension which prolongs the life and accuracy of the product.

## MAINTENANCE

1. The internal mechanism of the torque wrench has been calibrated and lubricated before final assembly. DO NOT attempt to open the wrench's internal mechanism for any reason. Doing so will void the warranty.
2. Do not submerge the torque wrench in water or any other liquids.
3. When not in use always store the torque wrench in its protective case. Be sure before storage that you have reset the torque setting back to zero.
4. Re-calibration is necessary to maintain accuracy once a year or every 5000 cycles. Using a torque wrench that is not regularly calibrated may cause damage to the tool and personal property.