



WARNING: To reduce the risk of injury, read the pressure washer instruction manual and the engine instruction manual before operating pressure washer.

QUICK SETUP GUIDE

(Letters A-C)

E10 E15 E85

NOTICE: Use of fuels with greater than 10% ethanol are not approved for use in this product per EPA regulations and will damage the unit and void the warranty.

A Install the Handle
Slide the handle assembly onto the frame and secure with saddle bolts and knobs.

B Add/Check Oil
The engine is shipped without oil. Before starting engine, add the oil provided. Check oil level prior to each use. Refer to Engine Owner's Manual for complete procedure.

C Add Gasoline
In a well ventilated outdoor area add fresh, high quality, unleaded gasoline with a pump octane rating of 86 or higher. Do not overfill. Wipe up spilled fuel before starting the engine. Refer to Engine Owner's Manual for complete procedure.

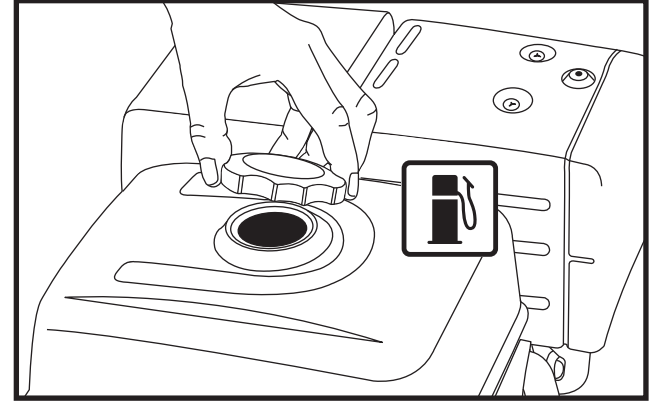
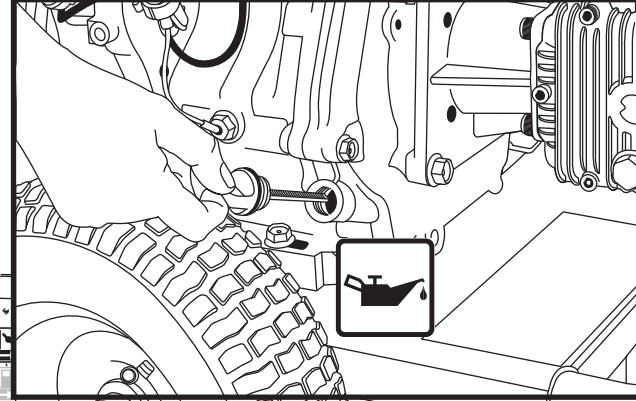
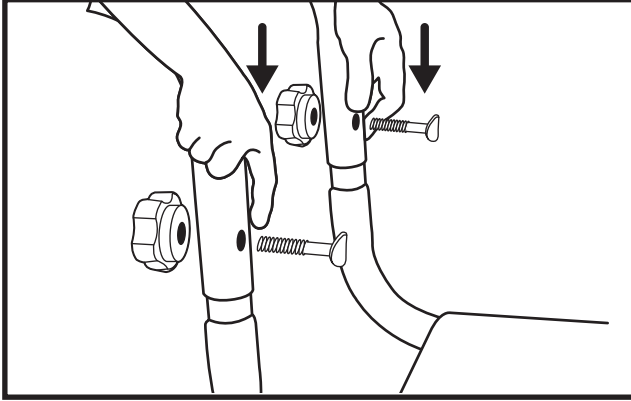

DANGER:

- Never run engine indoors or in enclosed, poorly ventilated areas. Engine exhaust contains carbon monoxide, an odorless and deadly gas.
- Risk of fluid injection and laceration. When using the high-pressure setting, DO NOT allow the high-pressure spray to come in contact with unprotected skin, eyes or with any pets or animals. Serious injury will occur.

QUICK START GUIDE

(Numbers 1-12)

1 Connect Garden Hose to Pump
Thread the garden hose to the pump inlet. See Label #1 on the unit.

2 Connect High Pressure Hose to Pump
Connect the high pressure hose to the pump outlet. See Label #2 on the unit.

3 Connect High Pressure Hose to Spray Gun
Connect the other end of the high pressure hose to the spray gun.

4 Connect Spray Wand to Spray Gun
Thread the spray wand into the end of the spray gun.

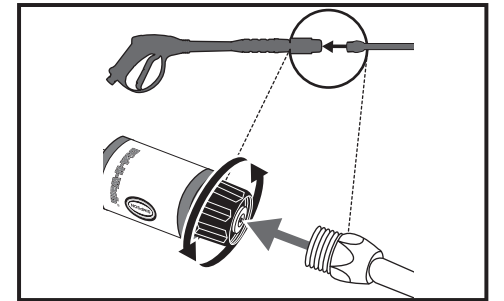
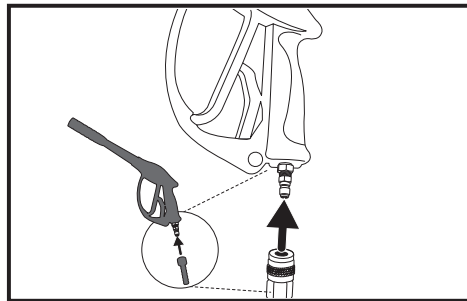
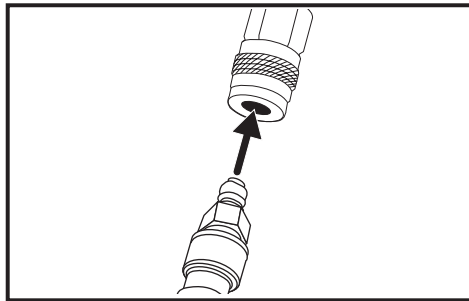
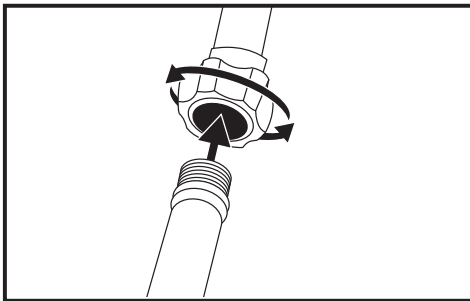

5 Connect QC Nozzles to Spray Wand
Pull quick connect coupler back and insert nozzle. Release quick connect coupler and twist nozzle to make sure it is secure in coupler.

6 Turn Water Faucet Completely On
Do not run the unit without water supply connected and turned on. Use Cold Water Only.

7 Release Air from System
Release all air from pump and high pressure hose by depressing trigger until a steady stream of water is present. Approximately 30 seconds.

8 Verify the Fuel Switch is in the ON Position
See label #8 on unit.

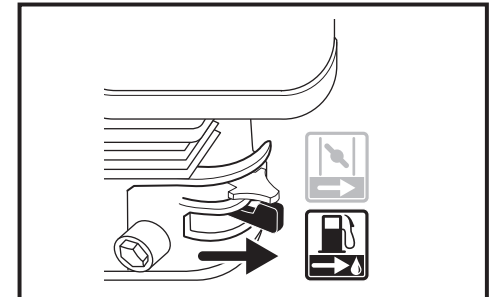
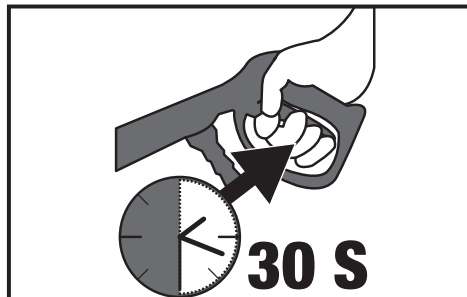
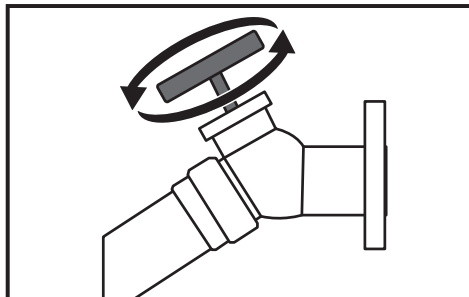
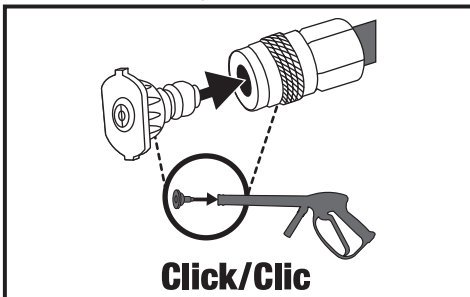

9 Verify the Engine Switch is turned to the ON Position
See label #9 on unit.

10 Move the Choke to the CLOSED Position
See label #10 on unit.

11 Pull the Recoil Starter Grip
Pull the recoil starter grip to start the engine. See label #11 on unit.

12 Move the Choke to the OPEN Position
Gradually move the Choke to the OPEN Position after engine starts. See label #12 on unit.

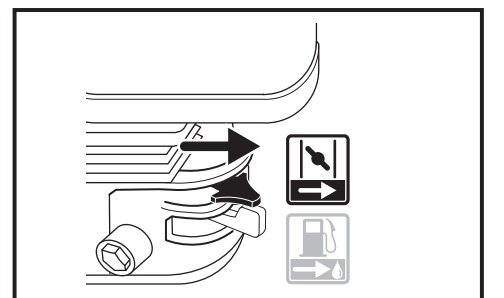
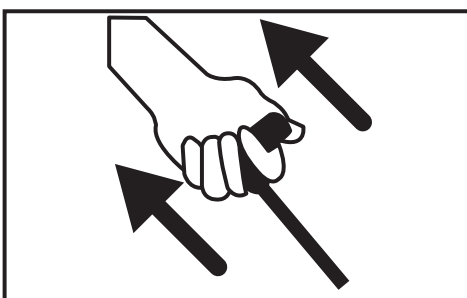
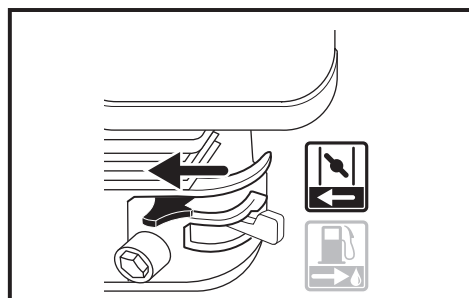
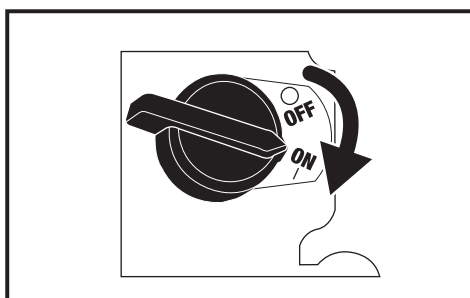

WARNING: This Guide is not a substitute for reading the instruction manual.

Learn more about outdoor tools and equipment on our website.