

# INDUSTRIAL UTILITY CART

Stock Number W53991

## OWNERS MANUAL



Performance Tool®

### **▲ WARNING**

*It is the owner and/or operators' responsibility to study all WARNINGS, operating, and maintenance instructions contained on the product label and instruction manual prior to operating this tool. The owner/operator shall retain product instructions for future reference.*

*The owner and/or operator are responsible for maintenance, maintaining all decals or warning labels and while in use, maintaining the unit in good working order. If the owner and/or operator are not fluent in English, the product warnings and instructions shall be read and discussed with the operators' native language by the purchaser/owner or his designee. Make sure that the operator comprehends its contents. Safety information shall be emphasized and understood prior to usage.*

*Protect yourself and others by observing all safety information.*

*Failure to comply with instructions could result in personal injury and/or property damage!*

**PT**  
**Performance Tool®**

Please read these instructions carefully and retain them for future use.

## SPECIFICATIONS

Industrial Utility Cart: .....W53991

Construction: .....High Impact Poly-Propylene

Maximum Capacity: .....500 Lbs.

Tray Size: .....30 in. L x 16 in. W x 3 in. D

Overall dimensions: .....39-3/4 in. L x 17 in. W x 33-1/4 in. H

**Specifications are  
subject to change  
without notice**

## IMPORTANT SAFETY INFORMATION

Read these safety warnings before operation.

Assemble only according to these instructions. Improper assembly can create hazards.

Wear ANSI-approved safety goggles and heavy-duty work gloves during assembly.

Keep assembly area clean and well lit.

Keep bystanders out of the area during assembly.

Do not assemble when tired or when under the influence of drugs or medication.

Weight capacity and other product capabilities apply to properly and completely assembled product only.

This product is not a toy. Do not allow children to play with or near this item.

Use as intended only.

Inspect before every use: do not use if parts are loose or damaged. Do not exceed listed weight capacity, evenly distributed. **Be aware of dynamic loading!** Sudden load movement may briefly create excess load causing product failure.

Use only on flat, level, hard surface able to properly support cart and load.

Maintain product labels and nameplates. These carry important safety information.

## ASSEMBLY INSTRUCTIONS

Note: Use a rubber mallet to ensure snug connection of all nonmetal parts.

1. Place the bases of the four Posts (2,3) into the corners of the Tray (1).  
The Flange on each Post will only fit into certain corners.
2. Insert Carriage Bolt (10) down through the holes in the bases of the Posts (2,3).
3. Attach Casters (6,7) to Carriage Bolts (10) using Split Washers (11) and Nuts (12). For best operation, the two Straight Casters (6) go on the same end of the cart, and the two Swivel Casters (7) go on the other end.
4. Place the other Tray (1) upside down on the work surface. Turn the Handle (8) upside down with the cup holder toward the Tray and the hand holes on the outside.
5. Place the Tray with the Handle firmly on top of the Posts (2,3). Position the Handle above either the swivel of fixed casters, depending on operation preference.
6. Place a Post Cap (4,5) on top of each corner of the Tray (1).
7. Use three Screws (9) through each Post (2,3) from underneath to secure them.

## PARTS LISTING

Part	Description	Qty.
1	Tray	2
2	RH Post	2
3	LH Post	2
4	RH Post Cap	2
5	LH Post Cap	2
6	Straight Caster	2

Part	Description	Qty.
7	Swivel Caster	2
8	Handle	1
9	Screw	12
10	Carriage Bolt	16
11	Split Washer	16
12	Nut	16

## PARTS DIAGRAM

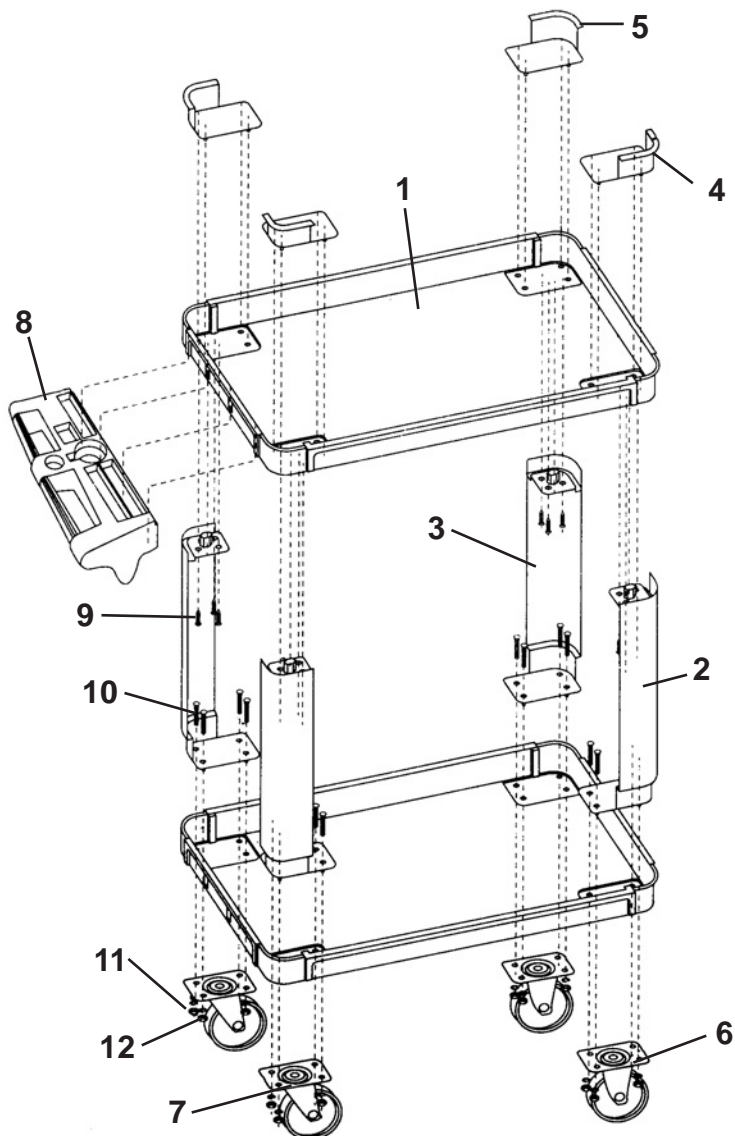

## **1 YEAR LIMITED WARRANTY**

PERFORMANCE TOOL® extends only the following warranties, and only to original retail purchasers. These warranties give specific legal rights. Except where prohibited by local law, the law of the State of Washington governs all warranties and all exclusions and limitations of warranties and remedies. There may be other rights which vary from state to state.

PERFORMANCE TOOL® warrants the product to be free from defects in materials and workmanship under normal use and service. A defective product may be returned for a free replacement within 90 days from the date of purchase, provided that product is returned to place of purchase immediately after discovery of defect. After 90 days and up to one year from date of purchase, PERFORMANCE TOOL® will replace at no charge any parts which our examination shall disclose to be defective and under warranty.

These warranties exclude blades, bits, punches, dies, bulbs, fuses, hoses, and other consumables which must be replaced under normal use and service. These warranties shall not apply to any product or part which is used for a purpose for which it is not designed, or which has been repaired or altered in any way so as to affect adversely its performance or reliability, nor shall these warranties apply to any product or part which has been subject to misuse, neglect, accident or wear and tear incident to normal use and service.

PERFORMANCE TOOL® does not authorize any other person to make any warranty or to assume any liability in connection with its products.

Except for warranties of title and the limited express warranties set forth above, PERFORMANCE TOOL® makes no express or implied warranties of any kind with respect to its products. In particular, PERFORMANCE TOOL® makes no implied warranty of merchantability and no implied warranty of fitness for any particular purpose, except that for goods purchased primarily for personal, family or household use and not for commercial or business use, PERFORMANCE TOOL® makes an implied warranty of merchantability (and, if otherwise applicable, an implied warranty of fitness for a particular purpose), but only for the particular qualities or characteristics, and for the duration, expressly warranted above.

The laws on limitation of implied warranties may differ from state to state, so the above limitations may not apply in all cases.

PERFORMANCE TOOL® shall not be liable for consequential, incidental or special damages resulting from or in any manner related to any product, or to the design, use, or any inability to use the product. The sole and exclusive remedy for a defective product or part shall be the repair, or replacement thereof as provided above. On occasion, after printing of our literature is completed, our manufacturers may make changes and/or modifications to merchandise which will not be reflected in this manual. Although we strive to maintain complete and accurate information, it is possible in some instances, that the product may differ slightly from printed specifications. Illustrations are intended for reference only. Actual merchandise may vary. Wilmar is not responsible for typographical errors.