

**Parts List &  
Assembly Instructions**  
for:

5095A  
5096A

## Easy Lever™ Tire and Wheel Caddie

The Easy Lever tire and wheel caddie makes moving tires and wheels an easy task. Use the following steps to assemble the Easy Lever:

1. Secure the handle over the U-frame, as shown, using two hex head bolts, two spring washers, two flat washers, and two nuts.
2. Fasten the kickstand under the frame tabs using a hex head bolt, a spring washer, and a flat washer.

**NOTE: Fully tighten all nuts at this time. To prevent damage to the kickstand, do not overtighten its bolt.**

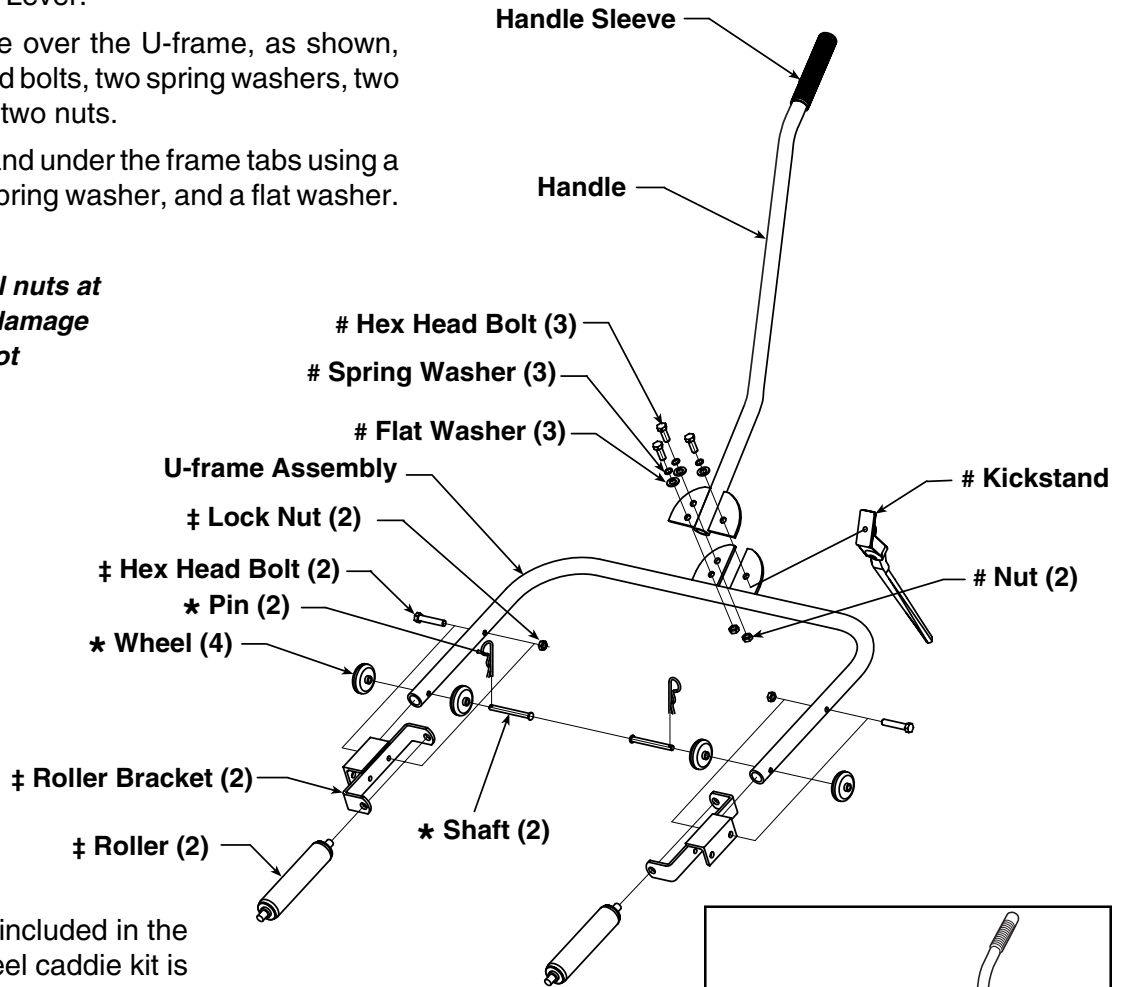

The number of parts included in the Easy Lift tire and wheel caddie kit is identified in parenthesis on the illustration. Parts not identified with a number are single units.

### Replacement Parts:

Kit No.	Items Included in Kit	Description
533873	*	Wheel/Axle Kit
533874	‡	Roller Kit
533875	#	Kick Stand/Hardware Kit

