

Please read and save these instructions. Read through this owner's manual carefully before using product. Protect yourself and others by observing all safety information, warnings, and cautions. Failure to comply with instructions could result in personal injury and/or damage to product or property. Please retain instructions for future reference.



LEVER ACTION BARREL PUMP **POLYPROPYLENE STAINLESS STEEL ROD**

UNPACKING

After unpacking unit, inspect carefully for any damage that may have occurred during transit. Check for loose, missing, or damaged parts. If any damage is observed, a shipping damage claim must be filed with carrier. Do not use Lever Action Barrel Pump if broken, bent, cracked or damaged parts (including labels) are noted. Any Lever Action Barrel Pump that appears damaged in any way, operates abnormally or is missing parts should be removed from service immediately. If you suspect that the Lever Action Barrel Pump was subjected to a shock load (a load that was dropped suddenly, unexpectedly, etc.) immediately discontinue use until it has been checked by a factory authorized service center.



⚠ WARNING

The following safety information is provided as a guideline to help you operate your Lever Action Barrel Pump under the safest possible conditions. Any tool or piece of equipment can be potentially dangerous to use when safety or safe handling instructions are not known or not followed. The following safety instructions are to provide the user with the information necessary for safe use and operation. Please read and retain these instructions for the continued safe use of your service system. Failure to follow instructions listed below may result in serious injury. In addition, make certain that anyone that uses the equipment understands and follows these safety instructions as well.

Explanation of Safety Signal Words

⚠ WARNING: Indicates a potentially hazardous situation which, if not avoided, could result in death or serious injury.

⚠ CAUTION: Indicates a potentially hazardous situation which, if not avoided, may result in minor or moderate injury.

CAUTION: Used without the safety alert symbol indicates a potentially hazardous situation which, if not avoided, may result in property damage.

NOTES: Provide clarity and helpful information.

Thank you very much for choosing an OEMTOOLS Product!

For future reference, please complete the owner's record below:

Model: _____ **Purchase Date:** _____

Save the receipt, warranty and these instructions. It is important that you read the entire manual to become familiar with this product before you begin using it. This machine is designed for certain applications only. OEMTOOLS cannot be responsible for issues arising from modification. We strongly recommend this machine is not modified and/or used for any application other than that for which it was designed. If you have any questions relative to a particular application, DO NOT use the machine until you have first contacted OEMTOOLS to determine if it can or should be performed on the product.



LEVER ACTION BARREL PUMP POLYPROPYLENE STAINLESS STEEL ROD



IMPORTANT INSTRUCTIONS AND SAFETY RULES

1. Know your tool. Read this manual carefully. Learn the tool's applications and limitations, as well as, potential hazards specific to it.
 2. Keep work area clean and well lit. Cluttered or dark work areas invite accidents.
 3. Keep children away. All children should be kept away from the work area. Never let a child handle a tool without strict adult supervision.
 4. Do not operate this tool if under the influence of alcohol or drugs. Read warning labels on prescriptions to determine if your judgment or reflexes are impaired while taking drugs. If there is any doubt, do not attempt to operate.
 5. Use safety equipment. Eye protection should be worn at all times when operating this tool. Use ANSI approved safety glasses. Everyday eyeglasses are NOT safety glasses. Dust mask, non-skid safety shoes, hard hat or hearing protection should be used in appropriate conditions.
 6. Wear proper apparel. Loose clothing, gloves, neck-ties, rings, bracelets or other jewelry may present a potential hazard when operating this tool. Keep all apparel clear of the tool.
 7. Don't overreach. Keep proper footing and balance at all times when operating this tool.
 8. Check for damage. Check your tool regularly. If part of the tool is damaged it should be carefully inspected to make sure that it can perform its intended function correctly. If in doubt, the part should be repaired. Refer all servicing to a qualified technician. Consult your dealer for advice.
 9. Store idle tools out of the reach of children and untrained persons. Tools may be dangerous in the hands of untrained users.
- Maintain tools with care.
 - Keep tools dry and clean.
 - Do not use a damaged tool. Tag damaged tools "Do not use" until repaired.
 - Use only accessories that are recommended by the manufacturer for your model. Accessories that may be suitable for one tool may become hazardous when used on another tool.
 - Tool service must be performed only by qualified repair personnel. Service or maintenance performed by unqualified personnel could result in a risk of injury.
 - When servicing a tool, use only identical replacement parts. Use of unauthorized parts or failure to follow maintenance instructions may create a risk of injury.
 - Maintain a safe working environment. Keep the work area well lit. Make sure there is adequate surrounding workspace. Keep the work area free of obstructions, grease, oil, trash, and other debris. Do not use this product in a damp or wet location.
 - Maintain labels and nameplates on this product. These carry important information. If unreadable or missing, contact OEMTOOLS for a replacement.
 - Before use, read and understand all warnings, safety precautions, and instructions as outlined in the vehicle manufacturer's service manual. It is beyond the scope of this manual to properly describe the correct procedure and test data for each vehicle.
- Always perform vehicle service in a properly ventilated area. Never run an engine without proper ventilation for its exhaust. Stop work and take necessary steps to improve ventilation in the work area if you develop momentary eye, nose, or throat irritation as this indicates inadequate ventilation.

WARNING

- Engine parts that are in motion and unexpected movement of a vehicle can injure or kill. When working near moving engine parts, wear snug fit clothing and keep hands and fingers away from moving parts. Keep hoses and tools clear of moving parts. Always stay clear of moving engine parts. Hoses and tools can be thrown through the air if not kept clear of moving engine parts. The unexpected movement of a vehicle can injure or kill. When working on vehicles always set the parking brake or block the wheels.
- Avoid accidental fire and/or explosion. Do not smoke near engine fuel and battery components.
- The warnings, precautions, and instructions discussed in this manual cannot cover all possible conditions and situations that may occur. The operator must understand that common sense and caution are factors which cannot be built into this product, but must be supplied by the operator.
- For safety purposes and the prevention of damage to expensive components it is advised that the user have an understanding of basic automotive repair and a working knowledge of automotive systems.
- We believe the information contained herein to be reliable. However, general technical information is given by us without charge and the user shall employ such information at his own discretion and risk. We assume no responsibility for results or damages incurred from the use of such information in whole or in part. Always refer to specific instructions and technical information supplied by vehicle manufacturer.

Note: The manufacturer declines any and all responsibility for damage to vehicles or components if said damage is the result of unskillful handling by the operator or of failure to observe the basic safety rules set forth in the instruction manual.

WARNING

Read Rules for Safe Operation and Instructions Carefully.

IMPORTANT SAFETY INSTRUCTIONS

The warnings, precautions, and instructions discussed in this manual cannot cover all possible conditions and situations that may occur. The operator must understand that common sense and caution are factors which cannot be built into this product, but must be supplied by the operator.

DISPOSAL

At the end of the useful life of the Lever Action Barrel Pump, dispose of the components according to all state, federal, and local regulations.



LEVER ACTION BARREL PUMP POLYPROPYLENE STAINLESS STEEL ROD

PURPOSE

The OEM Lever-Action Barrel Pump is constructed with a Polypropylene Body, PP Telescopic Tube, 316 Stainless Steel Rod, PP Piston and PP Spout. It is designed to fit 15, 30 or 55 Gallon Drums and is ideal for pumping Diesel, Kerosene, Water-based Chemicals, Bases, and Mild Acids.

WARNING

NOT SUITABLE FOR USE WITH GASOLINE, DIESEL EXHAUST FLUID (DEF), NITRIC ACID ETC. DO NOT PUMP USED, DIRTY OIL OR FLUIDS IN THIS PUMP. IT IS SOLELY THE OPERATORS RESPONSIBILITY TO DETERMINE IF A FLUID IS COMPATIBLE WITH THIS PUMP. IF IN DOUBT CONTACT THE FLUID MANUFACTURER OR OEM TOOLS.

MAXIMUM VISCOSITY: 40 wt. Oil

PRODUCT SPECIFICATIONS

Flow Rate:	12 Oz./Stroke
Bung Adapter:	1.25" and 2" Thread
Applicable Drums:	30, 55 Gallon and some 15 Gallon.

WARNING

TOXIC FLUID HAZARD:

HAZARDOUS FLUID OR TOXIC FUMES CAN CAUSE SERIOUS INJURY OR DEATH IF SPLASHED IN THE EYES OR ON THE SKIN, INHALED, OR SWALLOWED. KNOW THE SPECIFIC HAZARDS OF THE FLUID YOU ARE USING. STORE HAZARDOUS FLUID IN AN APPROVED CONTAINER. DISPOSE OF HAZARDOUS FLUID ACCORDING TO ALL LOCAL, STATE AND NATIONAL GUIDELINES. ALWAYS WEAR PROTECTIVE EYEWEAR, GLOVES, CLOTHING AND RESPIRATOR AS RECOMMENDED BY THE FLUID AND SOLVENT MANUFACTURER.

WARNING

FIRE AND EXPLOSION HAZARD:

- EXTINGUISH ALL OPEN FLAMES OR PILOT LIGHTS IN THE WORK AREA.
- DO NOT SMOKE IN THE WORK AREA.
- DO NOT TURN ON OR OFF ANY LIGHT SWITCH IN THE WORK AREA WHILE OPERATING OR IF FUMES ARE PRESENT.
- DO NOT OPERATE A GASOLINE ENGINE IN THE WORK AREA.
- KEEP A FIRE EXTINGUISHER IN THE WORK AREA.
- KEEP THE WORK AREA FREE OF DEBRIS, INCLUDING SOLVENT, RAGS, AND GASOLINE.

INSTRUCTIONS:

1. Attach Handle:
 - a. Remove the Nut and Screw from the end of the Handle that is not connected to anything.
 - b. Insert the Pump Shaft into the Handle, aligning the hole in the Pump Shaft with the holes in the handle.
 - c. Reinstall the Screw in the Handle inserting it through the hole in the Pump Shaft and tighten the Nut. Do not overtighten.

NOTE: Use a compatible, liquid thread sealant or PTFE tape on all male threads. Tighten all connections firmly to avoid air or fluid leaks. Do not overtighten plastic threads.

2. Thread the Suction Tube into the inlet side of Pump. Attach extensions as needed for your drum size.
3. Insert Suction Tube into the drum's Bung opening.
4. Thread the Bung Nut into the tank.
5. Assemble and thread the Delivery Spout onto the output side of Pump.

MAINTENANCE:

Weekly: Spray a Teflon lubricant into the Pump Body.



**LEVER ACTION BARREL PUMP
POLYPROPYLENE STAINLESS STEEL ROD**

Figure	Description	Quantity
A	Pump Body	1
B	Discharge Spout	1
C	Suction Tube	3
D	Handle	1
E	Bung Nut	1
F	Pump Shaft	1

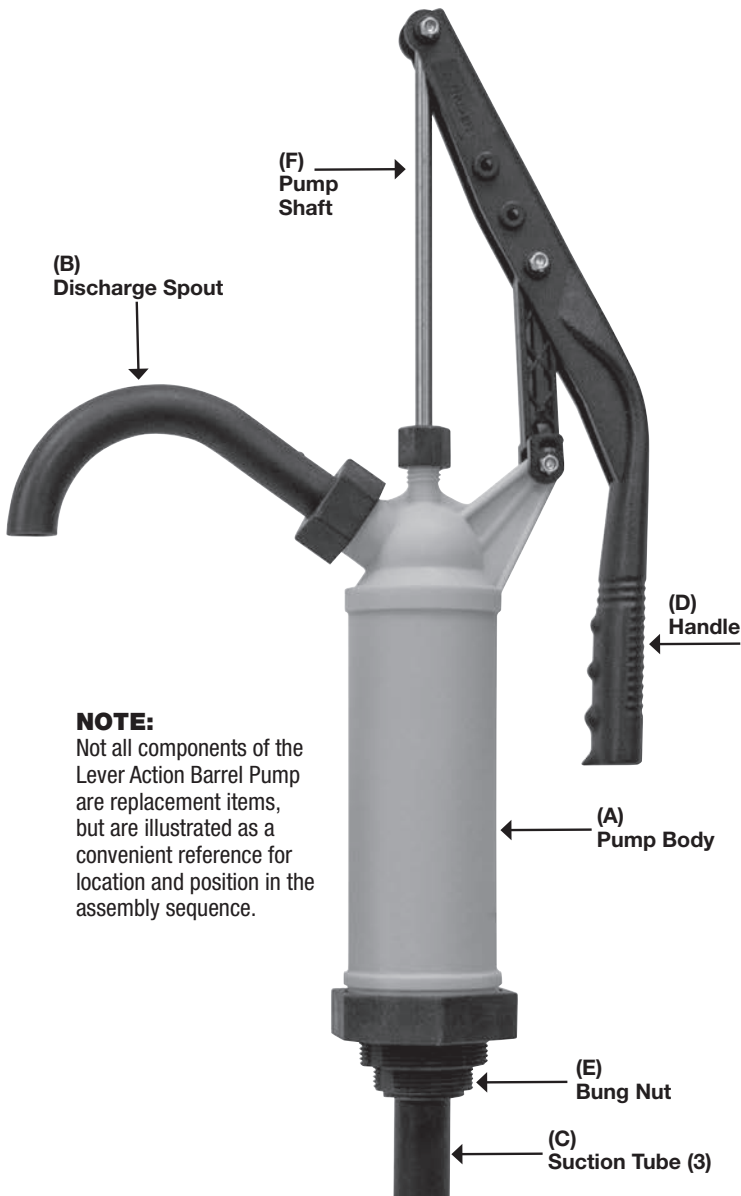

NOTE:
Not all components of the Lever Action Barrel Pump are replacement items, but are illustrated as a convenient reference for location and position in the assembly sequence.

