



## Instruction Manual FORGE™ NSP-4640B

US PATENT 9,713,217

### PACKAGE CONTENTS



### WARNINGS

- NOT FOR USE ABOVE HAZARDOUS LOCATIONS
- DO NOT use in explosive atmospheres, near flammable liquids, or where explosion proof lamps are required.
- DO NOT use in the proximity of vehicles or equipment when there is a risk of flammable liquids coming into contact with the flashlight.
- DO NOT expose the batteries to water or salt water, or allow the batteries to get wet.
- DO NOT store the batteries with metallic objects that may cause a short circuit.
- Immediately discontinue use of the batteries if they emit an unusual smell, feel hot, change color, change shape or appear abnormal in any way.
- Keep out of the reach of children.

### INSTALLING BATTERIES

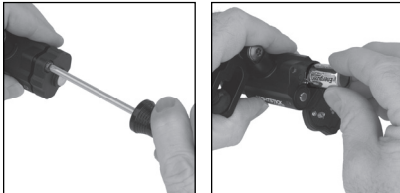

Image 1



Image 2

- Loosen the screw on the battery compartment door. (Image 1)
- Insert batteries using the orientation markings on the back of the battery compartment door. (Image 2)
- Close the battery door fully, then tightening the screw until it is hand tight. CAUTION: Do not cross-thread or strip the screw threads.
- Test the operation of the light (see OPERATION below).

### INSTALLING THE FORGE ON A HELMET

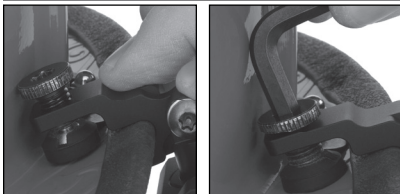

Image 3



Image 4

- Choose the side of the helmet you wish to mount the light on.
- Rotate the mount to orient the clamp with thumbscrew on top.
- Open the clamp completely and fully seat over helmet brim, ensuring the clamp clears any rubber helmet trim. (Image 3)
- Tighten the clamp firmly with included Allen wrench. (Image 4)

### SETTING THE ANGLE OF THE LIGHT

- Twist the light left or right on the vertical pivot until beam pattern is in an ideal position.
- The tension on the mount is meant to be firm to maintain the aim.
- Once aimed, the mount allows the user to position light above or below the brim by rotating up or down as needed.

### OPERATION

The 4640 has a flashlight push button tail switch with the following lighting modes:

#### CONSTANT-ON FLASHLIGHT

Press the flashlight switch until it clicks and then release for constant-on in high-brightness mode. Press and release to turn the light off.

#### SELECT FLASHLIGHT BRIGHTNESS LEVEL

Press and hold down the flashlight switch. The flashlight will cycle from high to medium to low and then back up again at a rate of approximately one mode per second. The light will continue to cycle through the modes as long as the flashlight switch is held down. When the desired brightness level is reached, release the flashlight switch, and the light will remain in that mode. Press and hold from any mode to start the cycle again. Press and release to turn the light off.

#### Rear Green Safety LED

The rear green safety LED will remain lit while flashlight is on in any mode.