



TO INFORM YOU

PRODUCT
SUPPORT
BULLETIN # 387

TO: AUTHORIZED *Portable Electric Tool* SERVICE STATIONS
factory SERVICE CENTERS
SALES COMPANIES

DATE: September, 2002

TOOL(S) \ PRODUCT(S) AFFECTED : 6380-51, 6390-20, 6390-21, 6394-20 7-1/4" Til-Lok® Handle Circular Saw

SUBJECT: 45-06-0075 Felt Seal

Original manufacture of the 7-1/4" Til-Lok® Handle Circular Saw had a **Felt Seal 45-06-0075** as part of the Spindle Lock assembly.

A running change is being made and 7-1/4" Til-Lok® Handle Circular Saws will no longer be manufactured with a 45-06--0075 Felt Seal [fig 67]. For service on a 7-1/4" Til-Lok® Handle Circular Saw the same is true, the felt seal is no longer needed and should be discarded if in need of replacement. Status of 45-06-0075 felt seal has been changed to obsolete, no longer available, with no-replacement.

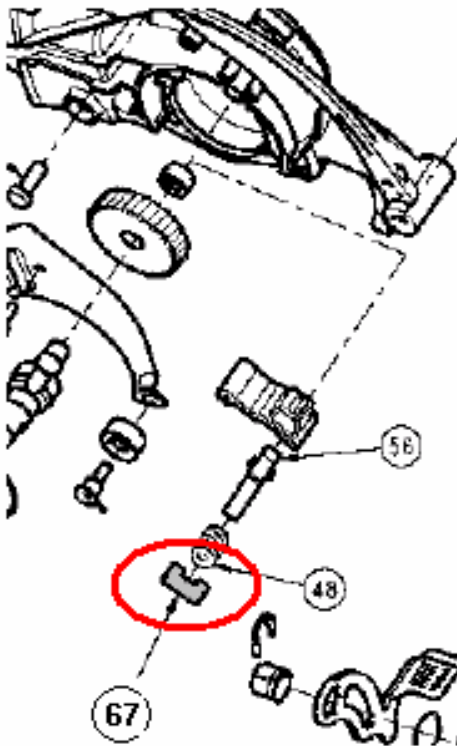

This bulletin is for informational purposes. PLEASE NOTE ON SERVICE PARTS LIST; **120V** - 54-40- 6000, -6001 , -6025, -6050
240V - 55-40-6000