

WIRING INSTRUCTIONS

TITLE

SANDERS & GRINDERS

**BULLETIN
58-01-0307**

DATE
Oct. '91

TOP ILLUSTRATION SHOWS THE WIRE ROUTING FOR TOOLS WITH CURVED HANDLES (OLD DESIGN), BOTTOM ILLUSTRATION SHOWS THE WIRE ROUTING FOR STRAIGHT HANDLE TOOLS.

NOTE:
AFTER FIELD IS INSTALLED,
CUT WIRE NO. 5 TO 4" FROM
REAR OF MOTOR HOUSING.

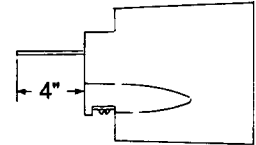

CURVED DESIGN

STRAIGHT DESIGN

NOTE:
AFTER FIELD IS INSTALLED,
CUT WIRE NO. 5 TO 4" FROM
REAR OF MOTOR HOUSING.

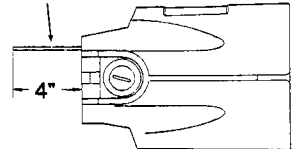

NOTE:
WIRES CAN BE ROUTED IN
ANY TRAP AND IN ANY
ORDER.

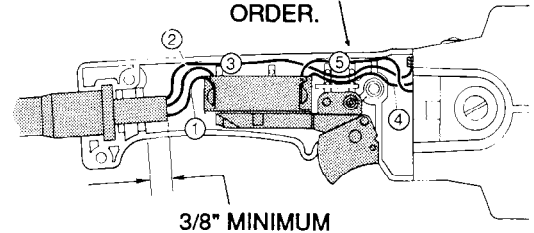

3/8" MINIMUM

NOTE:
WIRES CAN BE ROUTED
IN ANY TRAP AND
IN ANY ORDER.

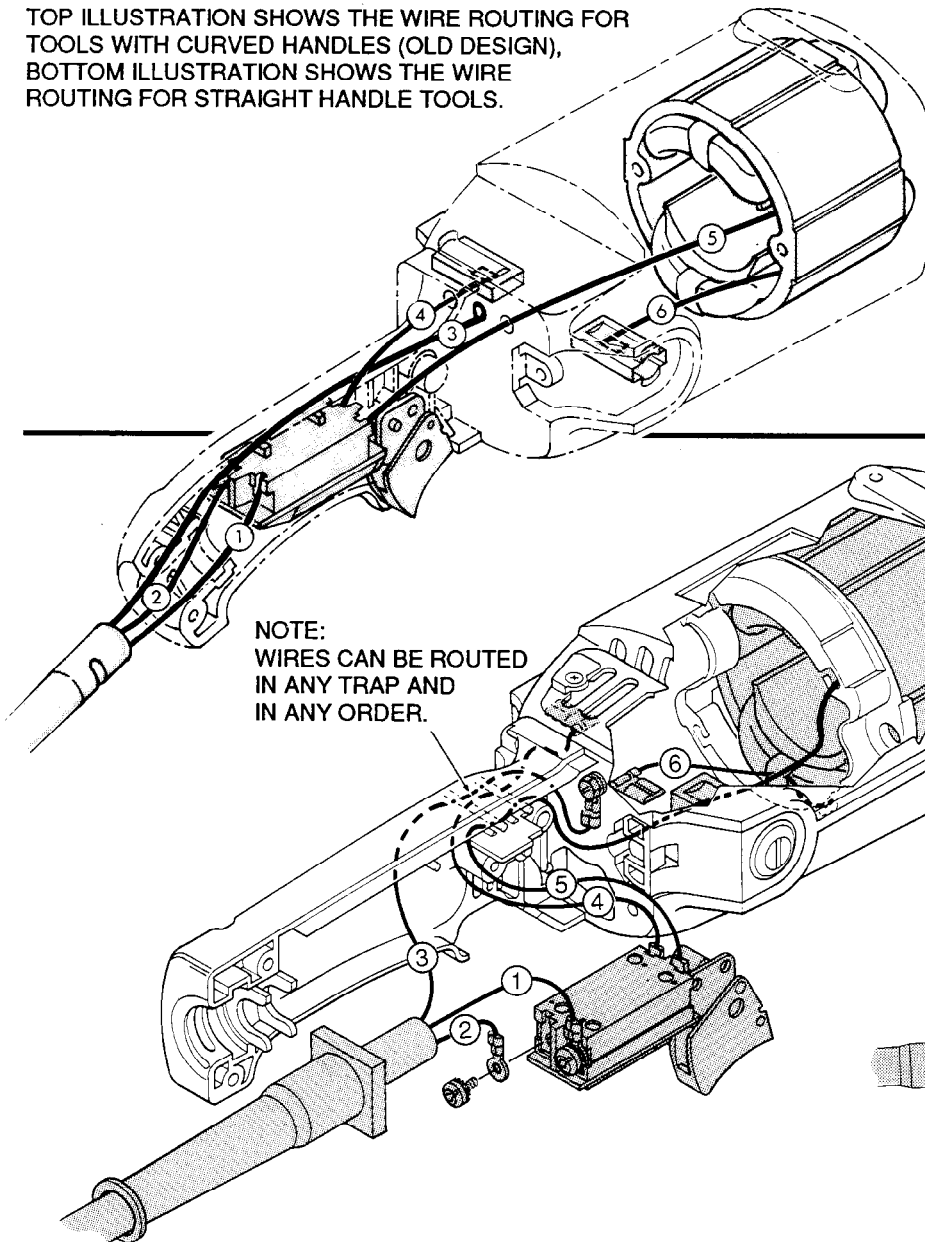

WIRING SPECIFICATIONS

Wire No.	Wire Color	Origin or Gauge	Length	Terminals, Connectors and 1 or 2 End Wire Preparation
1	Black	Cord/14 Ga.	2"	Strip 3/16" For T2.
2	White	Cord/14 Ga.	2"	Strip 3/16" For T2.
3	Green	Cord/14Ga.	6-3/4"	Strip 3/16" For T1.
4	Yellow	16 Ga.	5"	Strip 3/16" For T2/Strip 3/16" For T3.
5	Black	Field/16 Ga.	See Note	Strip 3/16" for T2.
6	Yellow	Field/16 Ga.	2-3/4"	Strip 3/16" For T3.

NOTE:
All leads must be held to $\pm 1/8"$.
All field leads to be measured from
and perpendicular to laminations.
All lead lengths are before stripping.

TERMINAL DESCRIPTION

Code	Part No.	Qty.
T1	23-74-0841	1
T2	23-74-0851	4
T3	23-74-0300	2

CONNECTOR DESCRIPTION

Code	Part No.	Qty.

WIRING INSTRUCTIONS

TITLE

SANDERS / GRINDERS

BULLETIN

58-01-1307

DATE
Jan. 2009

**SEE REVERSE SIDE
FOR TOOLS WITH
ALTERNATIVE SWITCH
CONFIGURATION**

NOTE:

After lead field is installed, attach wire 6 to brush tube. Route wires 5 and 6 from rear of motor housing and cut wire 5 to length as shown.

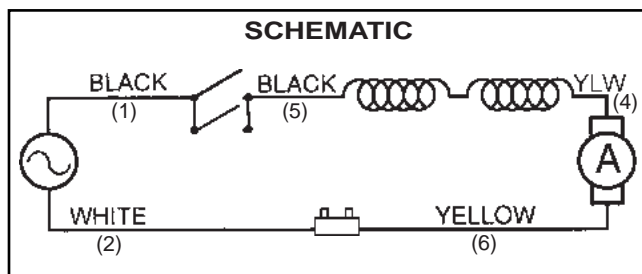
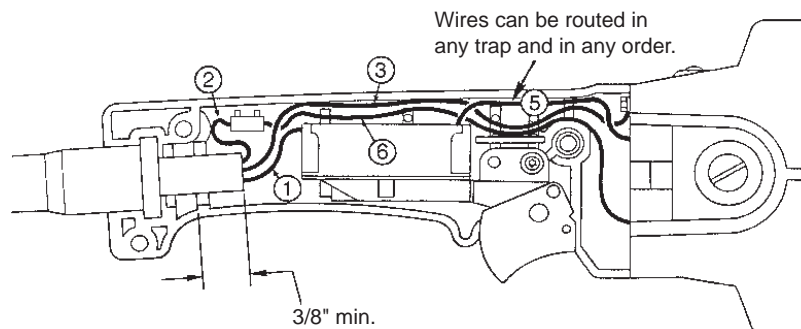
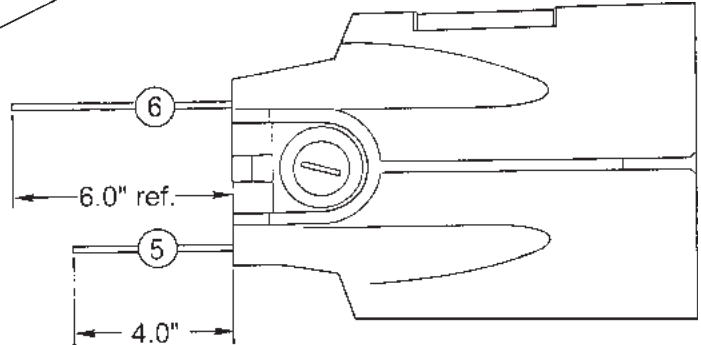
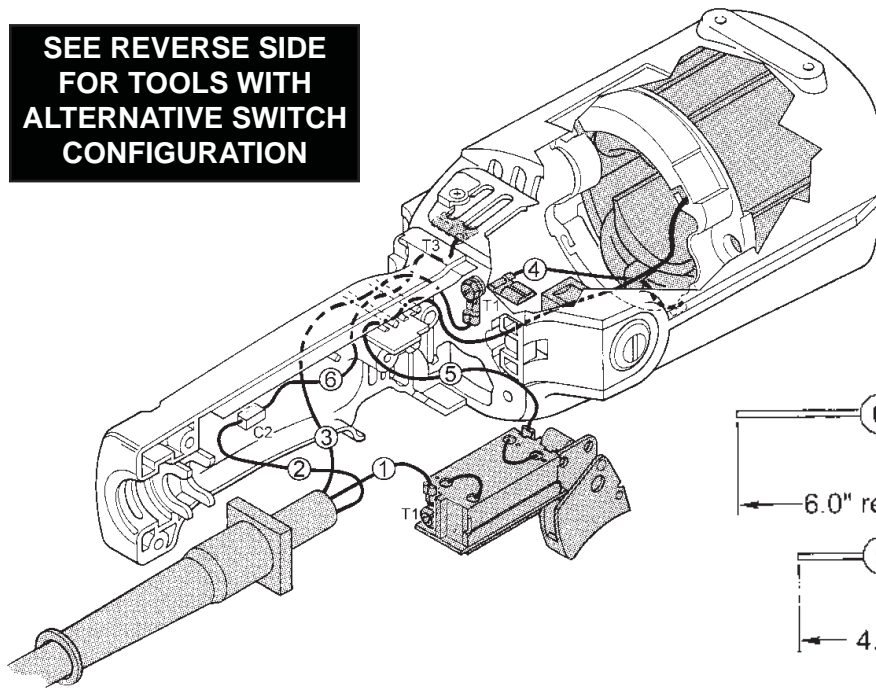

NOTE:

All lead lengths are before stripping.
All field leads are to be measured from and perpendicular to laminations.
All leads must be held to $\pm 1/8$ ".
Strip wire per ES 13-11.
Crimp terminals per ES 13-15.
See terminal drawings for crimp heights.

WIRING SPECIFICATIONS

Wire No.	Wire Color	Origin or Part No.	Gauge	Length	Terminals, Connectors and End Wire Preparation
1	Black	Cord	14 ga.	2"	Strip 3/16" for T1
2	White	Cord	14 ga.	2"	Strip 5/16" for T4
3	Green	Cord	14 ga.	6 3/4"	Strip 3/16" for T1
4	Yellow	Field	16 ga.	-----	Strip 3/16" for T3
5	Black	Field	16 ga.	see note	Strip 3/16" for T1
6	Yellow	Brush Tube	16 ga.	see note	Strip 3/16" for T3, strip 5/16" for T4

BULK LEAD WIRE - BULLETIN 58-01-0003

TERMINAL DESCRIPTION

Code	Part No.	Qty.
T1	23-74-0840	3
T3	23-74-0610	2
T4	23-74-0385	2

CONNECTOR DESCRIPTION

Code	Part No.	Qty.
C2	22-56-0480	1

**SEE REVERSE SIDE
FOR TOOLS WITH
ALTERNATIVE SWITCH
CONFIGURATION**

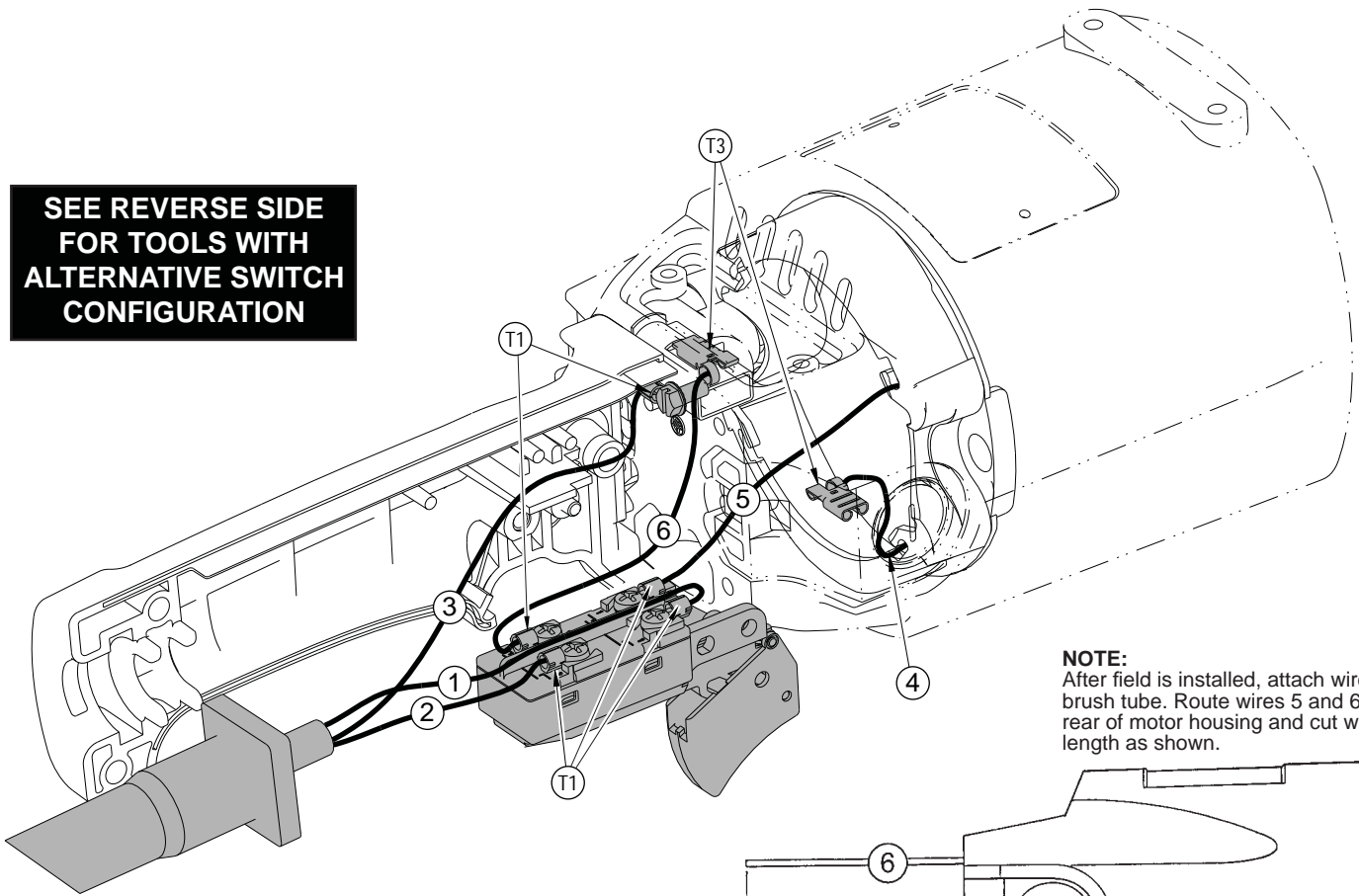

NOTE:
After field is installed, attach wire 6 to brush tube. Route wires 5 and 6 from rear of motor housing and cut wire 5 to length as shown.

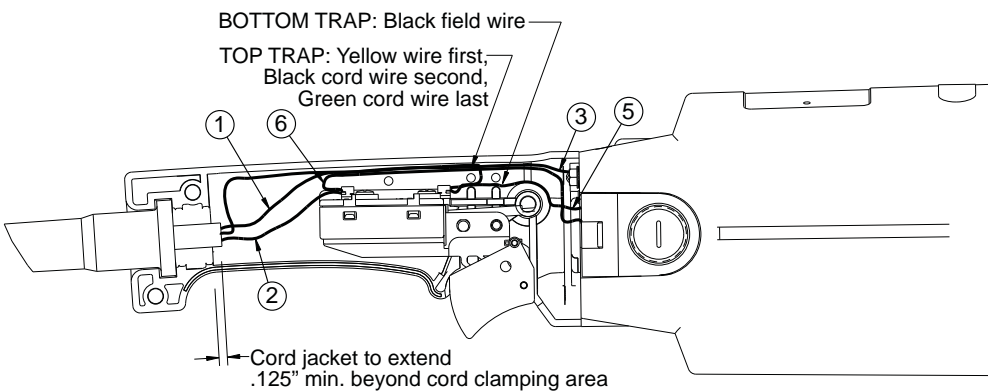
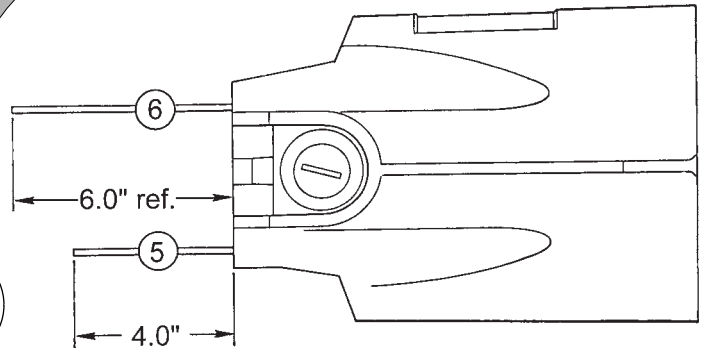
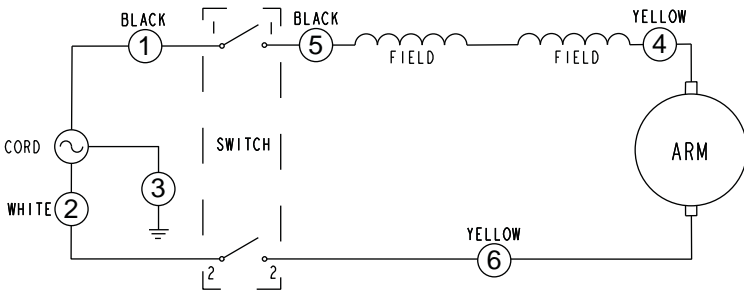

NOTE:
All lead lengths are before stripping.
All field leads are to be measured from and perpendicular to laminations.
All leads must be held to $\pm 1/8"$.
Strip wire per ES 13-11.
Crimp terminals per ES 13-15.
See terminal drawings for crimp heights.

WIRING SPECIFICATIONS

Wire No.	Wire Color	Origin or Part No.	Gauge	Length	Terminals, Connectors and End Wire Preparation
1	Black	Cord	14 ga.	5"	Strip 3/16" for T1
2	White	Cord	14 ga.	2-3/8"	Strip 3/16" for T1
3	Green	Cord	14 ga.	6 3/4"	Strip 3/16" for T1
4	Yellow	Field	16 ga.	-----	Strip 3/16" for T3
5	Black	Field	16 ga.	see note	Strip 3/16" for T1
6	Yellow	23-94-4401	16 ga.	see note	Strip 3/16" for T1, Strip 3/16" for T3

BULK LEAD WIRE - BULLETIN 58-01-0003

TERMINAL DESCRIPTION

Code	Part No.	Qty.
T1	23-74-0840	5
T3	23-74-0610	2

CONNECTOR DESCRIPTION

Code	Part No.	Qty.

WIRING INSTRUCTIONS

TITLE

SANDERS / GRINDERS

BULLETIN

58-01-1309

DATE
Jan. 2009

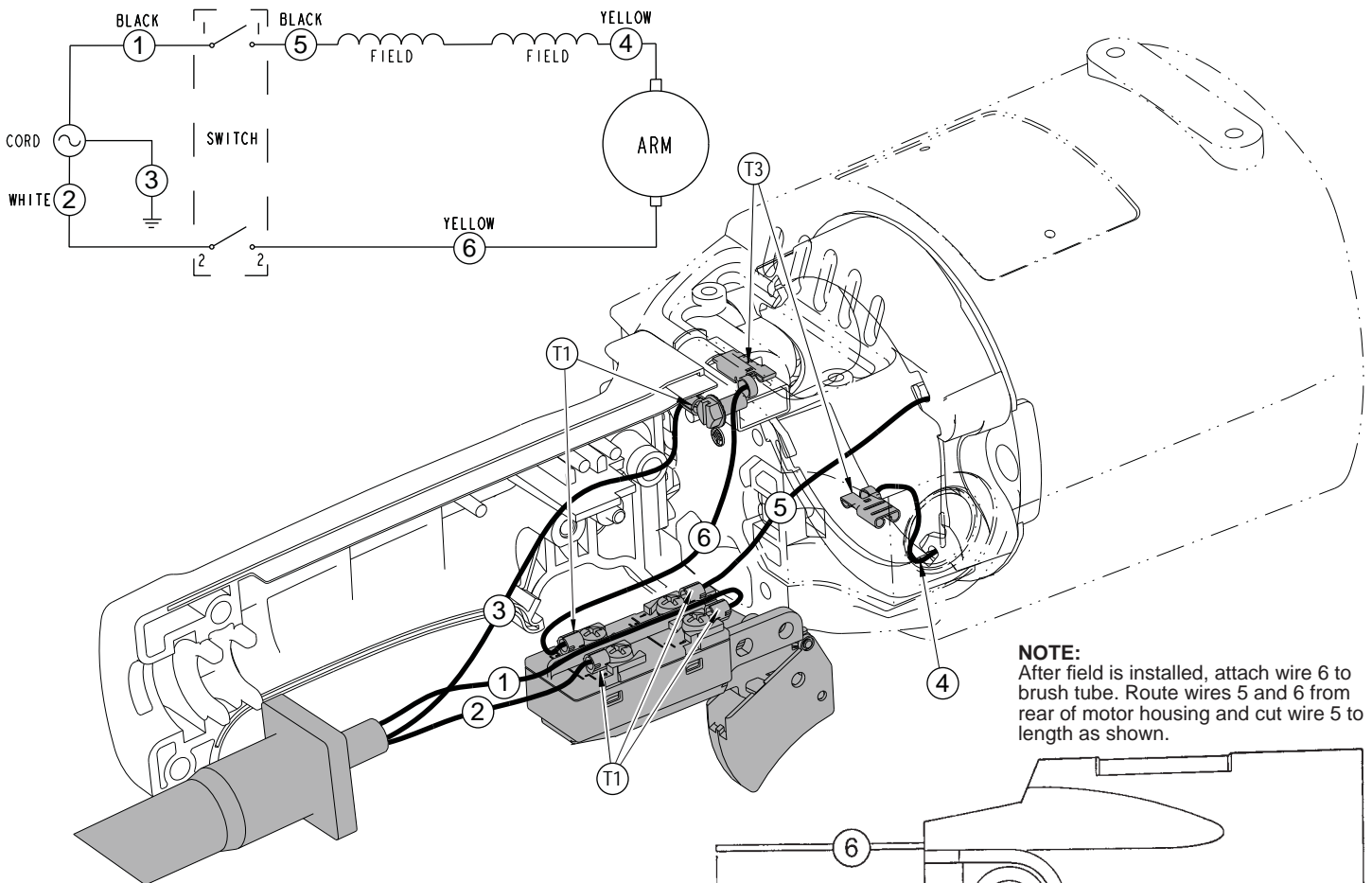

NOTE:
After field is installed, attach wire 6 to brush tube. Route wires 5 and 6 from rear of motor housing and cut wire 5 to length as shown.

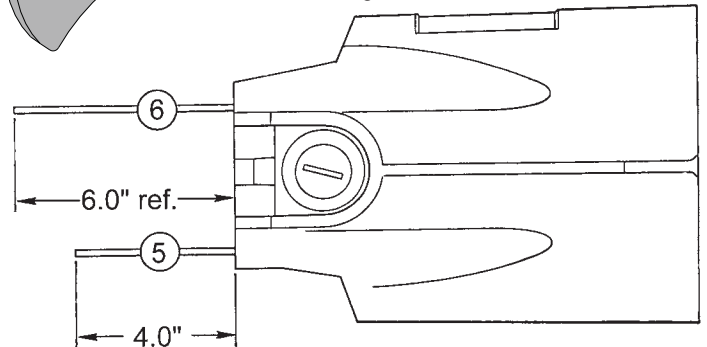

BOTTOM TRAP: Black field wire

TOP TRAP: Yellow wire first,
Black cord wire second,
Green cord wire last

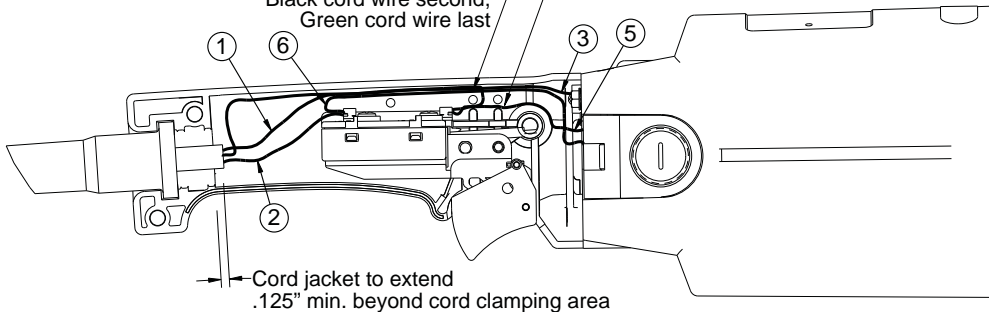

WIRING SPECIFICATIONS

Wire No.	Wire Color	Origin or Part No.	Gauge	Length	Terminals, Connectors and End Wire Preparation
1	Black	Cord	14 ga.	5"	Strip 3/16" for T1
2	White	Cord	14 ga.	2-3/8"	Strip 3/16" for T1
3	Green	Cord	14 ga.	6 3/4"	Strip 3/16" for T1
4	Yellow	Field	16 ga.	-----	Strip 3/16" for T3
5	Black	Field	16 ga.	see note	Strip 3/16" for T1
6	Yellow	23-94-4401	16 ga.	see note	Strip 3/16" for T1, Strip 3/16" for T3

BULK LEAD WIRE - BULLETIN 58-01-0003

NOTE:

All lead lengths are before stripping.
All field leads are to be measured from and perpendicular to laminations.
All leads must be held to ± 1/8".

TERMINAL DESCRIPTION		
Code	Part No.	Qty.
T1	23-74-0840	5
T3	23-74-0610	2

Drwg. 1