

WIRING INSTRUCTIONS

TITLE	BODY GRIP TOOLS	BULLETIN 58-01-0306
		DATE Feb. '95

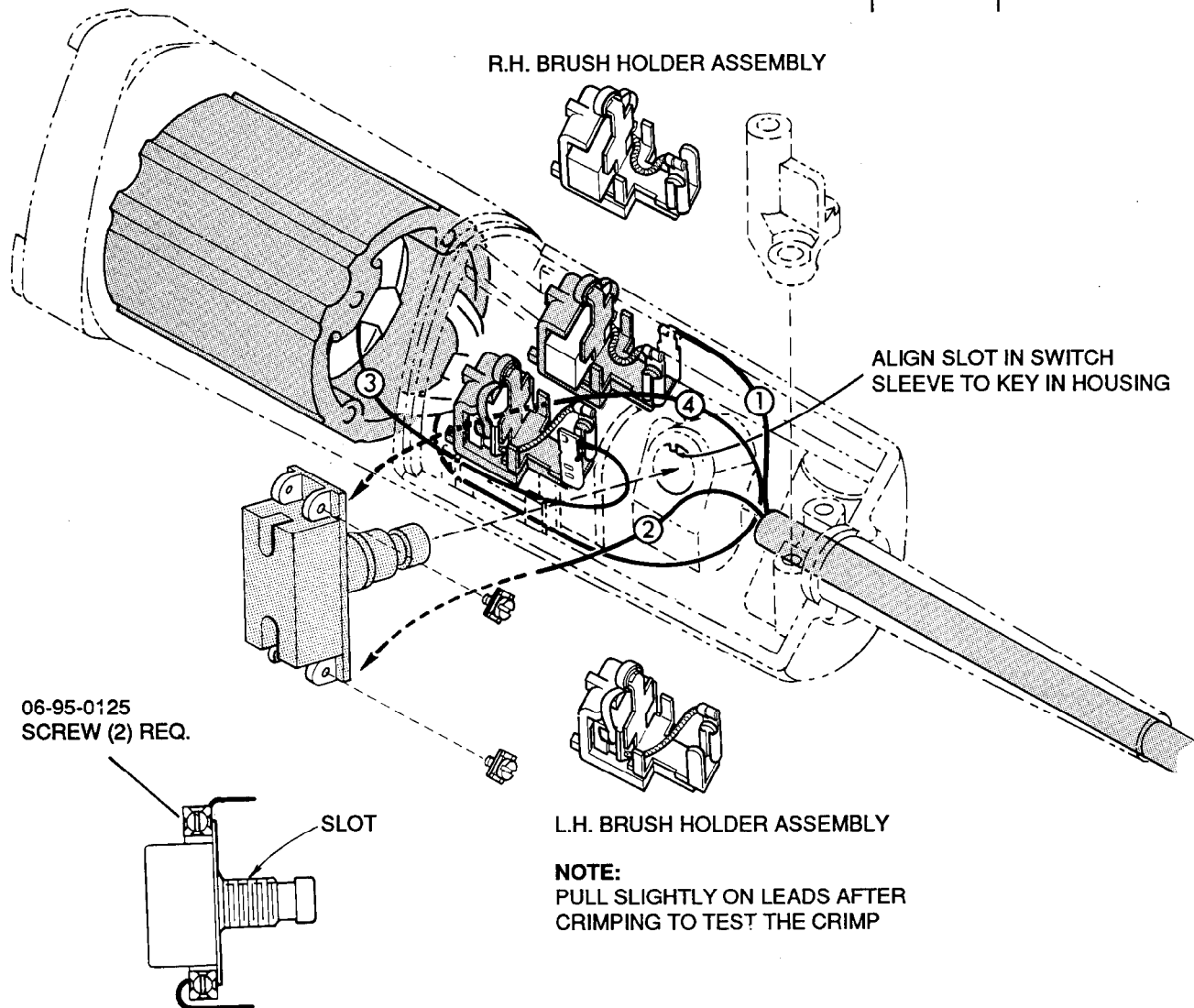

NOTE:
PULL SLIGHTLY ON LEADS AFTER CRIMPING TO TEST THE CRIMP

WIRE ROUTING DETAIL AT SWITCH TERMINALS

PUSH BUTTON SWITCH SHOWN (SOME TOOLS HAVE TOGGLE SWITCH). WIRING HOOKUP IS COMMON TO BOTH. POSITION TOGGLE SWITCH SO THAT THE "ON" MARKING OF THE SWITCH CORRESPONDS TO THE "ON" MARKING OF THE TRIGGER COVER.

NOTE:
All leads must be held to $\pm 1/8"$.
All field leads to be measured from and perpendicular to laminations.
All lead lengths are before stripping.

WIRING SPECIFICATIONS					
Wire No.	Wire Color	Origin or Part No.	Gauge	Length	Terminals, Connectors and End Wire Preparation
1	White	Cord	18	2"	Strip 3/32" for T1
2	Black	Cord	18	2"	Strip 1/4"
3	White	Field	18	----	Strip 3/32" for T1
4	Black	Field	18	----	Strip 5/16"

BULK LEAD WIRE - BULLETIN 58-01-0003

TERMINAL DESCRIPTION		
Code	Part No.	Qty.
T1	23-74-0755	2
TERMINAL DESCRIPTION		
Code	Part No.	Qty.

WIRING INSTRUCTIONS

TITLE	BODY GRIP TOOLS	BULLETIN 58-01-0308
		DATE Feb. '95

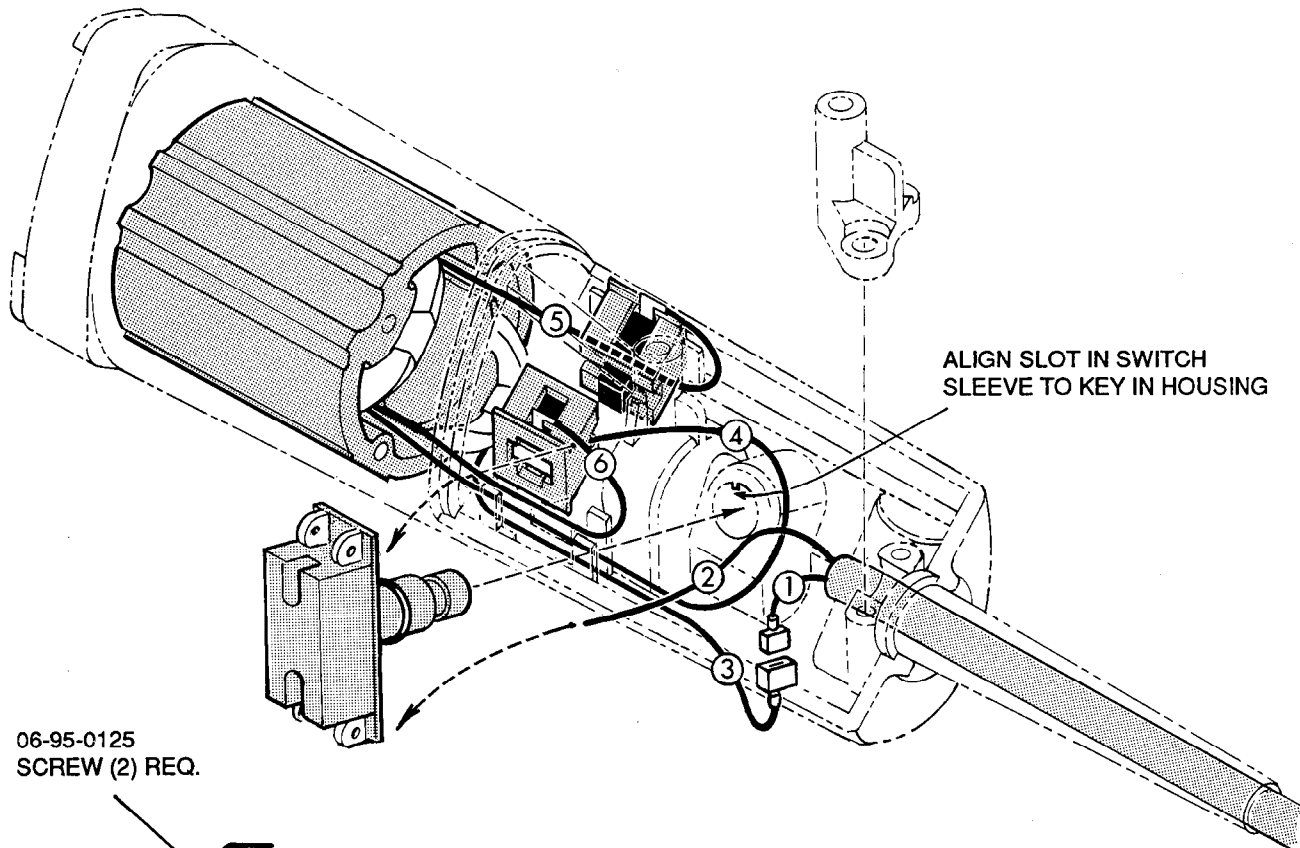

ALIGN SLOT IN SWITCH SLEEVE TO KEY IN HOUSING

06-95-0125
SCREW (2) REQ.

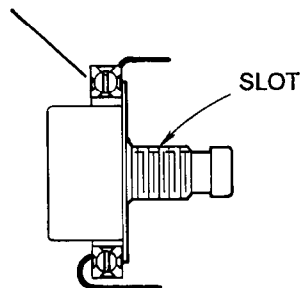

WIRE ROUTING DETAIL AT SWITCH TERMINALS

NOTE:
PULL SLIGHTLY ON LEADS AFTER CRIMPING TO TEST THE CRIMP

PUSH BUTTON SWITCH SHOWN (SOME TOOLS HAVE TOGGLE SWITCH). WIRING HOOKUP IS COMMON TO BOTH. POSITION TOGGLE SWITCH SO THAT THE "ON" MARKING OF THE SWITCH CORRESPONDS TO THE "ON" MARKING OF THE TRIGGER COVER.

WIRING SPECIFICATIONS

Wire No.	Wire Color	Origin or Part No.	Gauge	Length	Terminals, Connectors and End Wire Preparation
1	White	Cord	18	2"	Cut & Strip 3/16" for T2 (See Note)
2	Black	Cord	18	2"	Cut & Strip 1/4"
3	White	Field	18	-----	Strip 3/16" for T3 (See Note)
4	Blue	Field	18	-----	Strip 1/4"
5	Black	Field	18	-----	Strip 3/16" for T1
6	Black	Field	18	-----	Strip 3/16" for T1

BULK LEAD WIRE - BULLETIN 58-01-0003

NOTE:
All leads must be held to $\pm 1/8"$.
All field leads to be measured from and perpendicular to laminations.
All lead lengths are before stripping.

TERMINAL DESCRIPTION

Code	Part No.	Qty.
T1	23-74-0695	2
T2	23-74-0430	1
T3	23-74-0440	1

TERMINAL DESCRIPTION

Code	Part No.	Qty.

WIRING INSTRUCTIONS

TITLE

BODY GRIP TOOLS

**BULLETIN
58-01-0309**

DATE
Feb. 2009

NOTE: Shunt wire positioned to the inside of brush holder. Spring must be in brush slot.

Position brush as shown.

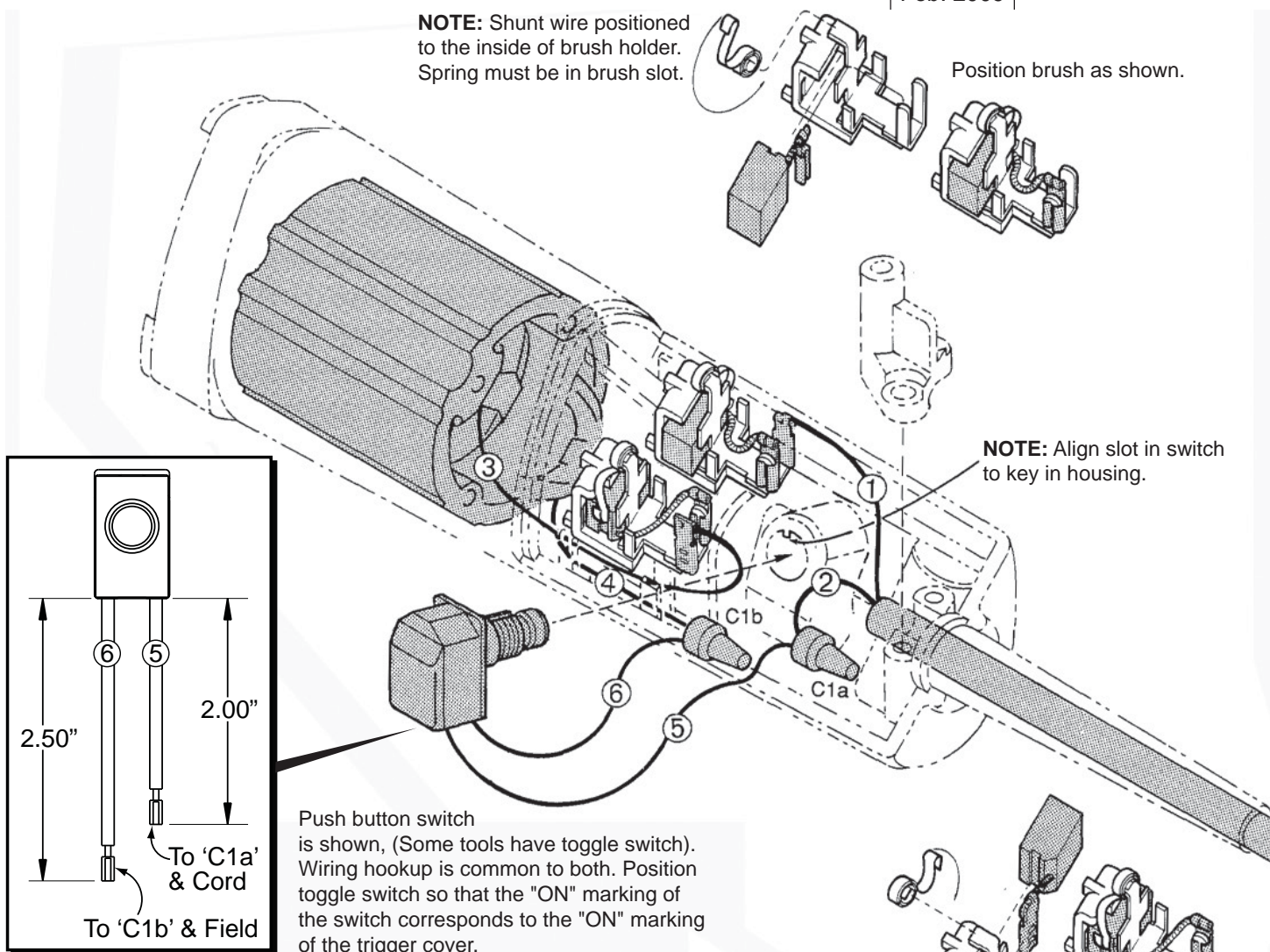

NOTE: Align slot in switch to key in housing.

Push button switch is shown, (Some tools have toggle switch). Wiring hookup is common to both. Position toggle switch so that the "ON" marking of the switch corresponds to the "ON" marking of the trigger cover.

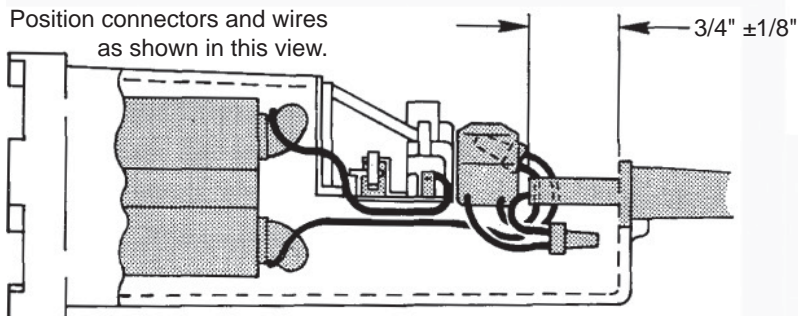

Brush shunt wire must be connected to the inside terminal post (both sides).

Lead wire insulation must be subflush to connectors. All strands must be in connectors.

WIRING SPECIFICATIONS

Wire No.	Wire Color	Origin or Part No.	Gauge	Length	Terminals, Connectors and End Wire Preparation
1	White	Cord	18	2"	Strip 5/32" for T1.
2	Black	Cord	18	2"	Strip 1/4" for C1a.
3	White	Field	18	4"	Strip 5/32" for T1.
4	Black	Field	18	6"	Strip 5/16" for C1b.
5	Black	Switch	18	2"	Strip 1/4" for C1a.
6	Black	Switch	18	2-1/2"	Strip 5/16" for C1b.

BULK LEAD WIRE - BULLETIN NO. 58-01-0003

NOTE:

All leads must be held to ± 1/8". All lead lengths are before stripping.

TERMINAL DESCRIPTION		
Code	Part No.	Qty.
T1	23-74-0755	2
CONNECTOR DESCRIPTION		
C1	22-56-0150	2

Drwg. 1