

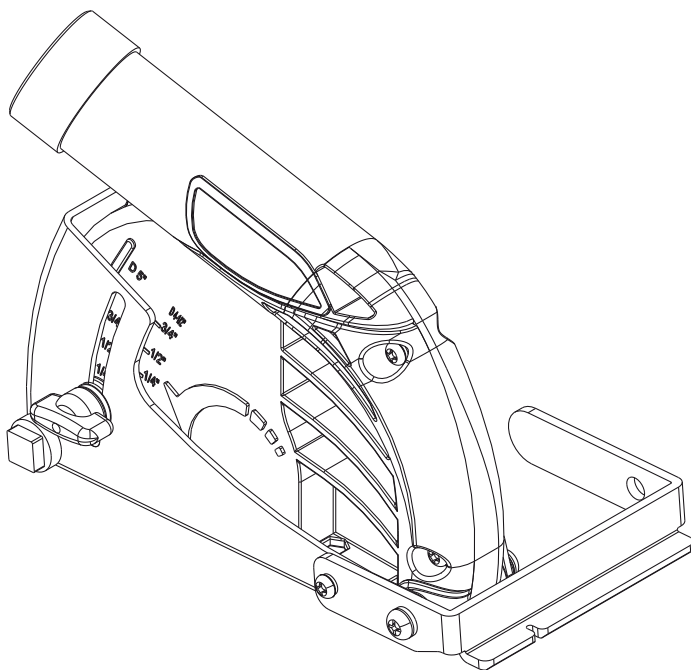

OPERATOR'S MANUAL



Cat. No.
49-40-6110

CUTTING DUST SHROUD



WARNING To reduce the risk of injury, user must read and understand operator's manual.

GENERAL SAFETY WARNINGS

WARNING WHEN USING THE CUTTING DUST SHROUD, BASIC PRECAUTIONS SHOULD ALWAYS BE FOLLOWED, INCLUDING THE FOLLOWING: READ THIS OPERATOR'S MANUAL, AS WELL AS YOUR TOOL AND VACUUM OPERATOR'S MANUALS, AND ALL LABELS ON THE SHROUD, TOOL, AND VACUUM. FOR HOUSEHOLD OR COMMERCIAL USE.

WORK AREA SAFETY

- Keep work area clean and well lit. Cluttered or dark areas invite accidents.
- Do not use in the presence of explosive dust, liquids or vapors.
- Do not use where oxygen or anesthetics are used.
- Do not allow to be used as a toy. Close attention is necessary when used by or near children.
- Use extra care when using on stairs.

ELECTRICAL SAFETY

- Do not pick up wet material. Do not use water to settle dust.

PERSONAL SAFETY

- **STAY ALERT.** Watch what you are doing and use common sense. Do not use dust extractor when you are tired, distracted or under the influence of drugs, alcohol or medication causing diminished control.
- The operation of a dust extractor can result in foreign objects being blown into eyes, which can result in eye damage. Always wear safety goggles or glasses with side shields when operating dust extractor.
- Wear a dust mask or use an OSHA compliant dust extraction solution when working in dusty situations. Dust particles can harm your lungs.
- Do not overreach. Keep proper footing and balance at all times. This enables better control of the dust extractor in unexpected situations.
- Keep hair, loose clothing, fingers, and all parts of body away from openings and moving parts.
- Use only as described in this manual. Use only manufacturer's recommended attachments.

USE AND CARE

- Do not use to pick up flammable or combustible liquids such as gasoline or use in areas where they may be present.
- Do not pick up anything that is burning or smoking such as cigarettes, matches, or hot ashes.
- Do not pick up soot, cement, plaster or drywall dust without filter in place. These are very fine particles that may affect the performance of the motor or be exhausted back into the air.
- This product is suitable for collection of silica dust when used in accordance with these instructions. To reduce the risk of health hazards from other vapors or dust, do not vacuum carcinogenic, toxic or hazardous materials such as asbestos, arsenic, barium, beryllium, lead, pesticides or other health endangered materials.

WARNING Some dust created by power sanding, sawing, grinding, drilling, and other construction activities contains chemicals known to cause cancer, birth defects or other reproductive harm. Some examples of these chemicals are:

- lead from lead-based paint
- crystalline silica from bricks and cement and other masonry products, and

- arsenic and chromium from chemically-treated lumber. Your risk from these exposures varies, depending on how often you do this type of work. To reduce your exposure to these chemicals: work in a well ventilated area, and work with approved safety equipment, such as those dust masks that are specially designed to filter out microscopic particles.
- Do not put any object into openings. Do not use with any opening blocked; keep free of dust, lint, hair, and anything else that may reduce air flow.
- Maintain dust extractor. Check for misalignment or binding of moving parts, breakage of parts and any other condition that may affect the dust extractor's operation. If damaged, have the dust extractor repaired before use. Many accidents are caused by poorly maintained tools.
- Maintain labels and nameplates. These carry important information. If unreadable or missing, contact a MILWAUKEE service facility for a free replacement.

SERVICE

- Have your power tool serviced by a qualified repair person using only identical replacement parts. This will ensure that the safety of the power tool is maintained.

SPECIFIC SAFETY RULES

- The cutting dust shroud is compliant with Table 1 of OSHA Standard 29CFR 1926.1153 assuming (1) it is used in accordance with MILWAUKEE instructions; (2) it is attached to a dust collector that has a filter with 99% or greater efficiency and a filter-cleaning mechanism; and (3) the dust collector has above 125 CFM.
- Before using the cutting dust shroud, read this operator's manual, your tool and vacuum manuals, and all labels on the shroud, tool, and vacuum.
- Wear ear protectors. Exposure to noise can cause hearing loss.
- Hold power tool by insulated gripping surfaces, when performing an operation where the cutting accessory may contact hidden wiring. Cutting accessories contacting a "live" wire may make exposed metal parts of the power tool "live" and could give the operator an electric shock.
- Only install diamond abrasive wheels according to instructions. Flap discs and resin bonded grinding wheels are not acceptable for this shroud.

READ AND SAVE ALL INSTRUCTIONS FOR FUTURE USE

SPECIFICATIONS

Cat. No.	49-40-6110
Vacuum Port Outer Diameter	1-7/16"
Vacuum Port Inner Diameter	1-1/8"
Adaptor Outer Diameter	1-3/4"
Adaptor Inner Diameter	1-1/2"
Cutting Wheel Capacity	4-1/2" or 5"

NOTE: For grinder model compatibility, see Assembly instructions regarding the collar design. The shroud will not work on grinders that do not have the same spindle collar design.

ASSEMBLY

⚠WARNING Use only recommended diamond abrasive wheels. Other accessories may be hazardous.

Attaching the Shroud

1. Unplug or remove the battery pack from the grinder.
2. Remove the side handle, all accessories and the grinder guard.

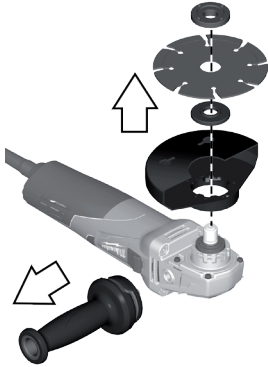

3. Turn the shroud knob to open the shroud and expose the collar.

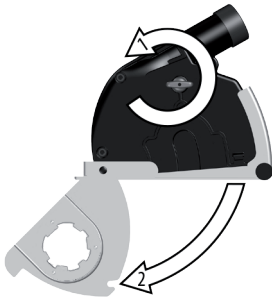

4. Place the collar on the grinder spindle. Make sure it aligns properly. Install according to the guard assembly instructions in the tool manual.

NOTE: The shroud will not work on grinders that do not have the same spindle collar design.

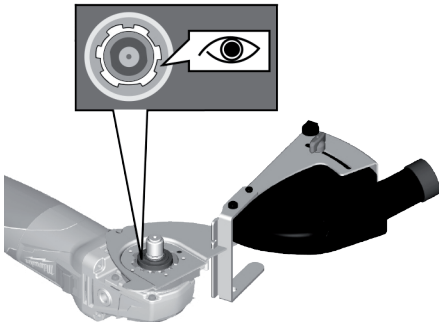

5. **WARNING!** Always adjust the guard to provide the operator with maximum protection while operating. See tool manual for reference. Select the proper cutting angle for the application.
6. **WARNING!** Only install diamond abrasive wheels according to instructions. Flap discs and resin bonded grinding wheels are not acceptable for this shroud. Install the applicable diamond abrasive wheel according to the instructions in the tool manual.
7. Close the wheel cover and tighten the shroud knob securely.

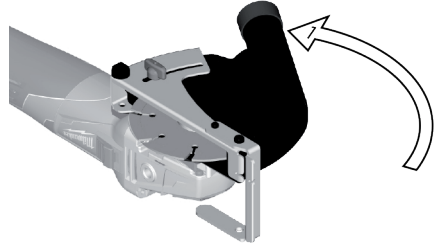

8. Adjust the depth gauge for the chosen depth of cut.
9. Reinstall the grinder side handle. **WARNING!** Do not use the grinder without the side handle installed.
10. Attach the hose clip adaptor and dust extractor hose to the shroud.

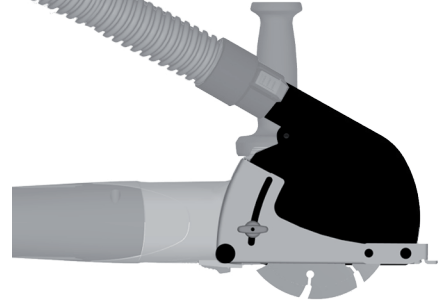

OPERATION

⚠WARNING To reduce the risk of fire and injury, do not use to pick up flammable or combustible materials. Empty dust box completely before use.

To reduce the risk of injury, wear safety goggles or glasses with side shields.

To reduce the risk of injury, wear a dust mask or use an OSHA compliant dust extraction solution.

Before using the cutting dust shroud, read this operator's manual, your tool and vacuum manuals, and all labels on the shroud, tool, and vacuum.

1. Turn the dust extractor to "automatic-cleaning" mode.
2. Align the shroud so that it is flush with the material and begin the cut.

NOTE: Operate on concrete, brick, or tile surfaces only. Do not operate on wood or metal surfaces.

MAINTENANCE

⚠WARNING To reduce the risk of injury, always unplug the tool before performing any maintenance. Never disassemble the tool. Contact a MILWAUKEE service facility for ALL repairs.

Maintaining Tools

Keep your tool in good repair by adopting a regular maintenance program. Inspect your tool for issues such as undue noise, misalignment or binding of moving parts, breakage of parts, or any other condition that may affect the tool operation. Return the tool to a MILWAUKEE service facility for repair. After six months to one year, depending on use, return the tool to a MILWAUKEE service facility for inspection.

⚠WARNING To reduce the risk of personal injury, electric shock and damage, never immerse your tool in liquid or allow a liquid to flow inside it.

Cleaning

Clean dust and debris from vents. Keep handles clean, dry and free of oil or grease. Use only mild soap and a damp cloth to clean, since certain cleaning agents and solvents are harmful to plastics and other insulated parts. Some of these include gasoline, turpentine, lacquer thinner, paint thinner, chlorinated cleaning solvents, ammonia and household detergents containing ammonia. Never use flammable or combustible solvents around tools.

Repairs

For repairs, return the tool to the nearest service center.