

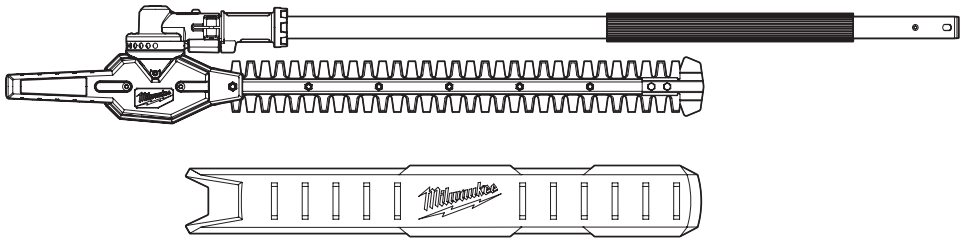

OPERATOR'S MANUAL



Cat. No.
49-16-2719

M18 FUEL™ ARTICULATING HEDGE TRIMMER ATTACHMENT W/ QUIK-LOK™



WARNING To reduce the risk of injury, user must read and understand operator's manual.

GENERAL POWER TOOL SAFETY WARNINGS

⚠WARNING Read all safety warnings, instructions, illustrations and specifications provided with this power tool. Failure to follow all instructions listed below may result in electric shock, fire and/or serious injury. **Save all warnings and instructions for future reference.** The term "power tool" in the warnings refers to your mains-operated (corded) power tool or battery-operated (cordless) power tool.

WORK AREA SAFETY

- **Keep work area clean and well lit.** Cluttered or dark areas invite accidents.
- **Do not operate power tools in explosive atmospheres, such as in the presence of flammable liquids, gases or dust.** Power tools create sparks which may ignite the dust or fumes.
- **Keep children and bystanders away while operating a power tool.** Distractions can cause you to lose control.

ELECTRICAL SAFETY

- **Power tool plugs must match the outlet. Never modify the plug in any way. Do not use any adapter plugs with earthed (grounded) power tools.** Unmodified plugs and matching outlets will reduce risk of electric shock.
- **Avoid body contact with earthed or grounded surfaces, such as pipes, radiators, ranges and refrigerators.** There is an increased risk of electric shock if your body is earthed or grounded.
- **Do not expose power tools to rain or wet conditions.** Water entering a power tool will increase the risk of electric shock.
- **Do not abuse the cord. Never use the cord for carrying, pulling or unplugging the power tool. Keep cord away from heat, oil, sharp edges or moving parts.** Damaged or entangled cords increase the risk of electric shock.
- **When operating a power tool outdoors, use an extension cord suitable for outdoor use.** Use of a cord suitable for outdoor use reduces the risk of electric shock.
- **If operating a power tool in a damp location is unavoidable, use a ground fault circuit interrupter (GFCI) protected supply.** Use of an GFCI reduces the risk of electric shock.

PERSONAL SAFETY

- **Stay alert, watch what you are doing and use common sense when operating a power tool. Do not use a power tool while you are tired or under the influence of drugs, alcohol or medication.** A moment of inattention while operating power tools may result in serious personal injury.
- **Use personal protective equipment. Always wear eye protection.** Protective equipment such as a dust mask, non-skid safety shoes, hard hat or hearing protection used for appropriate conditions will reduce personal injuries.
- **Prevent unintentional starting. Ensure the switch is in the off-position before connecting to power source and/or battery pack, picking up or carrying the tool.** Carrying power tools with your finger on the switch or energizing power tools that have the switch on invites accidents.
- **Remove any adjusting key or wrench before turning the power tool on.** A wrench or a key left

attached to a rotating part of the power tool may result in personal injury.

- **Do not overreach. Keep proper footing and balance at all times.** This enables better control of the power tool in unexpected situations.
- **Dress properly. Do not wear loose clothing or jewelry. Keep your hair and clothing away from moving parts.** Loose clothes, jewelry or long hair can be caught in moving parts.
- **If devices are provided for the connection of dust extraction and collection facilities, ensure these are connected and properly used.** Use of dust collection can reduce dust-related hazards.
- **Do not let familiarity gained from frequent use of tools allow you to become complacent and ignore tool safety principles.** A careless action can cause severe injury within a fraction of a second.

POWER TOOL USE AND CARE

- **Do not force the power tool. Use the correct power tool for your application.** The correct power tool will do the job better and safer at the rate for which it was designed.
- **Do not use the power tool if the switch does not turn it on and off.** Any power tool that cannot be controlled with the switch is dangerous and must be repaired.
- **Disconnect the plug from the power source and/or remove the battery pack, if detachable, from the power tool before making any adjustments, changing accessories, or storing power tools.** Such preventive safety measures reduce the risk of starting the power tool accidentally.
- **Store idle power tools out of the reach of children and do not allow persons unfamiliar with the power tool or these instructions to operate the power tool.** Power tools are dangerous in the hands of untrained users.
- **Maintain power tools and accessories. Check for misalignment or binding of moving parts, breakage of parts and any other condition that may affect the power tool's operation. If damaged, have the power tool repaired before use.** Many accidents are caused by poorly maintained power tools.
- **Keep cutting tools sharp and clean.** Properly maintained cutting tools with sharp cutting edges are less likely to bind and are easier to control.
- **Use the power tool, accessories and tool bits etc. in accordance with these instructions, taking into account the working conditions and the work to be performed.** Use of the power tool for operations different from those intended could result in a hazardous situation.
- **Keep handles and grasping surfaces dry, clean and free from oil and grease.** Slippery handles and grasping surfaces do not allow for safe handling and control of the tool in unexpected situations.

BATTERY TOOL USE AND CARE

- **Recharge only with the charger specified by the manufacturer.** A charger that is suitable for one type of battery pack may create a risk of fire when used with another battery pack.
- **Use power tools only with specifically designated battery packs.** Use of any other battery packs may create a risk of injury and fire.
- **When battery pack is not in use, keep it away from other metal objects, like paper clips, coins, keys, nails, screws or other small metal objects,**

that can make a connection from one terminal to another. Shorting the battery terminals together may cause burns or a fire.

- **Under abusive conditions, liquid may be ejected from the battery; avoid contact. If contact accidentally occurs, flush with water. If liquid contacts eyes, additionally seek medical help.** Liquid ejected from the battery may cause irritation or burns.
- **Do not use a battery pack or tool that is damaged or modified.** Damaged or modified batteries may exhibit unpredictable behavior resulting in fire, explosion or risk of injury.
- **Do not expose a battery pack or tool to fire or excessive temperature.** Exposure to fire or temperature above 265°F (130°C) may cause explosion.
- **Follow all charging instructions and do not charge the battery pack or tool outside the temperature range specified in the instructions.** Charging improperly or at temperatures outside the specified range may damage the battery and increase the risk of fire.

SERVICE

- **Have your power tool serviced by a qualified repair person using only identical replacement parts.** This will ensure that the safety of the power tool is maintained.
- **Never service damaged battery packs.** Service of battery packs should only be performed by the manufacturer or authorized service providers.

SPECIFIC SAFETY RULES FOR HEDGE TRIMMERS

Hedge trimmer safety warnings:

- **Keep all parts of the body away from the blade. Do not remove cut material or hold material to be cut when blades are moving.** Blades continue to move after the switch is turned off. A moment of inattention while operating the hedge trimmer may result in serious personal injury.
- **Carry the hedge trimmer by the handle with the blade stopped and taking care not to operate any power switch.** Proper carrying of the hedge trimmer will decrease the risk of inadvertent starting and resultant personal injury from the blades.
- **When transporting or storing the hedge trimmer, always fit the blade cover.** Proper handling of the hedge trimmer will decrease the risk of personal injury from the blades.
- **When clearing jammed material or servicing the unit, make sure all power switches are off and the battery pack is removed or disconnected.** Unexpected actuation of the hedge trimmer while clearing jammed material or servicing may result in serious personal injury.
- **Hold the hedge trimmer by insulated gripping surfaces only, because the blade may contact hidden wiring.** Blades contacting a "live" wire may make exposed metal parts of the hedge trimmer "live" and could give the operator an electric shock.
- **Keep all power cords and cables away from cutting area.** Power cords or cables may be hidden in hedges or bushes and can be accidentally cut by the blade.
- **Do not use the hedge trimmer in bad weather conditions, especially when there is a risk of lightning.** This decreases the risk of being struck by lightning.

• **To reduce the risk of electrocution, never use the extended-reach hedge trimmer near any electrical power lines.** Contact with or use near power lines may cause serious injury or electric shock resulting in death.

• **Always use two hands when operating the extended-reach hedge trimmer.** Hold the extended-reach hedge trimmer with both hands to avoid loss of control.

• **Always use head protection when operating the extended-reach hedge trimmer overhead.** Falling debris can result in serious personal injury.

• **Do not use tool while standing on a ladder, rooftop, or unstable support.** Stable footing on a solid surface enables better control of the tool in unexpected situations.

• **Before starting the tool check the work area for hidden objects, such as wire fencing, posts, etc.** Striking a solid object could cause loss of control and serious personal injury.

• **Lock all adjustments before use.**

• **Before use, read this manual, and all manuals and labels of this tool and its power head. Failure to follow the warnings and instructions may result in serious injury. Use tool only as described in this manual. Use only attachments recommended by MILWAUKEE.**

• **Always wear eye, hearing, and head protection, and protective clothing and footwear, according to the operation being performed. Wear heavy, long pants, long sleeves, boots, and gloves. Contain long hair. Do not wear loose clothing or jewelry. Do not wear short pants, sandals, or go barefoot.**

• **Keep bystanders at least 50' away during use.**

• **⚠ WARNING Do not operate near electric power lines.** The unit has not been designed to provide protection from electric shock in the event of contact with electric power lines. Consult local regulations for safe distances from electric power lines and ensure that the operating position is safe and secure before use.

• **Do not extend tool by more than one attachment extension.** Additional attachment extensions will make the pole unstable and difficult to control, which could result in injury.

• **When using this attachment with larger-capacity battery packs, use the shoulder strap to reduce user fatigue and help in maintaining control of the tool during use.**

• **Do not operate the tool without the front handle in place. The front handle must be attached properly during use. Use both hands when operating the tool, according to the attachment instructions. Maintain a firm grip.** Using one hand could cause loss of control and result in serious injury.

• **Before starting the tool, make sure the blade is not contacting anything.** A moment of inattention while operating may cause entanglement of clothing or body with the blade.

• **Before setting down the tool, turn the switch off, ensure the blade has stopped, and remove the battery pack.**

• **Always turn off the tool when transporting from one location to another.** Do not carry tool with finger on the trigger. Accidental starting can cause serious personal injury.

• **Do not immerse in water or spray with a hose. Do not clean with a pressure washer.** Water entering a power tool will increase the risk of electric shock. Store tool indoors.

• **Do not store the power tool on or near to fertilizers or chemicals.**

• **Always turn off the tool and then remove battery**

pack before changing or removing accessories, between jobs, or when storing the tool.

- Use only recommended accessories. Others may be hazardous.

- Maintain the unit with care. Keep the cutting edge sharp and clean for best performance and to reduce the risk of injury. Follow instructions for lubricating and changing accessories. Follow the sharpening and maintenance instructions for the blade. Clean off trimmings and debris before storing.

Other Safety Rules.

- Keep ALL children, bystanders, visitors, and animals out of the work area while starting or cutting with the tool.

- Dress Properly - Wear snug fitting clothing. Always wear heavy, long pants, long sleeves, overalls, jeans or chaps made of cut resistant material or ones that contain cut resistant inserts. Wear non-slip safety footwear. Wear non-slip heavy duty gloves to improve your grip and to protect your hands. Do not wear jewelry, short pants, sandals, or go barefoot. Do not wear loose fitting clothing, which could be drawn into the motor or catch the blade or underbrush. Secure hair so it is above shoulder level. Wear hearing and head protection.

- Heavy protective clothing may increase operator fatigue, which could lead to heat stroke. During weather that is hot and humid, heavy work should be scheduled for early morning or late afternoon hours when temperatures are cooler.

- Always be aware of what you are doing when using the tool. Use common sense. Do not operate the tool when you are tired, ill, or under the influence of alcohol, drugs, or medication.

- Never let anyone use your tool who has not received adequate instructions in its proper use. This applies to rentals as well as privately owned tools.

- Replace any blade that has been damaged. Always make sure blade is installed correctly and securely fastened before each use. Failure to do so can cause serious injury.

- Never cut any material with a diameter larger than 1". The tool may stall or kickback, causing a risk of injury.

- Always use common sense and be cautious when using tools. It is not possible to anticipate every situation that could result in a dangerous outcome. Do not use this tool if you do not understand these operating instructions or you feel the work is beyond your capability; contact Milwaukee Tool or a trained professional for additional information or training.

- Maintain labels and nameplates. These carry important information. If unreadable or missing, contact a MILWAUKEE service facility for a free replacement.

- ⚠WARNING** Some dust created by power sanding, sawing, grinding, drilling, and other construction activities contains chemicals known to cause cancer, birth defects or other reproductive harm. Some examples of these chemicals are:

- lead from lead-based paint

- crystalline silica from bricks and cement and other masonry products, and

- arsenic and chromium from chemically-treated lumber. Your risk from these exposures varies, depending on how often you do this type of work. To reduce your exposure to these chemicals: work in a well ventilated area, and work with approved safety equipment, such as those dust masks that are specially designed to filter out microscopic particles.

READ AND SAVE ALL INSTRUCTIONS FOR FUTURE USE

FUNCTIONAL DESCRIPTION

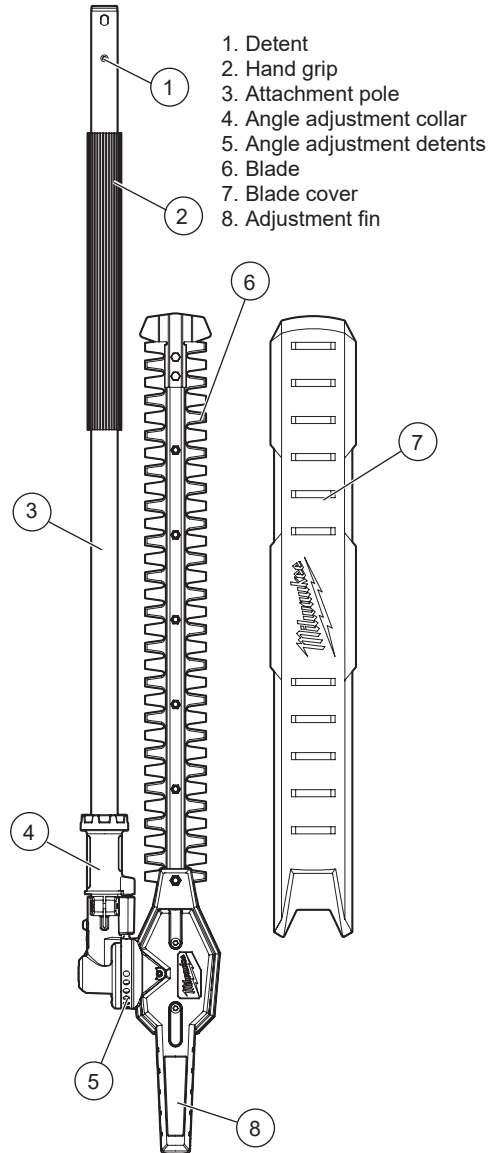

SPECIFICATIONS

Cat. No.	49-16-2719
Power Head	2825-20
SPM	0 - 3500
Blade Length	20"
Cutting Capacity (diameter)	1"
Replacement Blades	Cat. No. 42-26-2719

SYMBOLOLOGY

	Volts
	Direct Current
n_0 XXXX min ⁻¹	No Load Strokes per Minute (SPM)
	Safety Alert Symbol
	Read operator's manual
	Wear eye, hearing, and head protection
	Wear non-slip safety footwear
	Wear protective gloves
	Keep tool at least 50' away from electric power lines.
	Keep bystanders at least 50' away during use.
	▲ DANGER Avoid blade contact during use
	UL Listing for Canada and U.S.

ASSEMBLY

WARNING Before use, read manual and labels of the power head. Important assembly and use instructions are provided in the power head manual. Connect the attachment to the power head in accordance with the power head manual.

Always remove battery pack before changing or removing accessories.

Attaching the Shoulder Strap (Available as an accessory)

When using this attachment with larger-capacity battery packs, use the shoulder strap to reduce user fatigue and help in maintaining control of the tool during use.

To **install** the strap:

1. Remove the battery pack.
2. Fit the pole clip around the power head pole between the front handle and rear handle in a location comfortable during use.
3. Insert the bolt through the pole clip and strap bevel. Thread the nut onto the bolt and tighten securely.
4. Clip the strap carabiner to the bevel.

To **wear** the strap:

1. Put your right arm and head through the strap.
2. Adjust the strap clips to change the strap length to fit comfortably.
3. Slide the neck pad to the appropriate position.

To **unclip** the strap:

1. Hold the tool by the front handle with your left hand.
2. Grip the carabiner with your right hand and unclip by pushing in the gate and it sliding off the bevel.

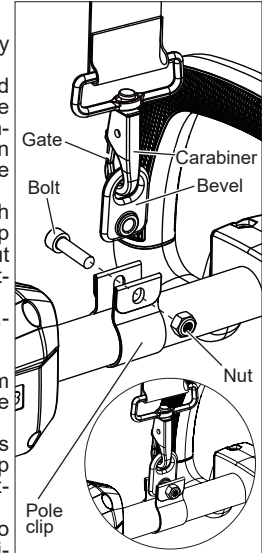

Quik-Lok™ System Extension Attachment (Available as an accessory)

Do not extend tool by more than one extension attachment. Additional extension attachments will make the pole unstable and difficult to control, which could result in injury.

To **install** an attachment or extension:

1. Remove battery pack.
2. Loosen the lock knob.
3. Slide the pole into the Quik-Lok™ latch. The dent on the pole should line up with the slot in the Quik-Lok™ latch.
4. Push the sections together securely. Tug on the poles to ensure they are secure.

5. Tighten the lock knob.

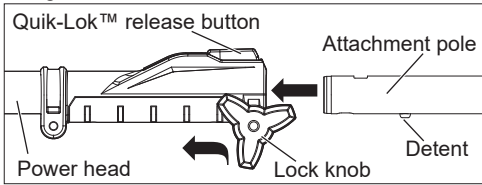

To **remove** an attachment or extension:

1. Remove battery pack.
2. Loosen the lock knob.
3. Push in the Quik-Lok™ release button and pull the poles apart.

Selecting the Speed

When using this attachment, only HIGH SPEED is recommended. Use the speed control button to select HIGH SPEED.



WARNING Always remove battery pack before making adjustments. Check all adjustments are locked into place before each use. Never run the tool when the blade is in the storage position.

Adjusting the Trimming Angle

Depending on the work, adjust the trimming angle from 90° to 270°.

To adjust the angle:

1. Remove the battery pack.
2. Pull the angle adjustment collar back toward the power head.
3. Grasp the adjustment fin and rotate the trimmer head to the desired angle.
4. Release the adjustment collar.
5. Rotate the head slightly to ensure the pin engaged the detent.
6. When work is complete, return the trimmer head to the storage position and install the blade cover.

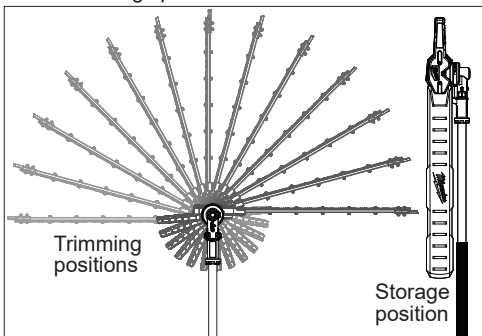

WARNING Carry the tool by the front handle to avoid accidental starting. Proper handling of the tool will prevent injury. Always turn off the tool when transporting from one location to another. Do not carry tool with finger on the trigger. Accidental starting can cause serious personal injury.

Blade Cover

Always place the blade cover over the blade before moving from one job to another, storing or transporting the tool. **WARNING!** Blade is sharp. Keep hands and body away from blade.

1. Remove battery pack.
2. Slide the blade cover over the blade. It may be necessary to push with some force as blade cover reaches the front guard.
3. To remove, pull blade cover off of blade. It may be necessary to pull with some force until cover clears the detent near the guard.

WARNING To reduce the risk of injury, always remove the battery pack from the tool before lubricating.

Lubricating the Blade

To extend cutting life, lubricate the trimmer blades before and after each use and before storing.

1. Remove the battery pack.
2. Apply a lightweight machine oil along both sides of the top blade.

OPERATION

⚠ DANGER Never cut near power lines, electric cords, or other electric sources. If blades jams on any electrical cord or line, DO NOT TOUCH THE BLADES! THEY CAN BECOME ELECTRICALLY LIVE AND VERY DANGEROUS. Continue to hold the tool by the insulated rear handle or lay it down and away from you in a safe manner. Disconnect the electrical service to the damaged line or cord before attempting to free the tool from the line or cord. Contact with the blades other conductive parts of the tool or live electric cords or lines will result in death by electrocution, electric shock, or serious personal injury.



WARNING Read and understand all instructions. Failure to follow all instructions listed below may result in electric shock, fire and/or serious personal injury.

- Always wear eye protection with side shield, as well as head and hearing protection. Failure to do so could result in objects being thrown into your eyes and other possible serious injuries.
- Do not overreach. Do not cut with right hand holding tool above chest height. Make sure your footing is firm. Keep feet apart. Divide your weight evenly on both feet.
- Do not allow familiarity with this product to make you careless. Remember that a careless fraction of a second is sufficient to inflict serious injury.
- Use a firm grip with your left hand on the front handle and your right hand on the rear handle so that your body is to the left of the guide bar.
- Never use a cross-handed grip (left hand on the rear handles and right hand on the front handle).
- Never operate while in a tree, in any awkward position or on a ladder or other unstable surface. You may lose control of tool causing severe injury.
- Keep the tool running at full speed the entire time you are cutting.
- Allow the blades to cut for you. Exert only light pressure. Do not put pressure on tool at end of cut.

- When not in use always remove the battery.
- Do not use any attachments or accessories not recommended by the manufacturer. The use of attachments or accessories not recommended can result in serious personal injury.
- Wear non-slip gloves for maximum grip and protection.
- Do not operate the tool without the front handle in place. The front handle must be attached properly for use. Using one hand could cause loss of control and result in serious injury.
- Always keep both hands on the tool handles. Do not remove cut material or hold material to be cut when blades are moving.
- Clear the area to be cut before each use. Remove all objects such as cords, lights, wire, or string which can become entangled in the cutting blade.
- Never attempt to lock the trigger in the ON position.

Trimming

1. Set the desired angle for trimming.
2. Remove the blade cover. **WARNING!** Always remove the blade cover before use.
3. Insert the battery pack.
4. Hold the front and trigger handles securely. **WARNING!** Blade is sharp. Keep hands and body away from blade.
5. To **start** the tool, squeeze the lock-off lever and pull the trigger.
6. Allow tool to come to full speed before contacting workpiece.
7. To **vary** the speed, increase or decrease the pressure on the trigger. The further the trigger is pulled, the greater the speed up to the maximum set by the speed control button.
8. To **stop** the tool release the trigger. Make sure the tool comes to a complete stop before laying the tool down.

Cutting Tips

- The tool can be held in multiple orientations depending on the grip used. Keep your right hand on the trigger handle and grip either the front handle or pole hand grip with your left hand. To increase control, always hold the tool using the hand grip when using the attachment extension.
- Use a sweeping, back and forth motion, moving down or across the work.
- Move the tool at a slower pace when cutting thicker branches. Do not force the tool. The blade will slow and could bind.
- Do not cut branches with a diameter greater than 3/4". Use a Sawzall® or Hackzall® reciprocating saw with a pruning blade for thicker branches.
- If blades jam, stop the tool and remove the battery pack. **WARNING!** Use caution when removing debris from the blades.
- For straight cuts, stretch a string along the work area just below the desired cut height. Use the string as a guide when cutting. Hold the tool at a 0° to 10° angle when cutting a flat top.
- Do not trim trees near electrical wires or buildings. Leave this operation for professionals.
- Cut only when visibility and light are adequate for you to see clearly.
- Check work area for hazards such as bees, rodents, snakes, etc., that may live in brush.

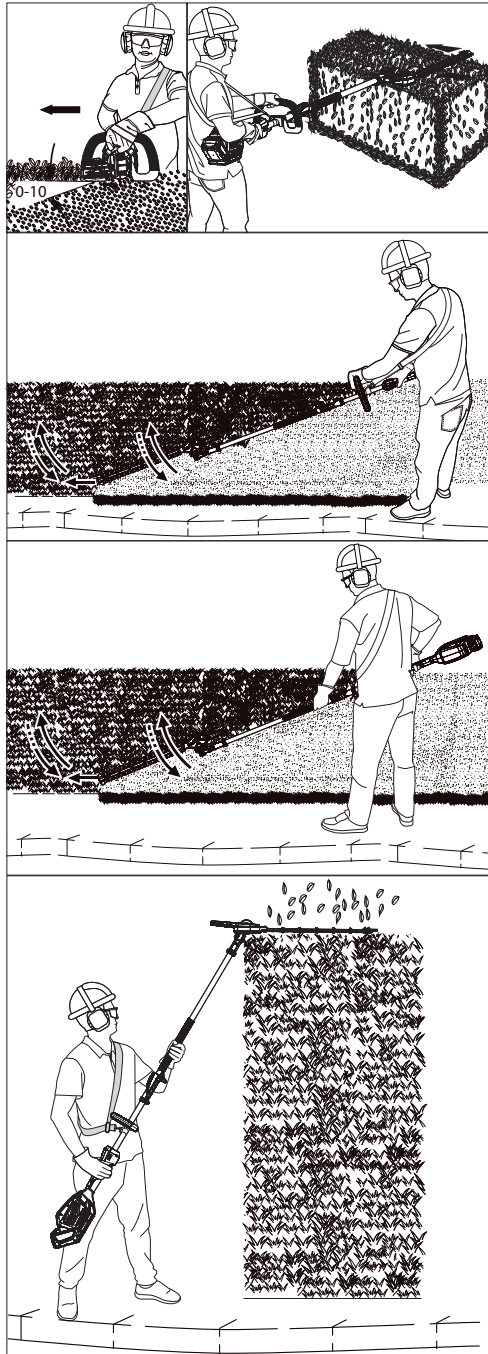

MAINTENANCE

⚠WARNING To reduce the risk of injury, always unplug the charger and remove the battery pack from the charger or tool before performing any maintenance. Never disassemble the tool, battery pack or charger. Contact a MILWAUKEE service facility for ALL repairs.

Maintaining Tool

Keep your tool, battery pack and charger in good repair by adopting a regular maintenance program. Inspect your tool for issues such as undue noise, misalignment or binding of moving parts, breakage of parts, or any other condition that may affect the tool operation. Return the tool, battery pack, and charger to a MILWAUKEE service facility for repair. After six months to one year, depending on use, return the tool, battery pack and charger to a MILWAUKEE service facility for inspection.

If the tool does not start or operate at full power with a fully charged battery pack, clean the contacts on the battery pack. If the tool still does not work properly, return the tool, charger and battery pack, to a MILWAUKEE service facility for repairs.

Sharpening Blade

1. Stop the tool so the teeth appear in an offset position (see picture).
2. Remove the battery pack from the tool.
3. Secure the blade in a vise and file the exposed cutting surface of each cutting blade tooth with a file. Do not change the cutting angle of the cutting teeth.
4. To sharpen the other side of the teeth, restart the tool to offset the teeth in the opposite position. Remove the battery pack before re-securing in the vise.

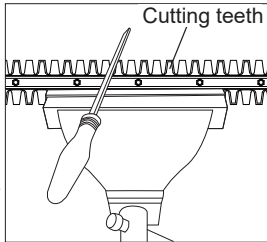

⚠WARNING To reduce the risk of personal injury and damage, never immerse your tool, battery pack or charger in liquid or allow a liquid to flow inside them.

Cleaning

Clean dust and debris from vents. Keep handles clean, dry and free of oil or grease. Use only mild soap and a damp cloth to clean, since certain cleaning agents and solvents are harmful to plastics and other insulated parts. Some of these include gasoline, turpentine, lacquer thinner, paint thinner, chlorinated cleaning solvents, ammonia and household detergents containing ammonia. Never use flammable or combustible solvents around tools.

Repairs

For repairs, return the tool, battery pack and charger to the nearest service center.

ACCESSORIES

⚠WARNING Use only recommended accessories. Others may be hazardous.