



# SERVICE PARTS LIST

**BULLETIN NO.**  
**54-04-7010**

SPECIFY CATALOG NO. AND SERIAL NO. WHEN ORDERING PARTS			REVISED BULLETIN	DATE
<b>28 VOLT BATTERY</b>				Feb. 2007
<b>CATALOG NO.</b>	<b>48-11-2830</b>	<b>SERIAL NUMBER</b>	<b>A71A, A71B, A71C, A71D</b>	
			WIRING INSTRUCTION	

**EXAMPLE:**

00 | 0

Component Parts (Small #)  
Are Included When Ordering  
The Assembly (Large #).

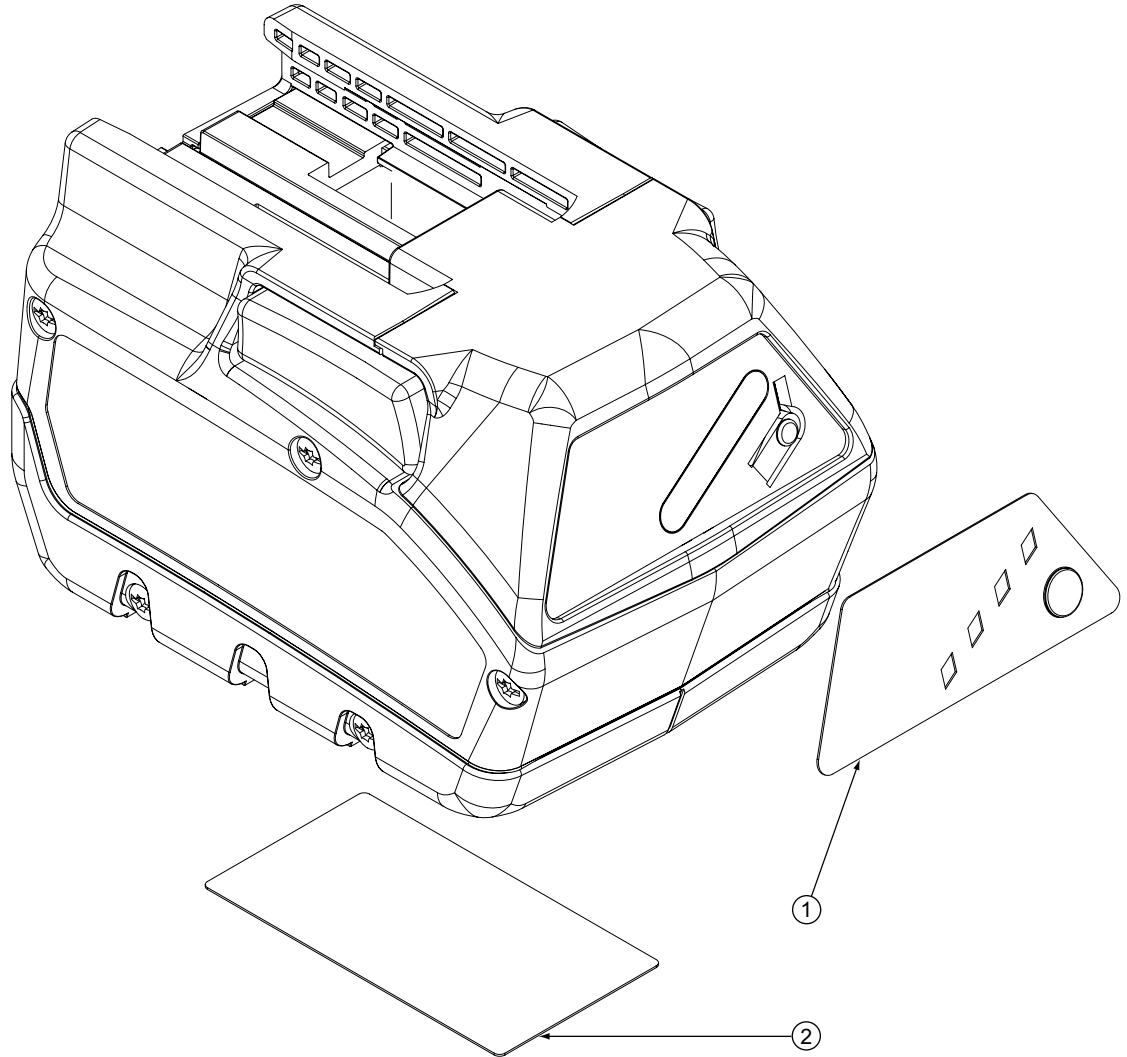

FIG.	PART NO.	DESCRIPTION OF PART	NO. REQ.
1	10-20-3620	Front Label	(1)
2	10-15-1290	Service Nameplate	(1)

**FIG. NOTES**  
1, 2 A clean, dry surface is essential for proper performance for any adhesive system. The area intended for application of any adhesive label or nameplate must be prepared by cleaning with isopropyl alcohol. The solvent is to be applied with a clean, lint free applicator and the surface allowed to dry before applying the label or nameplate.



# SERVICE PARTS LIST

**BULLETIN NO.**  
**54-04-7011**

SPECIFY CATALOG NO. AND SERIAL NO. WHEN ORDERING PARTS			REVISED BULLETIN	DATE
<b>M28 BATTERY</b>			54-04-7010	Sept. 2010
<b>CATALOG NO.</b>	<b>48-11-2830</b>	<b>SERIAL NUMBER</b>	<b>C71E</b>	
WIRING INSTRUCTION				

**EXAMPLE:**

00	0
----	---

Component Parts (Small #)  
Are Included When Ordering  
The Assembly (Large #).

**NOTE:** Some battery nameplates were stamped with a serial number prefix and break of **C48A**.

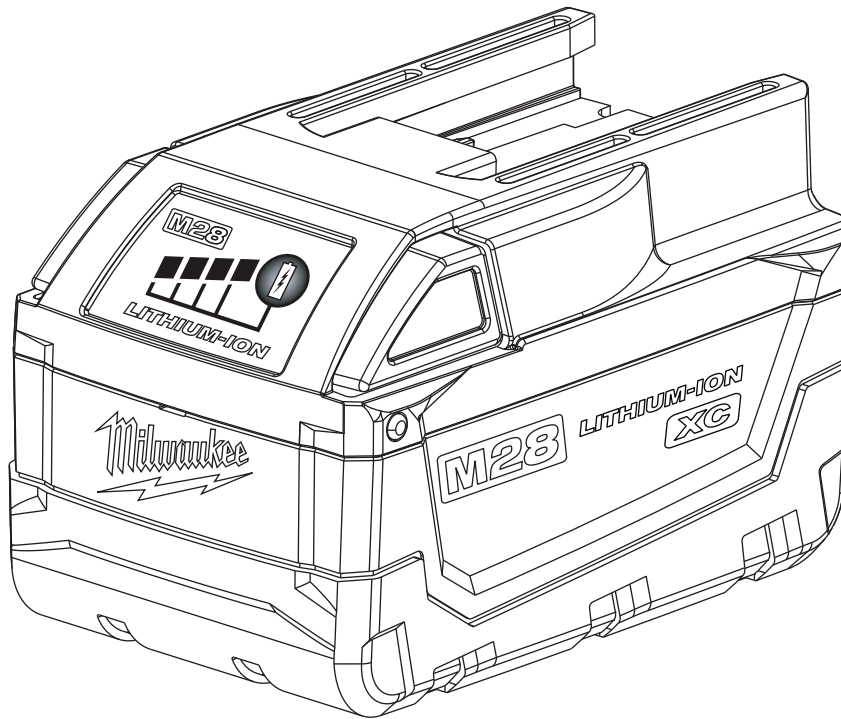

FIG.	PART NO.	DESCRIPTION OF PART	NO. REQ.
1	10-20-4550	Fuel Gauge Label (Front of tool)	(1)
2	12-20-2900	Service Nameplate (Bottom of tool)	(1)

**FIG. 1, 2 NOTES**  
A clean, dry surface is essential for proper performance for any adhesive system. The area intended for application of any adhesive label or nameplate must be prepared by cleaning with isopropyl alcohol. The solvent is to be applied with a clean, lint free applicator and the surface allowed to dry before applying the label or name plate.



# SERVICE PARTS LIST

**BULLETIN NO.**  
**54-04-7012**

SPECIFY CATALOG NO. AND SERIAL NO. WHEN ORDERING PARTS			REVISED BULLETIN	DATE
<b>M28 BATTERY</b>			54-04-7011	Nov. 2010
<b>CATALOG NO.</b>	<b>48-11-2830</b>	<b>SERIAL NUMBER</b>	<b>C71F</b>	
WIRING INSTRUCTION				

**EXAMPLE:**

00	0
----	---

Component Parts (Small #)  
Are Included When Ordering  
The Assembly (Large #).

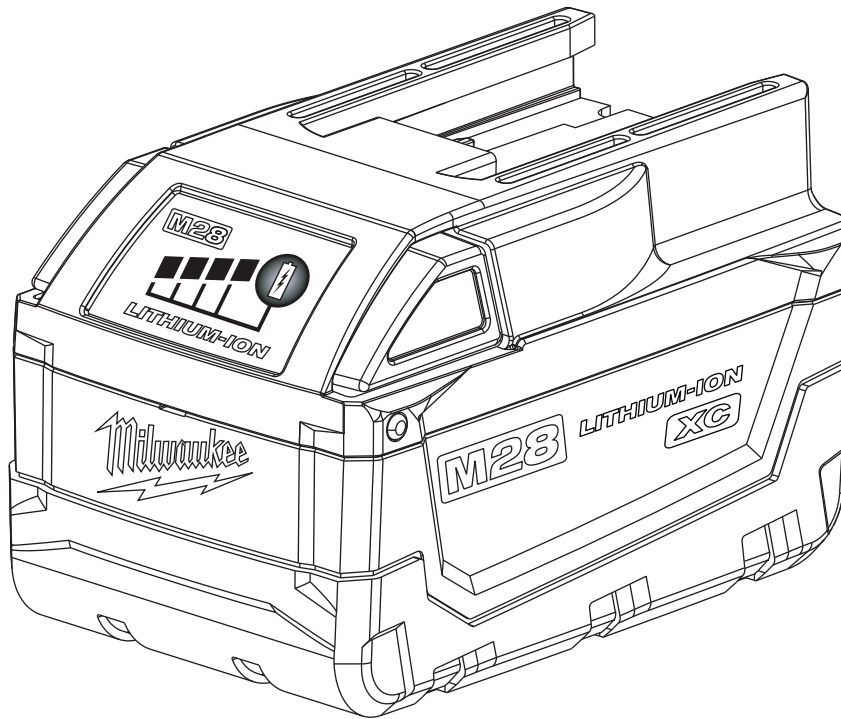

FIG.	PART NO.	DESCRIPTION OF PART	NO. REQ.
1	10-20-4550	Fuel Gauge Label (Front of tool)	(1)
2	12-20-2900	Service Nameplate (Bottom of tool)	(1)

**FIG. 1, 2** **NOTES**  
A clean, dry surface is essential for proper performance for any adhesive system. The area intended for application of any adhesive label or nameplate must be prepared by cleaning with isopropyl alcohol. The solvent is to be applied with a clean, lint free applicator and the surface allowed to dry before applying the label or name plate.