



SERVICE PARTS LIST

BULLETIN NO.
54-04-1820

SPECIFY CATALOG NO. AND SERIAL NO. WHEN ORDERING PARTS		REVISED BULLETIN	DATE
M18™ BATTERY			Apr. 2019
CATALOG NO. 48-11-1812, 48-11-1815, 48-11-1820, 48-11-1828, 48-11-1835, 48-11-1840, 48-11-1850, 48-11-1860, 48-11-1865, 48-11-1880, 48-11-1890		WIRING INSTRUCTION	

EXAMPLE:
Component Parts (Small #) Are Included
When Ordering The Assembly (Large #).

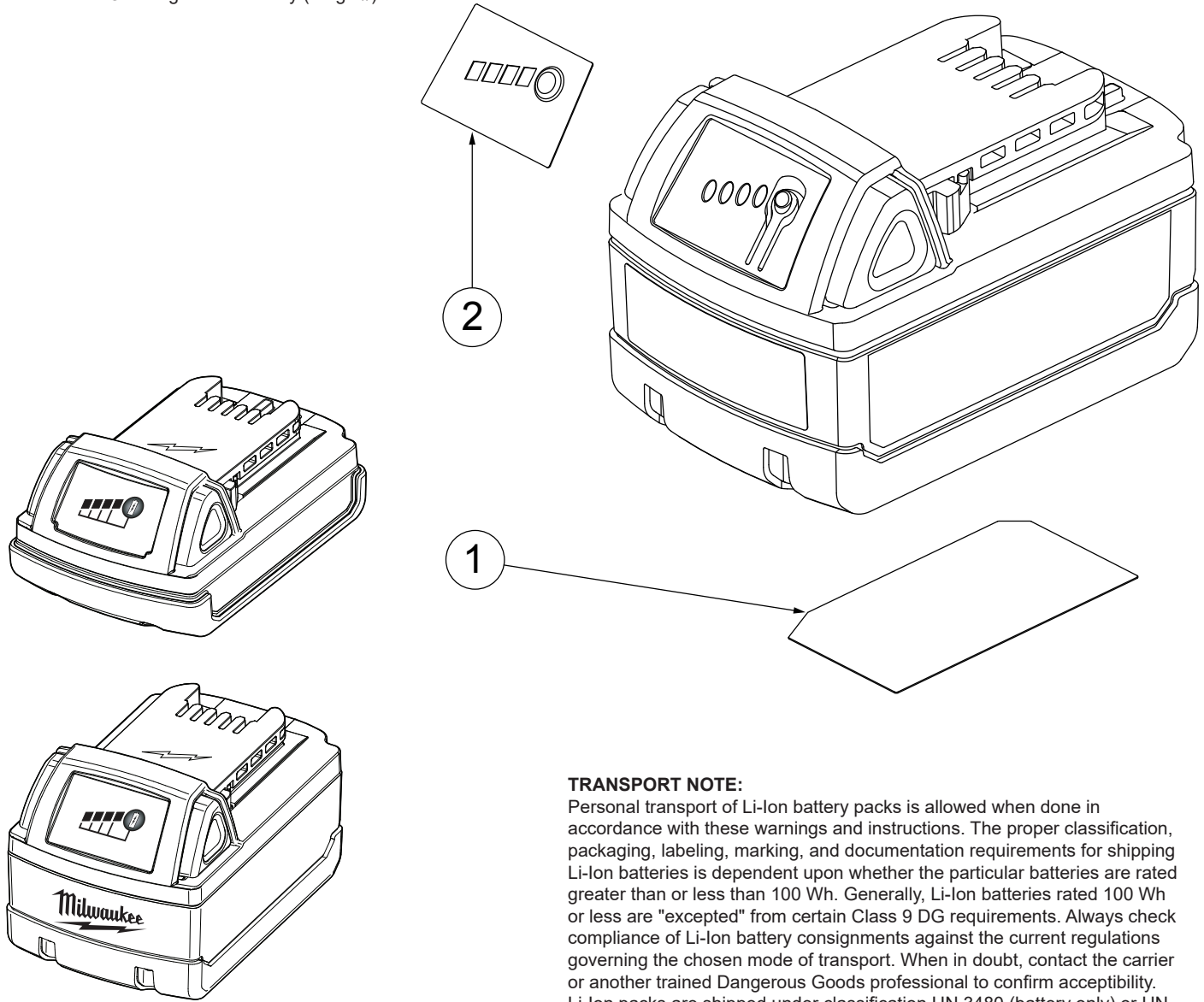

TRANSPORT NOTE:

Personal transport of Li-Ion battery packs is allowed when done in accordance with these warnings and instructions. The proper classification, packaging, labeling, marking, and documentation requirements for shipping Li-Ion batteries is dependent upon whether the particular batteries are rated greater than or less than 100 Wh. Generally, Li-Ion batteries rated 100 Wh or less are "excepted" from certain Class 9 DG requirements. Always check compliance of Li-Ion battery consignments against the current regulations governing the chosen mode of transport. When in doubt, contact the carrier or another trained Dangerous Goods professional to confirm acceptability. Li-Ion packs are shipped under classification UN 3480 (battery only) or UN 3481 (batteries contained in or packed with equipment).

FIG.	PART NO.	DESCRIPTION OF PART	NO. REQ.
1	12-20-0131	Service Nameplate	(1)
2	10-20-4305	Front Label	(1)

FIG.	NOTES
1, 2	The service nameplate and front label will fit on all catalog numbers listed above.

A clean, dry surface is essential for proper performance for any adhesive system. The area intended for application of any adhesive label or nameplate must be prepared by cleaning with isopropyl alcohol. The solvent is to be applied with a clean, lint free applicator and the surface allowed to dry before applying the label or nameplate.