

WIRING INSTRUCTIONS

TITLE

120 VOLT DYMODRILL

BULLETIN
58-01-0930

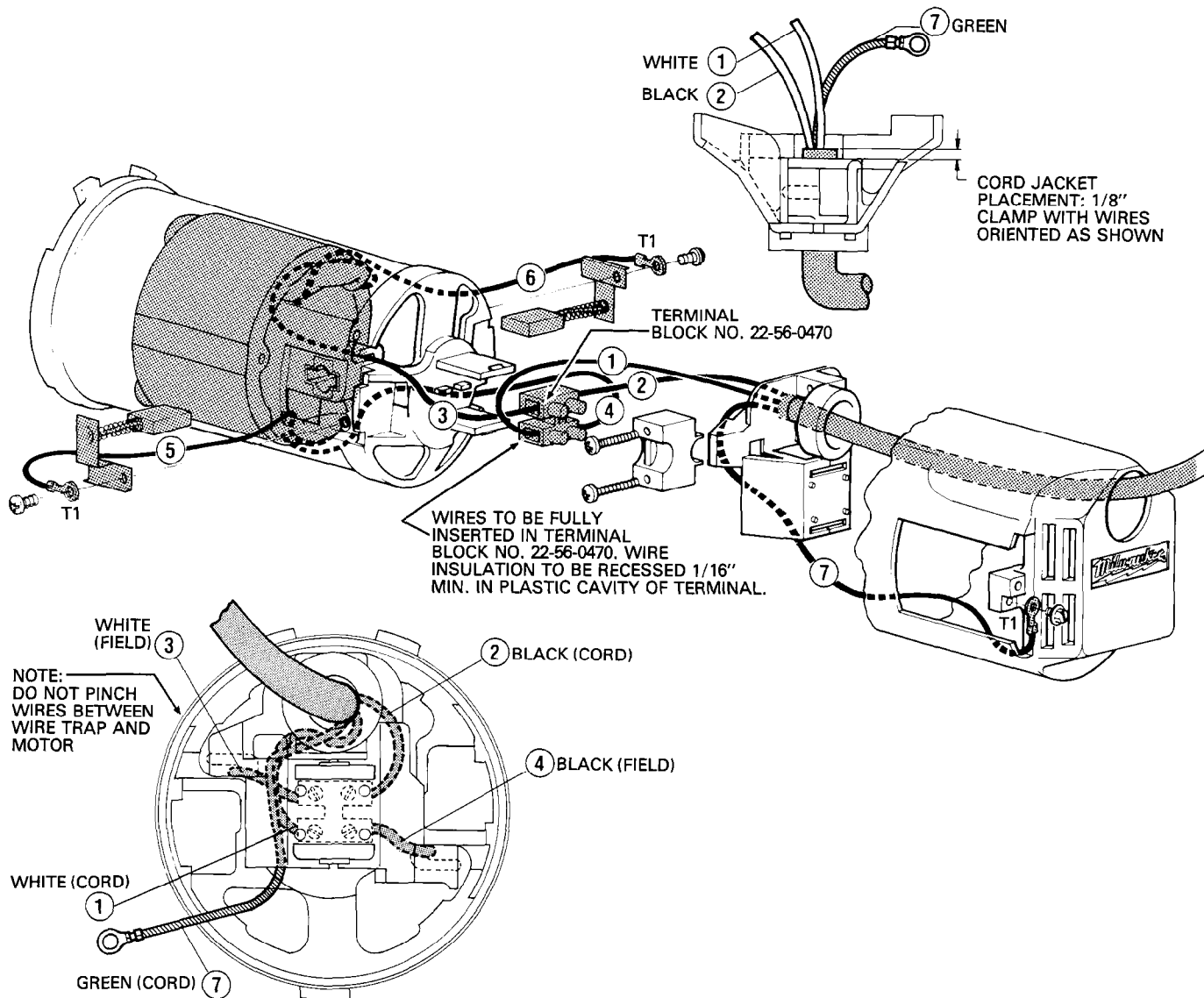

WIRING SPECIFICATIONS				
Wire No.	Wire Color	Origin or Gauge	Length	Terminals, Connectors and 1 or 2 End Wire Preparation
1	WHITE	CORD	2-3/4"	STRIP 1/4" AND TIN
2	BLACK	CORD	2-1/4"	STRIP 1/4" AND TIN
3	WHITE	FIELD	-----	STRIP 1/4" AND TIN
4	BLACK	FIELD	-----	STRIP 1/4" AND TIN
5	WHITE	FIELD	-----	STRIP 3/16" FOR T1
6	WHITE	FIELD	-----	STRIP 3/16" FOR T1
7	GREEN	CORD	-----	STRIP 3/16" FOR T1

NOTE:
All leads must be held to $\pm 1/8"$.
All field leads to be measured from and perpendicular to laminations.
All lead lengths are before stripping.

TERMINAL DESCRIPTION		
Code	Part No.	Qty.
T1	23-74-0840	3
CONNECTOR DESCRIPTION		

WIRING INSTRUCTIONS

TITLE

DYMODRILL and SWITCH BOX

**BULLETIN
58-03-0020**

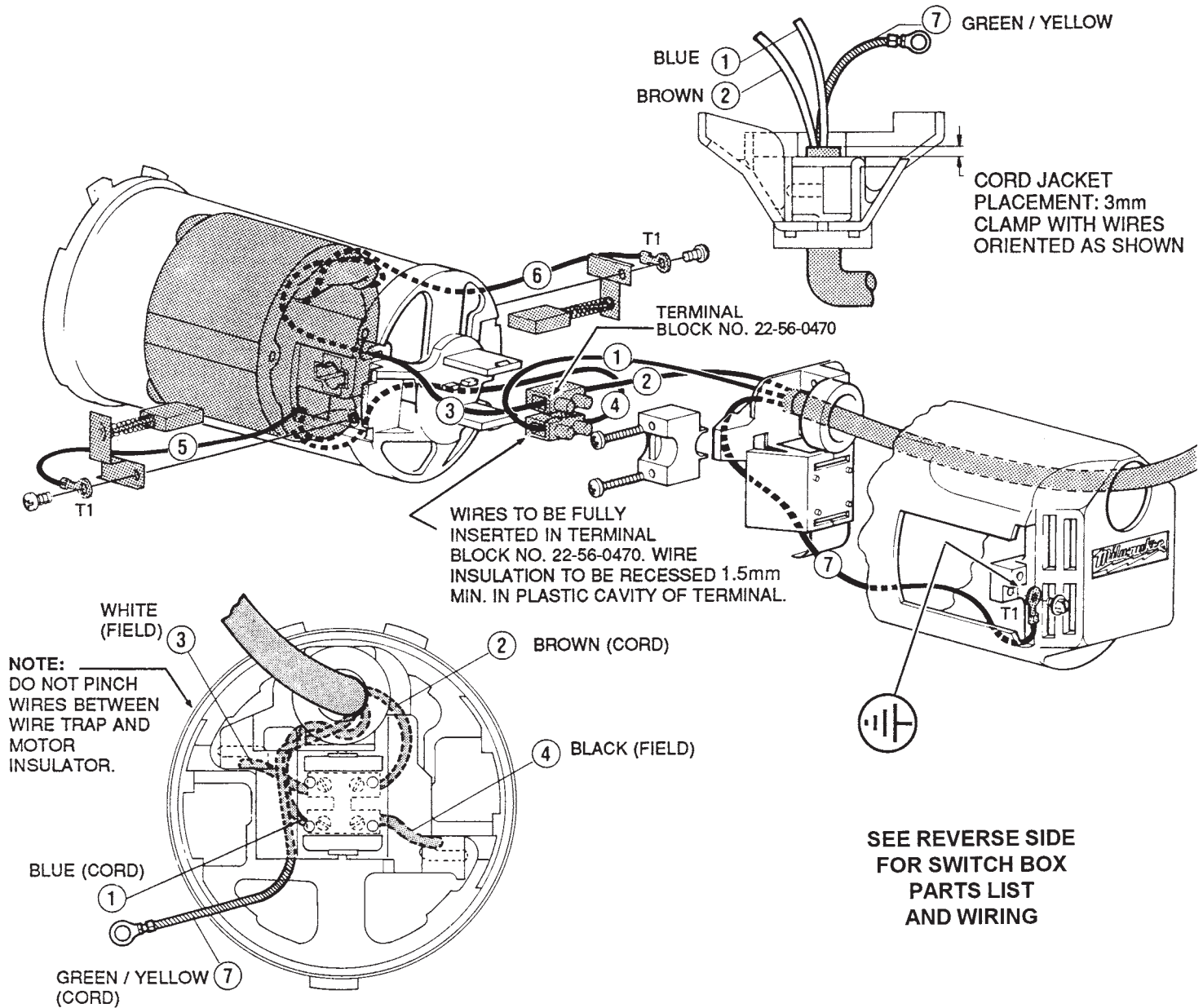

**SEE REVERSE SIDE
FOR SWITCH BOX
PARTS LIST
AND WIRING**

WIRING SPECIFICATIONS

Wire No.	Wire Color	Origin or Gauge	Length	Terminals, Connectors and 1 or 2 End Wire Preparation
1	Blue	Cord	70mm	As received, apply with #8.
2	Brown	Cord	70mm	As received, apply with #9.
3	White	Field	-----	As received.
4	Black	Field	-----	As received.
5	White	Field	-----	Strip 5mm for T1.
6	White	Field	-----	Strip 5mm for T1.
7	Green/Yellow	Cord	-----	Strip 5mm for T1.

NOTE:
All leads must be held to ± 1/8".
All lead lengths are before stripping.

TERMINAL DESCRIPTION		
Code	Part No.	Qty.
T1	23-74-0840	3
CONNECTOR DESCRIPTION		

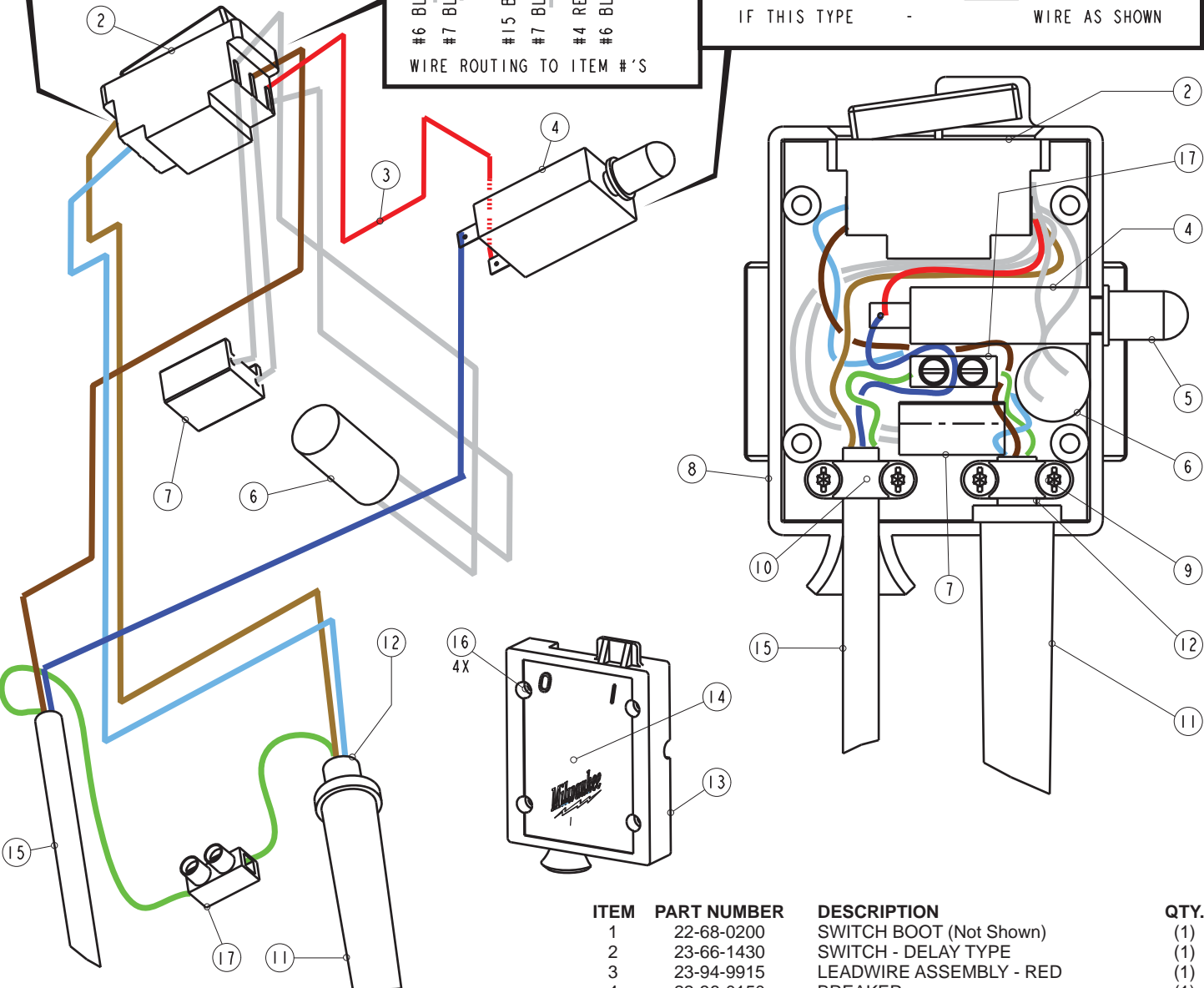
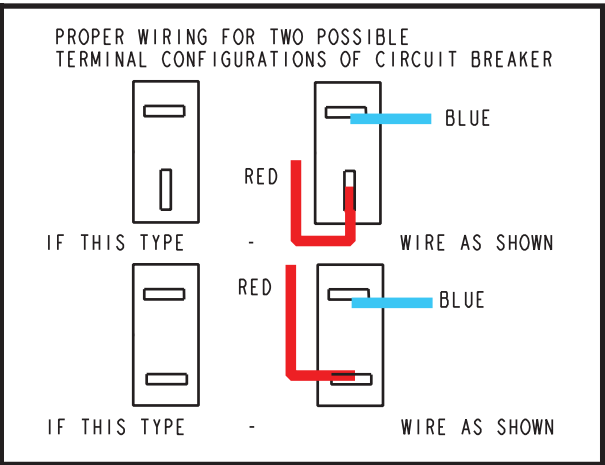
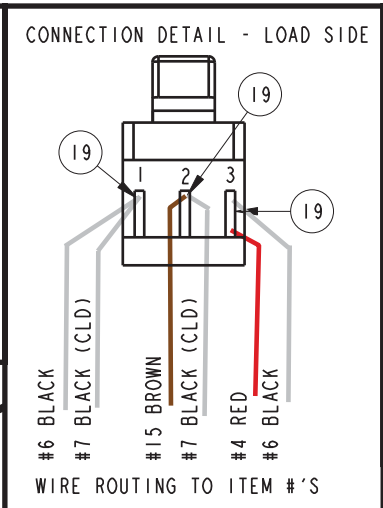
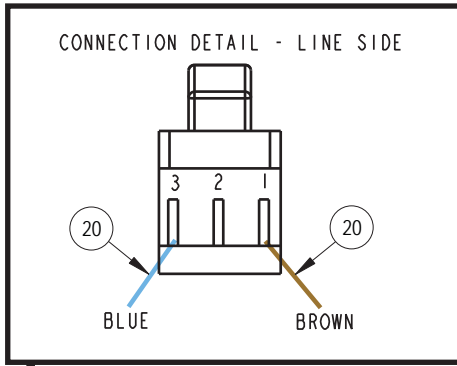

SERVICE NOTES:

- Screws can use either a flat blade or T-20 screwdriver.
- Cover (13) should mate flush with enclosure (8) before securing with cover screws (16). A gap indicates a misplaced wire or component.
- Tighten breaker boot (5) after installing cover (13).
- Cord jackets (12 and 15) are to extend a minimum of .125" beyond cord clamps (10), 2 places. Cord set (12) is shown inside cord protector (11).
- Ground label (18) is to be applied to the inside of the enclosure (8), under the terminal block (17).
- Tuck the red leadwire assembly (3) down below pegs.

ITEM	PART NUMBER	DESCRIPTION	QTY.
1	22-68-0200	SWITCH BOOT (Not Shown)	(1)
2	23-66-1430	SWITCH - DELAY TYPE	(1)
3	23-94-9915	LEADWIRE ASSEMBLY - RED	(1)
4	22-36-0150	BREAKER	(1)
5	22-68-0210	BREAKER BOOT	(1)
6	22-33-0430	SUPPRESSOR	(1)
7	22-74-0053	CURRENT LIMIT DEVICE	(1)
8	22-12-0200	ENCLOSURE	(1)
9	06-82-7299	SCREW	(4)
10	31-17-0155	CLAMP	(2)
11	44-76-0140	CORD PROTECTOR	(1)
12	23-37-0170	CORD SET ASSEMBLY	(1)
13	22-68-0190	COVER	(1)
14	12-98-3080	INSTRUCTION PLATE	(1)
15	22-64-5050	CORD SET	(1)
16	06-82-7326	SCREW	(4)
17	22-56-0480	TERMINAL BLOCK	(1)
18	10-98-3030	GROUND LABEL (Not Shown)	(1)
19	23-74-2005	1.5MM FERRULE (Not Shown)	(3)
20	23-74-2000	1.0MM FERRULE (Not Shown)	(2)