



SERVICE PARTS LIST

BULLETIN NO.
54-06-2736

SPECIFY CATALOG NO. AND SERIAL NO. WHEN ORDERING PARTS			REVISED BULLETIN	DATE
CORDLESS 18 VOLT LED WORKLIGHT			54-06-2735	Oct. 2017
CATALOG NO.	2735-20	STARTING SERIAL NO.	WIRING INSTRUCTION	
		C12B		

EXAMPLE:
Component Parts (Small #) Are Included
When Ordering The Assembly (Large #).

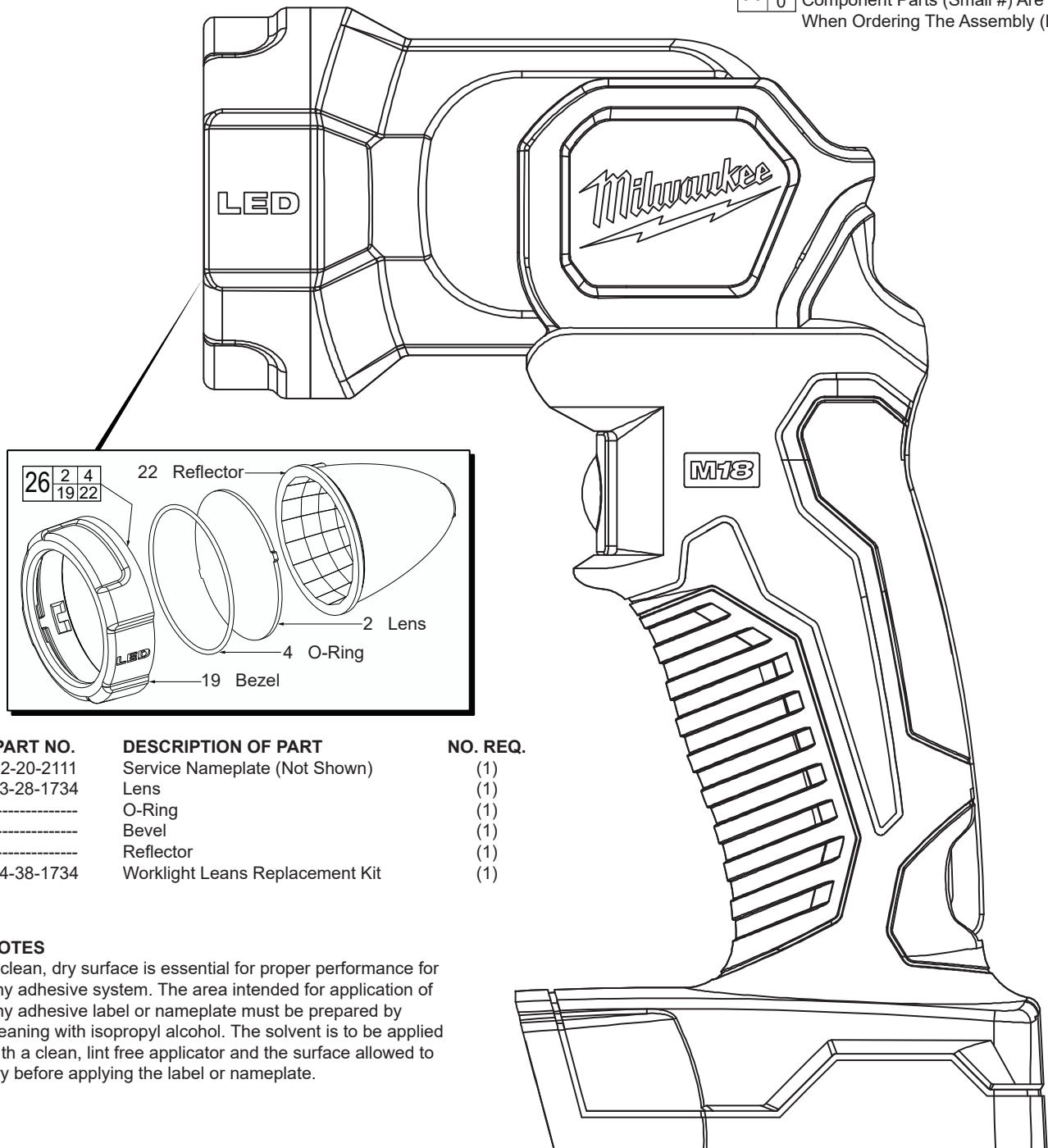

FIG.	PART NO.	DESCRIPTION OF PART	NO. REQ.
1	12-20-2111	Service Nameplate (Not Shown)	(1)
2	23-28-1734	Lens	(1)
4	-----	O-Ring	(1)
19	-----	Bezel	(1)
22	-----	Reflector	(1)
26	14-38-1734	Worklight Leans Replacement Kit	(1)

FIG. NOTES

- 1 A clean, dry surface is essential for proper performance for any adhesive system. The area intended for application of any adhesive label or nameplate must be prepared by cleaning with isopropyl alcohol. The solvent is to be applied with a clean, lint free applicator and the surface allowed to dry before applying the label or nameplate.