

WIRING INSTRUCTIONS

TITLE

D-HANDLE DRILL

BULLETIN

58-01-0247

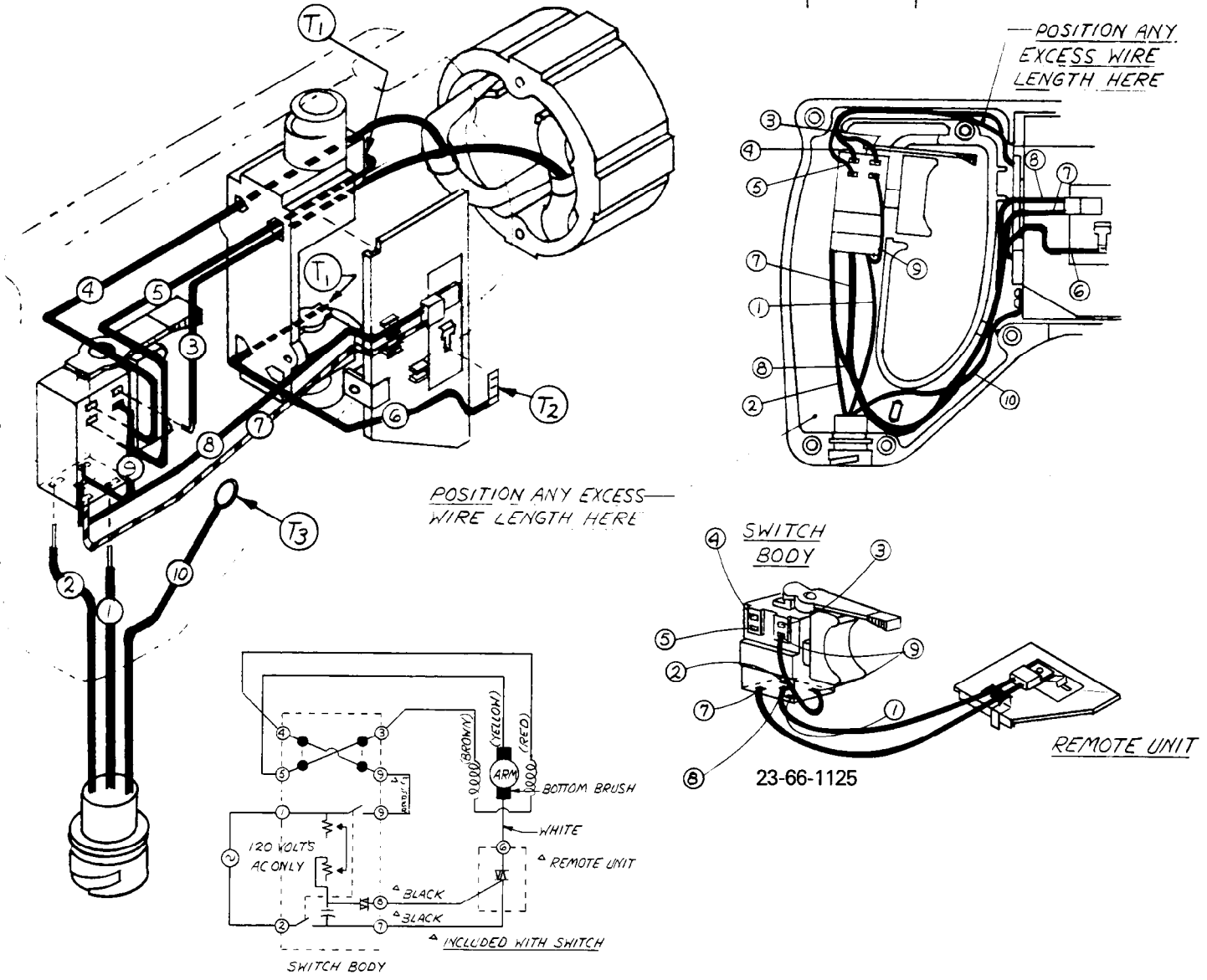

WIRING SPECIFICATIONS

Wire No.	Wire Color	Origin or Gauge	Length	Terminals, Connectors and 1 or 2 End Wire Preparation.
1	WHITE	*	—	COMPONENT OF PIN HSG. ASSY.
2	WHITE	*	—	COMPONENT OF PIN HSG. ASSY.
3	BROWN	FIELD	8-3/8"	STRIP 3/8" AND TIN.
4	RED	FIELD	8-1/4"	STRIP 3/8" AND TIN.
5	YELLOW	18	7-3/4"	STRIP 3/8" AND TIN/STRIP 1/4" FOR T1
6	WHITE	18	5"	STRIP 1/4" FOR T1/STRIP 3/16" FOR T2
7	BLACK	—	—	SUPPLIED WITH SWITCH
8	BLACK	—	—	SUPPLIED WITH SWITCH
9	BLACK	—	—	SUPPLIED WITH SWITCH
10	GREEN	*	—	COMPONENT OF PIN HSG. ASSY.

NOTE:

All leads must be held to $\pm 1/8"$.
 All field leads to be measured from and perpendicular to laminations.
 All lead lengths are before stripping.

TERMINAL DESCRIPTION

Code	Part No.	Qty.
T1	22-44-0090	2
T2	23-74-0615	1
T3	23-74-0896	1

CONNECTOR DESCRIPTION

Code	Part No.	Qty.

WIRING INSTRUCTIONS

TITLE

"D" HANDLE DRILLS

BULLETIN
58-01-0281

For double insulated tools,
disregard wire no. 3 and T2.

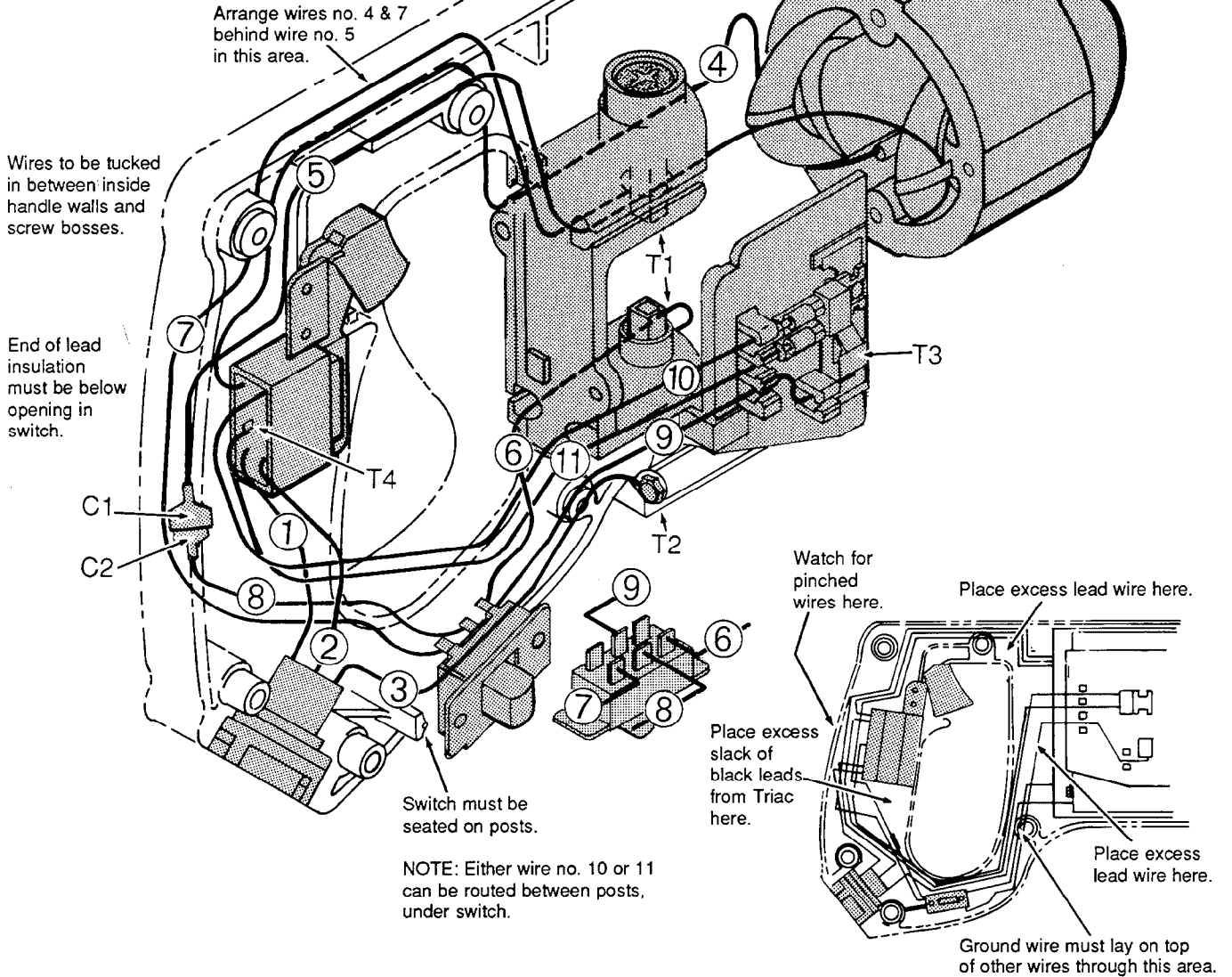

WIRING SPECIFICATIONS

Wire No.	Wire Color	Origin or Gauge	Length	Terminals, Connectors and 1 or 2 End Wire Preparation
1	WHITE	18 Ga.*	-----	COMPONENT OF PIN HOUSING ASSEMBLY.*
2	WHITE	18 Ga.*	-----	COMPONENT OF PIN HOUSING ASSEMBLY.*
3	GREEN	18 Ga.*	-----	COMPONENT OF PIN HOUSING ASSEMBLY.* STRIP 3/16" FOR T2
4	RED	FIELD	8-1/2"	STRIP 3/8" AND TIN.
5	BROWN	FIELD	9-3/8"	STRIP 3/16" FOR C1.
6	WHITE	18 Ga.	4-3/4"	STRIP 1/4" FOR T1.
7	YELLOW	18 Ga.	10-3/4"	STRIP 1/4" FOR T1.
8	WHITE	18 Ga.	2"	STRIP 3/16" FOR C2.
9	YELLOW	18 Ga.	6-3/4"	STRIP 3/16" FOR T3.
10	BLACK	18 Ga.	11-1/2"	STRIP 5/16" AND TIN.
11	BLACK	18 Ga.	11-1/2"	STRIP 3/16" FOR T4.

NOTE:
All leads must be held to $\pm 1/8"$.
All field leads to be measured from
and perpendicular to laminations.
All lead lengths are before stripping.

TERMINAL DESCRIPTION		
Code	Part No.	Qty.
T1	22-44-0090	2
T2	23-74-0896	1
T3	23-74-0615	1
T4	23-74-0900	1

CONNECTOR DESCRIPTION		
Code	Part No.	Qty.
C1	23-74-0440	1
C2	23-74-0430	1

WIRING INSTRUCTIONS

TITLE **DOUBLE REDUCTION "D" HANDLE DRILLS**

BULLETIN
58-01-0283

DATE
Sept. '95

For double insulated tools,
disregard wire no. 3 and T2.

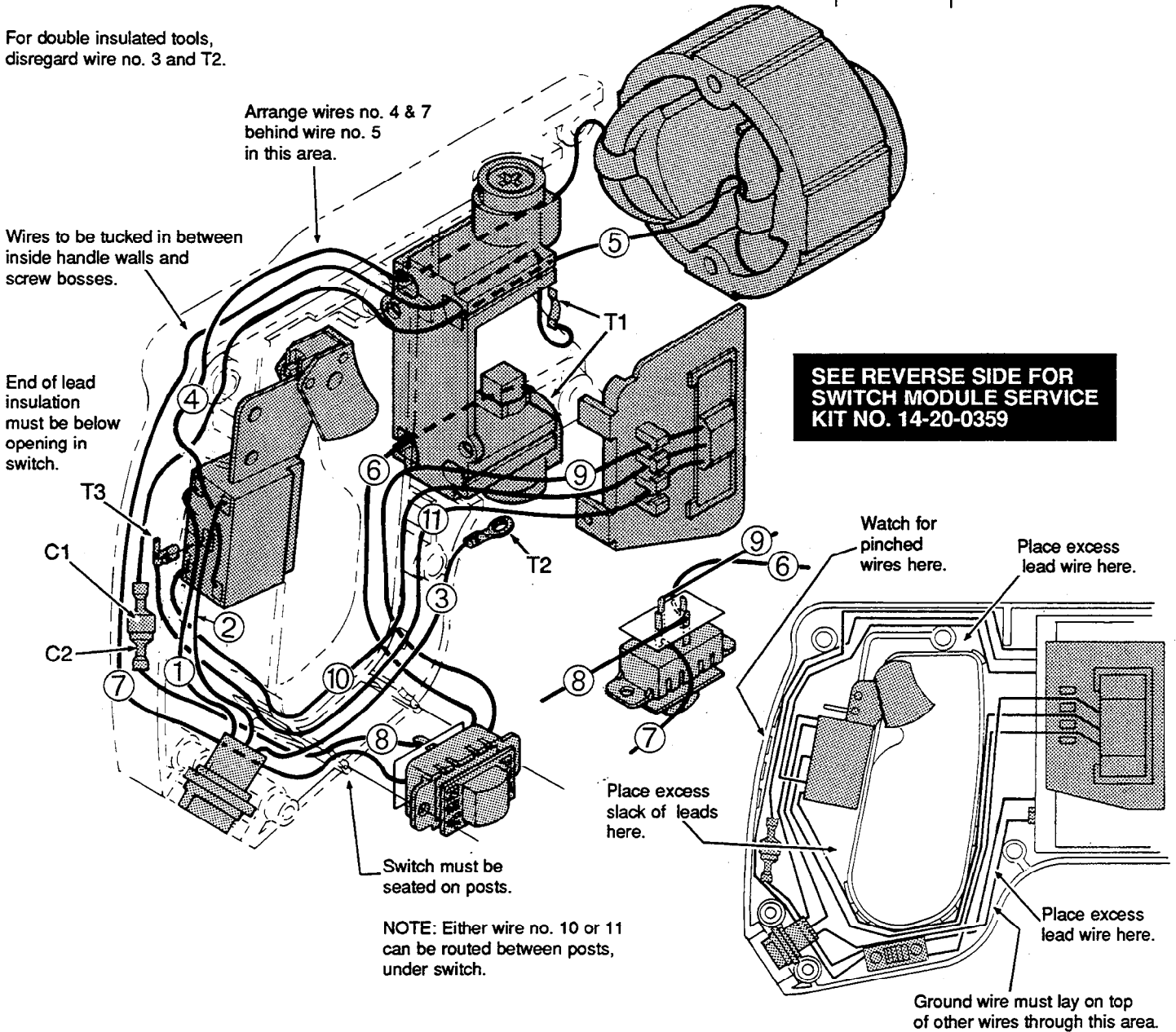

NOTE: Either wire no. 10 or 11 can be routed between posts, under switch.

WIRING SPECIFICATIONS

Wire No.	Wire Color	Origin or Gauge	Length	Terminals, Connectors and 1 or 2 End Wire Preparation
1	WHITE	18 Ga.*	----	COMPONENT OF PIN HOUSING ASSEMBLY.*
2	WHITE	18 Ga.*	----	COMPONENT OF PIN HOUSING ASSEMBLY.*
3	GREEN	18 Ga.*	----	COMP. OF PIN HSG. ASSY.* STRIP 3/16" FOR T2.
4	RED	FIELD	8-1/2"	STRIP 3/8" AND TIN.
5	BROWN	FIELD	9-3/8"	STRIP 3/16" FOR C1.
6	BLACK	18 Ga.	5-1/4"	STRIP 1/4" FOR T1.
7	BLACK	18 Ga.	10-3/4"	STRIP 1/4" FOR T1.
8	BLACK	18 Ga.	2"	STRIP 3/16" FOR C2.
9	BLACK	18 Ga.	5-7/8"	STRIP 3/16" AND SOLDER TO FWD / REV SWITCH.
10	BLACK	18 Ga.	9-1/2"	STRIP 5/16" AND TIN.
11	BLACK	18 Ga.	10-1/8"	STRIP 3/16" FOR T3.

NOTE:
All leads must be held to $\pm 1/8"$.
All field leads to be measured from and perpendicular to laminations.
All lead lengths are before stripping.

TERMINAL DESCRIPTION		
Code	Part No.	Qty.
T1	22-44-0090	2
T2	23-74-0896	1
T3	23-74-0900	1

CONNECTOR DESCRIPTION		
Code	Part No.	Qty.
C1	23-74-0440	1
C2	23-74-0430	1

WIRING INSTRUCTIONS

TITLE **DOUBLE REDUCTION "D" HANDLE DRILLS**

BULLETIN

DATE

For double insulated tools,
disregard wire no. 3 and T2.

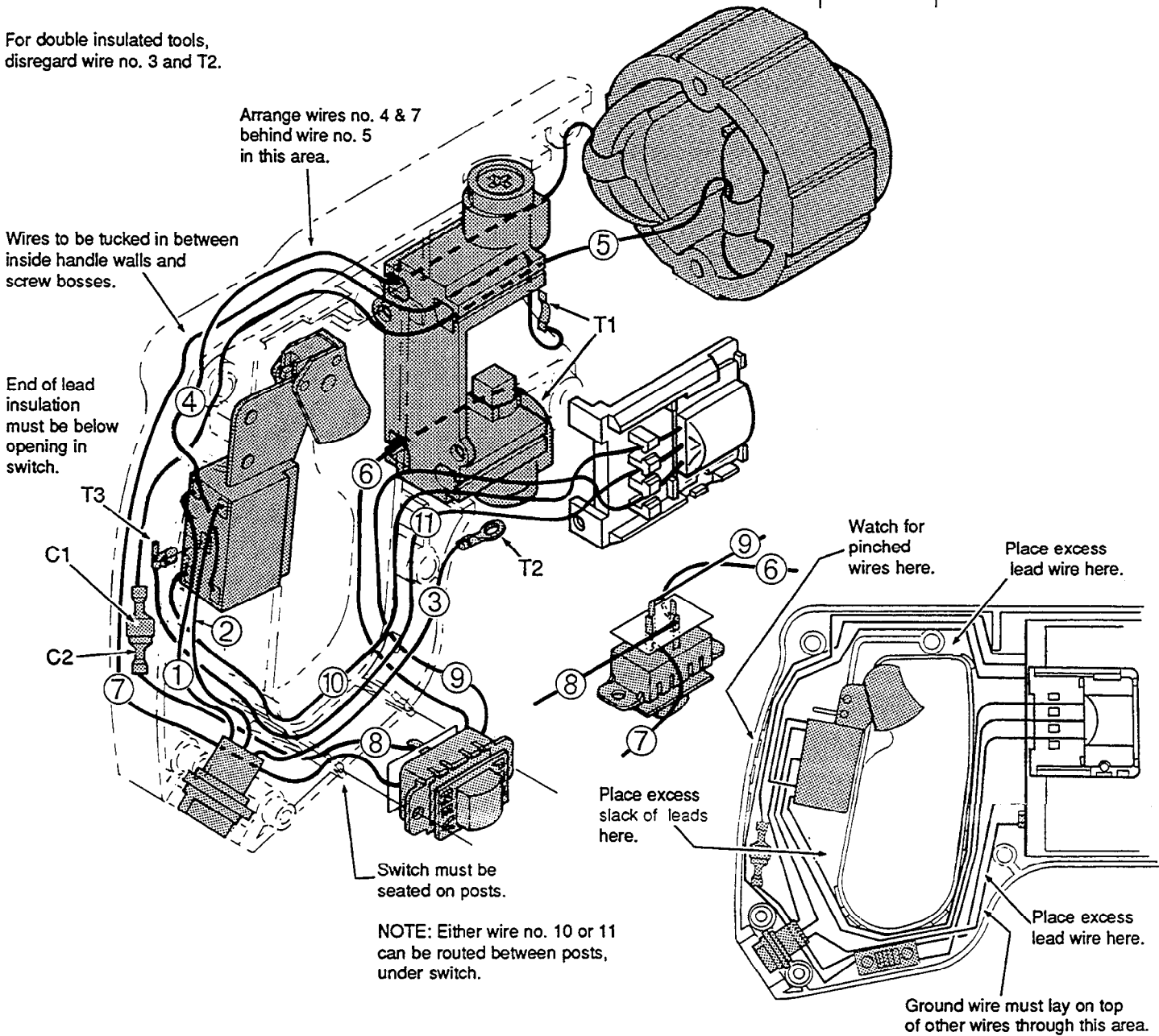

NOTE: Either wire no. 10 or 11
can be routed between posts,
under switch.

Ground wire must lay on top
of other wires through this area.

WIRING SPECIFICATIONS

Wire No.	Wire Color	Origin or Gauge	Length	Terminals, Connectors and 1 or 2 End Wire Preparation
1	WHITE	18 Ga.*	----	COMPONENT OF PIN HOUSING ASSEMBLY.*
2	WHITE	18 Ga.*	----	COMPONENT OF PIN HOUSING ASSEMBLY.*
3	GREEN	18 Ga.*	----	COMP. OF PIN HSG. ASSY.* STRIP 3/16" FOR T2.
4	RED	FIELD	8-1/2"	STRIP 3/8" AND TIN.
5	BROWN	FIELD	9-3/8"	STRIP 3/16" FOR C1.
6	BLACK	18 Ga.	5-1/4"	STRIP 1/4" FOR T1.
7	BLACK	18 Ga.	10-3/4"	STRIP 1/4" FOR T1.
8	BLACK	18 Ga.	2"	STRIP 3/16" FOR C2.
9	BLACK	18 Ga.	5-7/8"	STRIP 3/16" AND SOLDER TO FWD / REV SWITCH.
10	BLACK	18 Ga.	9-1/2"	STRIP 5/16" AND TIN.
11	BLACK	18 Ga.	10-1/8"	STRIP 3/16" FOR T3.

NOTE:

All leads must be held to $\pm 1/8"$.
All field leads to be measured from
and perpendicular to laminations.
All lead lengths are before stripping.

TERMINAL DESCRIPTION

Code	Part No.	Qty.
T1	22-44-0090	2
T2	23-74-0896	1
T3	23-74-0900	1

CONNECTOR DESCRIPTION

C1	23-74-0440	1
C2	23-74-0430	1

WIRING INSTRUCTIONS

TITLE **DOUBLE REDUCTION "D" HANDLE DRILLS**

BULLETIN

DATE

For double insulated tools,
disregard wire no. 3 and T2.

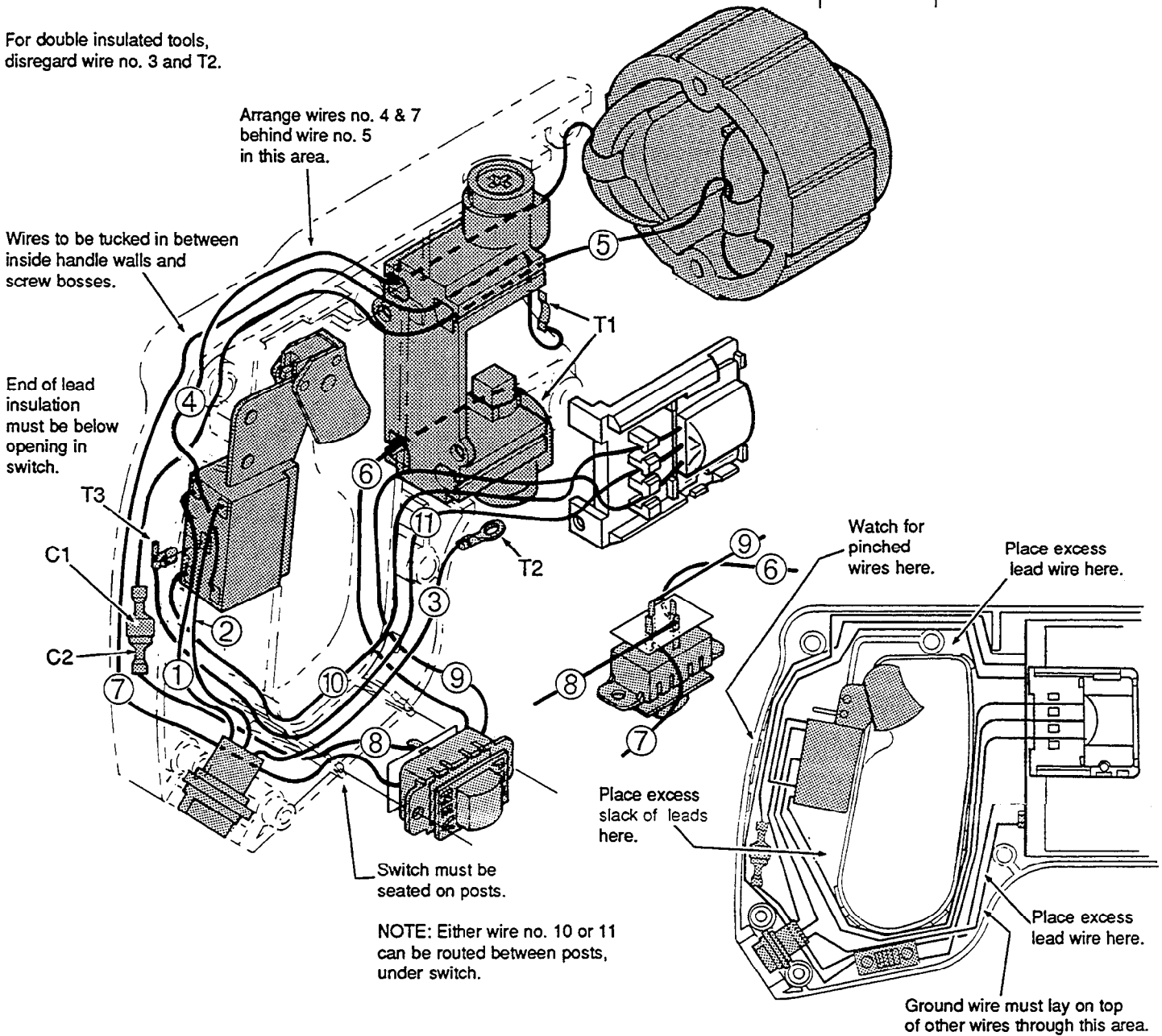

NOTE: Either wire no. 10 or 11
can be routed between posts,
under switch.

Ground wire must lay on top
of other wires through this area.

WIRING SPECIFICATIONS

Wire No.	Wire Color	Origin or Gauge	Length	Terminals, Connectors and 1 or 2 End Wire Preparation
1	WHITE	18 Ga.*	----	COMPONENT OF PIN HOUSING ASSEMBLY.*
2	WHITE	18 Ga.*	----	COMPONENT OF PIN HOUSING ASSEMBLY.*
3	GREEN	18 Ga.*	----	COMP. OF PIN HSG. ASSY.* STRIP 3/16" FOR T2.
4	RED	FIELD	8-1/2"	STRIP 3/8" AND TIN.
5	BROWN	FIELD	9-3/8"	STRIP 3/16" FOR C1.
6	BLACK	18 Ga.	5-1/4"	STRIP 1/4" FOR T1.
7	BLACK	18 Ga.	10-3/4"	STRIP 1/4" FOR T1.
8	BLACK	18 Ga.	2"	STRIP 3/16" FOR C2.
9	BLACK	18 Ga.	5-7/8"	STRIP 3/16" AND SOLDER TO FWD / REV SWITCH.
10	BLACK	18 Ga.	9-1/2"	STRIP 5/16" AND TIN.
11	BLACK	18 Ga.	10-1/8"	STRIP 3/16" FOR T3.

NOTE:

All leads must be held to $\pm 1/8"$.
All field leads to be measured from
and perpendicular to laminations.
All lead lengths are before stripping.

TERMINAL DESCRIPTION

Code	Part No.	Qty.
T1	22-44-0090	2
T2	23-74-0896	1
T3	23-74-0900	1

CONNECTOR DESCRIPTION

Code	Part No.	Qty.
C1	23-74-0440	1
C2	23-74-0430	1

WIRING INSTRUCTIONS

TITLE

D-HANDLE TOOLS

BULLETIN
58-01-0288

DATE
Sept. '97

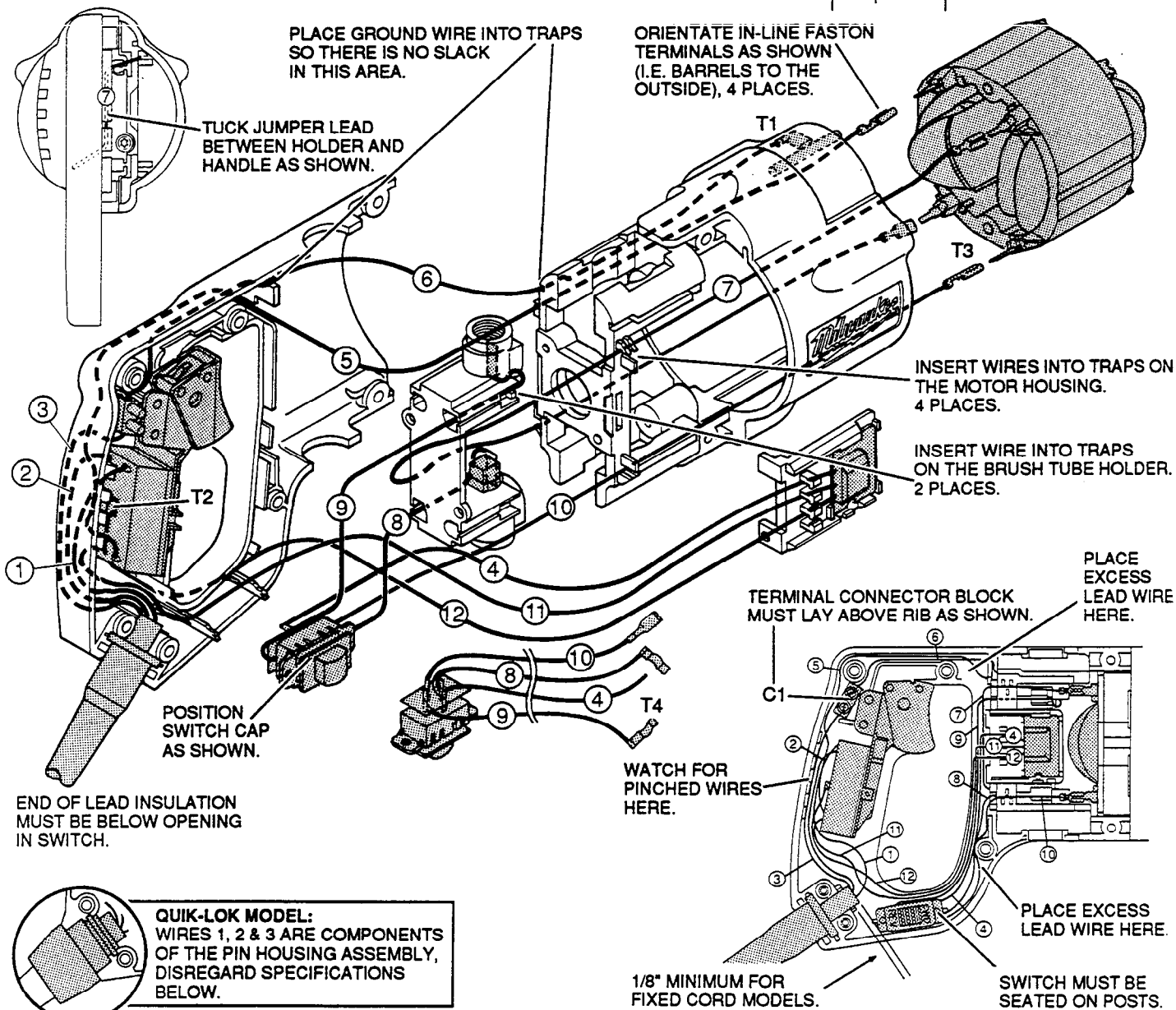

QUIK-LOK MODEL:
WIRES 1, 2 & 3 ARE COMPONENTS OF THE PIN HOUSING ASSEMBLY, DISREGARD SPECIFICATIONS BELOW.

WIRING SPECIFICATIONS					
Wire No.	Wire Color	Origin or Part No.	Gauge	Length	Terminals, Connectors and End Wire Preparation
1	White	Cord	18	3-3/4"	Strip 3/8" and tin.
2	Black	Cord	18	3-3/4"	Strip 3/8" and tin.
▲ 3	Green	Cord	18	4-1/2"	Strip 3/16" and tin for C1.
4	Black	Switch Assy.	18	5-7/8"	Strip 3/8" and tin.
5	White	23-94-6175	18	8"	Strip 3/16" for T3 / Strip 3/8" tin.
▲ 6	Green	23-94-6100	16	8-3/4"	Strip 3/16" for T1 / Strip 3/16 and tin for C1.
7	Yellow	23-94-6110	18	5-5/16"	Strip both ends 3/16" for T3.
8	Black	Switch Assy.	18	5-1/4"	Strip 1/4" for T4.
9	Black	Switch Assy.	18	7-1/4"	Strip 1/4" for T4.
10	Red	Switch Assy.	18	5-1/4"	Strip 3/16" for T3.
11	Black	Switch Assy.	18	9-7/16"	Strip 5/16" and tin.
12	Black	Switch Assy.	18	10-3/32"	Strip 3/16" for T2.

▲ BULK LEAD WIRE - BULLETIN 58-01-0003

▲ FOR DOUBLE INSULATED, DISREGARD WIRES AND TERMINALS

NOTE:
All leads must be held to ± 1/8".
All lead lengths are before stripping.

TERMINAL DESCRIPTION		
Code	Part No.	Qty.
▲ T1	23-74-0605	1
T2	23-74-0900	1
T3	23-74-1060	4
T4	23-74-0410	2

CONNECTOR DESCRIPTION		
Code	Part No.	Qty.
▲ C1	22-56-0456	1

WIRING INSTRUCTIONS

TITLE

D-HANDLE TOOLS

**BULLETIN
58-01-0296**

DATE
June 2007
T3

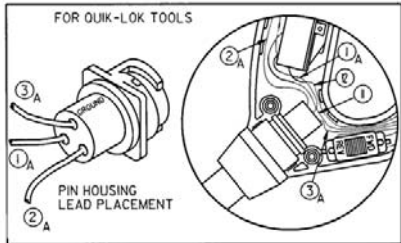
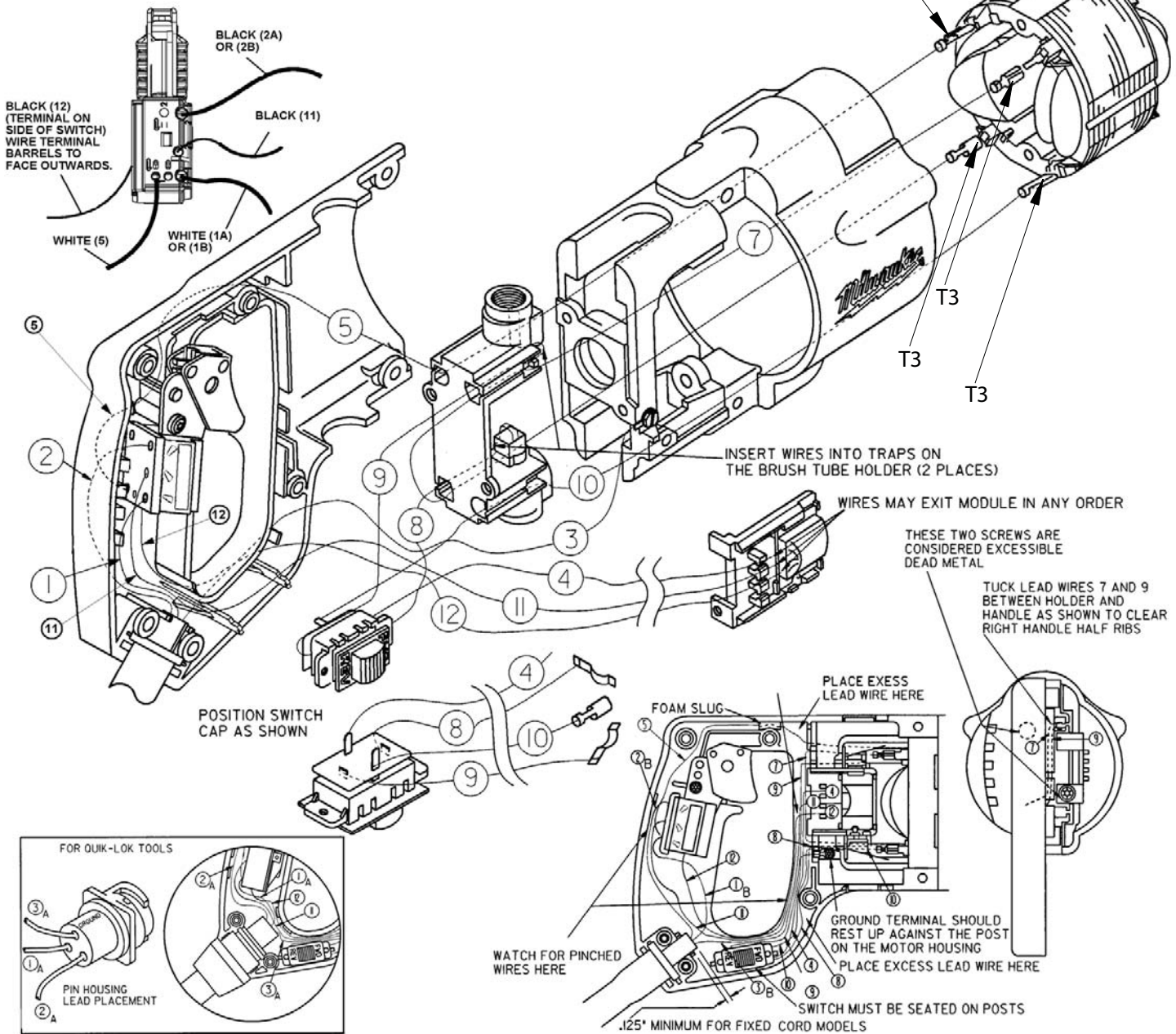

WIRING SPECIFICATIONS

Wire No.	Wire Color	Origin or Part No.	Length	Terminals, Connectors and End Wire Preparation
1A	White	Quik-Lok Cord	--	Part of Pin Housing Assembly
2A	Black	Quik-Lok Cord	--	Part of Pin Housing Assembly
3A	Green	Quik-Lok Cord	--	Part of Pin Housing Assembly
1B	White	Cord	3.25	Strip .320 and Tin
2B	Black	Cord	3.75	Strip .320 and Tin
3B	Green	Cord	6.10	Strip .150 and Crimp, Crimp HT .006 ± .003
4	Black	--	--	Part of Remote Switch Assembly
5	White	--	--	Lead Assembly L4
7	Yellow	--	--	Lead Assembly L6
8	Black	--	--	Part of Remote Switch Assembly
9	Black	--	--	Part of Remote Switch Assembly
10	Brown	--	--	Part of Remote Switch Assembly
11	Black	--	--	Part of Remote Switch Assembly
12	Black	--	--	Part of Remote Switch Assembly

NOTE:
All leads must be held to ± 1/8".
All lead lengths are before stripping.

TERMINAL DESCRIPTION		
Code	Part No.	Qty.
T1	23-74-0896	1
T2	23-74-0410	2
T3	23-74-1060	4
T4	23-74-0900	1

WIRING INSTRUCTIONS

TITLE

D-HANDLE TOOLS

**BULLETIN
58-01-0297**

DATE
Dec. '94

END OF LEAD WIRE INSULATION
MUST BE BELOW OPENING
IN DUST BOOT OF SWITCH.

BENDING OF TERMINAL IS
ACCEPTABLE, IF BENT
DURING ASSEMBLY. DO
NOT STRAIGHTEN.

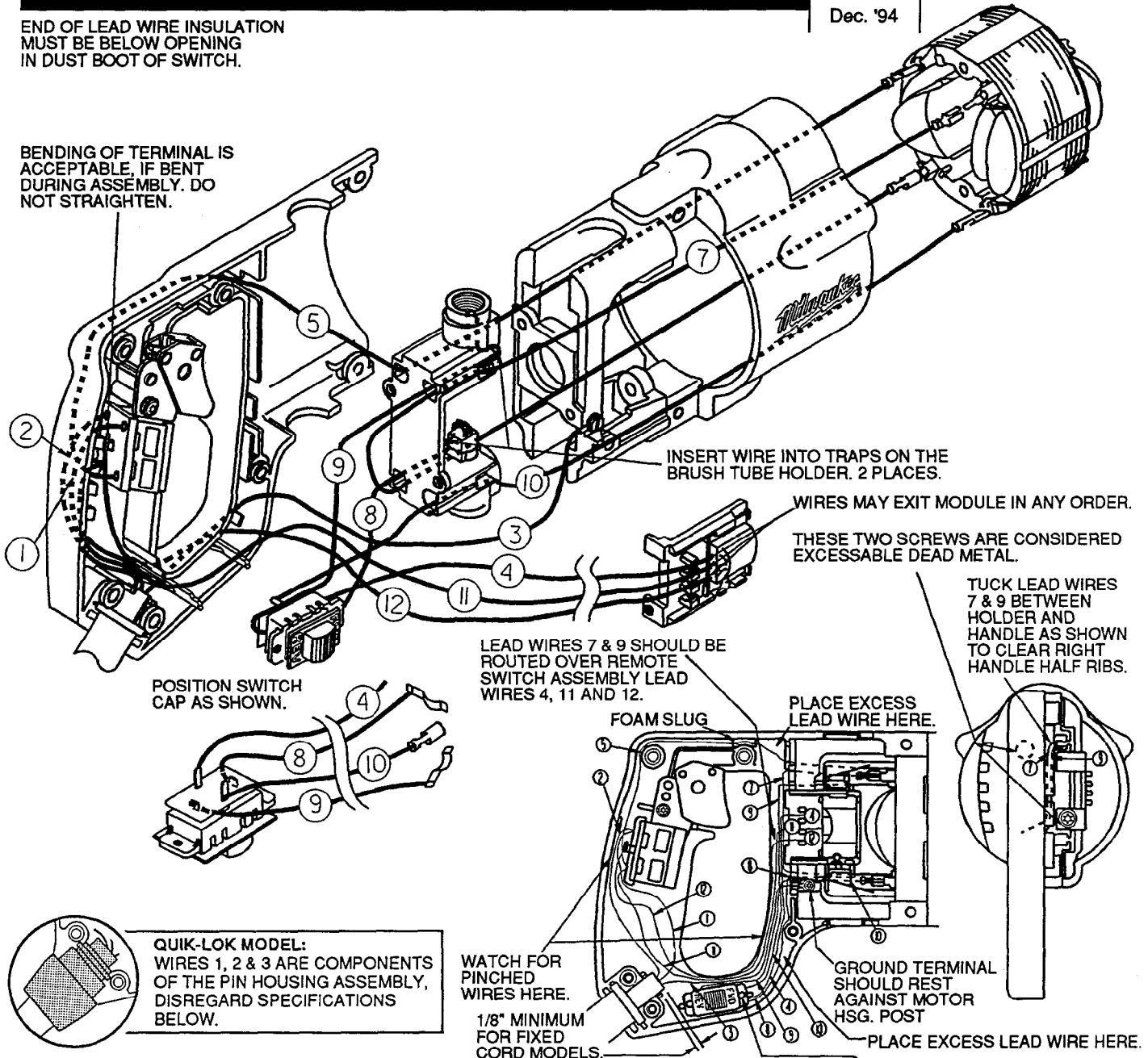

POSITION SWITCH
CAP AS SHOWN.

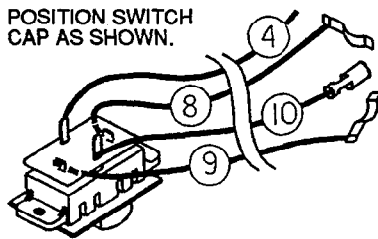

QUIK-LOK MODEL:
WIRES 1, 2 & 3 ARE COMPONENTS
OF THE PIN HOUSING ASSEMBLY,
DISREGARD SPECIFICATIONS
BELOW.

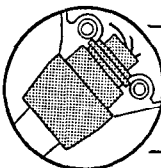

WATCH FOR
PINCHED
WIRES HERE.

1/8" MINIMUM
FOR FIXED
CORD MODELS.

GROUND TERMINAL
SHOULD REST
AGAINST MOTOR
HSG. POST

PLACE EXCESS LEAD WIRE HERE.

SWITCH MUST BE
SEATED ON POSTS.

WIRING SPECIFICATIONS

Wire No.	Wire Color	Origin or Part No.	Gauge	Length	Terminals, Connectors and End Wire Preparation
1	White	Cord	18	3-3/4"	Strip 3/8" and tin.
2	Black	Cord	18	3-3/4"	Strip 3/8" and tin.
3	Green	Cord	18	5-1/2"	Strip 3/16" for T1.
4	Black	Remote Assy.	18	5-7/8"	Strip 3/16" and tin.
5	White	23-94-6115	18	8"	Strip 3/16" for T3 / Strip 3/8" tin.
7	Yellow	23-94-6110	18	5-5/16"	Strip both ends 3/16" for T3.
8	Black	Remote Assy.	18	5-1/4"	Strip 1/4" for T2.
9	Black	Remote Assy.	18	7-1/4"	Strip 1/4" for T2.
10	Brown	Remote Assy.	18	5-1/4"	Strip 3/16" for T3.
11	Black	Remote Assy.	18	9-7/16"	Strip 5/16" and tin.
12	Black	Remote Assy.	18	10-3/32"	Strip 3/16" for T4.

BULK LEAD WIRE - BULLETIN 58-01-0003

NOTE:
All leads must be held to ± 1/8".
All lead lengths are before stripping.

TERMINAL DESCRIPTION

Code	Part No.	Qty.
T1	23-74-0896	1
T2	23-74-0410	2
T3	23-74-1060	4
T4	23-74-0900	1

WIRING INSTRUCTIONS

TITLE

D-HANDLE TOOLS

BULLETIN
58-01-0298

DATE
Dec. '94

END OF LEAD WIRE INSULATION
MUST BE BELOW OPENING
IN DUST BOOT OF SWITCH.

BENDING OF TERMINAL IS
ACCEPTABLE, IF BENT
DURING ASSEMBLY. DO
NOT STRAIGHTEN.

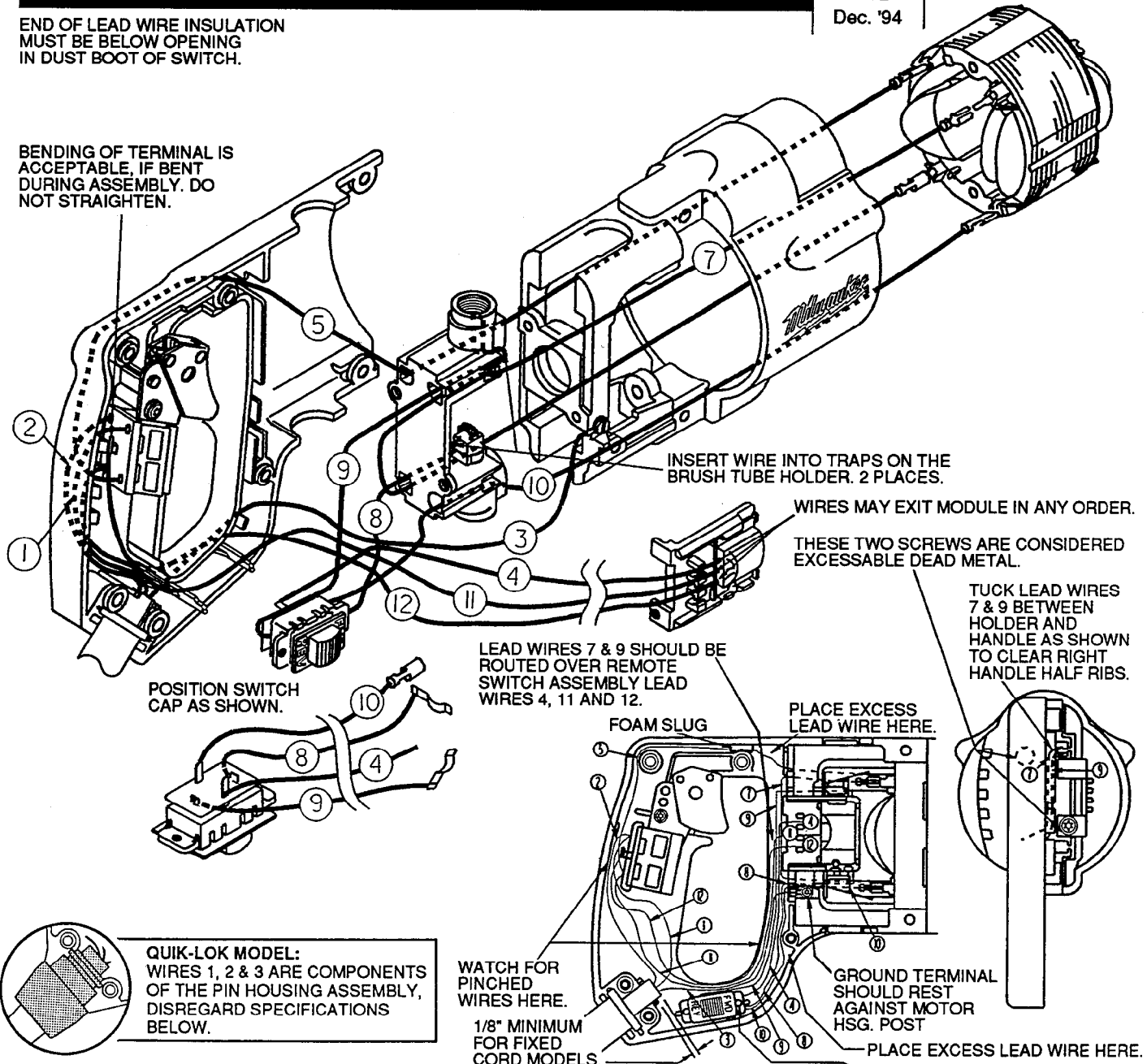

POSITION SWITCH
CAP AS SHOWN.

INSERT WIRE INTO TRAPS ON THE
BRUSH TUBE HOLDER. 2 PLACES.

WIRES MAY EXIT MODULE IN ANY ORDER.

THESE TWO SCREWS ARE CONSIDERED
EXCESSABLE DEAD METAL.

TUCK LEAD WIRES
7 & 9 BETWEEN
HOLDER AND
HANDLE AS SHOWN
TO CLEAR RIGHT
HANDLE HALF RIBS.

LEAD WIRES 7 & 9 SHOULD BE
ROUTED OVER REMOTE
SWITCH ASSEMBLY LEAD
WIRES 4, 11 AND 12.

PLACE EXCESS
LEAD WIRE HERE.

FOAM SLUG

QUIK-LOK MODEL:
WIRES 1, 2 & 3 ARE COMPONENTS
OF THE PIN HOUSING ASSEMBLY,
DISREGARD SPECIFICATIONS
BELOW.

WATCH FOR
PINCHED
WIRES HERE.

1/8" MINIMUM
FOR FIXED
CORD MODELS.

GROUND TERMINAL
SHOULD REST
AGAINST MOTOR
HSG. POST

PLACE EXCESS LEAD WIRE HERE.

SWITCH MUST BE
SEATED ON POSTS.

WIRING SPECIFICATIONS

Wire No.	Wire Color	Origin or Part No.	Gauge	Length	Terminals, Connectors and End Wire Preparation
1	White	Cord	18	3-3/4"	Strip 3/8" and tin.
2	Black	Cord	18	3-3/4"	Strip 3/8" and tin.
3	Green	Cord	18	5-1/2"	Strip 3/16" for T1.
4	Black	Remote Assy.	18	5-7/8"	Strip 3/16" and tin.
5	White	23-94-6115	18	8"	Strip 3/16" for T3 / Strip 3/8" tin.
7	Yellow	23-94-6110	18	5-5/16"	Strip both ends 3/16" for T3.
8	Black	Remote Assy.	18	5-1/4"	Strip 1/4" for T2.
9	Black	Remote Assy.	18	7-1/4"	Strip 1/4" for T2.
10	Red	Remote Assy.	18	5-1/4"	Strip 3/16" for T3.
11	Black	Remote Assy.	18	9-7/16"	Strip 5/16" and tin.
12	Black	Remote Assy.	18	10-3/32"	Strip 3/16" for T4.

BULK LEAD WIRE - BULLETIN 58-01-0003

NOTE:
All leads must be held to $\pm 1/8"$.
All lead lengths are before stripping.

TERMINAL DESCRIPTION		
Code	Part No.	Qty.
T1	23-74-0896	1
T2	23-74-0410	2
T3	23-74-1060	4
T4	23-74-0900	1