

# WIRING INSTRUCTIONS

TITLE

MAGNUM® TOOLS

BULLETIN  
58-01-1650

NOTICE:  
ROUTE WIRE 3  
AROUND BOSS  
AND PRESS INTO  
WIRETRAP.

ORIENTATE IN-LINE FASTON  
TERMINALS AS SHOWN (I.E.  
BARRELS TO THE INSIDE),  
2 PLACES.

ROUTE WIRES IN  
MAIN TRAP FROM  
BOTTOM TO TOP  
AS FOLLOWS:  
WIRES 3, 9, 10,  
6 AND 5.

FORM WIRES  
4 AND 6 AS  
SHOWN, BEFORE  
PLACING SWITCH  
IN HANDLE, TO  
AVOID PINCHING  
WIRES UNDER  
SWITCH.

\* TO REMOVE A WIRE FROM THE BOTTOM  
OF SWITCH, INSERT A THIN (.04 DIA.)  
INSTRUMENT INTO THE SMALL HOLE  
NEAREST THE WIRE, ANGLED TOWARD  
THE WIRE. SWITCH SHOULD THEN BE  
REPLACED.

ROUTE WIRE 8 UNDER WIRES 9 AND 10, DIRECTLY OVER  
MOTOR HOUSING BEARING BOSS. ROUTE ALL WIRES  
OVER MOTOR HOUSING BEARING BOSS TO PREVENT  
PINCHING UNDER HANDLE COVER.

WIRES TO BE KEPT AWAY FROM THIS AREA TO  
AVOID PINCHING UNDER HANDLE COVER.

TUCK WIRES DOWN  
INTO TRAP. DRESS  
WIRES AS  
NECESSARY TO  
PREVENT  
PINCHING UNDER  
HANDLE COVER.

WIRE #3 MUST BE  
IN FAR LEFT WIRE  
TRAP. WIRES 9 &  
10 CAN BE  
PLACED IN TWO  
OTHER TRAPS IN  
ANY ORDER.

LEAD WIRE TO BE INSERTED  
INTO SWITCH SO INSULATION  
IS FLUSH-SUBFLUSH  
WITH OPENING

CAN BE ORIENTATED 180°  
FROM AS SHOWN.

TAKE CARE TO AVOID  
PINCHING WIRE UNDER  
SWITCH.

WIRES TO BE  
KEPT AWAY  
FROM THIS  
AREA TO  
AVOID  
PINCHING.

DO NOT  
ROUTE  
WIRES IN  
SHADED  
AREA.

WIRING SPECIFICATIONS					
Wire No.	Wire Color	Origin or Part No.	Gauge	Length	Terminals, Connectors and End Wire Preparation
1	Black	Pin Hsg. Assy.	18	----	Component of pin housing assembly.
2	White	Pin Hsg. Assy.	18	----	Component of pin housing assembly.
3	Green	Pin Hsg. Assy.	18	----	Component of pin housing assembly / Strip 3/16" for T1.
4	Blue	23-94-6247	18	2-3/8"	Strip 3/16" for T4 / Strip 3/16" and tin.
5	Blue	23-94-6232	18	4"	Strip 3/16" for T3 / Strip 3/16" and tin.
6	White	23-94-6237	18	4-1/8"	Strip 3/16" for T4 / Strip 3/16" and tin.
8	Black	Module	18	2"	Strip 3/16" for T4.
9	Black	Module	18	5-1/2"	Strip 5/16" and tin.
10	Blue	Module	18	5-1/2"	Strip 5/16" and tin.
11	White	23-94-6242	18	3-3/8"	Strip 3/16" for T3 / Strip 3/16" for T4.

BULK LEAD WIRE - BULLETIN 58-01-0003

NOTE:  
All leads must be held to ± 1/8".  
All lead lengths are before stripping.

TERMINAL DESCRIPTION		
Code	Part No.	Qty.
T1	23-74-0615	1
T3	23-74-1090	2
T4	23-74-1100	4

CONNECTOR DESCRIPTION		

# WIRING INSTRUCTIONS

TITLE

MAGNUM TOOLS

BULLETIN  
58-01-1651

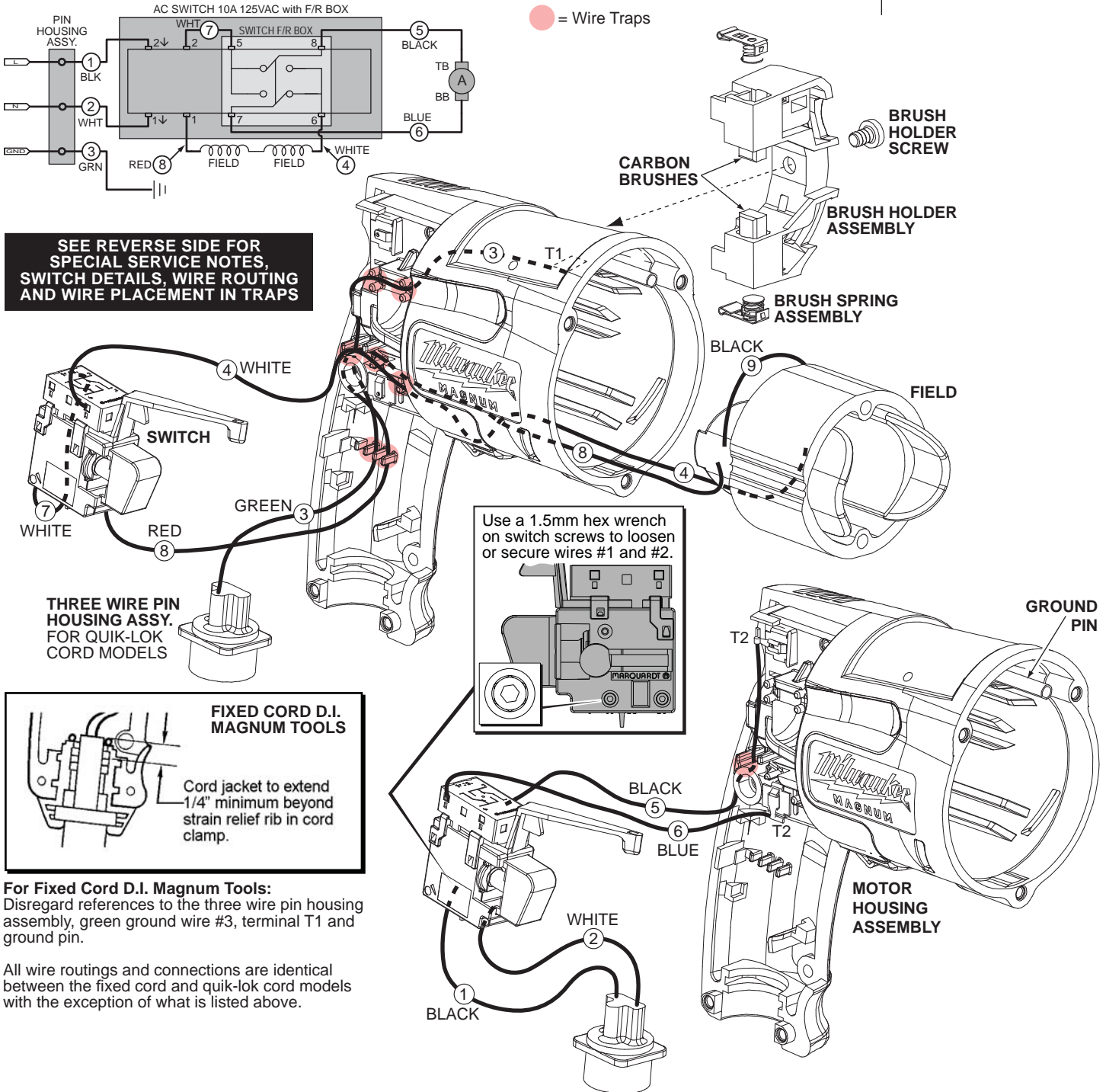

## WIRING SPECIFICATIONS

Wire No.	Wire Color	Origin or Part No.	Gauge	Length	Terminals, Connectors and End Wire Preparation
1	Black	Cord	18	----	Component of Pin Housing Assembly 22-56-0845.
2	White	Cord	18	----	Component of Pin Housing Assembly 22-56-0845.
3	Green	Cord	18	----	Component of Pin Hsg. Assy. 22-56-0845. Strip 3/16" for T1.
4	White	Field	18	5-3/4"	Component of Field 18-11-0076. Strip 5/16" and tin.
5	Black	23-94-6336	18	4-1/2"	Strip 3/16" for T2. Strip 3/16" and tin.
6	Blue	23-94-6248	18	1-3/4"	Strip 3/16" for T2. Strip 3/16" and tin.
7	White	23-94-6405	18	2-7/8"	Strip both ends 3/16" and tin.
8	Red	Field	18	5-3/4"	Component of Field 18-11-0076. Strip 5/16" and tin.
9	Black	Field Jumper	18	----	Component of Field 18-11-0076.

BULK LEAD WIRE - BULLETIN 58-01-0003

### NOTE:

All leads must be held to  $\pm 1/8"$ .  
All lead lengths are before stripping.

### TERMINAL DESCRIPTION

	Part No.	Qty.
T1	23-74-0615	1
T2	23-74-1100	2

### CONNECTOR DESCRIPTION

● = Wire Traps

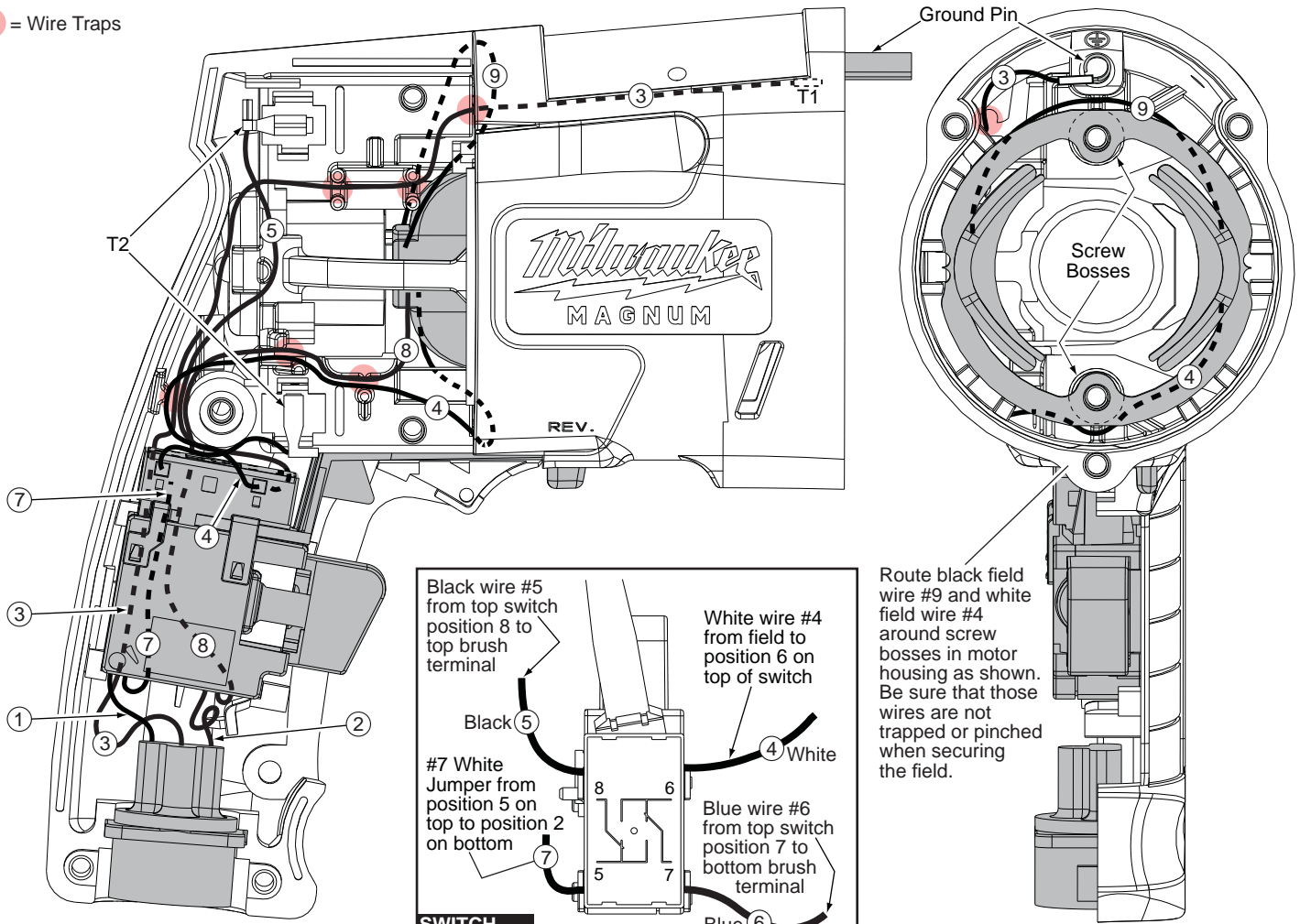

Route black field wire #9 and white field wire #4 around screw bosses in motor housing as shown. Be sure that those wires are not trapped or pinched when securing the field.

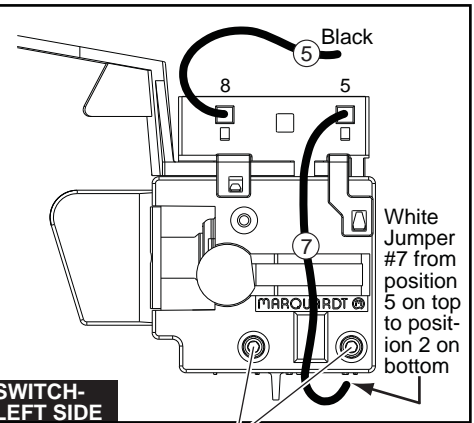
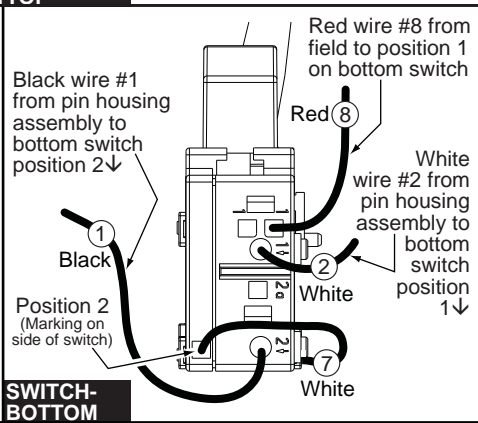
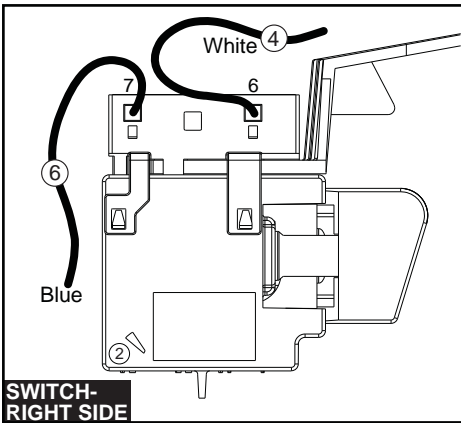
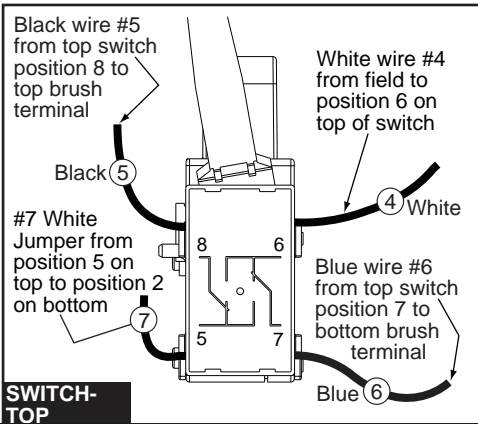

Use a 1.5mm hex wrench on switch screws to secure or loosen cord wires #1 & #2 (See detail on front).

**NOTE:**  
All leads must be held to ± 1/8".  
All lead lengths are before stripping.

**WIRING SPECIFICATIONS**

Wire No.	Wire Color	Origin or Part No.	Gauge	Length	Terminals, Connectors and End Wire Preparation
1	Black	Cord	18	-----	Component of Pin Housing Assembly 22-56-0845.
2	White	Cord	18	-----	Component of Pin Housing Assembly 22-56-0845.
3	Green	Cord	18	-----	Component of Pin Hsg. Assy. 22-56-0845. Strip 3/16" for T1.
4	White	Field	18	5-3/4"	Component of Field 18-11-0076. Strip 5/16" and tin.
5	Black	23-94-6336	18	4-1/2"	Strip 3/16" for T2. Strip 3/16" and tin.
6	Blue	23-94-6248	18	1-3/4"	Strip 3/16" for T2. Strip 3/16" and tin.
7	White	23-94-6405	18	2-7/8"	Strip both ends 3/16" and tin.
8	Red	Field	18	5-3/4"	Component of Field 18-11-0076. Strip 5/16" and tin.
9	Black	Field Jumper	18	-----	Component of Field 18-11-0076.

**BULK LEAD WIRE - BULLETIN 58-01-0003**

TERMINAL DESCRIPTION		
	Part No.	Qty.
T1	23-74-0615	1
T2	23-74-1100	2
CONNECTOR DESCRIPTION		

For Fixed Cord D.I. Magnum Tools: Disregard references to the three wire pin housing assembly, green ground wire #3, terminal T1 and ground pin. All wire routings and connections are identical between the fixed cord and quik-lok cord models with the exception of what is listed above.

# WIRING INSTRUCTIONS

TITLE **DOUBLE REDUCTION PISTOL GRIP TOOLS**

**BULLETIN  
58-01-1805**

**FOR DOUBLE INSULATED TOOLS  
DISREGARD GREEN GROUND WIRE #3  
AND THE GROUNDING TERMINAL**

Grounding terminal  
Green ground wire #3 connects to male tab of grounding terminal. Position terminal as shown. (Grounded models only).

Route blue brush wire #5 and white brush wire #6 through wire traps over rear bearing bore as shown.

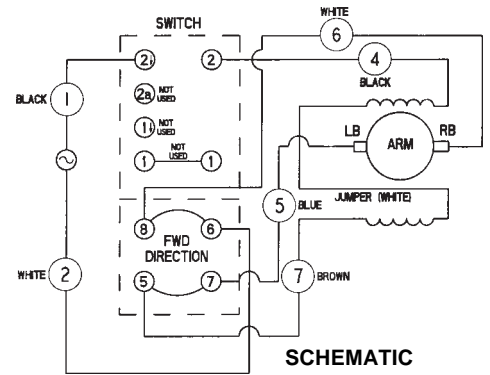
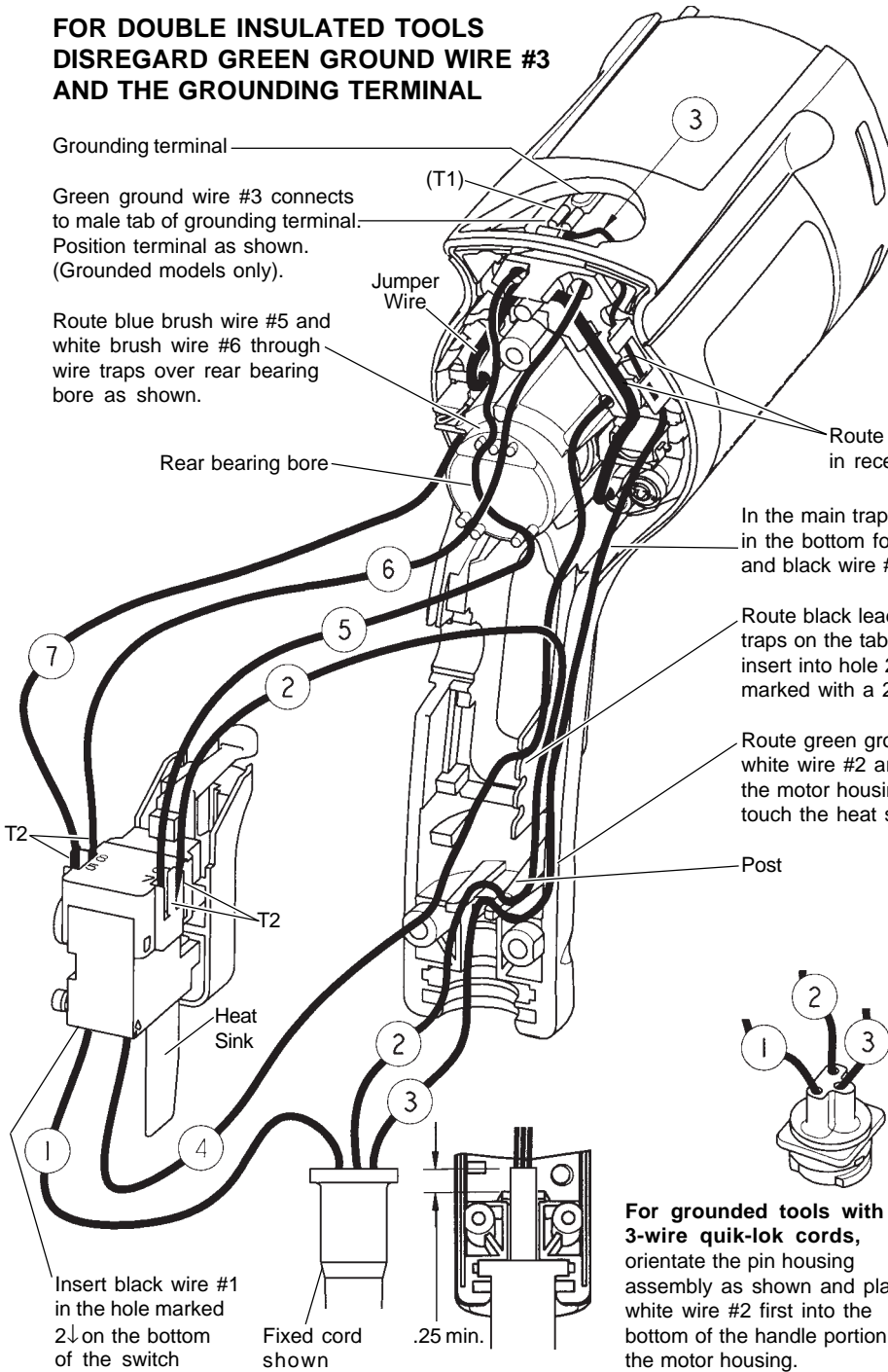

In the main trap, route green ground wire #3 in the bottom followed by the white wire #2 and black wire #4 on the top.

Route black lead #4 through any of the three traps on the tab of the motor housing and insert into hole 2 on bottom of switch (Hole is marked with a 2 on side of switch).

Route green ground wire #3 and white wire #2 around the post in the motor housing. Wires cannot touch the heat sink of the switch.

Black wire #1 Black wire #4

If screw is present seat screw fully.

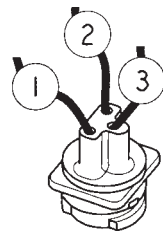
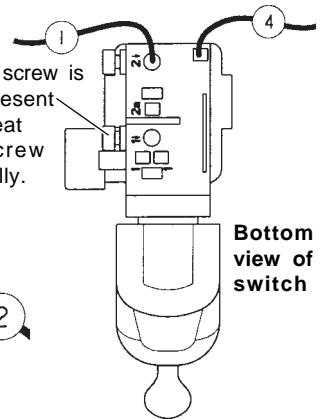

**For grounded tools with 3-wire quik-lok cords,** orientate the pin housing assembly as shown and place white wire #2 first into the bottom of the handle portion of the motor housing.

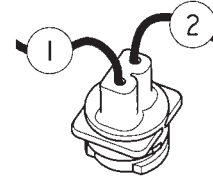

**For double insulated tools with 2-wire quik-lok cords,** orientate the blade housing assembly as shown and place white wire #2 first into the bottom of the handle portion of the motor housing.

## WIRING SPECIFICATIONS

Wire No.	Wire Color	Origin or Gauge	Length	Terminals, Connectors and 1 or 2 End Wire Preparation
1	Black	*	----	*Component of cord set, pin hsg. assy. or blade hsg. assy.
2	White	*	----	*Component of cord set, pin hsg. assy. or blade hsg. assy.
3	Green	*	----	*Component of cord set, pin hsg. assy. or blade hsg. assy.
4	Black	**	----	**Component of the brush card assembly.
5	Blue	**	----	**Component of the brush card assembly.
6	White	**	----	**Component of the brush card assembly.
7	Brown	**	----	**Component of the brush card assembly.

## TERMINAL DESCRIPTION

Code	Part No.	Qty.
T1	23-74-0605	1
T2	23-74-1060	4



# WIRING INSTRUCTIONS

TITLE

**DOUBLE REDUCTION PISTOL GRIP TOOLS**

**BULLETIN  
58-01-1806**

**FOR DOUBLE INSULATED TOOLS  
DISREGARD GREEN GROUND WIRE #3  
AND THE GROUNDING TERMINAL**

Grounding terminal  
Green ground wire #3 connects to male tab of grounding terminal. Position terminal as shown. (Grounded models only).

Route blue brush wire #5 and white brush wire #6 through wire traps over rear bearing bore as shown.

Rear bearing bore

Jumper Wire

Route green ground wire #3 and jumper wire (white) in recessed area of brush card as shown.

In the main trap, route green ground wire #3 in the bottom followed by the white wire #2 and black wire #4 on the top.

Route black lead #4 through any of the three traps on the tab of the motor housing and insert into hole 2a on bottom of switch. (Hole is marked with a 2a on side of switch).

Route green ground wire #3 and white wire #2 around the post in the motor housing.

Post

If screw is present seat screw fully.

Bottom view of switch

Insert black wire #1 in the hole marked 2 on the bottom of the switch

Fixed cord shown

.25 min.

**For grounded tools with 3-wire quik-lok cords,** orientate the pin housing assembly as shown and place white wire #2 first into the bottom of the handle portion of the motor housing.

**For double insulated tools with 2-wire quik-lok cords,** orientate the blade housing assembly as shown and place white wire #2 first into the bottom of the handle portion of the motor housing.

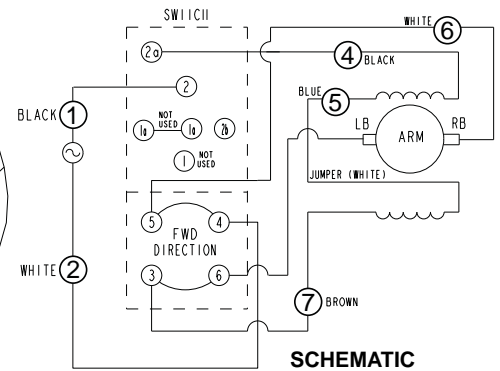

WIRING SPECIFICATIONS				
Wire No.	Wire Color	Origin or Gauge	Length	Terminals, Connectors and 1 or 2 End Wire Preparation
1	Black	*	----	*Component of cord set, pin hsg. assy. or blade hsg. assy.
2	White	*	----	*Component of cord set, pin hsg. assy. or blade hsg. assy.
3	Green	*	----	*Component of cord set, pin hsg. assy. or blade hsg. assy.
4	Black	**	----	**Component of the brush card assembly.
5	Blue	**	----	**Component of the brush card assembly.
6	White	**	----	**Component of the brush card assembly.
7	Brown	**	----	**Component of the brush card assembly.

**BULK LEAD WIRE - BULLETIN NO. 58-01-0003**

TERMINAL DESCRIPTION		
Code	Part No.	Qty.
T1	23-74-0605	1
T2	23-74-1060	4

Rely on premium drills and drivers by Milwaukee if you're looking for quality and efficiency.