

# QUICKSTART

## SK103P

- 1 On/Set key
- 2 Pulse key
- 3 Lock switch
- 4 Locked
- 5 Laser active
- 6 Pulse/Power save mode on
- 7 Laser line horizontal
- 8 Laser line vertical
- 9 Laser horizontal and vertical line
- 10 Laser all points
- 11 Laser all lines and points

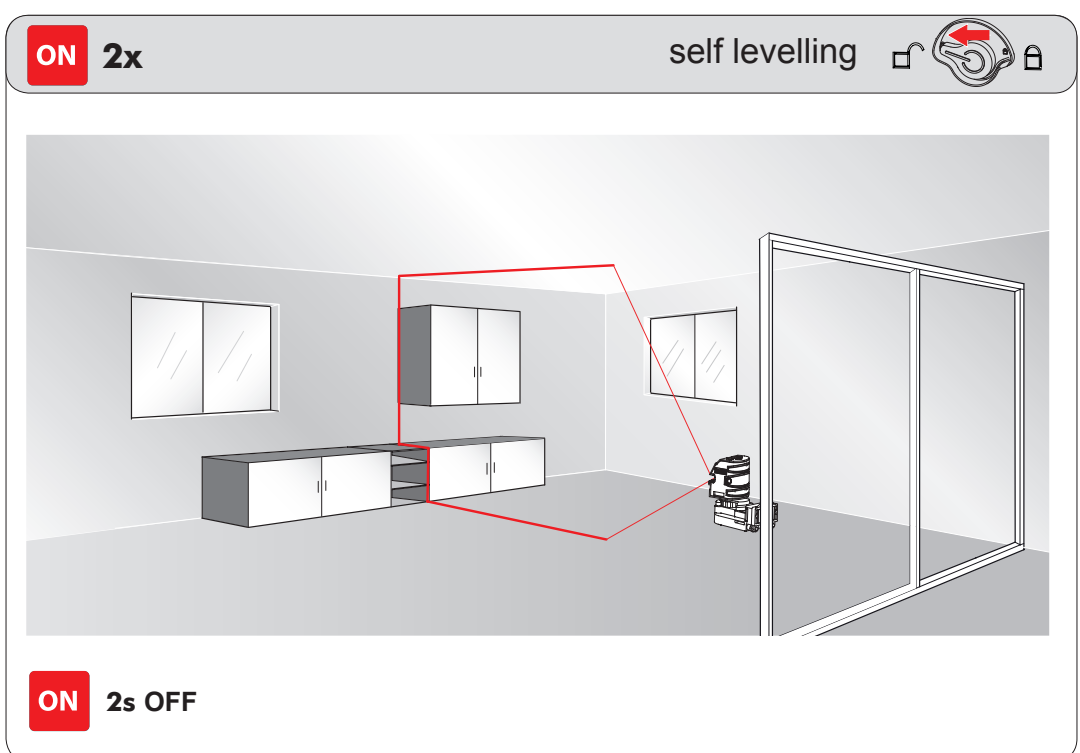
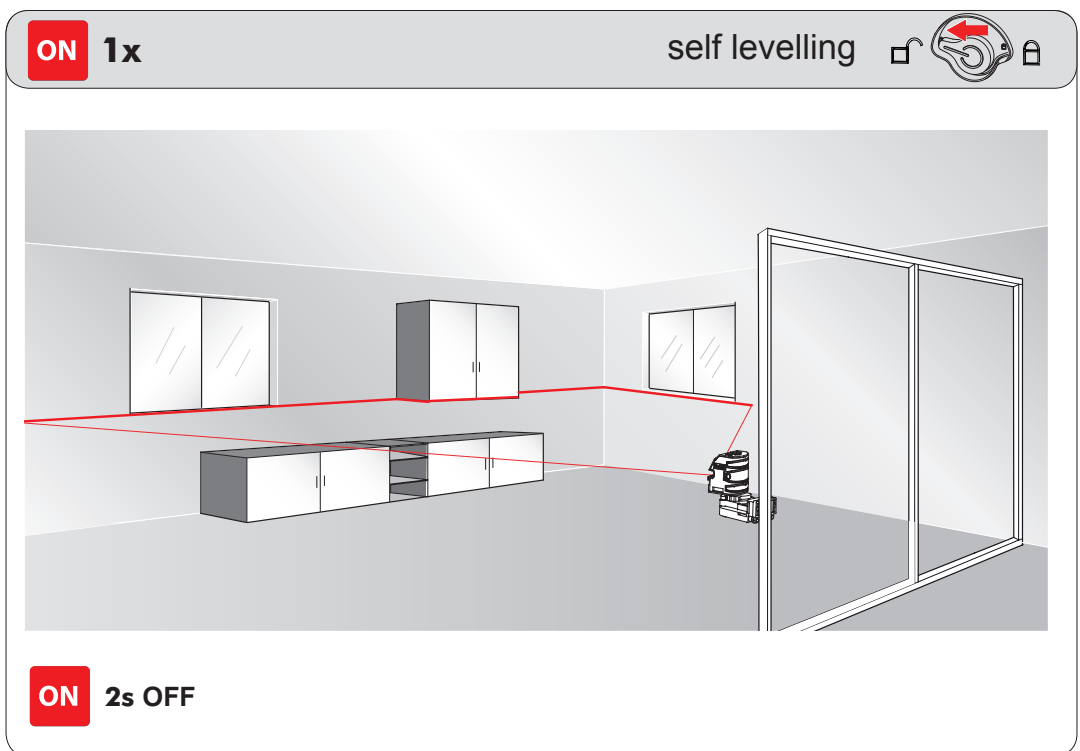
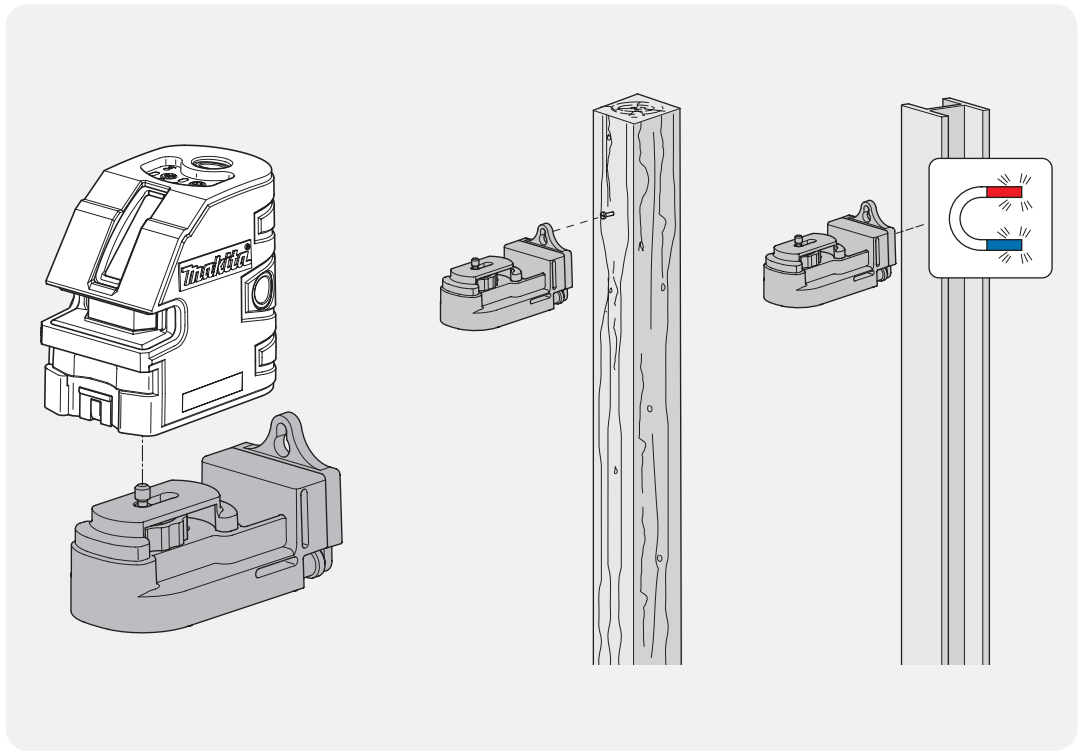
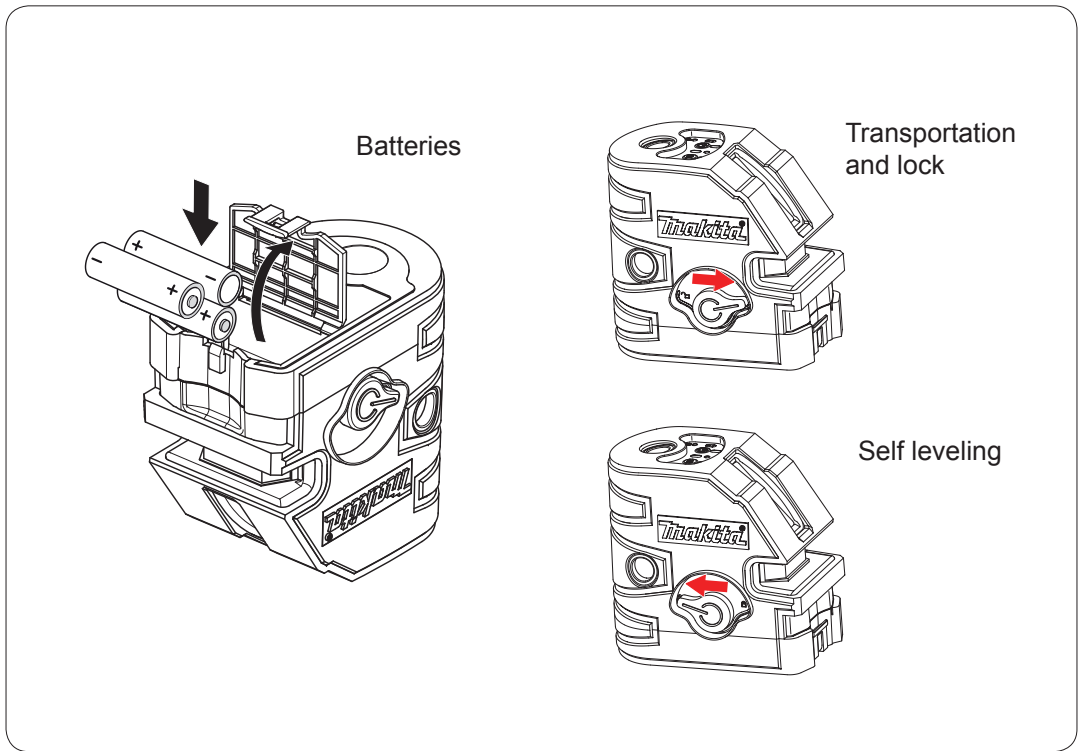
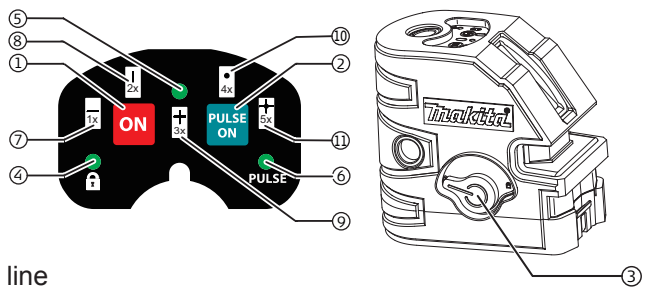

	LASER 2	
IEC 60825-1:2014	$\lambda=635\text{nm}$ Pav.=0.95m	Wtp=50 $\mu\text{s}$ ,

**ON** 3x

self levelling

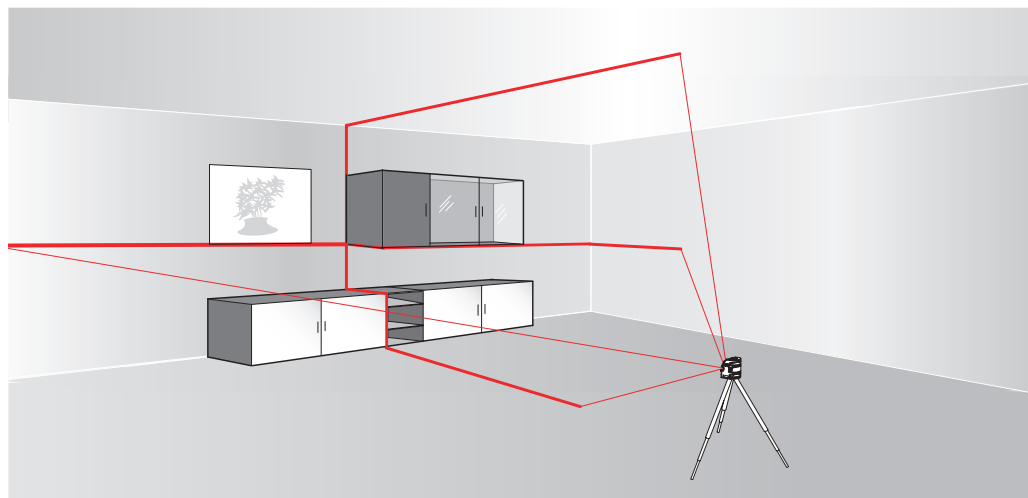

**ON** 2s OFF

**ON** 4x

self levelling

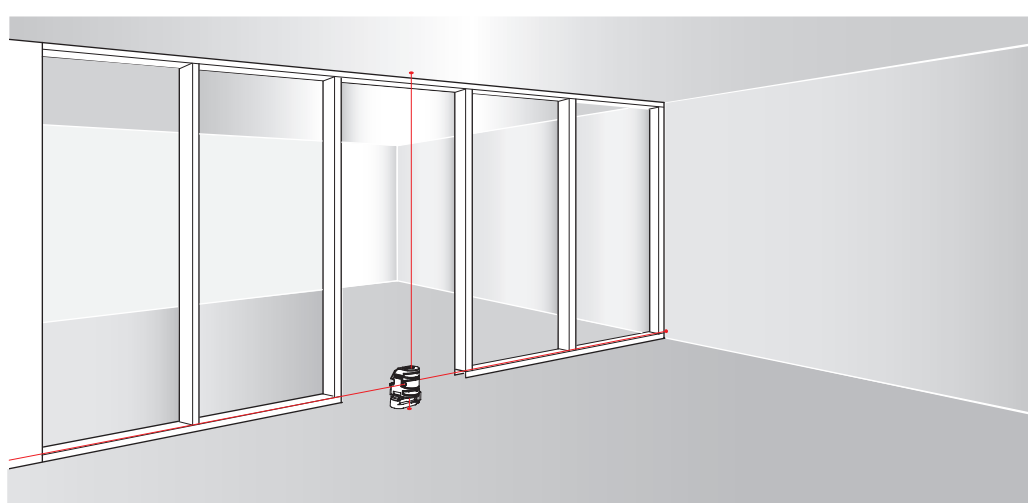

**ON** 2s OFF

**ON** 5x

self levelling

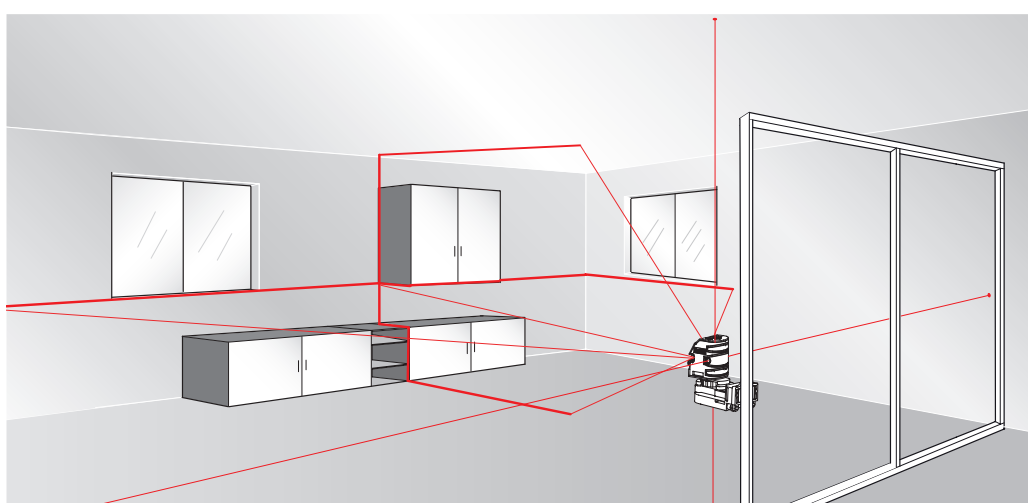

**ON** 2s OFF

**PULSE ON** 1x

self levelling

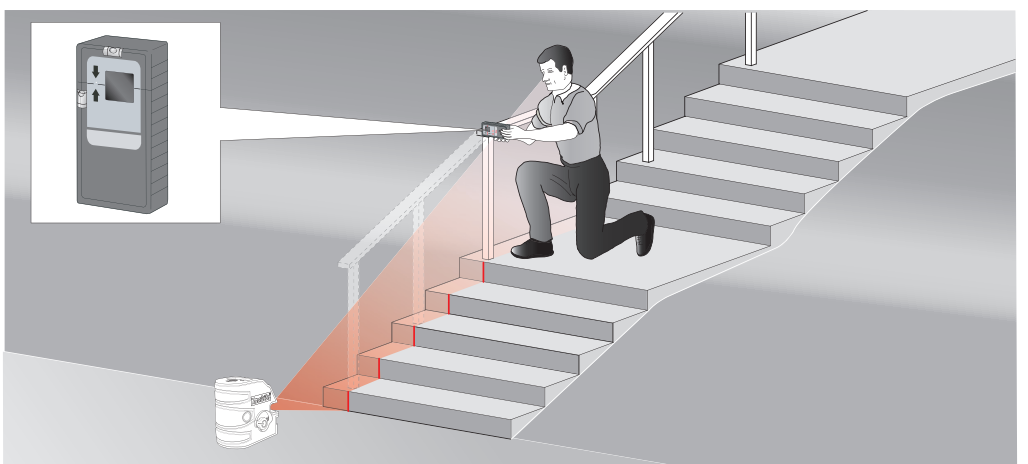

**ON** 1x

**ON** 2x

lock

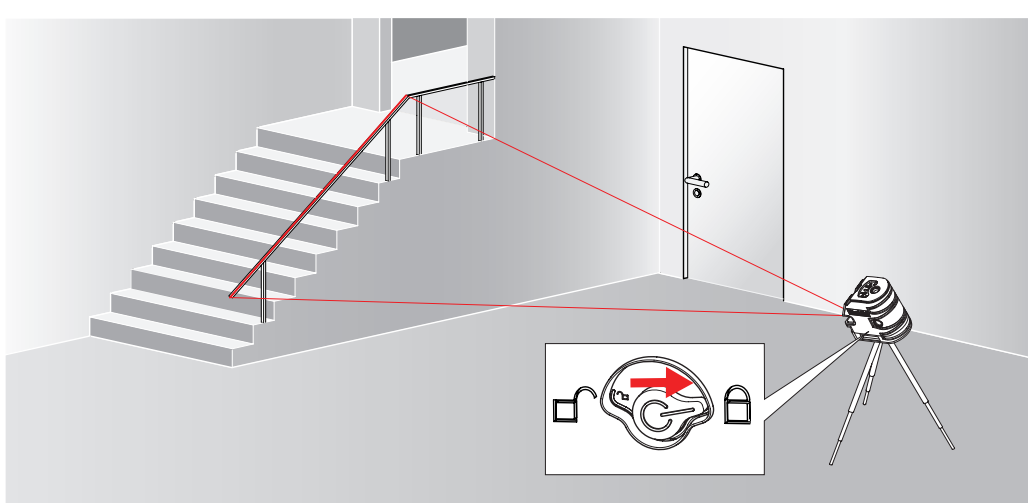

**ON** 2s OFF