

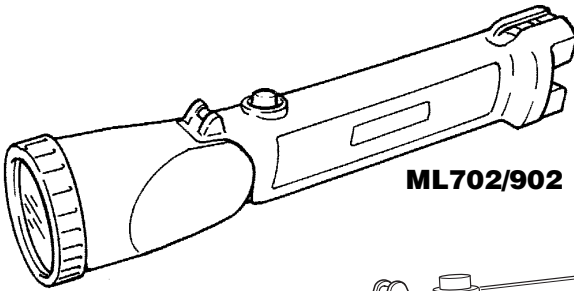

- Rechargeable Flashlight

ML702/ML901/ML902/ML903



ML702/902

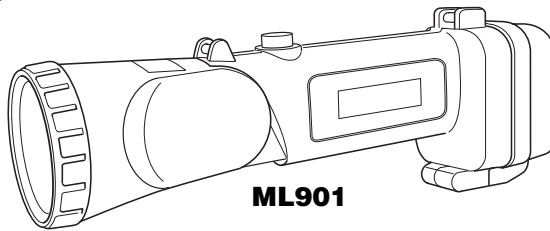

ML901

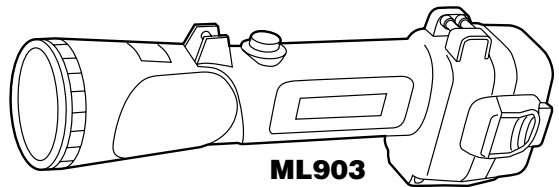

ML903

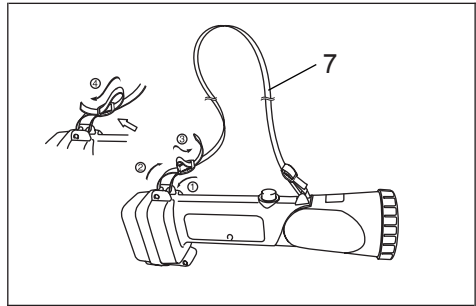
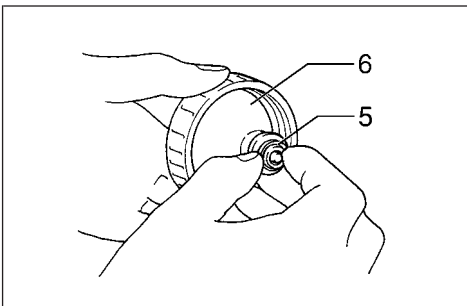
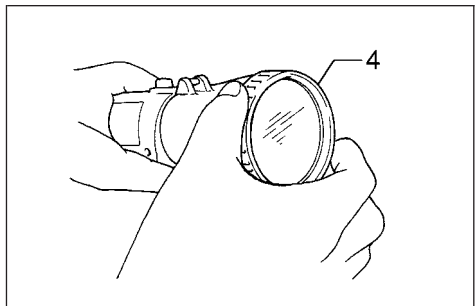
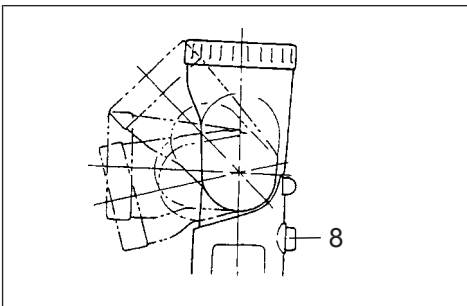
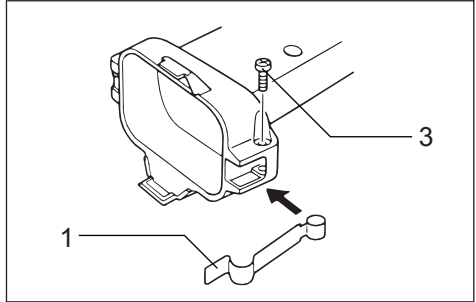
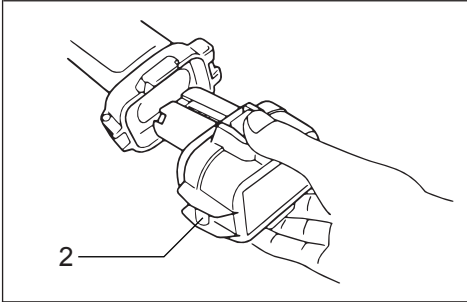
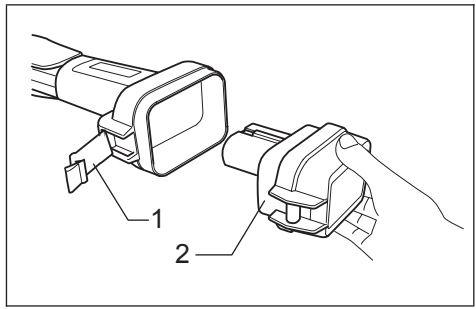
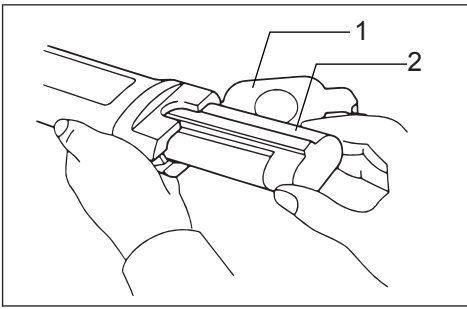

7

8

Symbols

The following show the symbols used for the tool. Be sure that you understand their meaning before use.



Read instruction manual.



Do not touch the bulb which is hot in use or immediately after putting out light. You may get burnt.

Explanation of general view

1 Set plate	4 Ring	7 Shoulder strap
2 Battery cartridge	5 Bulb holder	8 Switch
3 Screw	6 Reflector	

SPECIFICATIONS

Model	ML702	ML901	ML902	ML903
Bulb	7.2 V 0.55 A	9.6 V 0.5 A	9.6 V 0.5 A	9.6 V 0.5 A
Dimensions (L x W x H)	283 x 67 x 71 mm (11-1/8" x 2-5/8" x 2-13/16")	254 x 67 x 96 mm (10" x 2-5/8" x 3-3/4")	325 x 67 x 71 mm (12-13/16" x 2-5/8" x 2-13/16")	254 x 77 x 98 mm (10" x 3" x 3-7/8")
Net weight	0.22 kg (0.49 lbs)	0.23 kg (0.51 lbs)	0.25 kg (0.55 lbs)	0.23 kg (0.51 lbs)

- Due to our continuing program of research and development, the specifications herein are subject to change without notice.
- Note: Specifications may differ from country to country.

IMPORTANT SAFETY INSTRUCTIONS

WARNING:

When using electric tools, basic safety precautions should always be followed to reduce the risk of fire, electric shock, and personal injury, including the following:

READ ALL INSTRUCTIONS.

1. Read this instruction manual and the charger instruction manual carefully before use.
2. This flashlight is not water-proof. Do not use it in damp or wet locations. Do not expose it to rain or snow. Do not wash it in water.
3. A short-circuit can cause a large current flow, overheating, possible burns and even a breakdown.
 - (1) Do not touch the inside of the flashlight head with tweezers, metal tools, etc.
 - (2) Do not touch the battery terminals with any conductive material.
 - (3) Avoid storing the battery cartridge in a container with any metal objects such as nails, coins, etc.
4. Never expose the battery cartridge to flames, fire or great heat. Breakage may cause release of injurious material.
5. If electrolyte gets into your eyes, rinse them out with clear water and seek medical attention right away. It may result in loss of your eyesight.
6. If operating time has become excessively shorter, stop operating immediately. It may result in a risk of overheating, possible burns and even an explosion.
7. Be careful not to drop, shake or strike battery.
8. When the tool is not in use, always switch off and remove the battery cartridge from the tool.
9. Do not store the tool and battery cartridge in locations where the temperature may reach or exceed 50°C (122°F).
10. Do not give the tool a shock by dropping, striking, etc.
11. Do not expose the light to eyes continuously. It may hurt them.
12. Do not cover or clog the lit tool with cloth or carton, etc. It may create a risk of fire.
13. Switch off the light immediately when the lamp gets dark in use. If you leave the lamp switched on, the battery cartridge capacity may decrease.
14. Do not disassemble the charger or battery cartridge; take it to a qualified serviceman when service or repair is required. Incorrect reassembly may result in a risk of electric shock or fire.
15. If any problem develops, consult your nearest Makita Service Center or dealer. To maintain product safety and reliability, repairs, maintenance or adjustment should be carried out by Makita Authorized Service Center.

SAVE THESE INSTRUCTIONS.

For USA only Recycling the Battery

The only way to dispose of a Makita battery is to recycle it. The law prohibits any other method of disposal.

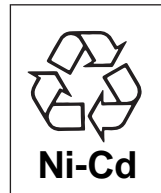

To recycle the battery:

1. Remove the battery from the tool.
2. a). Take the battery to your nearest Makita Factory Service Center or
or
b). Take the battery to your nearest Makita Authorized Service Center or Distributor that has been designated as a Makita battery recycling location.
 - *Call your nearest Makita Service Center or Distributor to determine the location that provides Makita battery recycling. See your local Yellow Pages under "Tools-Electric".*

OPERATING INSTRUCTIONS

Charging

For ML702 (Fig. 1), ML902 (Fig. 1) and ML901 (Fig. 2)

Charge the battery cartridge with the Makita charger before use. To remove the battery cartridge, pull out the set plate on the torch/flashlight and grasp both sides of the cartridge while withdrawing it from the torch/flashlight. After charging, insert the battery cartridge into the torch/flashlight and snap the set plate back into place.

For ML903 (Fig. 3)

Charge the battery cartridge with the Makita charger before use. To remove the battery cartridge, withdraw it from the torch/flashlight while pressing the buttons on both sides of the cartridge. After charging, insert the battery cartridge into the torch/flashlight all the way until it locks in place with a little click.

NOTE:

Battery cartridge 9100, 9102, 9100A and 9102A can be used on ML903 if you install the set plate. Install the set plate on ML903 with the screw provided as shown in **Fig. 4**.

The following tables indicate the charging time and operating time on a single charge.

ML702

Voltage	Battery cartridge	Operating time	Charger
7.2 V	7000	Approx. 140 min.	DC7100, DC9710, DC9711, DC1201, DC1411, DC1439, DC1470, DC1422, DC1801
	7002	Approx. 210 min.	DC9711, DC1201, DC1411, DC1439, DC1422, DC1801
	7033	Approx. 240 min.	DC9711, DC1411, DC1439, DC1422, DC1801

ML901/ML903

Voltage	Battery cartridge	Operating time	Charger
9.6 V	9100, 9100A, 9120	Approx. 160 min.	DC9710, DC9711, DC1201, DC1411, DC1439, DC1470, DC1422, DC1801
	9102, 9102A, 9122	Approx. 230 min.	DC9711, DC1201, DC1411, DC1439, DC1422, DC1801
	9133	Approx. 260 min.	DC9711, DC1411, DC1439, DC1422, DC1801
	9134	Approx. 310 min.	
	9135, 9135A	Approx. 360 min.	

(Note)

If you use a power checking battery on Model ML901/ML903, the power checking battery will not indicate the remaining battery capacity properly.

ML902

Voltage	Battery cartridge	Operating time	Charger
9.6 V	9000	Approx. 160 min.	DC9710, DC9711, DC1201, DC1411, DC1439, DC1470, DC1422, DC1801
	9002	Approx. 230 min.	DC9711, DC1201, DC1411, DC1439, DC1422, DC1801
	9033	Approx. 260 min.	DC9711, DC1411, DC1439, DC1422, DC1801

Storing battery cartridge

Always charge the Nickel Metal Hydride battery cartridge before storing it when you do not use it for more than six months.

Head angle (Fig. 5)

The head angle can be adjusted in four stages. Adjust as desired.

Replacing bulb (Fig. 6 & 7)

CAUTION:

The bulb is very hot immediately after operation. Wait until the bulb cools off before attempting to replace it.

First, turn the ring counterclockwise and remove the reflector. Remove the bulb holder by turning it counterclockwise. Then replace the bulb.

Shoulder strap (Fig. 8)

Install the strap on the tool.

MAINTENANCE

To maintain product safety and reliability, repairs, maintenance or adjustment should be carried out by a Makita Authorized Service Center.

ACCESSORIES

CAUTION:

These accessories or attachments are recommended for use with your Makita tool specified in this manual. The use of any other accessories or attachments might present a risk of injury to persons. The accessories or attachments should be used only in the proper and intended manner.

- Bulb set (2 pcs)
- Shoulder strap
- Set plate (For Model ML903)