

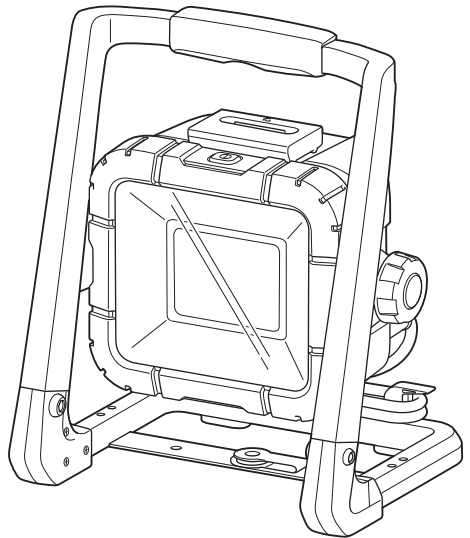

INSTRUCTION MANUAL

Corded and Cordless LED Worklight

DML805



DOUBLE INSULATION

IMPORTANT: Read Before Using.

SPECIFICATIONS

Model	DML805			
LED	20 pcs, 10 W			
Operating time* (with Battery BL1830)	(Approximately) High: 5 hours / Low: 10 hours			
Power source	100-240 V 50-60 Hz AC or 14.4 V / 18 V DC			
Standard battery cartridge	BL1415 / BL1415N	BL1430 / BL1440 / BL1450	BL1815 / BL1815N / BL1820	BL1830 / BL1840 / BL1850
Voltage (with battery operation)	14.4 V		18 V	
Dimensions (L x W x H)	8-3/8" x 10-1/4" x 12-7/8" (214 mm x 261 mm x 328 mm)			
Net weight	5.1 lbs (2.3 kg)	5.5 lbs (2.5 kg)	5.2 lbs (2.4 kg)	5.8 lbs (2.6 kg)
Pressure receiving area (Lens area)	0.0195 m ²			

- Due to our continuing program of research and development, the specifications herein are subject to change without notice.
 - Specifications and battery cartridge may differ from country to country.
 - Weight, with battery cartridge, according to EPTA-Procedure 01/2003
- * This value is only advisory. This may vary according to the condition and environment of the battery.

Symbols

The following show the symbols used for the equipment. Be sure that you understand their meaning before use.



- Read instruction manual.



- Indoor use only



- Only for EU countries
Do not dispose of electric equipment or battery pack together with household waste material!

In observance of the European Directives, on Waste Electric and Electronic Equipment and Batteries and Accumulators and Waste Batteries and Accumulators and their implementation in accordance with national laws, electric equipment and batteries and battery pack(s) that have reached the end of their life must be collected separately and returned to an environmentally compatible recycling facility.



- DOUBLE INSULATION



- Optical Radiation (UV and IR).
Minimize exposure to eyes or skin.



- Do not stare at operating lamp.



- Use appropriate shielding or eyes protection.



- Take particular care and attention!

IMPORTANT SAFETY INSTRUCTIONS

⚠ WARNING: When using electric tools, basic safety precautions should always be followed to reduce the risk of fire, electric shock, and personal injury, including the following:

READ ALL INSTRUCTIONS.

⚠ CAUTION:

1. When the tool is not in use, always switch off, and unplug / remove the battery cartridge from the tool.
2. Do not cover or clog the lit tool with cloth or carton, etc. Covering or clogging it may cause a flame.
3. Do not use the tool in damp or wet locations. Do not expose the tool to rain or snow. Do not wash it in water.
4. Do not use the tool in explosive atmospheres, such as in the presence of flammable liquids, gases or dust.
5. Power tool plugs must match the outlet. Never modify the plug in any way. Do not use any adapter plugs with earthed (grounded) power tools. Unmodified plugs and matching outlets will reduce risk of electric shock.
6. Avoid body contact with earthed or grounded surfaces such as pipes, radiators, ranges and refrigerators. There is an increased risk of electric shock if your body is earthed or grounded.

7. Do not abuse the cord. Never use the cord for carrying, pulling or unplugging the power tool. Keep cord away from heat, oil, sharp edges or moving parts. Damaged or entangled cords increase the risk of electric shock.
8. When operating a power tool outdoors, use an extension cord suitable for outdoor use. Use of a cord suitable for outdoor use reduces the risk of electric shock.
9. If external flexible cable or cord of this luminaire is damaged, it shall be exclusively replaced by authorized service center in order to avoid a hazard.
10. Do not look in the LED light or see the source of light directly.

The lamp was classified at risk Group 1.

- a) The lamp or lamp system is in excess of the Exempt Group and that the viewer related risk is dependent upon how the users install and use the product;
- b) The most restrictive optical radiation hazard and other optical radiation hazards in excess of Exempt Group.
- c) Proper assembly, installation, maintenance and safe use, including clear warnings concerning precautions to avoid possible exposure to hazardous optical radiation.
- d) Advice on safe operation procedures and warnings concerning reasonably foreseeable malpractices, malfunctions and hazardous failure modes.
- e) NOTICE: UV and IR emitted from this product.
- f) WARNING: IR emitted from this product.
- g) CAUTION: Possibly hazardous optical radiation emitted from this product.
- h) Minimize exposure to eyes or skin. Use appropriate shielding.
- i) Use appropriate shielding or eye protection.
- j) Do not stare at operating lamp. May be harmful to the eyes.
- k) Eye or skin irritation may result from exposure. Avoid eye exposure.

Battery tool use and care

1. Recharge only with the charger specified by the manufacturer. A charger that is suitable for one type of battery cartridge may create a risk of fire when used with another battery cartridge.
2. Use power tools only with specifically designated battery cartridges. Use of any other battery cartridges may create a risk of injury and fire.
3. When the battery cartridge is not in use, keep it away from other metal objects, like paper clips, coins, keys, nails, screws or other small metal objects that can make a connection from one terminal to another. Shorting the battery terminals together may cause burns or a fire.
4. Under abusive conditions, liquid may be ejected from the battery; avoid contact. If contact accidentally occurs, flush with water. If liquid contacts eyes, additionally seek medical help. Liquid ejected from the battery may cause irritation or burns.

IMPORTANT SAFETY INSTRUCTIONS FOR BATTERY CARTRIDGE

1. Before using battery cartridge, read all instructions and cautionary markings on (1) battery charger, (2) battery, and (3) product using battery.
2. Do not disassemble battery cartridge.
3. If operating time has become excessively shorter, stop operating immediately. It may result in a risk of overheating, possible burns and even an explosion.
4. If electrolyte gets into your eyes, rinse them out with clear water and seek medical attention right away. It may result in loss of your eyesight.
5. Do not short the battery cartridge:
 - (1) Do not touch the terminals with any conductive material.
 - (2) Avoid storing battery cartridge in a container with other metal objects such as nails, coins, etc.
 - (3) Do not expose battery cartridge to water or rain. A battery short can cause a large current flow, overheating, possible burns and even a breakdown.
6. Do not store the tool and battery cartridge in locations where the temperature may reach or exceed 50°C (122°F).
7. Do not incinerate the battery cartridge even if it is severely damaged or is completely worn out. The battery cartridge can explode in a fire.
8. Be careful not to drop or strike battery.
9. Do not use a damaged battery.
10. Follow your local regulations relating to disposal of battery.

Tips for maintaining maximum battery life

1. Charge the battery cartridge before completely discharged. Always stop tool operation and charge the battery cartridge when you notice less tool power.
2. Never recharge a fully charged battery cartridge. Overcharging shortens the battery service life.
3. Charge the battery cartridge with room temperature at 10°C - 40°C (50°F - 104°F). Let a hot battery cartridge cool down before charging it.
4. Charge the battery cartridge once in every six months if you do not use it for a long period of time.

USE PROPER EXTENSION CORD. Make sure your extension cord is in good condition. When using an extension cord, be sure to use one heavy enough to carry the current your product will draw. An undersized cord will cause a drop in line voltage resulting in loss of power and overheating. Table 1 shows the correct size to use depending on cord length and nameplate ampere rating. If in doubt, use the next heavier gage. The smaller the gage number, the heavier the cord.

Table 1: Minimum gage for cord

Ampere Rating		Volts	Total length of cord in feet			
		120 V	25 ft.	50 ft.	100 ft.	150 ft.
		220 V - 240 V	50 ft.	100 ft.	200 ft.	300 ft.
More Than	Not More Than	AWG				
0	6	/	18	16	16	14
6	10		18	16	14	12
10	12		16	16	14	12
12	16		14	12	Not Recommended	

000300

Save all warnings and instructions for future reference.

ASSEMBLY

⚠ CAUTION:

- Always be sure that the tool is switched off, unplugged, and the battery cartridge is removed before carrying out any work on the tool.

Assembling the frame and the base

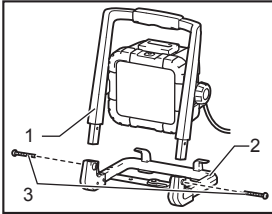

1. Frame
2. Base
3. Screw

Assemble the worklight as follows:

1. Remove the screws.
2. Insert the legs of the frame into the base.
3. Align the holes of the frame and the base.
4. Tighten them with screws.

FUNCTIONAL DESCRIPTION

⚠ CAUTION:

- Always be sure that the tool is switched off, unplugged, and the battery cartridge is removed before adjusting or checking function on the tool.

Use with battery:

Installing or removing battery cartridge

⚠ CAUTION:

- Always switch off the tool and unplug before installing or removing of the battery cartridge.
- **Hold the tool and the battery cartridge firmly when installing or removing battery cartridge.** Failure to hold the tool and the battery cartridge firmly may cause them to slip off your hands and result in damage to the tool and battery cartridge and a personal injury.

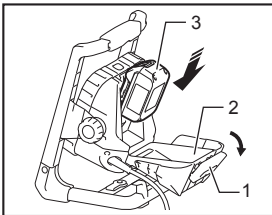

1. Cover lock
2. Battery cover
3. Battery cartridge

To install the battery cartridge, release the cover lock, and open the battery cover. And insert the battery cartridge. Align the tongue on the battery cartridge with the groove in the housing and slip it into place. Insert it all the way until it locks in place with a little click. Then close the battery cover.

To remove the battery cartridge, slide it from the tool while sliding the button on the front of the cartridge.

⚠ CAUTION:

- Always install the battery cartridge fully in place. If not, it may accidentally fall out of the tool, causing injury to you or someone around you.
- Do not install the battery cartridge forcibly. If the cartridge does not slide in easily, it is not being inserted correctly.

Use with AC power:

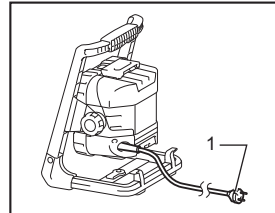

1. Plug (the shape may differ from country to country)

Connect the plug to a power supply.

Turning on LED light

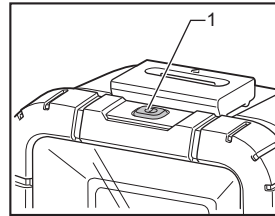

1. Switch

Press the switch once, the light shines brightly (high mode). Press the switch again, the light shines mildly (low mode). To turn off the light, press the switch once again.

Battery protection system

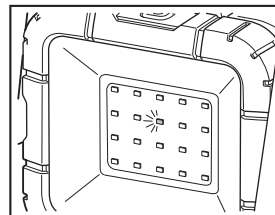

The tool is equipped with a battery protection system to extend battery life.

When the battery becomes low, the LED lights go out except one LED (the one on the second line center). Then, after approximately five to ten minutes later, the system automatically cuts off power.

OPERATION

⚠ CAUTION:

- This worklight is intended for field work use. Do not use the worklight for household purpose.
- Always put the tool on flat and stable place. Otherwise a falling accident may occur.

Adjusting the angle of the worklight

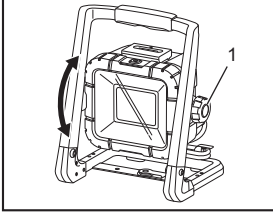

1. Knob

Loosen the knobs on the both side. Adjust the angle of the worklight. Then tighten the knobs again.

Using with tripod or vise (optional accessories)

⚠ CAUTION:

- Read carefully the instruction manuals of the accessories before using them with the worklight.
- When using with tripod or vise, do not let the total height exceed 1.75 m (5' 10").

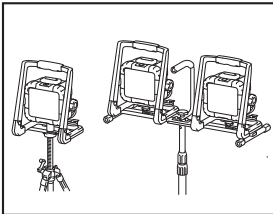

You can put the worklight on the tripod or vise to facilitate the operation.

MAINTENANCE

⚠ CAUTION:

- Always be sure that the tool is switched off, unplugged, and the battery cartridge is removed before attempting to perform inspection or maintenance.
- Never use gasoline, benzine, thinner, alcohol or the like. Discoloration, deformation or cracks may result.

Only maintenance work described in this instruction manual may be performed by the user. Any other work must be carried out by Makita authorized service centers.

Cleaning

From time to time wipe off the outside (tool body) of the tool using a cloth dampened in soapy water.

To maintain product SAFETY and RELIABILITY, repairs, any other maintenance or adjustment should be performed by Makita authorized service centers, always using Makita replacement parts.

OPTIONAL ACCESSORIES

⚠ CAUTION:

- These accessories or attachments are recommended for use with your Makita tool specified in this manual. The use of any other accessories or attachments might present a risk of injury to persons. Only use accessory or attachment for its stated purpose.

If you need any assistance for more details regarding these accessories, ask your local Makita service center.

- Makita genuine battery and charger
- Tripod
- Vise
- Anti-glare film

NOTE:

- Some items in the list may be included in the tool package as standard accessories. They may differ from country to country.