

MAGLITE® XL50™

LED FLASHLIGHT

ULTRA BRIGHT™
139 LUMENS



- 3 MODES**
- 1 Quick Click High Power**
- 2 Quick Clicks 25% Power**
- 3 Quick Clicks Emergency Safety Strobe**

3-CELL AAA



MAG-LITE®

XL50™ LED FLASHLIGHT

3-Cell AAA Flashlight

Model Number: **XL50-S3016**
Part Number: **163-000-035**

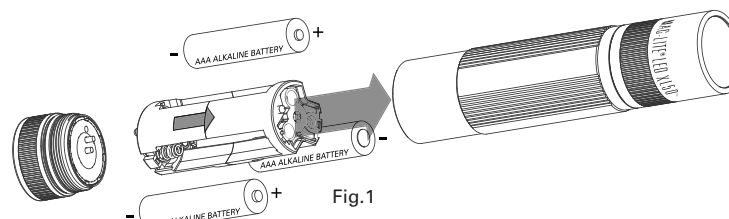
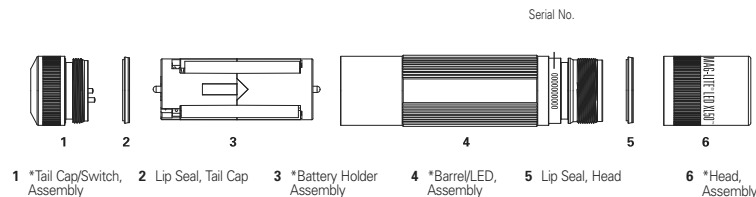

*Do not disassemble.

Thank you for purchasing a Maglite® flashlight product.

BATTERY HOLDER: Always install batteries with the “-” end facing the large spring end of each battery slot in the battery holder as shown (Fig. 1). Failure to insert batteries correctly could damage the LED module and / or the tailcap electronics. Insert the battery holder in the barrel with the arrow (Fig. 1) pointed toward the head end of the flashlight.

INSPECTION AND MAINTENANCE: For prolonged life and efficiency, it is necessary periodically to inspect and perform preventative maintenance on your flashlight as follows:
1. Inspection - Any battery may leak caustic solutions or gases which can corrode the inside of your flashlight. You should remove the batteries at least once a month and visually inspect the inside of the flashlight for signs of corrosion. If corrosion is seen, follow the instructions in the HOW AND WHEN TO MAKE A WARRANTY CLAIM section. **2. Separate Storage of Batteries** - If your flashlight is used infrequently, e.g., once a month or less, it is recommended to remove the batteries and store them separately. This helps guard against corrosion and may also prolong battery life. **3. Maintenance** - Place a small amount of petroleum jelly on all threads and rubber lip seals every six months.

Features a push-button tail cap switch with simple on-off function and 3 Selectable Modes

Turn on with...

1 Quick Click High Power

...Turn off with a single click

Turn on with...

2 Quick Clicks 25% Power

...Turn off with a single click

Turn on with...

3 Quick Clicks Emergency Safety Strobe

...Turn off with a single click

• Easy to use • Powerful Focusing LED Beam

The new Maglite® XL50™ LED flashlight delivers user-friendly, performance oriented features in a sleek, tactical design and is driven by the next generation of MAG-LED® technology. Features a push-button tail cap switch with simple on-off function and 3 selectable modes. Turn on with 1 quick click for high power. Turn on with 2 quick clicks for 25% power. Turn on with 3 quick clicks for emergency safety strobe. PLUS: All of the quality features professionals and consumers expect from a Mag® flashlight: • Rugged, machined aluminum construction. • Anodized inside and out for improved corrosion resistance. • Detailed warranty and operating instructions are enclosed. • Includes 3 AAA cell premium alkaline batteries.

TROUBLESHOOTING: If flashlight does not turn on or stay on -

1. Check the batteries. If they are exhausted, replace. **2.** Check the tail cap. The metal surfaces contacting the barrel, tail cap and spring assembly should be shiny metal without obstruction between them. Any corrosion formed by a foreign substance should be carefully removed.

WARNINGS: AVOID EYE INJURY - Do not stare directly into beam or shine it directly into anyone's face. Doing so for more than a few seconds could cause retinal damage.

Any battery may leak harmful chemicals which may damage skin, clothing or the inside of the flashlight. TO AVOID RISK OF INJURY, DO NOT LET ANY MATERIAL LEAKED FROM A BATTERY COME IN CONTACT WITH EYES OR SKIN. Any battery may rupture or explode if put in a fire or otherwise exposed to excessive heat. TO AVOID RISK OF INJURY, DO NOT EXPOSE BATTERIES TO EXCESSIVE HEAT. To reduce the risk of personal injury or harm to your flashlight, take the following precautions: • **Use only alkaline batteries from a reputable manufacturer.** • Do not use different brands of batteries in the same flashlight. • When replacing batteries, always replace the whole set. • **Do not use rechargeable or reuseable alkaline batteries.** • Do not try to recharge batteries that are not specifically designed to be recharged. • **Warning: batteries must be inserted correctly. Failure to do so could cause permanent damage to the LED module.** • Follow battery manufacturer's instructions as to proper handling, storage and disposal of batteries. • Carefully follow the steps listed under INSPECTION AND MAINTENANCE. • Not recommended for use by children under fourteen years of age.

Our website offers you a wide variety of flashlights at affordable prices.

423-000-133 7/12
BLACK