

# MAGLITE® XL200™

## LED FLASHLIGHT

**ULTRA BRIGHT™**  
**172**  
**LUMENS**

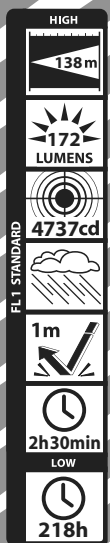

The **NEWEST, BRIGHTEST** member of our **XL™ SERIES** of compact flashlights.

### 5 MODES

- High Power
- Strobe
- Nite Lite™
- Signal
- SOS

3-CELL AAA

Quick- Click Switch

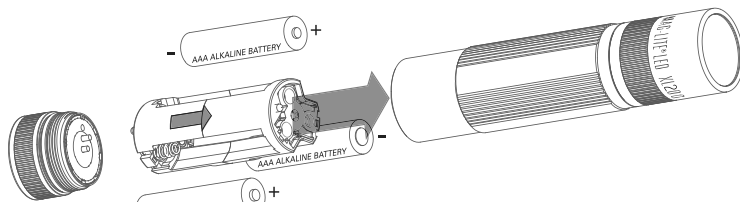
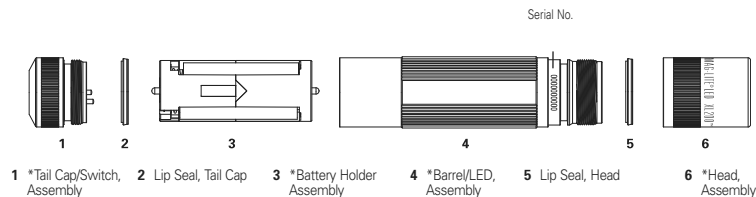

\*Do not disassemble tailcap, battery holder, or head.

Thank you for purchasing a Maglite® flashlight product.

**BATTERY HOLDER:** Always install batteries with the “-” end facing the large spring end of each battery slot in the battery holder as shown (Fig. 1). Failure to insert batteries correctly could damage the LED module and / or the tailcap electronics. Insert the battery holder in the barrel with the arrow (Fig. 1) pointed toward the head end of the flashlight.

**OPERATION:** Using the XL200™ flashlight’s pushbutton switch (in the tailcap), you can select one of 5 basic functions. These are summarized by icons on the tailcap as follows (see Fig. 2)

||||| means you can turn the flashlight on and adjust brightness using **1 Click**. Starting with the flashlight off, **press and hold down** the switch button while rotating the flashlight left and right (see Fig. 3) to vary the brightness. When you see the desired brightness level, **release the button** to keep that setting. Turn the flashlight off with **1 Click**. The XL200™ remembers your selected brightness setting, so when you turn the light on with **1 Click**, your selected brightness level will reappear. Your selection will stay in effect until you either (1) change it by repeating the above steps or (2) remove the tailcap, wait a moment, and replace it.

••• means that you can make the flashlight produce a **strobe (blinking) effect** using **2 Quick Clicks**. Starting with the flashlight off, **press the button twice** (about as quickly as you would say “Click Click”) **but hold it down on the second press**. Rotate the flashlight left and right (see Fig. 3) while holding down the switch button to vary the blink rate. When you see the desired blink rate, **release the button** to keep that setting. As above, use **1 Click** to turn the flashlight off. When you turn it on again with **2 Quick Clicks**, it will strobe at your selected blink rate, which will stay in effect until you change it as above.

Zzzz means that you can put the flashlight in **Nite Lite™ mode** using **3 Quick Clicks**. Starting with the flashlight off, quickly press the switch button three times (about as quickly as you would say “Three Quick Clicks”) and it will come on at maximum brightness (or whatever other brightness level you have stored). Within 5 seconds or so, it will dim down to a very low level and stay there until the flashlight is moved; then it will go to bright again. **1 Click** turns the flashlight off.

><<< means that you can put the flashlight in **Signal mode** using **4 Quick Clicks**. Starting with the flashlight off, **click the switch button four times**. You can then use your flashlight as a silent signaling device: Turn it on and off noiselessly simply by rotating the flashlight (as in Fig. 3). **1 Click** turns the flashlight off.

••• - - - ••• means that by using **5 Quick Clicks** you can make your flashlight repeatedly and silently signal “SOS” – the International Morse Code Distress Signal. Quickly **press the button five times** and

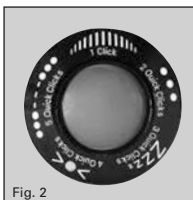

Fig. 2

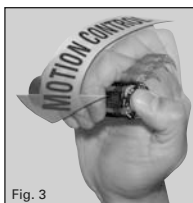

Fig. 3

it will begin signaling “SOS.” To make it stop, turn the flashlight off with **1 Click**.

**Lockout function** - Your Maglite® XL200™ flashlight also has a Lockout Feature, to prevent accidental operation. To lock your switch, aim the flashlight straight up at the ceiling or sky and, while holding down the switch button, rotate the flashlight to point straight down at the floor or ground; then release the switch button. The switch is now locked. To unlock, repeat these steps.

**INSPECTION AND MAINTENANCE:** For prolonged life and efficiency, it is necessary periodically to inspect and perform preventative maintenance on your flashlight as follows: **1. Inspection** - Any battery may leak caustic solutions or gases which can corrode the inside of your flashlight. You should remove the batteries at least once a month and visually inspect the inside of the flashlight for signs of corrosion. If corrosion is seen, follow the instructions in the HOW AND WHEN TO MAKE A WARRANTY CLAIM section. **2. Separate Storage of Batteries** - If your flashlight is used infrequently, e.g., once a month or less, it is recommended to remove the batteries and store them separately. This helps guard against corrosion and may also prolong battery life. **3. Maintenance** - Place a small amount of petroleum jelly on all threads and rubber lip seals every six months.

**TROUBLESHOOTING: 1. Flashlight will not turn on.** - Check Lockout (see OPERATION). Check the batteries. If they are exhausted, or weak, replace them with a quality brand of AAA alkaline batteries. **2. Flashlight still will not turn, or will not stay, on.** - If replacing the batteries does not solve the problem, next check the tail cap. The metal surfaces contacting the barrel, tail cap and battery terminals should be shiny metal without obstruction between them. Any corrosion or dirt should be carefully removed. **3. Motion Control will not operate.** - Try again with the flashlight held nearly horizontal to the ground. Motion control should work normally even if the flashlight is tilted considerably, but not if it is pointing almost straight up or straight down.

**WARNINGS: AVOID EYE INJURY - Do not stare directly into beam or shine it directly into anyone’s face. Doing so for more than a few seconds could cause retinal damage.** Any battery may leak harmful chemicals which may damage skin, clothing or the inside of the flashlight. TO AVOID RISK OF INJURY, DO NOT LET ANY MATERIAL LEAKED FROM A BATTERY COME IN CONTACT WITH EYES OR SKIN. Any battery may rupture or explode if put in a fire or otherwise exposed to excessive heat. TO AVOID RISK OF INJURY, DO NOT EXPOSE BATTERIES TO EXCESSIVE HEAT. To reduce the risk of personal injury or harm to your flashlight, take the following precautions: • **Use only alkaline batteries from a reputable manufacturer.** • Do not use different brands of batteries in the same flashlight. • When replacing batteries, always replace the whole set. • **Do not use rechargeable or reusable alkaline batteries.** • Do not try to recharge batteries that are not specifically designed to be recharged. • **Warning: batteries must be inserted correctly. Failure to do so could cause permanent damage to the LED module.** • Follow battery manufacturer’s instructions as to proper handling, storage and disposal of batteries. • Carefully follow the steps listed under INSPECTION AND MAINTENANCE. • Not recommended for use by children under fourteen years of age.

Our website offers you a wide variety of flashlights at affordable prices.