



MAGLITE® XL100™

LED FLASHLIGHT

New MULTI-MODE Advanced Flashlight User Interface™

5 MODES

NORMAL (On/Off), STROBE, NITE LITE™, SIGNAL & SOS Plus Lockout

HIGH

4484cd

134m

83 LUMENS

FL1 STANDARD

1m

5h 15min

LOW

201h

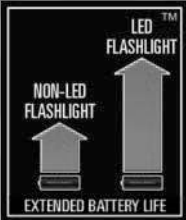

(3) AAA Cell, Alkaline

Rear tailcap switch



Rotate Left or Right For Variable Power Level and Strobe Rate Settings MAXIMUM TO MINIMUM

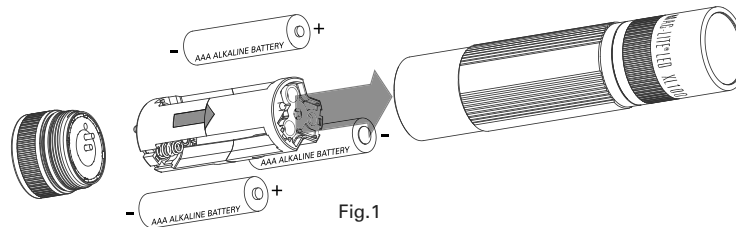
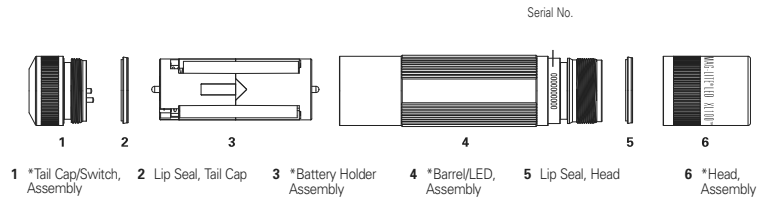

*Do not disassemble.

Thank you for purchasing a Maglite® flashlight product.

BATTERY HOLDER: Always install batteries with the “-” end facing the spring end of each battery slot in the battery holder as shown (Fig. 1). Failure to insert batteries correctly could damage the LED module. Insert the battery holder in the barrel with the arrow (Fig. 1) pointed toward the head end of the flashlight.

OPERATION: The XL100™ is turned on by depressing and releasing the tail cap switch. The light can then be turned off by a subsequent press and release of the tail cap switch. This basic on/off operation occurs when the initial press of the switch is released in less than 1 second.

MODES: The XL100™ has the following available modes: Normal (basic on/off), Strobe, Nite Lite™, Signal, and SOS. **Mode Activation:** If the tail cap switch is held longer than 1 second when first pressed, a mode of operation will be activated.

Selecting Modes: To select a mode of operation, the light should be held horizontal to the ground with the icon of the desired mode rotated to 12 o’clock (Fig. 2). The mode is activated by pressing and holding the tail cap switch for longer than 1 second. **Adjusting Modes:** Brightness and blink rate of the XL100™ can be adjusted by the user. **To adjust brightness:** Select the “Dim” mode icon and continue to hold the tail cap switch in. Rotate the light left or right (Fig. 3) and the brightness will vary from maximum to minimum brightness level. When the desired brightness level is reached, release the tail cap switch and the light will continue to operate at this level. This brightness level is stored in memory and will be the default brightness until changed. **To adjust blink rate:** This adjustment is for the Strobe mode only. Select the “Strobe” mode icon and continue to hold the tail cap switch in. Rotate the light left or right (Fig. 3) and the blink rate will vary from maximum to minimum. When the desired blink rate is reached, release the tail cap switch and the light will continue to blink at this rate. The blink rate will be stored in memory and will be the default rate until changed. **Nite Lite™:** Select the “Nite Lite™” mode icon, press and hold switch until it blinks once, then set the light at a desired stationary position. The light will dim automatically to a low setting. If the light is moved, it will return to full power. **Signal:** Select the “Signal” mode icon, press and hold switch until it turns off, rotating the light left and right or right and left will initiate on-off. **SOS:** Select the “SOS” mode icon, press and hold switch until it begins to blink morse code SOS. **Lockout:** This feature allows the user to lock



Fig. 2 For Tactile Orientation

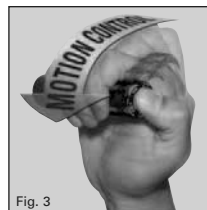

Fig. 3

the XL100™. (prevents accidental operation) To engage, aim the light to the ceiling, press and hold the switch, continue to hold the switch, while rotating downward, aiming the light to the floor. Release the switch, it is now in lockout mode. Repeat these steps to disengage lockout mode.

INSPECTION AND MAINTENANCE: For prolonged life and efficiency, it is necessary periodically to inspect and perform preventative maintenance on your flashlight as follows: **1. Inspection** - Any battery may leak caustic solutions or gases which can corrode the inside of your flashlight. You should remove the batteries at least once a month and visually inspect the inside of the flashlight for signs of corrosion. If corrosion is seen, follow the instructions in the HOW AND WHEN TO MAKE A WARRANTY CLAIM section. **2. Separate Storage of Batteries** - If your flashlight is used infrequently, e.g., once a month or less, it is recommended to remove the batteries and store them separately. This helps guard against corrosion and may also prolong battery life. **3. Maintenance** - Place a small amount of petroleum jelly on all threads and rubber lip seals every six months.

TROUBLESHOOTING: 1. The flashlight will not change modes. - Ensure that the light is horizontal when selecting the modes.

2. Flashlight will not turn on. - Check Lockout (see modes). Check the batteries. If they are exhausted, or weak, replace them with a quality brand of AAA alkaline batteries. **3. Flashlight still will not turn, or will not stay, on.** - If replacing the batteries does not solve the problem, next check the tail cap. The metal surfaces contacting the barrel, tail cap and battery terminals should be shiny metal without obstruction between them. Any corrosion or dirt should be carefully removed.

WARNINGS: AVOID EYE INJURY - Do not stare directly into beam or shine it directly into anyone’s face. Doing so for more than a few seconds could cause retinal damage. Any battery may leak harmful chemicals which may damage skin, clothing or the inside of the flashlight. TO AVOID RISK OF INJURY, DO NOT LET ANY MATERIAL LEAKED FROM A BATTERY COME IN CONTACT WITH EYES OR SKIN. Any battery may rupture or explode if put in a fire or otherwise exposed to excessive heat. TO AVOID RISK OF INJURY, DO NOT EXPOSE BATTERIES TO EXCESSIVE HEAT. To reduce the risk of personal injury or harm to your flashlight, take the following precautions: • **Use only alkaline batteries from a reputable manufacturer.** • Do not use different brands of batteries in the same flashlight. • When replacing batteries, always replace the whole set. • **Do not use rechargeable or reuseable alkaline batteries.** • Do not try to recharge batteries that are not specifically designed to be recharged. • **Warning: batteries must be inserted correctly. Failure to do so could cause permanent damage to the LED module.** • Follow battery manufacturer’s instructions as to proper handling, storage and disposal of batteries. • Carefully follow the steps listed under INSPECTION AND MAINTENANCE. • Not recommended for use by children under fourteen years of age.

Our website offers you a wide variety of flashlights at affordable prices.