

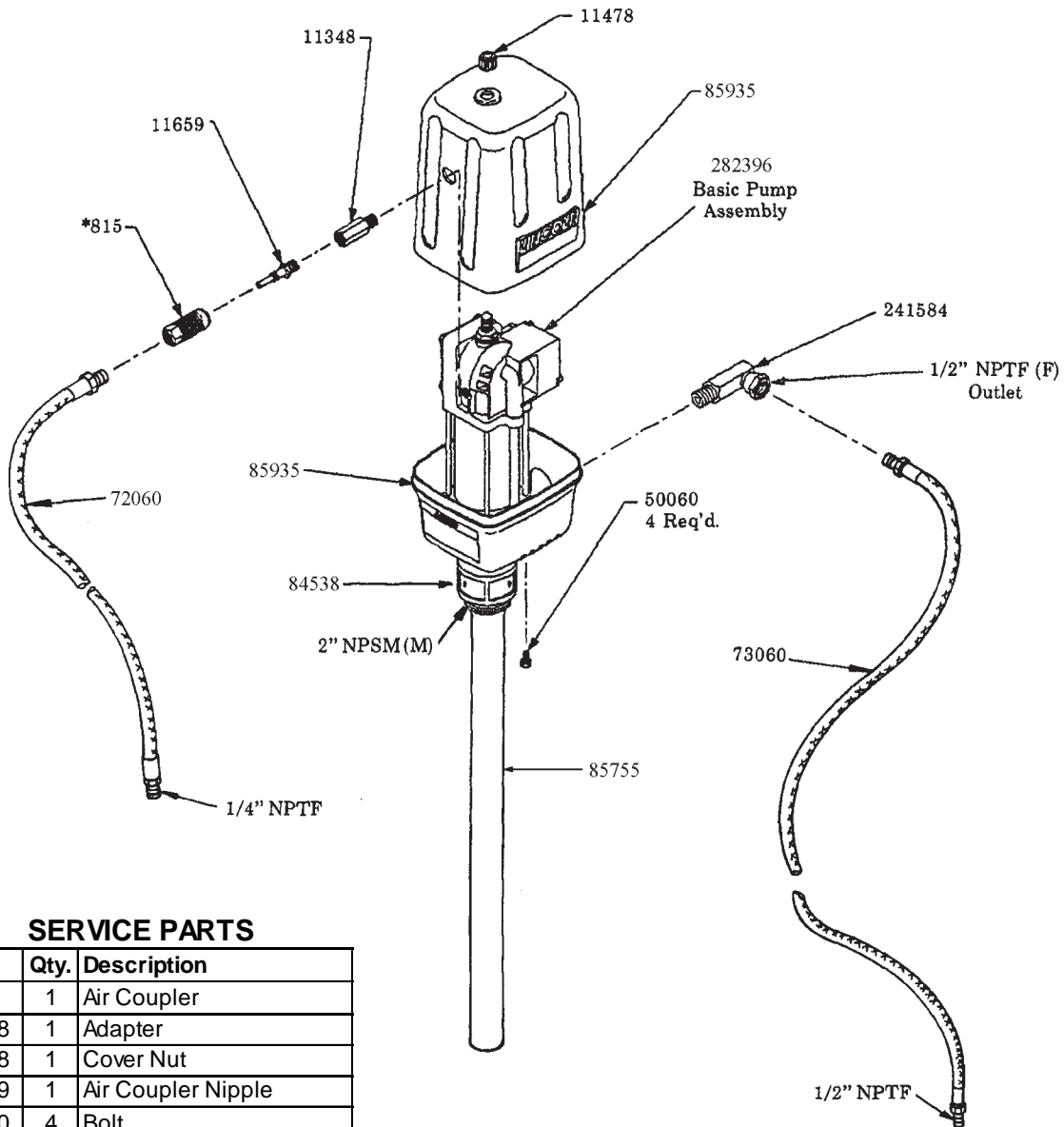

STATIONARY GEAR LUBRIGUN MODEL 2424 55 GAL. DRUM SIZE 3:1 RATIO



SERVICE PARTS

Part	Qty.	Description
815	1	Air Coupler
11348	1	Adapter
11478	1	Cover Nut
11659	1	Air Coupler Nipple
50060	4	Bolt
72060	1	Air Hose
73060	1	Lubricant Hose
84538	1	Bung Bushing Assembly
85935	1	Airmotor Cover
85755	1	Tube
241584	1	Outlet Connection
282396	1	Basic Pump Assembly

* Refer to separate instructions:
815 Air Coupler Section G9 Page 2 Series
282396 Basic Pump Section A6, Page 37 Series



AUG - 2003

[View other fuel transfer and lubrication made by Lincoln on our website.](#)