

Owner's Instructions

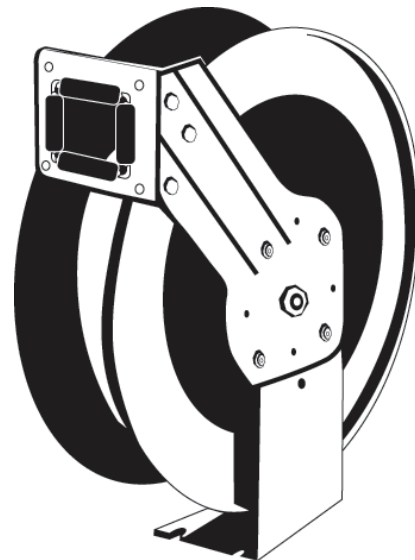

Part No. : L8611, L8611FZ, L8621, L8631, L8632, L8641

Industrial Hose Reels



DESCRIPTION

Open hose reel for air, water, grease, or oil, depending on model. Hose can be pulled to desired length and held in place by a latching mechanism. Pulling the hose gently releases the latch and the hose is automatically coiled.

- **Installation**
- **Hose Stopper Adjustment**
- **Hose Replacement**
- **Spring Load Adjustment**
- **Swivel Replacement**
- **Part Lists & Repair Kits**

CAUTION:

Read all instructions and warnings before operating this product.
SAVE THESE INSTRUCTIONS! READ ALL INSTRUCTIONS!

INSTALLATION

The hose reel can be bench, wall, high wall or ceiling mounted. The hose guide arm and the hose outlet opening must be positioned according to figure A to ensure a smooth operation of the reel and to increase the hose life. To move the hose guide arm and the hose outlet opening, the screws marked with an arrow on figure B must be removed. Move the arm and hose outlet to its correct position, replace screws and tighten.

HOSE STOPPER ADJUSTMENT

To modify the hose stopper position, pull out hose to the desired length and latch reel. Loosen the hose stopper and place it at the opening of the hose guide.

NOTE: CHECK THAT THE REEL IS PERFECTLY LATCHED BEFORE REMOVING THE HOSE STOPPER.

HOSE REPLACEMENT

CAUTION: REEL IS SPRING-LOADED. INJURY WILL RESULT IF YOU DO NOT MAINTAIN CONTROL OF REEL AND HOSE AT ALL TIMES.

1. Unwind hose completely then allow it to rewind to the first locked position. Secure vise grips or other device on spool assembly, near the guide arm assembly to prevent the reel from retracting. **DO NOT CRUSH LIP.**
2. Remove hose from the reel. Insert new hose through hole in spool and attach clamps. Attach hose stop.
3. With one hand on the hose remove the vise grips and allow the hose to rewind.
4. Once service gun is installed, verify that the spring tension is adequate. If the spring tension is not adequate, follow the steps below to add additional spring tension.

SPRING LOAD ADJUSTMENT

1. The hose reels are supplied with a spring tension, which is factory adjusted according to the hose. If the spring tension is to be adjusted afterwards **CHECK** that the required length of the hose can be pulled out **WITHOUT STRETCHING THE SPRING TO THE LIMIT**. The lowest spring tension possible increases the life of the spring.
2. Too much spring tension will shorten the life of the spring and put excessive wear and tear on the hose. Do not exceed 18 turns from unwound position.
3. To adjust tension, pull out approximately 6 ft. or 2 m of hose and allow the drum to latch.
4. Remove hose stopper from hose and feed hose back through guide.
5. Wrap the pulled hose one more time around the drum to increase tension, or un-wrap hose one time from drum to decrease tension. Do not exceed 18 turns from unwound position.
6. Re-feed hose through guide and install hose stopper.
7. Unlatch drum and check tension. Pull hose from reel, and adjust stopper position if necessary.

SWIVEL REPLACEMENT

IMPORTANT: BEFORE REMOVING THE OLD SWIVEL, CLOSE THE NEAREST CONTROL VALVE TO THE REEL AND OPEN THE FLUID CONTROL GUN TO RELEASE THE PRESSURE INSIDE THE GUN AND HOSE.

1. With the hose completely coiled, remove the fluid inlet hose and the old swivel. (Fig. C).
2. Replace the old swivel with the new one.
3. To tighten the swivel, hold the reel drum while you tighten it. (Fig. D).
4. Connect the inlet hose again.

PRESSURE RATINGS at 68°F/ 20°C:

	Working Pressure	Burst Pressure
L8611, L8611FZ	300 PSI	1200 PSI
L8621	5000 PSI	20,000 PSI
L8631, L8632	2000 PSI	8000 PSI
L8641	300 PSI	1200 PSI

Lead-in Hoses:

L8611LI for reel L8611
 L8621LI for reels L8620 and L8621
 L8631LI for reels L8630, L8631 and L8632
 L8611FZLI for reel L8611FZ

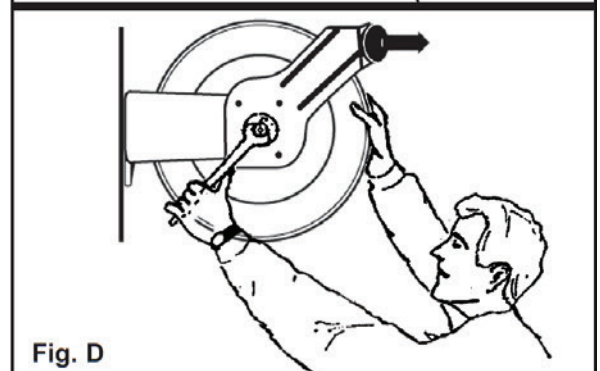
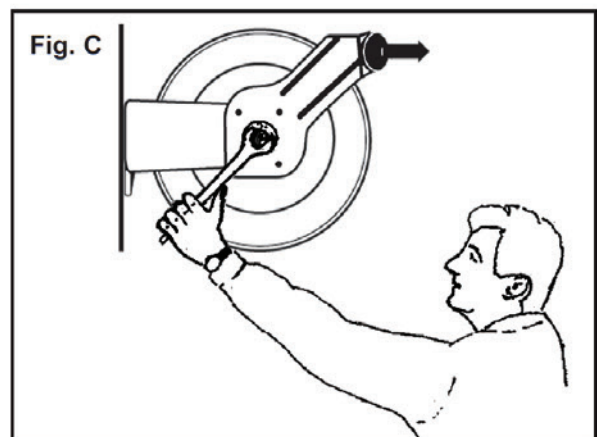
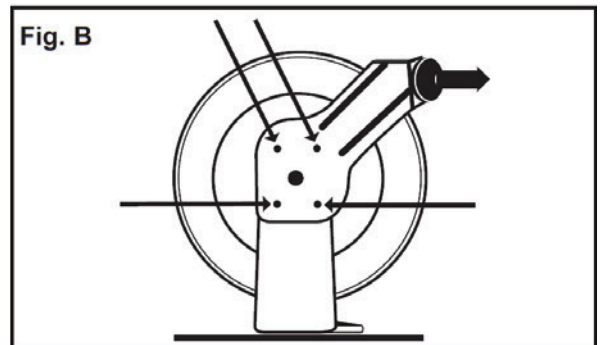
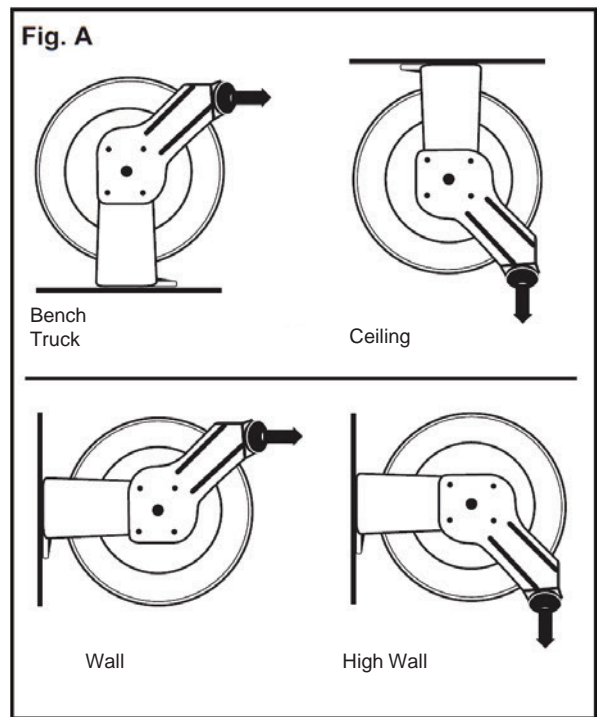

Models L8611FZ, 21, 31, 32, 41

Repair Part	Description	Part Number
RP001046	Replacement hose with ball stop	L8632
RP001049	Swivel	L8641
RP001051	Swivel	L8611
RP001053	Latch pawl kit	L8611, L8621, L8631, L8641
RP001055	Guide roller kit	L8611, L8621, L8631, L8641
RP001056	3/8 in. x 50 ft. air hose	L8611, L8711
RP001057	1/2 in. x 50 ft. air hose	L8641
RP001058-FZ	3/8 in. x 50 ft. Flexzilla air hose	L8611FZ
RP001059-EU	Swivel	L8621
RP001059	Swivel	L8621, L8711
RP001060-EU	Swivel	L8631
RP001060	Swivel	L8631
RP001064	Guide roller kit	L8611, L8621, L8631, L8641
RP001065	1/4 in. x 50 ft. hose	L8621
RP001066	1/2 in. x 50 ft. hose	L8631