

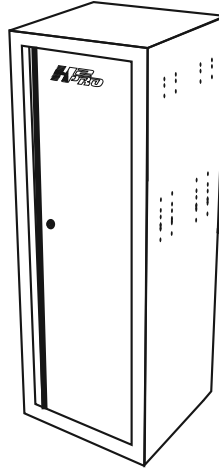

MANUAL
& OPERATING INSTRUCTIONS



19" H2Pro SERIES SIDE LOCKER

MODEL :
BK08019602 - BLACK



WARNING:

1. Close and lock drawers before moving.
2. Do not stand on the product. You may fall which may cause personal injury.
3. Do not climb on, in or around. IT MAY TIP OVER! Keep away from children.
4. Unit has a maximum load capacity of 420 lb (190.9 kg). Do not overload.
5. Do not step in the drawers. You may fall which may cause personal injury.
6. Read all instructions and safety tips before using this product.
7. For indoor use only.

THANK YOU FOR PURCHASING A HOMAK UNIT. WE APPRECIATE YOUR BUSINESS.

Congratulations on your new purchase!

Before operating your unit, please read the following carefully:

**KEEP INSTRUCTION MANUAL IN A SAFE PLACE UPON OPENING YOUR NEW UNIT.
THE KEY CODE TO YOUR HMC SECURE PREMIUM TUBULAR LOCK CAN BE FOUND
ON THE BACK OF THIS MANUAL.**

PARTS LIST:

A) Drawer Liners

B) Keys

C) 2 Caster Attachment Plates

D) 2 Swivel Locking Casters

E) 16 Bolts, 16 Lock Washers & 16 Washers for Casters & Caster Attachment Plates

F) 4 Spacers

G) 4 Long Bolts to secure to top chest

H) 4 Medium Bolts, 4 Lock Washers and 4 Washers for securing to push handle
mounting holes

I) 2 Shelves

J) 8 Shelf Clips

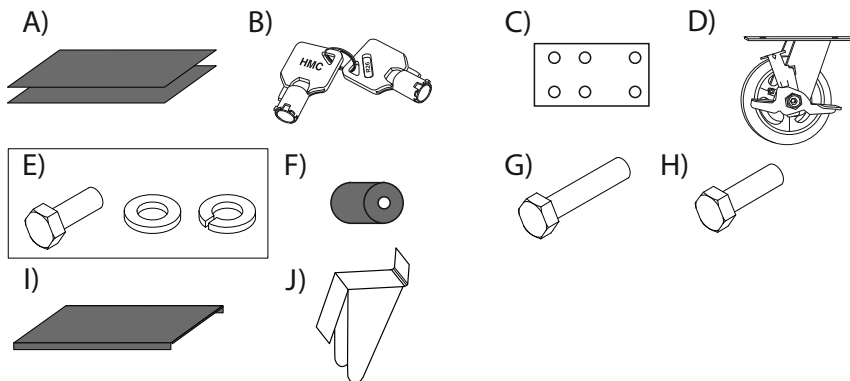

MOUNTING THE SIDE LOCKER TO THE TOP CHEST AND ROLLING CABINET:



CAUTION: DO NOT MOUNT ROLLER CABINET HANDLE TO SIDE ATTACHMENT,
DOING SO WILL DAMAGE SIDE UNIT.

*Work with a 2 person team to assemble this product to avoid
personal injury.

1) Turn locker on its side. Make sure to lay down protective material (such as the cardboard packaging that came with the locker) to prevent damage to the locker while installing casters.

2) Using 8 bolts, 8 lock washers and 8 washers (Part E), secure the 2 caster attachment plates (Part C) to the locker on the side that will be facing the rolling cabinet.

3) Attach 2 casters (Part D). to opposite side of locker using 8 bolts, 8 lock washers and 8 washers (Part E).

7) Remove top chest handles and rolling cabinet push handle.

6) Remove 4 bolts, washers, and lock washers on outer edge of rolling cabinet casters.

8) For the following steps: do not tighten bolts until all hardware is properly aligned, then tighten fully.

9) Using 4 spacers (part F), 4 long bolts, 4 washers, and 4 lock washers (part G), secure upper end of locker to top chest as shown in diagram below:

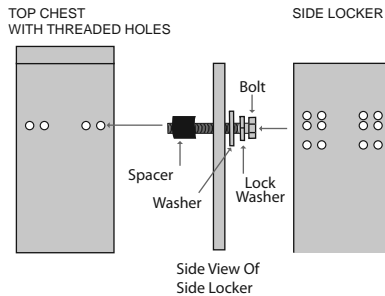

10) Use 4 medium bolts, 4 washers, and 4 lock washers (Part H) to secure locker to rolling cabinet as shown in diagram below:

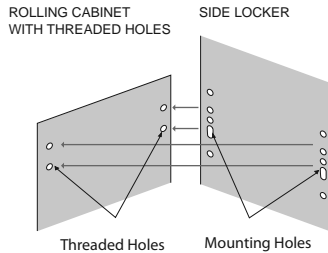

11) Secure caster attachment plates to the rolling cabinet casters using the rolling cabinet caster hardware that was removed in Step #6.

10) After all attachments are secure, fully tighten all bolts.

MAINTENANCE

Ball-Bearing Slides

Note: Unload drawer prior to drawer removal.

Never overload drawers.

To remove drawers and slides, pull drawer all the way out, depress the black drawer release levers on each slide. For ball-bearing glides, there is one black lever per slide. One black lever will be pushed down and the other will be pushed up for drawer removal. After levers are pushed, the drawer is released. Pull out drawer all the way for removal.

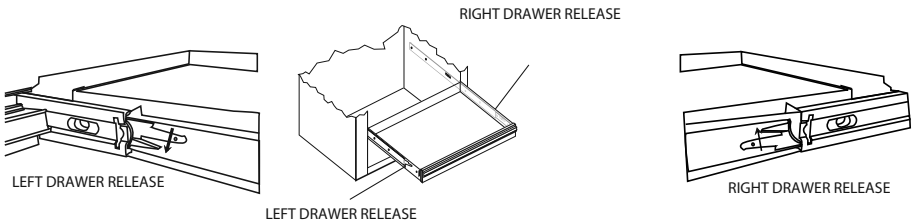

To re-install the drawer, line up cabinet glides to drawer glides and squeeze glides inwards while pushing in the drawer until each glide “clicks” into place.

To maintain the smooth and quiet operation of the ball-bearing slides, lubricate the extension track that houses the ball bearings every 3-6 months with a high quality jelly-like petroleum based lubricant.

Powder Coat Finish

For heavy build-up of dirt and grime, our powder coat paint finish can be cleaned with spray wax. Lightly spray the wax on the surface, and gently wipe with a soft, dry microfiber cloth.

Window cleaner and a soft cloth dampened with water can be used to clean the finish on a regular basis.

Customer Satisfaction

All mechanical parts are inspected and adjusted for proper use before shipment; however, mechanisms such as drawer slides and locks may shift during transit.