

IEC COMPLIANCE

Compliance with: EN/IEC 61010-031:2002+A1:2008

⚠️ Warning

Do not use in CAT III or CAT IV environments without the protective cap installed. The protective cap decreases the exposed probe metal to <4mm. This decreases the possibility of arc flash from short circuits.

Do not exceed the Measurement Category (CAT) rating of the lowest rated individual component of a product, probe, or accessory.

CAT II Measurement Category II is for measurements performed on circuits directly connected to the low voltage installation.

CAT III Measurement Category III is for measurements performed in the building installation.

CAT IV Measurement Category IV equipment is designed to protect against transients from the primary supply level, such as an electricity meter, or an overhead or underground utility service.

TPX Probe Cap Set Instruction Sheet

Compatible with TP1, TP2, and TP220

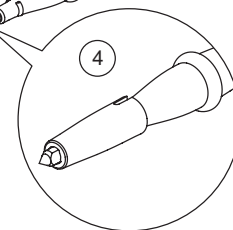
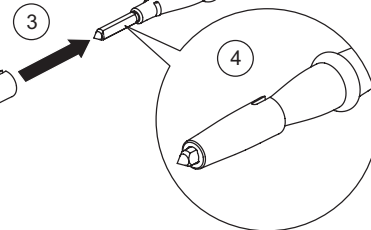
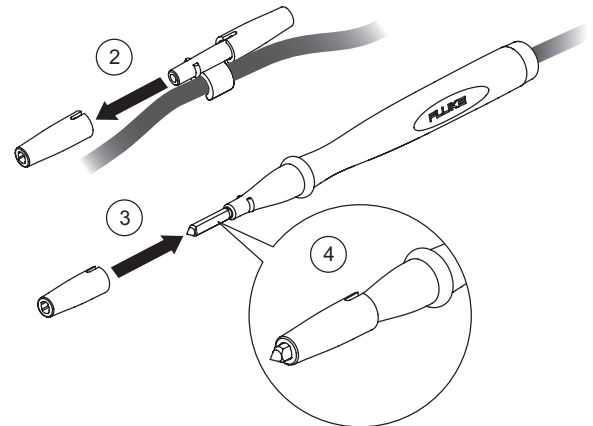
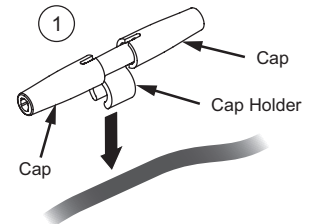
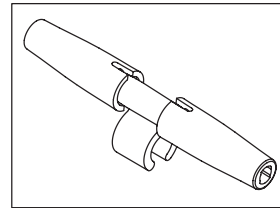

PN 4395399