

DEWALT®



Instruction Manual

DWX726
Rolling Miter Saw Stand

DWX726 ROLLING MITER SAW STAND

! **WARNING:** To reduce the risk of serious personal injury, turn tool off and disconnect tool from power source before installing and removing accessories, before adjusting or changing set-ups or when making repairs. An accidental start-up can cause injury.

Components (Fig. A)

! **WARNING:** Never modify the stand or any part of it. Damage or personal injury could result.

1. Mounting rails
2. Foot
3. Wheels
4. Leg extension
5. Hex wrench
6. Vertical lock knobs
7. Horizontal lock knobs
8. Handle
9. Work support extension arm
10. Work support
11. Stop plate
12. Activating lever

Hardware bag 1:

13. Axles (2)
14. Bushings (2)
15. Washers (4)
16. Nuts (2)

Hardware bag 2:

17. M8 x 16 mm button head screws (4)
18. Curved washers (4)
19. M6 x 10 mm button head screw (1)
20. M6 lock washer (1)
21. M8 x 21 mm button head screw with thread locking patch (1)
22. M8 lock washer (1)

Tools Required for Assembly

- Hex wrench 5 (supplied, comes in the wrench storage location in the corner of the stand)
- Adjustable wrench
- 1/2 inch open end wrench
- 3/4 inch open end wrench
- Wire cutting pliers

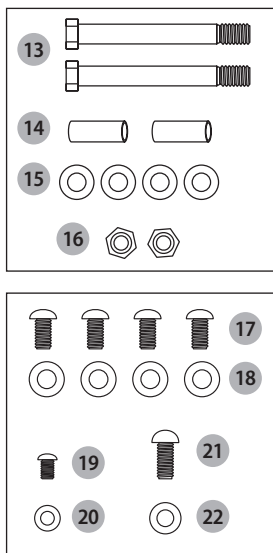
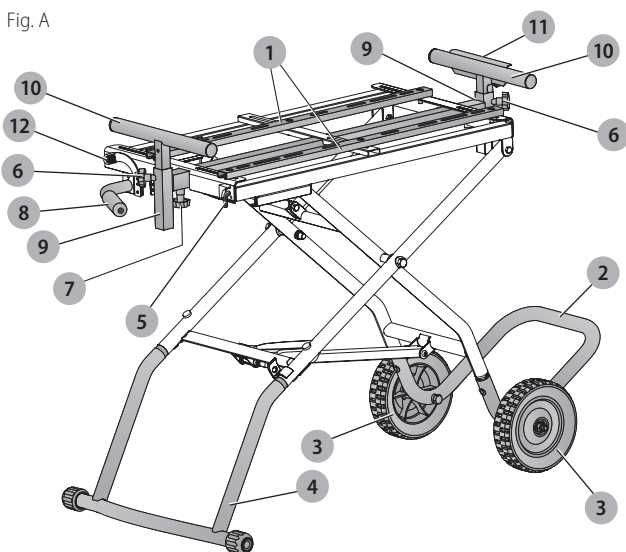





Fig. A







Definitions: Safety Alert Symbols and Words

This instruction manual uses the following safety alert symbols and words to alert you to hazardous situations and your risk of personal injury or property damage.

-  **DANGER:** Indicates an imminently hazardous situation which, if not avoided, **will** result in **death or serious injury**.
-  **WARNING:** Indicates a potentially hazardous situation which, if not avoided, **could** result in **death or serious injury**.
-  **CAUTION:** Indicates a potentially hazardous situation which, if not avoided, **may** result in **minor or moderate injury**.
-  (Used without word) Indicates a safety related message.
- NOTICE:** Indicates a practice **not related to personal injury** which, if not avoided, **may** result in **property damage**.

SAFETY RULES

-  **WARNING:** For your own safety, read the tool instruction manual before using any accessory. Failure to heed these warnings may result in personal injury and serious damage to the tool and the accessory. When servicing this tool, use only identical replacement parts.
 -  **WARNING:** Failure to follow these rules may result in serious personal injury.
 -  **WARNING:** To reduce the risk of injury, keep both hands on handle when raising and lowering the stand. The stand has gas assist lifting and may raise unexpectedly when lever is released.
 - **This product was designed to be used as a stand for miter saws.** The stand will support up to 300 lbs (136 kg). Any misuse or abuse can result in product damage or personal injury.
 - **Do not stand on the work table.** It is unsafe to climb, sit or stand on the stand. Do not use the support extensions as a ladder or scaffolding.
 - **Properly secure the miter saw to the stand before operation.** Follow the mounting instructions carefully.
- Fasten the tool to the saw mounting rails securely as instructed.
- **Place the stand on a flat and level surface to prevent rocking or tipping.**
 - **Take care during the raising and lowering of the product to reduce the hazard of pinching hands and fingers.**
 - **Check the legs and other supports to see that they are properly locked in place before operation.**
 - **Do not modify or use the stand for any operation for which it is not intended.**
 - **ALWAYS** use eye protection. All users and bystanders must wear eye protection that conforms to ANSI Z87.1.
-  **WARNING: ALWAYS** use safety glasses. Everyday eyeglasses are NOT safety glasses. Also use face or dust mask if cutting operation is dusty. **ALWAYS WEAR CERTIFIED SAFETY EQUIPMENT:**
 - ANSI Z87.1 eye protection (CAN/CSA Z94.3),
 - ANSI S13.6 (S3.20) hearing protection,
 - NIOSH/OSHA/MSHA respiratory protection.

ASSEMBLY

1. **WARNING: PINCH AND IMPACT HAZARD.** Do not cut the large securing cable ties ( Fig. B) until instructed to do so later in the manual. The spring loaded mechanism is under tension and can open unexpectedly, with high force. To reduce the risk of serious personal injury, do not raise or lower stand until the assembly is complete.

Fig. B

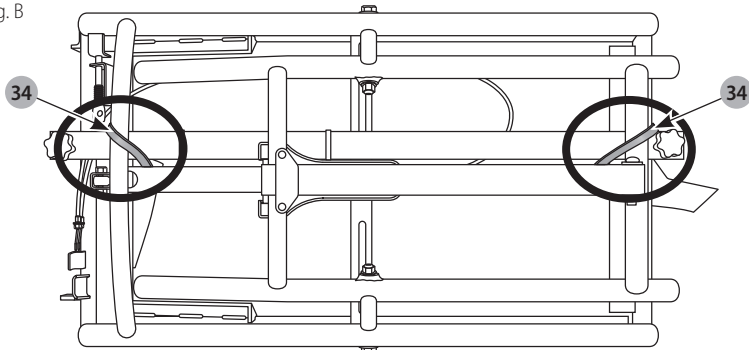

Fig. C

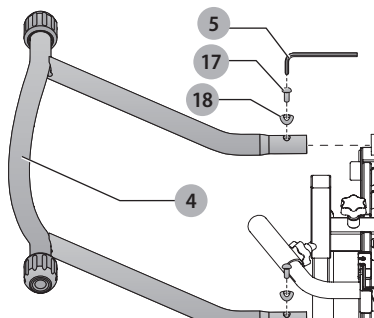

Fig. D

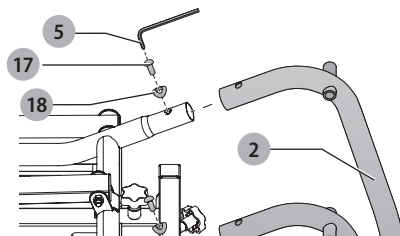

Fig. E

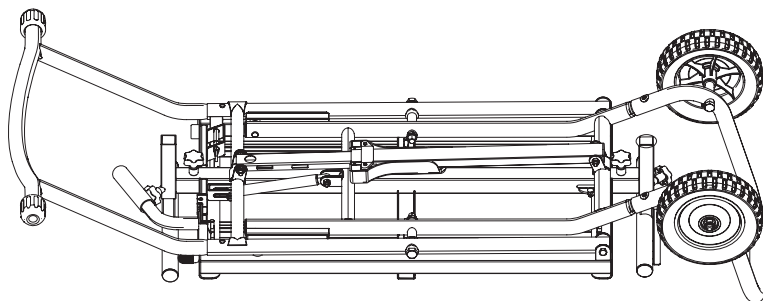

Fig. F

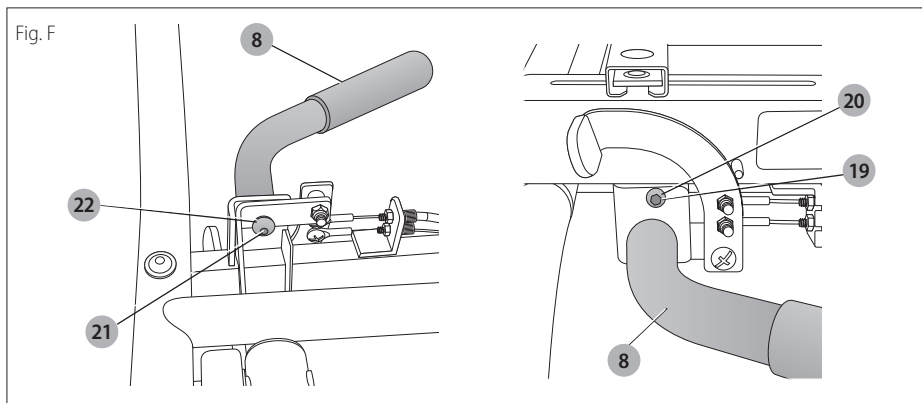
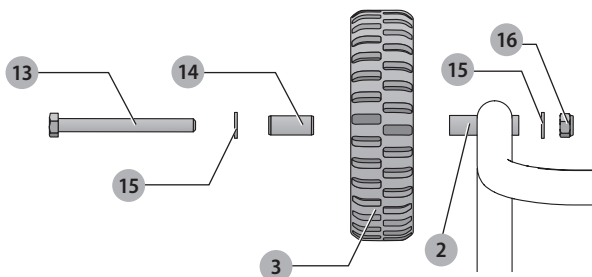

Fig. G



ATTACHING THE TOOL (FIG. A, H-K)

⚠ WARNING: STABILITY HAZARD. Refer to your tool manufacturer's instructions regarding the securing of your miter saw to a stand or supporting surface. Secure the tool according to both the instructions in this manual and those in your tool manufacturer's manual before operating. Failure to heed these warnings may result in serious personal injury and serious damage to the tool.

1. Turn the stand right side up and leave stand in closed position before attaching the saw.

Fig. H

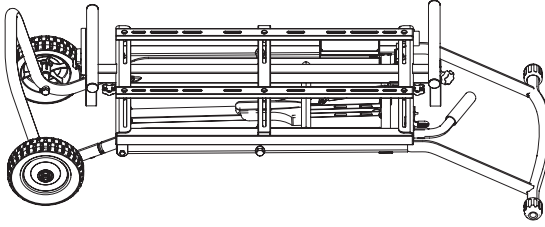

2. Loosen the 6 rail screws **27** with the supplied hex wrench. Remove the four mounting bolts/flat washers **28** from the mounting rails **1**.

Fig. I

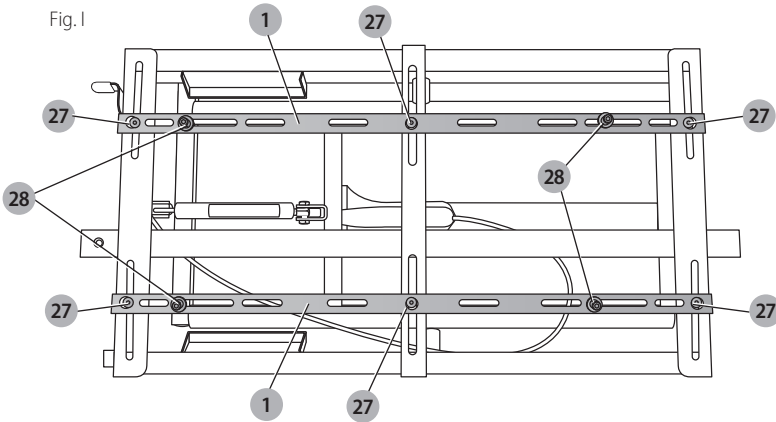

3. Slide the mounting rails **1** to fit the width of the tool.
4. Place miter saw on the mounting rails **1**. Center the tool, both forward and backward and side to side, on the stand (Fig. K).
5. Ensure the mounting holes **29** in the tool's feet align with the rail (Fig. J).
6. Insert the mounting bolts/flat washers **28** (removed in STEP 2) through each of the tool's feet into the captured nut **32**. Tighten securely.
7. Once the saw is tight to the rails, tighten the rail screws **27** loosened in STEP 2.

Fig. J

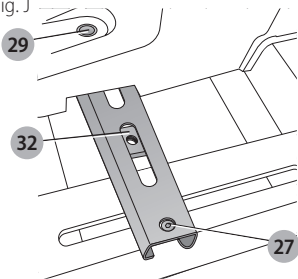
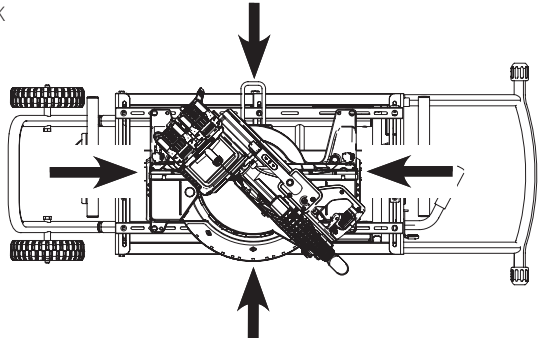

Fig. K



If your saw does not readily fit the mounting rails:

IMPORTANT: The miter saw MUST be positioned so the tool is bolted squarely to the mounting rails.

WARNING: STABILITY HAZARD. If the tool's mounting holes do not line up with the slots in the mounting rails, mount the miter saw to a piece of 3/4" (19 mm) plywood (See Figure L for dimensions). The plywood must be a minimum of 4" (101.6 mm) wider than the tool base being mounted and a minimum depth of 17" (431.8 mm). Plywood must be at least as deep as the tool base being mounted. Drill 3/8" (9.5 mm) holes near both ends of the plywood to align with the slots in the mounting rails as described in **Attaching the Tool**. Other hardware (not supplied) may be necessary under these circumstances.

WARNING: STABILITY HAZARD. All purchased hardware must be a minimum of Grade 2. Hardware should be 1-1/4" (31.8 mm) longer than the thickness of the tool base you are assembling.

NOTICE: To prevent binding and/or inaccuracy, ensure the plywood is not warped or uneven. If binding and/or inaccuracy occurs, replace the plywood with a non-warped, even piece of plywood.

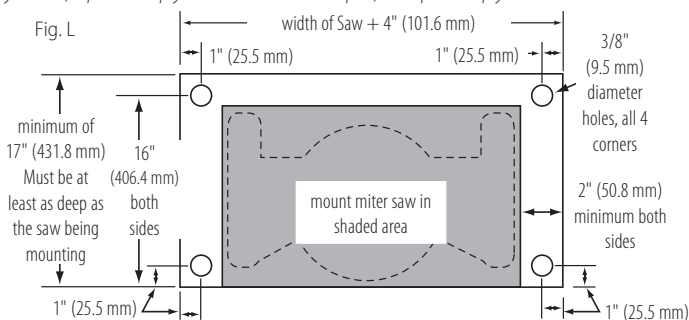

TO RAISE AND LOWER THE STAND (FIG. A, M, O)

WARNING: PINCH AND IMPACT HAZARD. The spring loaded mechanism is under tension and can open unexpectedly, with high force.

1. Turn the stand right side up on the floor.

IMPORTANT: Stand must be right side up when cutting white cable ties **34**.

Fig. M

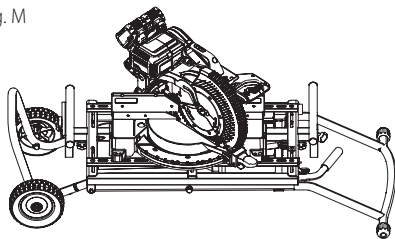
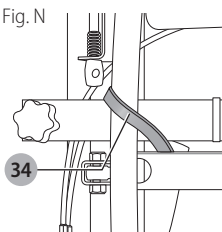

Fig. N



2. While holding down on the top of the stand frame, use wire cutting pliers to cut the white cable ties.

IMPORTANT: DO NOT cut the black cable ties securing the cables that open the stand.

3. Place one foot on the bottom of the leg extension **4**. Hold the handle down with one hand, push the red activating lever **12** to disengage the latching mechanism.
4. Lift the handle **8** with both hands.

The stand has three positions: closed, fully extended and intermediate

To Reach the Intermediate Position:

Lift up on the handle and slowly raise the stand. The stand will stop at the intermediate position. Release the lever.

NOTE: When in the intermediate position, the stand will lower slightly when a tool is placed on it. The intermediate position does not lock against upward motion. The stand relies on the weight of the tool to remain in the intermediate position.

Fig. O

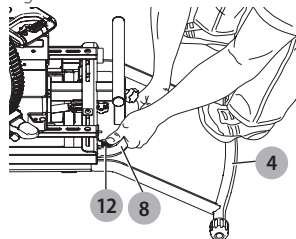

To Fully Extend Stand:

Start in the intermediate position. Repeat STEPS 3–4. Lift up on the handle and raise the stand to the fully extended position. The stand will latch in the fully extended position. Release the lever.

To Close Stand :

Repeat STEPS 3–4. You must lift up on the handle and then push down until the stand is closed. Release the lever.

IMPORTANT: Lift the handle first to disengage latch before able to lower stand.

ATTACHING THE EXTENSION ARMS AND WORK SUPPORTS (FIG. A, P, Q)

IMPORTANT: Be sure the longer side of the “T” in the work support arm 9 is oriented down as shown in Figure I. Ensure the arrow on the label points down.

1. Insert the long work support arm with the small black cap (24, Fig. P) into the hole (25) of the stand closest to the red activating lever. Push the arm in to snap in place.
2. Repeat for other work support arm on opposite end. Push the arm in to snap in place. Tighten the horizontal locking knobs to secure.
3. With the stand raised to desired height, insert the work support (10) into the top of the extension arm (9) hole. The threaded hole in the work support should be facing outward.
4. Insert the vertical locking knob (6) into the side hole of the work support arm.
5. Tighten the vertical lock knob (6).
6. Repeat with the other work support.

Fig. P

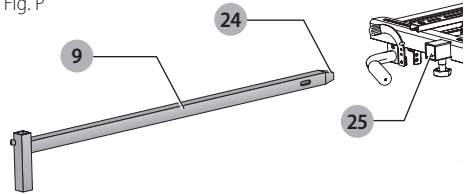

NOTE: The internal locking mechanism keeps the work support arm from disengaging.

Attaching the Stop Plate

1. Align the slot in the stoping plate (11) with the outward facing threaded hole of the work support (10).

NOTE: The stopping plate can be attached to either work support.

2. Secure the stop plate to work support by installing and tightening knob shown in figure J.

Fig. Q

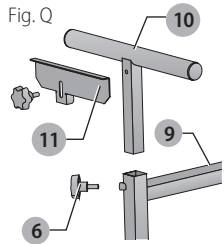

PRODUCT STABILITY TEST (Fig. R, S)

IMPORTANT: This test must be performed prior to using stand and saw together.

The rolling miter saw stand is designed to be used in conjunction with a wide variety of miter saws, compound miter saws and sliding compound miter saws.

WARNING: For your own safety, use two or more people to perform the stability test or serious injury could result.

WARNING: The cutting head **MUST** be raised on all miter saws, compound miter saws and sliding compound miter saws. All sliding compound miter saws **MUST** be locked in the rear position. Failure to do so may result in serious personal injury.

WARNING: **STABILITY HAZARD. Stay alert. The stand may tip during this procedure. Serious injury may result.**

1. With one person in front of saw/stand and one person in back of saw/stand, both ready to catch saw, the person in front lifts the front legs approximately 2.5" (63.5 mm) and then lets it go, dropping it.
Does stand tend to tip over toward front?
If so, re-adjust saw further back on stand and retighten fasteners.
2. The person in back lifts rear legs approximately 2.5" (63.5 mm) and drops it.
Does stand tend to tip over toward back?
If so, readjust saw toward front of stand and retighten fasteners.

Fig. R

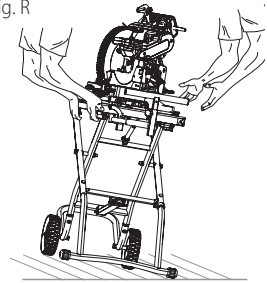
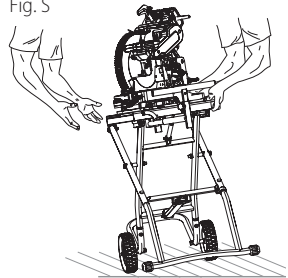
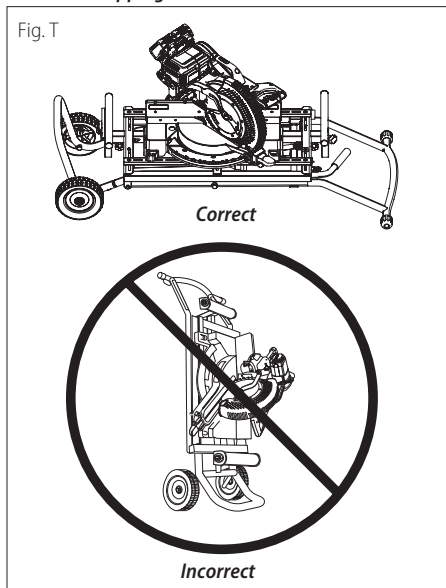

Fig. S



Storage and Transportation

- !** **WARNING: TIPPING HAZARD.** The stand may tip when storing or transporting the stand in the vertical position. Transport or store the stand in the horizontal position to reduce the risk of the stand tipping.



Repairs

- !** **WARNING:** To assure product SAFETY and RELIABILITY, repairs, maintenance and adjustment (including brush inspection and replacement) should be performed by a DeWALT factory service center or a DeWALT authorized service center. Always use identical replacement parts.

Register Online

Thank you for your purchase. Register your product now for:

- **WARRANTY SERVICE:** Registering your product will help you obtain more efficient warranty service in case there is a problem with your product.
- **CONFIRMATION OF OWNERSHIP:** In case of an insurance loss, such as fire, flood or theft, your registration of ownership will serve as your proof of purchase.
- **FOR YOUR SAFETY:** Registering your product will allow us to contact you in the unlikely event a safety notification is required under the Federal Consumer Safety Act.

Cleaning

- !** **WARNING:** Blow dirt and dust out of all air vents with clean, dry air at least once a week. To minimize the risk of eye injury, always wear ANSI Z87.1 approved eye protection when performing this.
- !** **WARNING:** Never use solvents or other harsh chemicals for cleaning the non-metallic parts of the tool. These chemicals may weaken the plastic materials used in these parts. Use a cloth dampened only with water and mild soap. Never let any liquid get inside the tool; never immerse any part of the tool into a liquid.

Accessories

- !** **WARNING:** Since accessories, other than those offered by DeWALT, have not been tested with this product, use of such accessories with this tool could be hazardous. To reduce the risk of injury, only DeWALT recommended accessories should be used with this product.