

**Erickson Version : CP3019-12AC / CP3019-20AC / CP3019-13A4 /
CP3019-18A3/CP3019-20A3 / CP3019-12AF / CP3019-20AF
Cnomo Version : CP3019-12AC / CP3019-20AC**

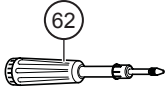

OPTIONAL ACCESSORIES

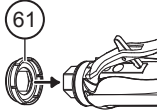
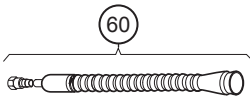

Item	Part no	Qty	Description
60	6153961010	1	Silencer kit
61	6153931240	1	Clipable silencer
62	6159901490	1	Grease gun 0.8 oz (24gr)
	6159901480	1	Grease for bevel gear 2.2lb (1kg)
	6158040980	1	2" (50mm) backing pad. for CP3019-..AF
	2050547523	1	Overhose 31" (0.8m)
	6154320110	1	Silencer kit 31" (0.8m)





Vibration levels



Sound levels

ISO 28927-3: sander

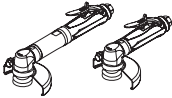
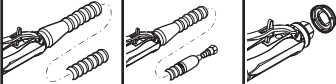
EN ISO
15744

	 Average A m/s ²		Uncertainty K m/s ²		 Kit 6158751060 Kit 6153961010 Kit 6153961240			
	LpA dB(A)	Noise variation		lb	kg			
CP3019-12AC	3.7	1.9	78	-4 to -9 dBa +/- 2 dBa	0.23	0.51		
CP3019-20AC	4.3	3.4	82	-4 to -9 dBa +/- 2 dBa	0.23	0.51		
CP3019-13A4	8.6	3.0	79.3	-4 to -9 dBa +/- 2 dBa	0.3	0.66		
CP3019-18A3	12.3	2.6	80.4	-4 to -9 dBa +/- 2 dBa	0.29	0.63		
CP3019-20A3	13.3	3.2	82.6	-4 to -9 dBa +/- 2 dBa	0.29	0.63		
CP3019-12AF	<2.5	-	77.6	-4 to -9 dBa +/- 2 dBa	0.29	0.63		
CP3019-20AF	2.7	1.3	81.6	-4 to -9 dBa +/- 2 dBa	0.29	0.63		
CP3019-12AC Cnomo	2.9	0.9	75	-4 to -9 dBa +/- 2 dBa	0.23	0.51		
CP3019-20AC Cnomo	4.7	2.4	78	-4 to -9 dBa +/- 2 dBa	0.23	0.51		

LpA Sound pressure level

KpA = 3 dB Uncertainty



WARNING

To reduce risk of injury, everyone using, installing, repairing, maintaining, changing accessories on, or working near this tool must read and understand these instructions before performing any such task.

SAFETY INSTRUCTIONS

• DO NOT DISCARD - GIVE TO USER

- Our goal is to produce tools that help you work safely and efficiently. The most important safety device for this or any tool is YOU. Your care and good judgement are the best protection against injury. All possible hazards cannot be covered here, but we have tried to highlight some of the important ones.
- Only qualified and trained operators should install, adjust or use this power tool.
- This tool and its accessories must not be modified in any way.
- Do not use this tool if it has been damaged.
- If the rated speed, operating pressure or hazard warning signs on the tool cease to be legible or become detached, replace without delay.

▲ Air supply and connection hazards

- Air under pressure can cause severe injury.
- Always shut off air supply, drain hose of air pressure and disconnect tool from air supply when not in use, before changing accessories or when making repairs.
- Never direct air at yourself or anyone else.
- Whipping hoses can cause severe injury. Always check for damaged or loose hoses and fittings.
- Do not use quick disconnect couplings at tool. See instructions for correct set up.
- Whenever universal twist couplings are used, lock pins must be installed.
- Do not exceed maximum air pressure of 6.3 bar / 90 psig, or as stated on tool nameplate.

▲ Entanglement hazards

- Keep away from rotating drive spindle and abrasive. Rotation may continue for several seconds after the throttle has been released. Do not lay the tool down until rotation has stopped.
- Choking, scalping and / or lacerations can occur if loose clothing, gloves, jewellery, neck ware and hair are not kept away from tool and accessories.

▲ Projectile hazards

- Failure of the accessory or abrasive, or of the workpiece, can generate high-velocity projectiles. Even small projectiles can injure eyes and cause blindness.
- Always wear impact-resistant eye and face protection when involved with or near the operation, repair or maintenance of the tool or changing accessories on the tool.
- Be sure all others in the area are wearing impact-resistant eye and face protection
- Use barriers to protect others from wheel fragments and grinding sparks.
- Daily measure the air tool speed with a tachometer to make sure that it is not greater than the RPM marked on the grinding accessory.
- Ensure that the abrasive is securely clamped to the die grinder using the tools provided.

- Ensure that the workpiece is securely fixed.

▲ Accessory hazards

- Always shut off air supply, relieve hose of air pressure and disconnect tool from air supply when changing accessories.
- Use only recommended sizes and types of accessories and consumables.
- Do not use mounted wheels which are chipped or cracked, or may have been dropped.
- Never mount a grinding wheel, cut-off wheel or router cutter on a die grinder. A grinding wheel that bursts can cause very serious injury or death.
- Never use an abrasive with a permitted speed lower than the air grinder speed.
- Correct mounting is necessary to prevent injury from broken mounted wheels.
- Ensure the shaft diameter of the accessory is correct for the size of collet.
- Maximise the gripping length of the accessory: it must not be less than 10mm (0.39 inch). Increased overhang of a mounted wheel reduces its permitted speed – refer to manufacturer's recommendations and ANSI B7.1.
- Before grinding, test mounted wheel by briefly running tool at full throttle. Be sure to use a barrier (such as under a heavy work table) to stop any possible broken wheel parts. Stop immediately if vibration is excessive.

▲ Operating hazards

- Operators and maintenance personnel must be physically able to handle the bulk, weight and power of the tool.
- Hold the tool correctly: be ready to counteract normal or sudden movements – have both hands available.
- You can be cut or burned if you come into contact with the accessory, grinding sparks or the work surface. Avoid contact and wear protective equipment such as gloves, apron and helmet.
- Do not use if vibration becomes excessive: check the accessory for damage or incorrect mounting.
- Ensure that sparks do not cause a hazard to people or materials.
- There is a risk of electrostatic discharge if used on plastic and other non-conductive materials.

▲ Repetitive motion hazards

- When using a power tool to perform work-related activities, the operator might experience discomfort in the hands, arms, shoulders, neck, or other parts of the body.
- Adopt a comfortable posture whilst maintaining secure footing and avoiding awkward or off-balance postures. Changing posture during extended tasks can help avoid discomfort and fatigue.
- Do not ignore symptoms such as persistent or recurring discomfort, pain, throbbing, aching, tingling, numbness, burning sensation, or stiffness. Stop using the tool, tell your employer and consult a physician.

▲ Noise and vibration hazards

- High sound levels can cause permanent hearing loss and other problems such as tinnitus. Use hearing protection as recommended by your employer or occupational health and safety regulations.
- Exposure to vibration can cause disabling damage to the nerves and blood supply of the hands and arms. Wear warm clothing and keep your hands warm and dry. If numbness, tingling, pain or whitening of the skin occurs, stop using tool, tell your employer and consult a physician.
- Hold the tool in a light but safe grip because the risk from vibration is generally greater when the grip force is higher. Where possible support

the weight of the tool with a balancer.

- To prevent unnecessary increases in noise and vibration levels:
 - Operate and maintain the tool, and select, maintain and replace the accessories and consumables, in accordance with this instruction manual;
 - Use damping materials to prevent workpieces from "ringing".

Workplace hazards

- Slip/Trip/Fall is a major cause of serious injury or death. Be aware of excess hose left on the walking or work surface.
- Avoid inhaling dust or fumes or handling debris from the work process which can cause ill health (for example, cancer, birth defects, asthma and/or dermatitis). Use dust extraction and wear respiratory protective equipment when working with materials which produce airborne particles.
- Some dust created by power sanding, sawing, grinding, drilling and other construction activities contains chemicals known to the State of

California to cause cancer and birth defects or other reproductive harm. Some examples of these chemicals are:

- Lead from lead based paints
- Crystalline silica bricks and cement and other masonry products
- Arsenic and chromium from chemically-treated rubber
- Your risk from these exposures varies, depending on how often you do this type of work.
- To reduce your exposure to these chemicals: work in a well ventilated area, and work with approved safety equipment, such as dust masks that are specially designed to filter out microscopic particles.
- Proceed with care in unfamiliar surroundings. Hidden hazards may exist, such as electricity or other utility lines.
- Potentially explosive atmospheres can be caused by dust and fumes resulting from sanding or grinding. Always use dust extraction or suppression systems which are suitable for the material being processed.
- This tool is not intended for use in potentially explosive atmospheres and is not insulated from coming into contact with electric power.

(4) declare that the product(s):

PNEUMATIC COLLET GRINDER

(5) Machine type(s) :

Type	Speed (RPM)	Power (W - Hp)	Type	Speed (RPM)	Power (W - Hp)
CP3109-13AC	13 000	600 - 0.8	CP3019-20AC	20 000	375 - 0.5
CP3109-19ES	19 000	600 - 0.8	CP3019-20 CNOMO	20 000	375 - 0.5
CP3109-24ES	24 000	600 - 0.8	CP3019-25 CNOMO	25 000	375 - 0.5
CP3109-28ES	28 000	600 - 0.8	CP3019-31 CNOMO	31 000	375 - 0.5
CP3119-12ES	12 000	900 - 1.21	CP3019-40 CNOMO	40 000	375 - 0.5
CP3119-15ES	15 000	900 - 1.21	CP3019-20ES CNOMO	20 000	375 - 0.5
CP3119-18ES	18 000	900 - 1.21	CP3019-25ES CNOMO	25 000	375 - 0.5
CP3119-22ES	22 000	900 - 1.21	CP3019-31ES CNOMO	31 000	375 - 0.5
CP3109-19	19 000	600 - 0.8	CP3019-40ES CNOMO	40 000	375 - 0.5
CP3109-24	24 000	600 - 0.8	CP3019-12AC CNOMO	12000	375-0.5
CP3109-28	28 000	600 - 0.8	CP3119-12 CNOMO	12 000	900 - 1.21
CP3119-12	12 000	900 - 1.21	CP3119-15 CNOMO	15 000	900 - 1.21
CP3119-15	15 000	900 - 1.21	CP3119-18 CNOMO	18 000	900 - 1.21
CP3119-18	18 000	900 - 1.21	CP3119-22 CNOMO	22 000	900 - 1.21
CP3119-22	22 000	900 - 1.21	CP3119-12ES CNOMO	12 000	900 - 1.21
CP3119-12EL	12 000	900 - 1.21	CP3119-15ES CNOMO	15 000	900 - 1.21
CP3119-12EXL	12 000	900 - 1.21	CP3119-18ES CNOMO	18 000	900 - 1.21
CP3019-18	18 000	375 - 0.5	CP3119-22ES CNOMO	22 000	900 - 1.21
CP3019-20	20 000	375 - 0.5	CP3119-055	5500	900 - 1.21
CP3019-25	25 000	375 - 0.5	CP3119-035	3500	900 - 1.21
CP3019-31	31 000	375 - 0.5	CP3119-010	1000	900 - 1.21
CP3019-40	40 000	375 - 0.5	CP3019-20AC CNOMO	20 000	375-0.5
CP3019-20ES	20 000	375 - 0.5			
CP3019-25ES	25 000	375 - 0.5			
CP3019-31ES	31 000	375 - 0.5			
CP3019-40ES	40 000	375 - 0.5			
CP3019-12AC	12 000	375 - 0.5			

Stick here

(6) Origin of the product : Hungary

(7) is in conformity with the requirements of the council Directives on the approximation of the laws of the Member States relating :

(8) to "**Machinery**" 2006/42/EC (17/05/2006)

• (11) applicable harmonised standard(s) : EN ISO 11148-9:2011

(12) NAME and POSITION of issuer :

Bruno BLANCHET
(General Manager)



(13) Place & Date : Saint-Herblain, 30/04/2012

⊕ "Loctite 222"
● "Loctite 270"

⊕ 13 / 18	* ↻	1.4Nm
31 / 18	↻	10Nm
31 / 24	↻	10Nm
⊕ 28 / 11	↻	35Nm
28 / 25	↻	35Nm
35 / 30	↻	35Nm
⊕ 1 / 11	↻	25Nm
● 32 / 34 - 42	↻	11Nm

◀ Tightening direction

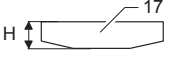
	mm
H maxi	6.6
H mini	5.6

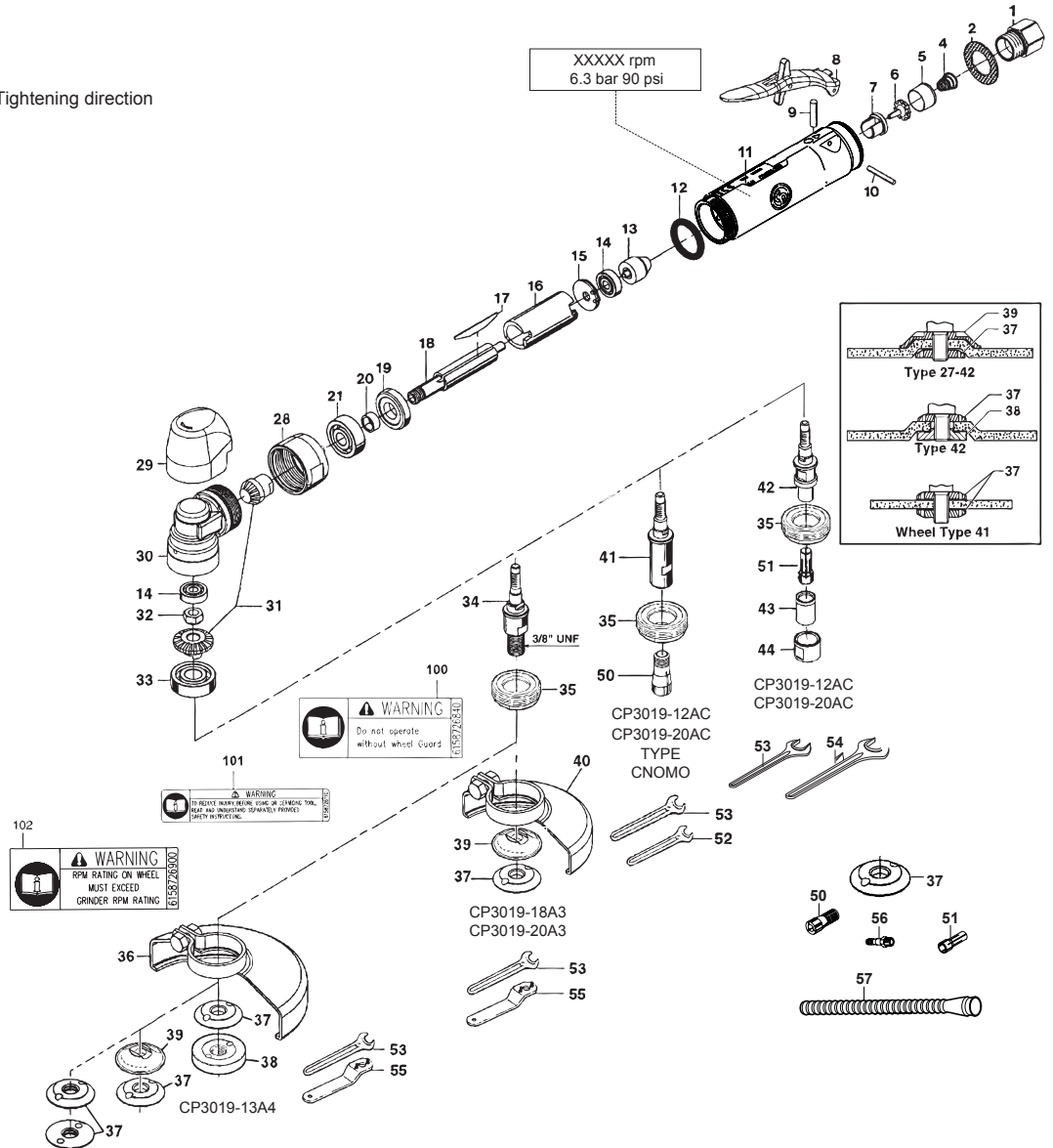

Item	Part No	Description	Qty
A	2050542053	AIR INLET KIT	
1	-	Adapter complete 1/4"	1
2	-	Silencer	1
B	2050542063	THROTTLE KIT	
4	-	Spring valve	1
5	-	Tube inlet	1
6	-	Throttle valve	1
7	-	Seat valve	1
C	2050542073	LEVER KIT	
8	-	Throttle lever	1
9	-	Pin	1
10	-	Pin	1
D	2050542083	REAR PLATE KIT	
14	758.63	Ball bearing	1
15	-	Rear end plate	1
E	2050542093	FRONT PLATE KIT	
19	-	Front end plate	1
21	758.113	Ball bearing CP3019-..	1
20	-	Collar rotor	1
F	2050542103	MOTOR KIT	
12	-	O-Ring	1
D	2050542083	REAR PLATE KIT	1
E	2050542093	FRONT PLATE KIT	1
16	400.134	Cylinder	1
17	434.55	Blade	3
18	426.92	Rotor	1
G	2050541693	COLLET CLAMP KIT	
43	-	Cap (CP3019-..AC)	1
44	-	Nut (CP3019-..AC)	1

Item	Part No	Description	Qty
H	2050541313	BEVEL GEAR KIT	
14	758.63	Ball bearing	1
31	-	Gear-bevel	1
32	-	Nut	1
33	758.117	Ball bearing	1
I	2050541323	ANGLE HEAD KIT CP3019-..A3, A4	
H	2050541313	BEVEL GEAR KIT	
29	6155704290	Sleeve protection	1
30	595.230	Housing angle	1
34	-	Spindle-wheel 3/8" (CP3019-..A3, CP3019-..A4)	1
35	-	Cap-angle housing	1
J	2050541333	ANGLE HEAD KIT CP3019-..AC	
H	2050541313	BEVEL GEAR KIT	1
G	2050541413	COLLET CLAMP KIT	1
29	6155704290	Sleeve protection	1
30	595.230	Housing angle	1
35	-	Cap-angle housing	1
42	2050541433	Spindle-Collet (CP3019-..AC)	1
51	6155260590	Serie 300 resilient collet ø1/4"	1
K	2050559713	ANGLE HEAD KIT CP3019 Cnomo	
H	2050541313	BEVEL GEAR KIT	1
G	2050541413	COLLET CLAMP KIT	1
29	6155704290	Sleeve protection	1
30	595.230	Housing angle	1
35	-	Cap-angle housing	1
41	6155011040	CNOMO collet holder	1
50	6155260460	Collet ø633 for CP3019 Cnomo	1

Item	Part No	Description	Qty
11	2050542193	Motor housing Kit	1
13	457.30	Governor CP3019-20AC, CP3019-20A3	1
13	457.29	Governor CP3019-12AC	1
13	457.25	Governor CP3019-13A4	1
13	457.31	Governor CP3019-18A3	1
21	758.113	Ball bearing	1
28	730.179	Sleeve alignment	1
36	6155041600	Wheel guard 4" (CP3019-..A4)	1
37	6155020640	Flange (CP3019-..A3)	1
37	6155020640	Flange (CP3019-..A4)	2
38	6156065150	Rear flange (CP3019-..A4)	1
39	6155031440	Rear flange	1
40	6155041550	Wheel guard 3" (CP3019-..A3)	1
52	6158010020	Flat Wrench 3/8" for Cnomo tools	1
53	6158010030	Flat Wrench 11/16"	1
54	6158010320	Flat wrench 11/16"	1
55	6158020080	Pin wrench	1
56	6157040190	Air hose nipple 1/4" for 5/6" ID hose	1
57	6158751060	Exhaust hose L=31"	1
100	6158726840	Warning guard label	1
101	6158726110	Warning instruction label	1
102	6158726900	Warning wheel speed label	1
TUNE UP KIT			
	2050542133	Including Part No. 2, 12, 17, 9, 10, 21, 33	1

	2050541913	Operator's manual
	6159948750	Safety instructions die-grinder
	6159948760	Safety instructions grinder
	2050541103	EC declaration die-grinder
	2050541213	EC declaration grinder

Rely only on high-grade air tools and compressors offered on our virtual shelves.