



**Chicago  
Pneumatic**

# ***Operator's Manual***

**CP0611-D28H & CP0611-D28L Series**

**1" & spline #5 Impact Wrench**



## **WARNING**

*To reduce risk of injury, everyone using, installing, repairing, maintaining, changing accessories on, or working near this tool must read and understand these instructions, as well as separately provided safety instructions part number 6159948710, before performing any such task.*

# Air Diagram:

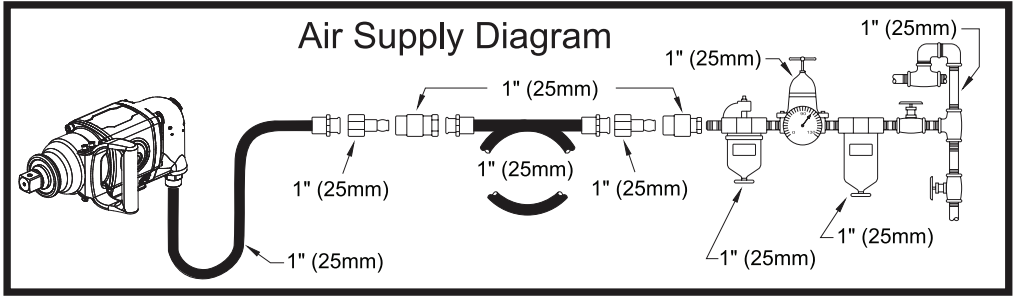

Fig. 1

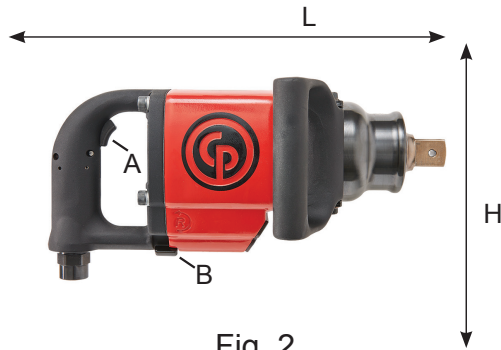

Fig. 2

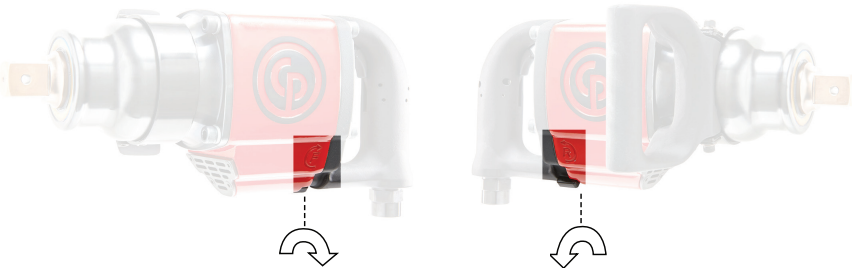

Fig. 3

Model	Drive	Torque		Speed	Weight	Inner hose diameter	Dimension	Air consumption @ load	Air inlet	Sound		Vibrations	
		Working	Max							Pressure	Power	a	k
	1	2		3	4	5	6	7	8	9		10	11
	in.	ft.lbs N.m	ft.lbs N.m	rpm	lbs kg	in. mm	in. mm	SCFM NI/s	in.	dB(a)	dB(a)	m/s <sup>2</sup>	m/s <sup>2</sup>
CP0611-D28H	1"	900 - 1 800	2 800	3500	22.5	1"	10.2*4.3*6.9	68	1/2"	99	110	18.0	4.1
CP0611-D28L	Spline #5	1 220 - 2 440	3790		10.4	25	360*110*175	32	FEMALE				

Fig. 4

# CP0611-D28H & CP0611-D28L Series

## Impact Wrench

### 1. Technical Data (see Fig 5.)

Model	Drive	Torque		Speed	Weight	Inner Hose Dia.	Dimension L x H x W	Air Consumption		Air Inlet	Sound-Pressure L <sub>pA</sub>	Sound-Power L <sub>wA</sub>	Vibrations	
		Working	Max					At load					ahd	k
	1	2	3	4	5	6	7	8	9	10	11			
	[inch]	[ft.lbs] [Nm]	[ft.lbs] [Nm]	[min-1]	[lb] [kg]	[inch.] [mm]	[inch.] [mm]	[SCFM] [NI/s]	[inch]	[dB(A)]	[dB(A)]	[m/s <sup>2</sup> ]	[m/s <sup>2</sup> ]	

max pressure 6.3 bar (90 psi)

$a_{wh}$ : Vibration level, k Uncertainty;  $L_{pA}$  Sound pressure level dB(A),  $K_{pA} = K_{wA} = 3$  dB Uncertainty.

**Declaration of noise (ISO 15744) and vibration emission (ISO 28927-2)**

All values are current as of the date of this publication.

These declared values were obtained by laboratory type testing in accordance with the stated standards and are suitable for comparison with the declared values of other tools tested in accordance with the same standards. These declared values are not adequate for use in risk assessments and values measured in individual work places may be higher. The actual exposure values and risk of harm experienced by an individual user are unique and depend upon the way the user works, the workplace and the workstation design, as well upon the exposure time and the physical condition of the user.

We, CHICAGO PNEUMATIC TOOLS, cannot be held liable for the consequences of using the declared values, instead of values reflecting the actual exposure, in an individual risk assessment in a work place situation over which we have no control.

This tool may cause hand-arm vibration syndrome if its use is not adequately managed.

We recommend a programme of health surveillance to detect early symptoms which may relate to noise or vibration exposure, so that management procedures can be modified to help prevent future impairment.

### 2. Machine Type

- This product is designed for installing and removing threaded fasteners in wood, metal and plastic. No other use permitted. For professional use only.
- Please read the product safety information carefully!

### 3. Implementation and Operation

- Connect device as shown in Fig.1.
- Fix the accessories properly to the tool.
- To switch rotation, turn the switch (B) as shown in Fig. 3
- To start the machine, simply pull the trigger (A). Machine speed is increased by increasing pressure on the trigger. Release the trigger to stop.
- Use the reverse switch (B) only when the drive spindle comes to a complete stop.

### 4. Lubrication

#### • Motor Lubrication

Use an air line lubricator with SAE #10 oil, adjusted to two (2) drops per minute. If an air line lubricator cannot be used, add air motor oil to the inlet once a day.

Recommended lubricant CP Oil PROTECTO-LUBE:

- 4 oz (0.12) P/N: CA149661
- 20.8 oz (0.591) P/N: CA000046
- 1gal (3.8l) P/N: P089507

#### • Clutch Lubrication

Use CP Pneu-Lube Synthetic Clutch Grease 8940158455: 1 oz. (30g).

### 5. Maintenance

- Follow local country environmental regulations for safe handling and disposal of all components**
- Disassemble and inspect the tool every three 3 months if the tool is used every day. Replace damaged or worn parts.
- Always ensure that the machine is disconnected from energy source (compressed air) to avoid accidental operation.
- High wear parts are underlined in the parts list.
- To keep downtime to a minimum, the following service kits are recommended:  
**Tune-Up Kit:** see part list

### 6. Disposal

- The disposal of this equipment must follow the legislation of the respective country.
- All damaged, badly worn or improperly functioning devices **MUST BE TAKEN OUT OF OPERATION.**
- Repair only by technical maintenance staff.**

### 7. Declaration of conformity

We: CHICAGO PNEUMATIC Tool Co.

Declare that the product(s): Impact Wrench

Machine type(s): CP0611-D28H, CP0611-D28L

Serial Number: From 00001 to 99999

Origin of the product: Japan

is in conformity with the requirements of the council Directives on the approximation of the laws of the Member States relating to "Machinery" 2006/42/EC (17/05/2006) applicable harmonised standard(s): EN ISO 11148-6:2012

Name and position of issuer: Nicolas Lebreton (R&D Manager)

Place & Date: Saint-Herblain,

Technical file available from EU headquarter.

### Copyright 2014, Chicago Pneumatic Tool Co. LLC

All rights reserved. Any unauthorized use or copying of the contents or part thereof is prohibited. This applies in particular to trademarks, model denominations, part numbers and drawings. Use only authorized parts. Any damage or malfunction caused by the use of unauthorized parts is not covered by Warranty or Product Liability.