



**Chicago
Pneumatic**

**CP3019-18 / CP3019-20 / CP3019-25 / CP3019-31 / CP3019-40
CP3019-20ES / CP3019-25ES / CP3019-31ES / CP3019-40ES
Erickson and Cnomo version**

Erickson Version



Cnomo Version



**WARNING**

5

EN

To reduce the risk of injury, before using or servicing tool, read and understand the following information as well as separately provided safety instructions (Item number: 6159948750). The features and descriptions of our products are subject to change without prior notice.

ACCESSORIES INCLUDED

Item	New part no.	Qty	Description
55	6157040190	1	1/4" air hose nipple for 8mm ID hose
56	6158751060	1	Exhaust hose L=31"

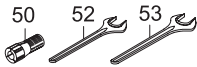
Conmo Version

Item	New part no.	Qty	Description
50	6155260460	1	CNOMO collet Ø 6mm
52	6158010020	1	Flat wrench 25/64"
53	6158010030	1	Flat wrench 7/16"

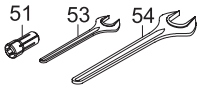
Erickson Version

Item	New part no.	Qty	Description
51	6155260590	1	Series 300 resilient collet Ø 1/4"
53	6158010030	1	Flat wrench 7/16"
54	6158010320	1	Flat wrench 11/16"

OPTIONAL ACCESSORIES

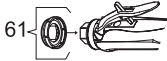
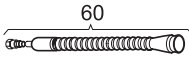

Item	New part no.	Qty	Description
60	6153961010	1	Silencer kit
61	6153931240	1	Clipable silencer

Cnomo Version



Item	New part no.	Qty	Description
50	6155260890	1	CNOMO collet Ø 2.5mm
50	6155260440	1	CNOMO collet Ø 3mm
50	6155260450	1	CNOMO collet Ø 1/8"
50	6155260900	1	CNOMO Collet 5/32"
50	6155260910	1	CNOMO Collet Ø 4.5mm
50	6155260920	1	CNOMO Collet Ø 5mm
50	6155260470	1	CNOMO Collet Ø 1/4"

Erickson Version



Item	New part no.	Qty	Description
51	6155260520	1	Serie 300 resilent collet Ø 3/64"
51	6155260530	1	Serie 300 resilent collet Ø 5/64"
51	6155260540	1	Serie 300 resilent collet Ø 3/32"
51	6155260550	1	Serie 300 resilent collet Ø 1/8"
51	6155260560	1	Serie 300 resilent collet Ø 5/32"
51	6155260570	1	Serie 300 resilent collet Ø 3/16"
51	6155260580	1	Serie 300 resilent collet Ø 7/32"

Original instructions.**© Copyright 2010, Chicago Pneumatic Tool Co. LLC**

All rights reserved. Any unauthorized use or copying of the contents or part thereof is prohibited. This applies in particular to trademarks, model denominations, part numbers and drawings. Use only authorized parts. Any damage or malfunction caused by the use of unauthorised parts is not covered by Warranty or Product Liability.

INSTRUCTIONS

This product is designed for removing material using abrasives. No other use permitted. For professional use only. Before servicing the power tool, the supply of compressed air must be disconnected or shut off.



When disposing of components, lubricants, etc ... ensure that the relevant safety procedures are carried out.



The tool is designed for a working pressure of 6.3 bar (90 psig). The compressed air must be clean. The installation of a filter is recommended. For maximum efficiency and performance, comply with the specification of the air hose (antistatic hose). (Refer to figure no.1 for compressed air connection).
A: $\varnothing_{\text{mini}} = 8\text{mm}$ (5/16")
B: 7 m max.



To obtain maximum efficiency from the pneumatic tool, preserve its features and avoid repeated repairs, a routine inspection and repair programme are recommended at least every 500 hours, the intervals between the various inspections depending on the amount of exertion on the power tool.



For dust extraction, please contact your local sales.



Check the free speed of the tool at regular intervals and after each operation or maintenance task. Remove the abrasive to check the speed. The maximum allowed speed shown on the tool must not be exceeded and the vibration level must not be excessive.



This tool is fitted with blades which can operate without lubricated air. However, a small amount of oil allows the tool to provide full power and lengthens its life. The use of dry air with no trace of oil may reduce the life of blades.

Declaration of noise and vibration emission.

These declared values were obtained by laboratory type testing in accordance with the stated standards and are suitable for comparison with the declared values of other tools tested in accordance with the same standards. These declared values are not adequate for use in risk assessments and values measured in individual work places may be higher. The actual exposure values and risk of harm experienced by an individual user are unique and depend upon the way the user works, the workpiece and the workstation design, as well upon the exposure time and the physical condition of the user.

We, Chicago Pneumatic, cannot be held liable for the consequences of using the declared values, instead of values reflecting the actual exposure, in an individual risk assessment in a work place situation over which we have no control.

We recommend a programme of health surveillance to detect early symptoms which may relate to noise or vibration exposure, so that management procedures can be modified to help prevent future impairment.

DISASSEMBLY AND REASSEMBLY INSTRUCTIONS



**Disconnect the machine from the compressed air supply.
Remove all accessories.**

Disassembling the turbine (see figure 2)

- Hold the housing (11) in one hand and remove the turbine assembly by pulling the collet-holder (22) or the collet nut (27) or the coupling fork (29).
- Position a flat wrench on the flats of the collet-holder (22) or of the collet nut (27) or coupling fork (29), then unscrew the governor (13).



Do not dismantle the governor, as it is an integral assembly.

- Disassemble the turbine (see figure 3).
- CLAMP THE ROTOR SLIGHTLY IN A VICE FITTED WITH LEAD JAWS, then unscrew the collet-holder (22) or the collet nut (27) or the coupling fork (29).

Reassembling the turbine

- Proceed in reverse order with respect to disassembly.



Be careful with the direction for assembling the blades.

- Apply a small quantity of "Loctite 222" on the thread of the governor (13) before tightening it to a 1.4N.m. torque.



Be careful with the direction for assembling the cylinder, align the lugs of the rear end plate (15) with the cylinder (16) throttle.

Disassembling the front housing

- Remove the spacer (30).
- Using a mallet, tap on the end of the collet-holder (22 or 25) to remove the shaft assembly.
- Unscrew the coupling fork (29), extract bearing (21), spacer (32) and the 3 bearings (33).
- For re-assembly, proceed in reverse order.

