

# INSTRUCTIONS

## #15-133 Drywall Taper

### Loading Instructions:

1. Unlatch the clasps and lift the lid of the unit. The handle and hardware for the lid (side handle) can be found inside the unit. Load with any 250' or 500' roll of paper wallboard tape not over 2-1/8" inches wide.

Place the roll on the roll holder as shown. Thread the tape through the two guides, under the lower tape guide, over the upper guide and out through the throat of the unit (shown at right).

**Note:** the tape must run through the slot in the "dam" before going through the two tape guides.

2. Use a standard joint compound (mud), in the Drywall Taper.

**Note:** MIX THE MUD TO THE CONSISTENCY OF A HEAVY TEXTURE PAINT, OR SLIGHTLY THINNER THAN THE USUAL HAND-TAPING MIX. Your joint compound should pour from the mixing container easily. To fill your Drywall Taper, push the tape up to the top of the roof of the unit, near the top handle. Then pour your mud into the body of the Drywall Taper. This will allow the tape to be loaded with mud as it is pulled out of the throat (nozzle) of the unit.

### Special Note:

Use the NOZZLE adjustment screw near the throat of the unit to control the flow of mud from the nozzle. This screw can be adjusted until you have the correct amount of mud flowing out with the tape. Experiment with different settings to find one that best fits your needs.

3. After loading the unit with tape and mud, close the lid and snap the latches closed. You are now ready to begin taping.

### Operating Instructions:

1. Point the nozzle toward the floor, allowing the mud to flow into the nozzle of the unit. This is called "dunking" and is best accomplished by a quick "flick" of your wrist motion to force the compound toward the nozzle.
2. Pull out about 6" of tape.
3. Position tape at the beginning of the joint and hold with a 6" - 8" taping knife.
4. Pull out a comfortable length of tape, keeping Drywall Taper about 6" from the joint. Quickly "dunk" the Drywall Taper again.
5. Adhere tape to wall/ceiling to cover joint. Move taping knife to a new starting point and repeat this pull-dunk operation until you reach the end of the joint.
6. At the end of the joint, hold the tape firmly by depressing it through the "U" (notch) opening on the cutting blade. Then, quickly twist the unit so that the cutter blade shears the tape.
7. With taping knife, flatten tape (bedding it to the wall/ceiling). Remove excess mud into a mud pan for re-use.

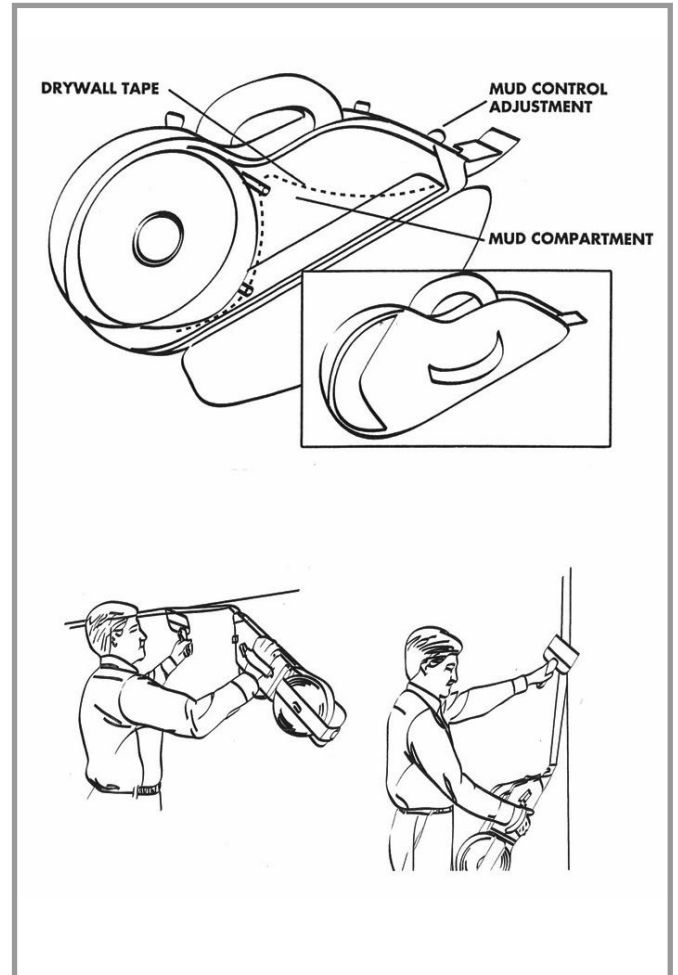

### CARE & MAINTENANCE:

Remember to keep the Drywall Taper clean at ALL times. Do not allow mud to remain in the Drywall Taper for longer than a two hour period. Properly clean the unit after every use.

**Bon**<sup>®</sup>  
Trusted since 1958

When it comes to quality concrete, masonry, drywall tools, Bon is the brand you can depend on.