

Contractor Grade Poly Tray Wheelbarrows

- High molecular weight poly tray is a full .250 thick
- Tray is 26" wide with a large rolled lip for extra strength
- Non-stick surface won't rust or dent
- Legs are made from steel channel



SINGLE WHEEL MODELS

| Part# | Handle Type | Tire |
|--------|-------------|------------------|
| 11-681 | Wood | 16" 4-ply Knobby |
| 28-704 | Wood | 16" Flat Free |
| 28-706 | Wood | 16" 4-ply Ribbed |
| 28-906 | Steel | 16" 4-ply Knobby |
| 28-910 | Steel | 16" Flat Free |
| 28-908 | Steel | 16" 4-ply Ribbed |



DOUBLE WHEEL MODELS

| Part# | Handle Type | Tires |
|--------|-------------|------------------|
| 11-661 | Wood | 16" 4-ply Knobby |
| 28-705 | Wood | 16" Flat Free |
| 28-707 | Wood | 16" 4-ply Ribbed |
| 28-907 | Steel | 16" 4-ply Knobby |
| 28-911 | Steel | 16" Flat Free |
| 28-909 | Steel | 16" 4-ply Ribbed |

#11-661/#11-676/#28-701/#28-703/#28-705
 #28-707/#28-901/#28-903/#28-905/#28-907
 #28-911/#28-909

Double Wheel Wheelbarrows

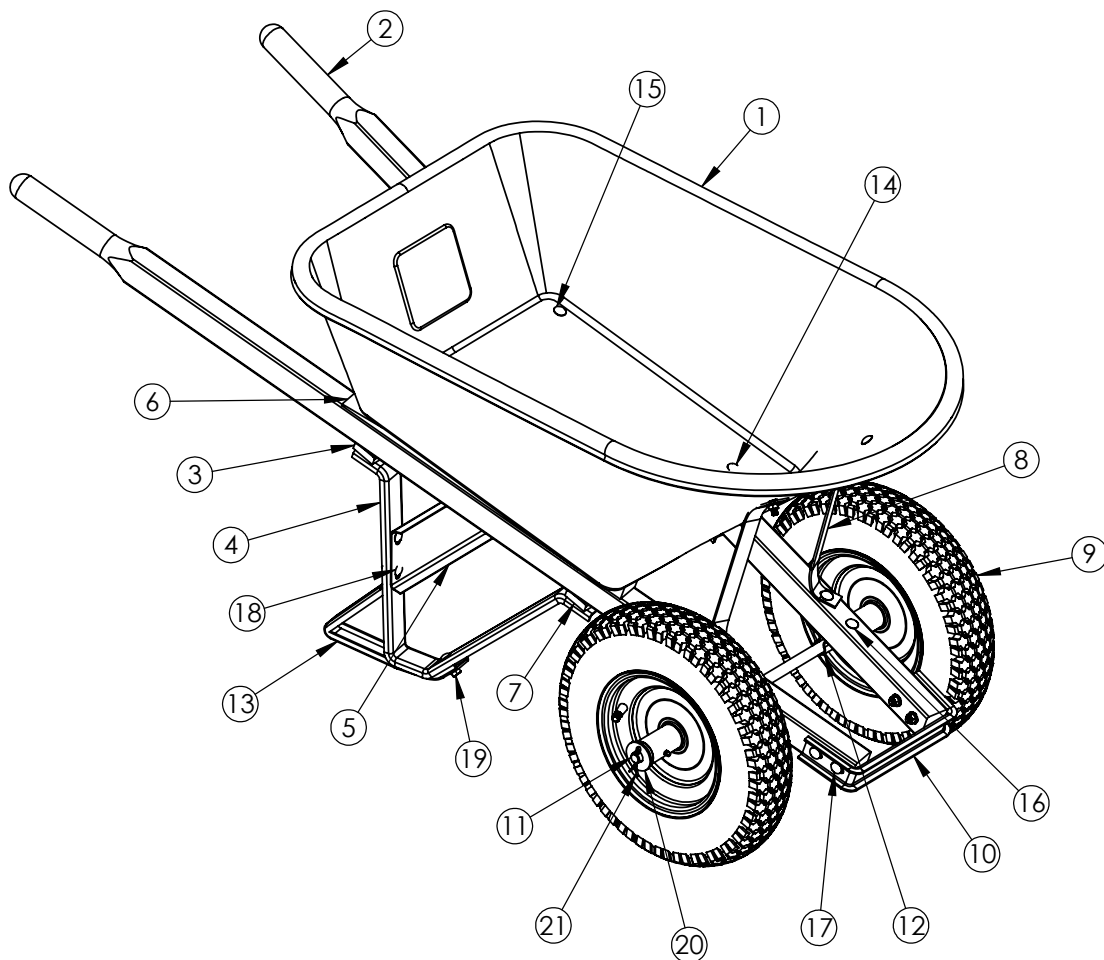

Parts List

| Key # | Part # | Detail | Qty/Unit | Key # | Part # | Detail | Qty/Unit |
|-------|--------|------------------------|----------|-------|--------|--|----------|
| 1 | 50-165 | Steel Tray | 1 | 11 | 50-247 | 24" Axle | 1 |
| 1 | 50-216 | Poly Tray | 1 | 12 | 50-332 | Axle Bracket (Dbl Wheel Only) | 2 |
| 2 | 50-532 | Steel Handles (pr) | 1 | 13 | 50-328 | Leg Stabilizer | 2 |
| 2 | 50-244 | Wood Handles (pr) | 1 | 14 | 52-435 | Carriage Bolt $\frac{5}{16}$ " x 5" | 2 |
| 3 | 50-319 | Rear Support | 1 | 15 | 52-434 | Carriage Bolt $\frac{5}{16}$ " x 3 $\frac{3}{4}$ " | 2 |
| 4 | 50-320 | Leg | 2 | 16 | 52-433 | Carriage Bolt $\frac{5}{16}$ " x 2 $\frac{1}{2}$ " | 4 |
| 5 | 50-321 | Leg Brace | 1 | 17 | 52-401 | Carriage Bolt $\frac{5}{16}$ " x 2 $\frac{1}{4}$ " | 4 |
| 6 | 50-323 | Wedge | 2 | 18 | 52-438 | Carriage Bolt $\frac{5}{16}$ " x 1" | 8 |
| 7 | 50-324 | Front Support | 1 | 19 | 52-232 | Serrated Nut $\frac{5}{16}$ " | 20 |
| 8 | 50-325 | Vertical Tray Brace | 2 | 20 | 52-108 | Washer $\frac{5}{8}$ " x 1- $\frac{3}{4}$ " | 2 |
| 9 | 50-174 | Rim & Tire (Knobby) | 2 | 21 | 52-670 | Cotter Pin | 2 |
| 9 | 84-714 | Rim & Tire (Flat Free) | 2 | n/a | 80-102 | Innertube | 1 |
| 9 | 80-105 | Rim & Tire (Ribbed) | 2 | n/a | 80-101 | Bearings (set of 2) | 1 |
| 10 | 50-326 | Nose Piece | 1 | n/a | 50-329 | Bag of Hardware-Tray | 1 |

Double Wheel Wheelbarrows

Before assembling your Bon Wheelbarrow please make sure you have the following items.

NOTE: The wheelbarrow comes with ONE tray: steel or poly; ONE pair of handles: wood or steel; ONE wheel type: knobby, flat free or ribbed

FOR PARTS LIST INFORMATION REFER TO PL11661

| KEY # | PART # | DETAIL | QTY/UNIT |
|-------|--------|-------------------------------|----------|
| 1 | 50-165 | STEEL TRAY | 1 |
| 1 | 50-216 | POLY TRAY | 1 |
| 2 | 50-244 | WOOD HANDLES (PR) | 1 |
| 2 | 50-532 | STEEL HANDLES (PR) | 1 |
| 3 | 50-319 | REAR SUPPORT | 1 |
| 4 | 50-320 | LEGS | 2 |
| 5 | 50-321 | LEG BRACE | 1 |
| 6 | 50-323 | WEDGES | 2 |
| 7 | 50-324 | FRONT SUPPORT | 1 |
| 8 | 50-325 | VERTICAL TRAY BRACE | 2 |
| 9 | 50-174 | RIM & TIRE (KNOBBY) | 2 |
| 9 | 84-714 | RIM & TIRE (FLAT FREE) | 2 |
| 9 | 80-105 | RIM & TIRE (RIBBED) | 2 |
| 10 | 50-326 | NOSE PIECE | 1 |
| 11 | 50-247 | AXLE 24" | 1 |
| 13 | 50-328 | LEG STABILIZER | 2 |
| 12 | 50-332 | AXLE BRACKET | 2 |
| 14 | 52-435 | CARRIAGE BOLT 5/16" X 5" | 2 |
| 15 | 52-434 | CARRIAGE BOLT 5/16" X 3 3/4" | 2 |
| 16 | 52-433 | CARRIAGE BOLT 5 1/6" X 2 1/2" | 4 |
| 17 | 52-401 | CARRIAGE BOLT 5/16" X 2 1/4" | 4 |
| 18 | 52-438 | CARRIAGE BOLT 5/16" X 1" | 8 |
| 19 | 52-201 | SERRATED NUT 5/16" | 20 |
| 21 | 52-108 | WASHER 5/8" X 3/4" | 2 |
| 20 | 52-670 | COTTER PIN | 2 |
| 21 | 80-102 | INNERTUBE | 1 |
| 21 | 80-101 | BEARINGS (SET OF 2) | 1 |
| N/A | 50-329 | BAG OF HARDWARE - TRAY | 1 |



Attach the leg brace (key #5) by inserting it between the legs using the 1" carriage bolts (key #18) and 5/16" nuts (key #19). While attaching the leg brace (key #5) place the stabilizer (key #13) to the leg (key #4) and fasten with a 1" carriage bolt (key #18).

ASSEMBLING THE AXLE ASSEMBLY

Place the Axle Bracket (key #12) on the handle. Attach the Vertical Tray Brace (key #8) to the Tray using the two 1" carriage bolts (key #18). Next, use the 2-1/2" carriage bolt (key #16) and put it through the Vertical Tray Brace, Axle Bracket, and Handle. Finger tighten one of the 5/16" nuts on the carriage bolt, and complete the above process on the other side of the wheelbarrow. After completing this on the other side, put the 24" Axle (key #11) through the Axle Bracket on both sides. Use the other two 2-1/2" carriage bolts (key #16) and 5/16" nuts (key #19) and finish attaching the axle brackets.

To attach the tires, place each Wheel (key #9) on the axle. Place the washers (key #21) onto each side of the axle and put in the Cotter Pins (key #20), through the holes in the axle.

Attach the nose piece (key #10) by using the 2-1/4" Carriage Bolts (key #17) and 5/16" nuts (key #19). Finally, finish your assembly by tightening all of the nuts using a 1/2" wrench and 1/2" socket.

MAINTENANCE

Periodically, grease the fitting on the tires. Keep clean from debris after use.

ASSEMBLING THE TRAY, HANDLES & LEGS

Place the steel or poly tray (key #1) upside down. Place one wedge (key #6) on the tray with the large end of the wedge facing towards the front of the tray. Place one of the handles (key #2) on top of the wedge (Note which way the handle is coming off of the tray, so as to not attach the handles the wrong way). Matching up the hole at the back end of the tray, wedge, and handle place the rear support (key #3) on top of those items. Finally, place one of the legs (key #4) on top of the rear support with the holes on the legs facing the back of the tray. Matching up the holes, place 3-3/4" carriage bolt (key #15) in through the tray and then finger tighten one of the 5/16" nuts (key #19) onto the carriage bolt. Place the front support (key #7) underneath the leg and put a 5" carriage bolt (key #14) through the tray, wedge, handle, front support, and leg. Finger tighten a 5/16" nut onto the carriage bolt, and do the same thing for the other side.