

## Folded Steel Tray Wheelbarrow

- Deep, narrow (26") 18 gauge steel tray with rolled edge for maximum tray strength
- Legs are made from steel channel
- Tires equipped with zerk fitting and ball bearings
- Leg stabilizer



### SINGLE WHEEL MODELS

Part #	Handles	Tire
#11-300	Wood	16" 4-ply Knobby
#28-700	Wood	16" Flat Free
#28-702	Wood	16" 4-ply Ribbed
#28-900	Steel	16" 4-ply Knobby
#28-904	Steel	16" Flat Free
#28-902	Steel	16" 4-ply Ribbed



### DOUBLE WHEEL MODELS

Part #	Handles	Tire
#11-676	Wood	16" 4-ply Knobby
#28-701	Wood	16" Flat Free
#28-703	Wood	16" 4-ply Ribbed
#28-901	Steel	16" 4-ply Knobby
#28-905	Steel	16" Flat Free
#28-903	Steel	16" 4-ply Ribbed

#11-661/#11-676/#28-701/#28-703/#28-705  
 #28-707/#28-901/#28-903/#28-905/#28-907  
 #28-911/#28-909

# Double Wheel Wheelbarrows

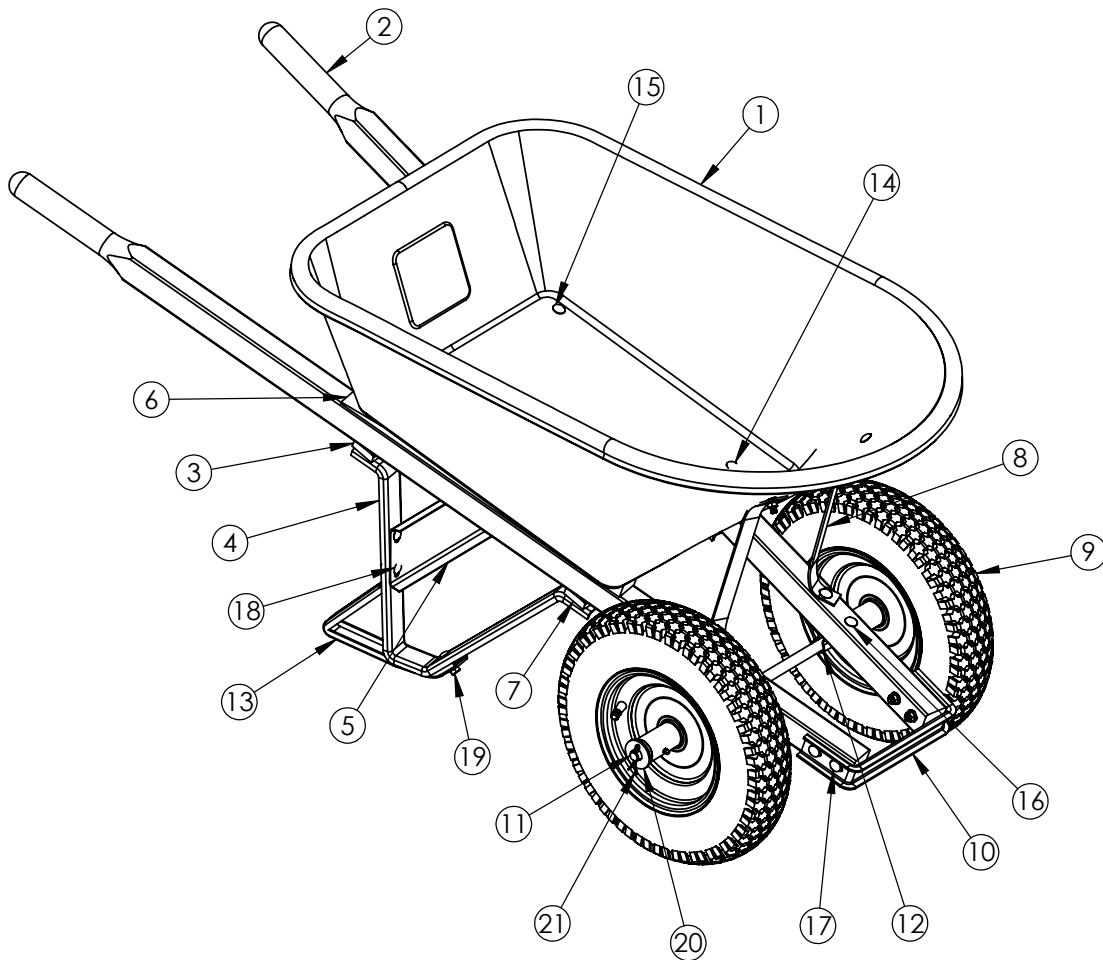

## Parts List

Key #	Part #	Detail	Qty/Unit	Key #	Part #	Detail	Qty/Unit
1	50-165	Steel Tray	1	11	50-247	24" Axle	1
1	50-216	Poly Tray	1	12	50-332	Axle Bracket (Dbl Wheel Only)	2
2	50-532	Steel Handles (pr)	1	13	50-328	Leg Stabilizer	2
2	50-244	Wood Handles (pr)	1	14	52-435	Carriage Bolt $\frac{5}{16}$ " x 5"	2
3	50-319	Rear Support	1	15	52-434	Carriage Bolt $\frac{5}{16}$ " x 3 $\frac{3}{4}$ "	2
4	50-320	Leg	2	16	52-433	Carriage Bolt $\frac{5}{16}$ " x 2 $\frac{1}{2}$ "	4
5	50-321	Leg Brace	1	17	52-401	Carriage Bolt $\frac{5}{16}$ " x 2 $\frac{1}{4}$ "	4
6	50-323	Wedge	2	18	52-438	Carriage Bolt $\frac{5}{16}$ " x 1"	8
7	50-324	Front Support	1	19	52-232	Serrated Nut $\frac{5}{16}$ "	20
8	50-325	Vertical Tray Brace	2	20	52-108	Washer $\frac{5}{8}$ " x 1- $\frac{3}{4}$ "	2
9	50-174	Rim & Tire (Knobby)	2	21	52-670	Cotter Pin	2
9	84-714	Rim & Tire (Flat Free)	2	n/a	80-102	Innertube	1
9	80-105	Rim & Tire (Ribbed)	2	n/a	80-101	Bearings (set of 2)	1
10	50-326	Nose Piece	1	n/a	50-329	Bag of Hardware-Tray	1

# Double Wheel Wheelbarrows

Before assembling your Bon Wheelbarrow please make sure you have the following items.

**NOTE: The wheelbarrow comes with ONE tray: steel or poly; ONE pair of handles: wood or steel; ONE wheel type: knobby, flat free or ribbed**

FOR PARTS LIST INFORMATION REFER TO PL11661

KEY #	PART #	DETAIL	QTY/UNIT
1	50-165	STEEL TRAY	1
1	50-216	POLY TRAY	1
2	50-244	WOOD HANDLES (PR)	1
2	50-532	STEEL HANDLES (PR)	1
3	50-319	REAR SUPPORT	1
4	50-320	LEGS	2
5	50-321	LEG BRACE	1
6	50-323	WEDGES	2
7	50-324	FRONT SUPPORT	1
8	50-325	VERTICAL TRAY BRACE	2
9	50-174	RIM & TIRE (KNOBBY)	2
9	84-714	RIM & TIRE (FLAT FREE)	2
9	80-105	RIM & TIRE (RIBBED)	2
10	50-326	NOSE PIECE	1
11	50-247	AXLE 24"	1
13	50-328	LEG STABILIZER	2
12	50-332	AXLE BRACKET	2
14	52-435	CARRIAGE BOLT 5/16" X 5"	2
15	52-434	CARRIAGE BOLT 5/16" X 3 3/4"	2
16	52-433	CARRIAGE BOLT 5 1/6" X 2 1/2"	4
17	52-401	CARRIAGE BOLT 5/16" X 2 1/4"	4
18	52-438	CARRIAGE BOLT 5/16" X 1"	8
19	52-201	SERRATED NUT 5/16"	20
21	52-108	WASHER 5/8" X 3/4"	2
20	52-670	COTTER PIN	2
21	80-102	INNERTUBE	1
21	80-101	BEARINGS (SET OF 2)	1
N/A	50-329	BAG OF HARDWARE - TRAY	1



Attach the leg brace (key #5) by inserting it between the legs using the 1" carriage bolts (key #18) and 5/16" nuts (key #19). While attaching the leg brace (key #5) place the stabilizer (key #13) to the leg (key #4) and fasten with a 1" carriage bolt (key #18).

## ASSEMBLING THE AXLE ASSEMBLY

Place the Axle Bracket (key #12) on the handle. Attach the Vertical Tray Brace (key #8) to the Tray using the two 1" carriage bolts (key #18). Next, use the 2-1/2" carriage bolt (key #16) and put it through the Vertical Tray Brace, Axle Bracket, and Handle. Finger tighten one of the 5/16" nuts on the carriage bolt, and complete the above process on the other side of the wheelbarrow. After completing this on the other side, put the 24" Axle (key #11) through the Axle Bracket on both sides. Use the other two 2-1/2" carriage bolts (key #16) and 5/16" nuts (key #19) and finish attaching the axle brackets.

## ASSEMBLING THE TRAY, HANDLES & LEGS

Place the steel or poly tray (key #1) upside down. Place one wedge (key #6) on the tray with the large end of the wedge facing towards the front of the tray. Place one of the handles (key #2) on top of the wedge (Note which way the handle is coming off of the tray, so as to not attach the handles the wrong way). Matching up the hole at the back end of the tray, wedge, and handle place the rear support (key #3) on top of those items. Finally, place one of the legs (key #4) on top of the rear support with the holes on the legs facing the back of the tray. Matching up the holes, place 3-3/4" carriage bolt (key #15) in through the tray and then finger tighten one of the 5/16" nuts (key #19) onto the carriage bolt. Place the front support (key #7) underneath the leg and put a 5" carriage bolt (key #14) through the tray, wedge, handle, front support, and leg. Finger tighten a 5/16" nut onto the carriage bolt, and do the same thing for the other side.

To attach the tires, place each Wheel (key #9) on the axle. Place the washers (key #21) onto each side of the axle and put in the Cotter Pins (key #20), through the holes in the axle.

Attach the nose piece (key #10) by using the 2-1/4" Carriage Bolts (key #17) and 5/16" nuts (key #19). Finally, finish your assembly by tightening all of the nuts using a 1/2" wrench and 1/2" socket.

## MAINTENANCE

Periodically, grease the fitting on the tires. Keep clean from debris after use.