

# BESSEY® Forged Vise Instructions

## Operating Instructions

*Please read and save these instructions. Read through these instructions carefully before using the product. Protect yourself and others by observing all safety information, warnings, and cautions. Failure to comply with instructions could result in personal injury and/or damage to product or property. Please retain instructions for future reference.*

## Forged Steel Combination Pipe & Bench Vise

Designed for holding materials for repair, assembly, dismantling, welding and other holding applications.

Swivel base & locking T Nuts are included in the box and should be assembled as illustrated in the image.

Securely attach the assembled vise to a work surface using industrial fasteners with lock washers (not included). Periodically check that mounting fasteners are tight.



## Specifications and Dimensions

Model	Jaw Width	Jaw Max. Opening	Pipe Capacity	Weight
BV-DF8SB	8"	10 1/2"	1/4" – 6"	67.3 Lbs.
BV-DF6SB	6"	7"	1/4" – 5"	50.0 Lbs.
BV-DF5SB	5"	6 1/2"	1/4" – 3"	25.2 Lbs.
BV-DF4SB	4"	4 1/4"	1/4" – 3"	14.0 Lbs.

## General Safety Information

### ▲WARNING

Misuse of bench vises can cause serious injury to hands, eyes and other body parts. Never use a hammer, extension pipe or cheater bar on the handle of the vise or the locking T-nuts on the swivel base. Never weld the vise or base to a work surface. Never unscrew the moveable jaw beyond the maximum specified opening of the vise. Always use the correct size vise to fit the work being done. Always wear eye protection or face shield when using power tools or striking tools on a work piece held in a vise.

## Assembly

Remove swivel base, T-Locking nuts, and steel locking bar from box and attach to stationary jaw of the vise.

## Installation

Mount vise to work surface using appropriately sized industrial bolts, lock washers & nuts, tighten securely. Stationary jaw face should be positioned slightly beyond the edge of the work surface to allow holding long work pieces.

## Operating Instructions

1. Only the original clamping handle should be used for clamping work pieces in the vise. Using pipes or cheater bars may damage the vise and render the warranty void.

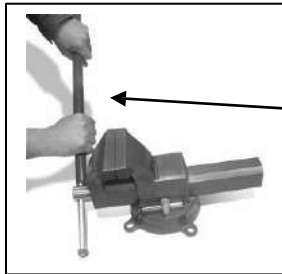

Never Use Cheater Bar in place of the original clamping handle

2. Over time, the machined V-guides may wear. By using a hex key you can tighten the adjustment nuts to restore smooth parallel operation of the vise jaw movement.

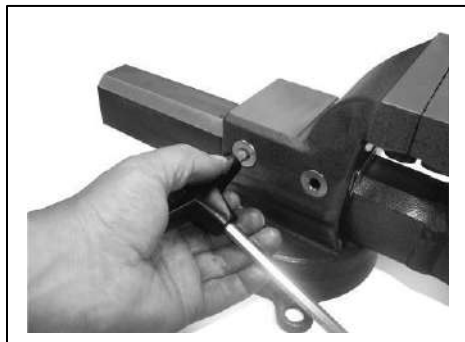

3. Periodically lubricate the V-guides and clamping screw in order to maintain smooth operation and long life.

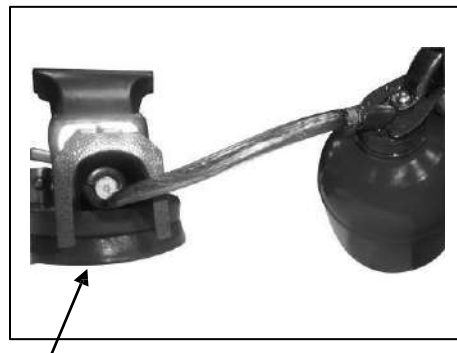
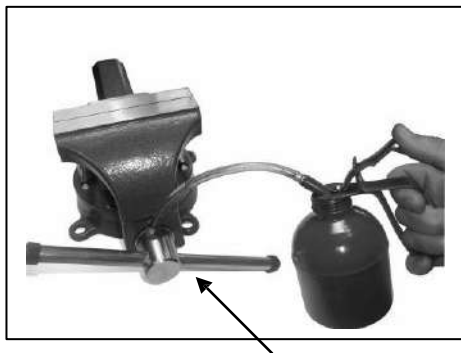

Lubricate Clamping Screws