



## **ATD-7811 500 lbs. Capacity Work Stand Manual**



### FEATURES:

- 500 lbs. capacity
- Lightweight construction
- Steel tubing with 1/2" foam padding wrapped around and down the top of the frame
- Adjustable working height - 22.8" - 37"
- Leg tube length: 30.7"
- Bent tube length: 40.35"
- Steel tubing diameter: 1.10"
- Steel tubing thickness: .05"
- Shipping Weight: 15.2 lbs.

# Assembly Instructions For Work Stand

- 1) Slide the foam padding (#8) onto the bent tube (#9).  
Slip a tube leg (#6) into the bent tube (#9). Line up the holes in the bent tube and the leg tubes and insert the eyebolt with chain attached (#4) to secure them.
  
- 2) Assemble the second bent tube the same way as above, but use the hook bolt (#2) to secure the leg tube and the bent tube.
  
- 3) Complete the assembly by placing one of the assembled tubes on top of the other. Line up the holes and secure with the M8x80 pivot bolts (#3). Be sure to place a flat washer (#5) outside, between and inside the tubing assemblies.  
Use M8 nuts (#1) to tighten the pivot bolts (#3). Then push on tube ends (#7).



# ATD-7811

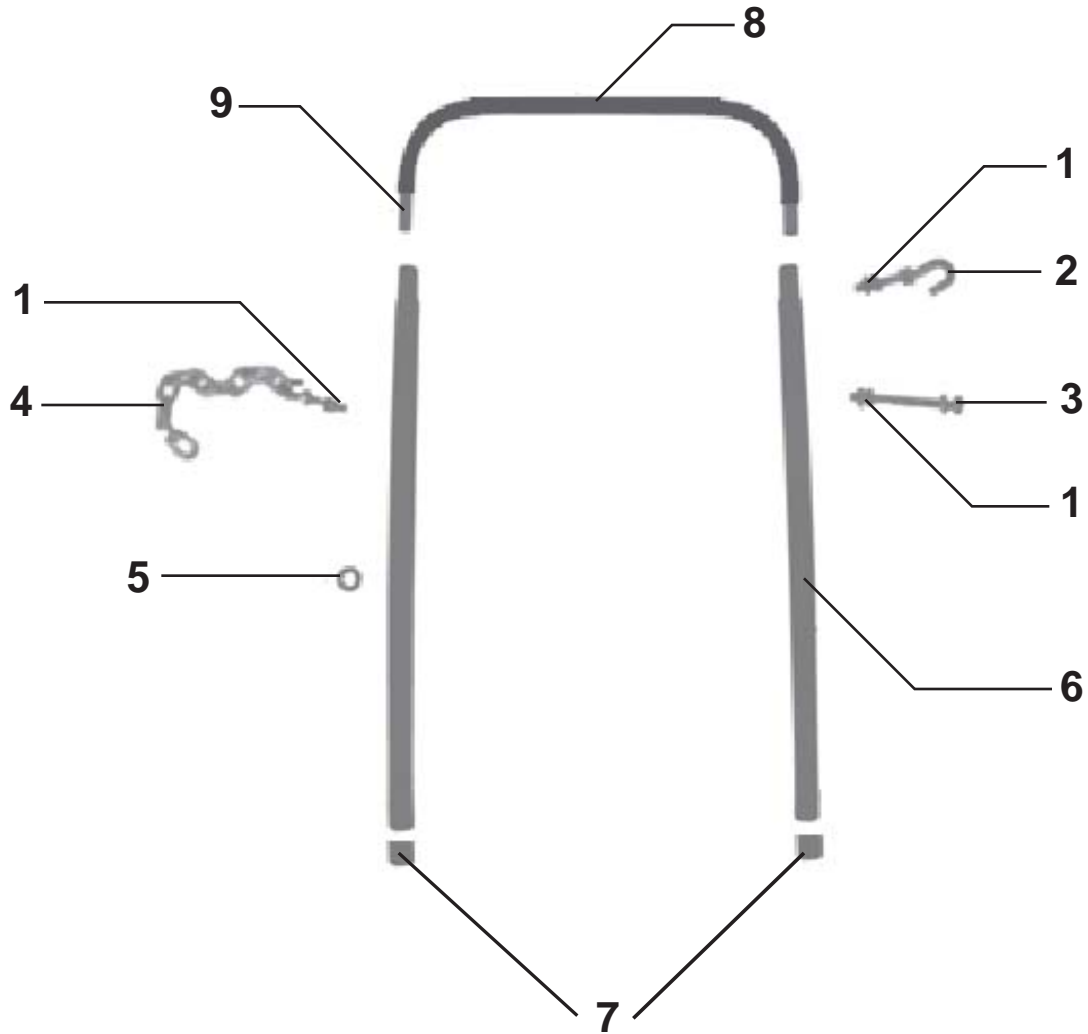

ITEM#	ORDERING PART#	PART DESCRIPTION
1, 2, 3, 4, 5	PRT7811-1	HARDWARE KIT
6	PRT7811-6	LEG TUBE
7	PRT7811-7	TUBE END
8	PRT7811-8	FOAM PADDING
9	PRT7811-9	BENT TUBE

ATD-7811