

POWERSHOT®

HEAVY DUTY
Forward Action® **Staple & Nail Gun**



Instruction Manual

POWERSHOT®

POWERSHOT® STAPLE AND NAIL SELECTION GUIDE

For best results the POWERSHOT® Heavy Duty Staple and Nail Gun has been designed to use POWERSHOT® Brand Heavy Duty .050" narrow crown width staples, 9/16" & 5/8" brad nails. It will also accept other standard .050" narrow crown width heavy duty staples, including Arrow® T-50®* brand staples.

As a general guideline, when stapling or nailing into wood, allow for leg penetration of approximately 3/16"–1/4".

		COMMON APPLICATIONS FOR STAPLE AND NAIL LENGTH:
	1/4"	Display Signs; Window Shades; Window Screens; Draperies; Shelf Paper; Light Upholstery; Plastic Film; Decorations.
	5/16"	Insulation; Upholstery; Weatherstripping; Wall Decorations; Crafts; Covering Cornices, Leatherettes.
	3/8"	Insulation; Carpeting; Wire Mesh; Plastic or Canvas Coverings; Roofing Paper; Felt Stripping; Low Voltage Wiring (Telephone, Telecommunications.)
	1/2"	Insulation; Carpet Underlayment; Low Voltage Wiring (Telephone/Telecommunications); Porch Screens; Picture Frames; Wire Mesh; Netting; Roofing Paper.
	9/16"	Heavy Insulation; Insulation Board; Fencing; Trellises; Roofing; Carpeting; Metal Lath; Cornerite; Heavy Wire Mesh.
	9/16" Ceiling Tile	Ceiling Tile; Carpeting, Picture Frames, Screening Cover Strips, Small Moldings.
9/16" 5/8"		Trim Molding, Paneling, Picture Frames, Model Work, Any Finish Nailing Application

1a. Loading Staples

1. Remove pusher rod "A" (FIG. #1).
2. Insert strip of staples into magazine "B" (FIG #2).
3. Replace pusher rod.

1b. Loading Nails

1. Remove pusher rod "A" (FIG. #1).
2. Insert strip of nails into left channel of magazine (side with  graphics) (FIG #3a & 3b).
3. Replace pusher rod.

IMPORTANT: Gun must NOT be loaded with staples and nails at the same time.

Wire Attachment (fig. 4)

If your POWERSHOT includes a wire attachment follow these directions:

- Installing** (fig. 4A) Spread sides of wire attachment and push.
- Application** (fig. 4B) Place PowerShot over wire: line up center attachment over wire. Avoid over stapling.
- Removal** (fig. 4C) Spread sides of wire attachment and pull.

2. Using Your POWERSHOT® Staple and Nail Gun

The POWERSHOT staple gun has a unique forward action® design to give maximum ease of use and control. To use, grasp the handle of the gun, making sure that the staple exit is pointing away from you (fig. 5). Place it firmly on the workpiece and push the handle steadily down towards the staple exit to activate. Maximum leverage is gained by pushing down at the front of the handle using the force of your arm rather than just squeezing with the hand. In vertical applications the front finger hole provides added support.

POWERSHOT has many other useful features - each designed to help make stapling easier and more comfortable (fig. 8).

- A. Staples Remaining Window- This feature is located on the left side of the gun. Reload when end of strip is seen through window "A" (FIG #8).
- B. Staple Exit Indicator- Use the Staple Exit Indicator when you need greater precision in placing your staples. The notch in the front of the gun shows you where the staple legs will be fired. Staples will exit the gun directly behind the noseplate "B" (FIG #8).
- C. Soft Grip Handle
- D. Finger Hole
- E. Track Release



3. To Clean Magazine

In the unlikely event of a staple jam, make sure that the bottom of the gun is pointing away from yourself and others before carrying out the following instructions.

1. Remove pusher rod "A" (FIG. #1).
2. Remove screw & nut "B" from hole "C" (FIG. #6).
3. Remove entire magazine from housing.

NOTE: THE TRACK MOVEMENT MAY BE STIFFER THAN USUAL IF THERE IS A STAPLE JAM.

Storing Your POWERSHOT®

When you have finished using your POWERSHOT staple gun, unload remaining staples before storage. Always store in a dry place out of the reach of children.

FIG. 7

Part #
26
57M41
57M43

Postage & Handling Extra

IMPORTANT

To assure product safety and reliability, repairs and maintenance and other adjustments should be performed by qualified PowerShot staff. This tool contains no customer serviceable components.

WARNING

We do not recommend unscrewing the housing to disassemble the tool because reassembly requires specific tools.

IMPORTANT SAFETY INSTRUCTIONS

▲ WARNING: TO MINIMIZE THE RISK OF EYE INJURY, ALWAYS USE EYE PROTECTION. When using mechanical tools basic safety precautions should always be followed to reduce the risk of personal injury, including the following:

READ ALL INSTRUCTIONS

- 1. BE AWARE OF THE STAPLE EXIT POINT.** The unique forward action design of the PowerShot puts the “high” part of the handle in the front. Be sure this product is in the proper position in your hand before using. Do not position “non gripping” hand under contact surface of stapler.
- 2. POINT THE GUN AWAY FROM YOURSELF AND OTHERS** at all times and especially when opening the track to clear a jammed staple. As the track is opened, the jammed staple may be shot out unexpectedly.
- 3. PLACE STAPLE EXIT POINT FIRMLY AGAINST WORK SURFACE BEFORE FIRING.** Staples fired “into the air” can cause serious injury.
- 4. ALWAYS USE THE PROPER STAPLE SIZE.** This product accepts .050” wire gauge heavy duty staples only. Do not try to use light duty (.030”), desk, or wire staples in this product.
- 5. KEEP WORK AREA CLEAN.** Cluttered areas and benches invite injuries.
- 6. CONSIDER WORK AREA ENVIRONMENT.** Don’t expose tool to rain. Keep work area well lit.
- 7. KEEP CHILDREN AWAY.** All visitors should be kept away from work area. Do not let visitors contact tool.
- 8. STORE IDLE TOOLS.** When not in use, tools should be stored in dry, high or locked-up place — out of reach of children.
- 9. DON’T OVERREACH.** Keep proper footing and balance at all times.
- 10. STAY ALERT.** Watch what you are doing. Use common sense. Do not operate tool when you are tired.
- 11. BE CAUTIOUS NOT TO STAPLE INTO ELECTRICAL WIRES** especially those which may be hidden from view.

SAVE THESE INSTRUCTIONS FOR FUTURE USE

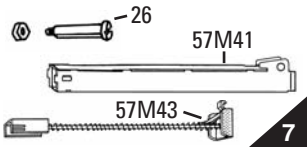
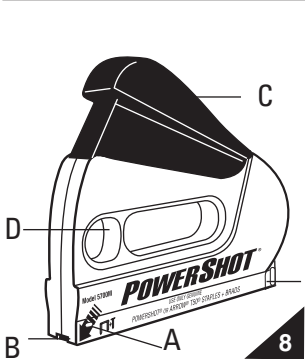
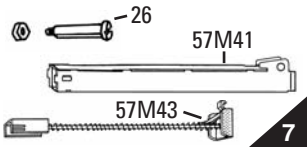
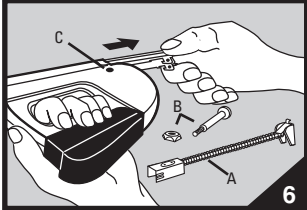
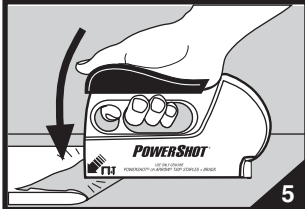
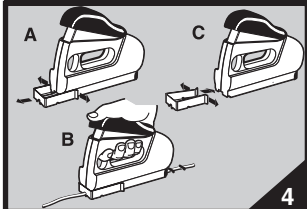
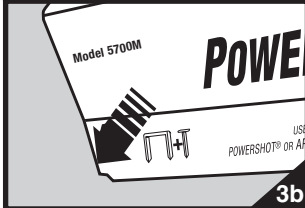
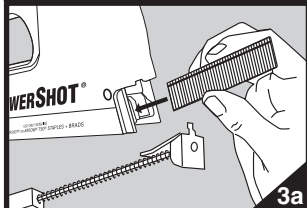
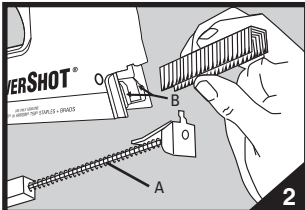
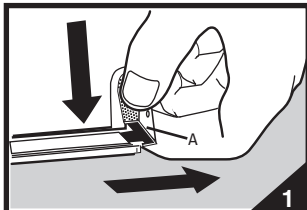

Find more Arrow Fastener products on our website.

Discover other hand tools on our website.

© 2010 Arrow Fastener Company. All rights reserved. Arrow, POWERSHOT, and Model 5700M are trademarks of Arrow Fastener Company.