

# BUILT BY PROFESSIONALS FOR PROFESSIONALS

# 2019 CATALOG

When you've got real work to do...  
**GRAB HOLD OF AN AIRCAT!**



**AIRCAT**  
PNEUMATIC TOOLS  
More power, half the noise.

**VIBROTHERM**  
by AIRCAT DRIVE™

**NITROCAT**  
XTREME  
POWER  
CAUTION



The AIRCAT line represents the most significant advances in the performance of pneumatic power tools in nearly 30 years. Founded in 1998, our tool line has a substantially reduced level of noise while retaining more power and torque. AIRCAT also incorporates a patented ergonomically engineered handle design to relieve stress and fatigue on the operator's hands, wrists and arms. AIRCAT has the patented tuned exhaust muffler technology in most tools, which allows discharged air to pass without developing back pressure, thus retaining more power, while significantly reducing noise. More power Half the noise.

AIRCAT is committed to product innovation, high quality levels, high service levels and continued development and expansion of the AIRCAT™, NITROCAT™ and VIBROTHERM DRIVE™ brands.

In late 2018 we introduced a new assortment of VIBROTHERM DRIVE™ patented impact wrenches up to 3/4" drive that provide longer working life, lower vibration and shorter length-coupled with "state of the art" cosmetic styling.

In addition the new low weight AIRCAT 1" impact wrenches provide an unmatched 2,100 ft-lb torque with weights between 13 to 19.9 lbs.

Our ratchet line up has been expanded to offer extended reach ratchets and sealed flat head ratchets; making the AIRCAT ratchet line up the broadest in the industry.

The new sander line delivers low noise and vibration levels, low air consumption and unmatched operating comfort at prices that reflect the usual AIRCAT great value proposition.





# TABLE OF CONTENTS

MODEL	DESCRIPTION	PAGE NO
<b>3/8" IMPACT WRENCHES</b>		
1320	3/8" BUTTERFLY IMPACT WRENCH	6
1058-VXL	3/8" VIBROTHERM DRIVETM. COMPACT IMPACT WRENCH	6
1077-TH	3/8" STUBBY IMPACT WRENCH	7
1076-XL	3/8" COMPOSITE IMPACT WRENCH	7
1300-TH-A	3/8" IMPACT WRENCH	8
1355-XL	3/8" "XTREME POWER" IMPACT WRENCH	8
1350-XL	3/8" IMPACT WRENCH HIGH-LOW TORQUE	9
<b>1/2" IMPACT WRENCHES</b>		
1056-XL	1/2" COMPOSITE IMPACT WRENCH	7
1057-TH	1/2" STUBBY IMPACT WRENCH	7
1375-XL	1/2" "XTREME POWER" IMPACT WRENCH	9
1178-VXL	1/2" VIBROTHERM DRIVETM IMPACT WRENCH	10
1150	1/2" IMPACT WRENCH	10
1000-TH	1/2" IMPACT WRENCH	11
1000-TH-2	1/2" X 2" IMPACT WRENCH	11
1285-XL	1/2" IMPACT WRENCH	11
1200-K	1/2" KEVLAR™ TWIN CLUTCH IMPACT WRENCH	12
1250-K	1/2" KEVLAR™ TWIN CLUTCH IMPACT WRENCH	12
1450	1/2" IMPACT WRENCH	13
1450-2	1/2" X 2" IMPACT WRENCH	13
1431	1/2" IMPACT WRENCH	14
1431-2	1/2" X 2" IMPACT WRENCH	14
1460-XL	1/2" IMPACT WRENCH	14
1460-XL-2	1/2" X 2" IMPACT WRENCH	14
<b>3/4" IMPACT WRENCHES</b>		
1770-XL	3/4" "SUPER DUTY" IMPACT WRENCH	15
1770-XLK	3/4" "SUPER DUTY" IMPACT WRENCH KIT	15
1778-VXL	3/4" VIBROTHERM DRIVETM IMPACT WRENCH	15
1600-TH-A	3/4" "SUPER DUTY" IMPACT WRENCH	16
1777	3/4" "SUPER DUTY" IMPACT WRENCH	16
1777-K	3/4" "SUPER DUTY" IMPACT WRENCH KIT	16
1778-VXL	3/4" VIBROTHERM DRIVETM IMPACT WRENCH	15
1680-A	3/4" "XTREME DUTY" TWIN HAMMER IMPACT WRENCH	17
1680-A-6	3/4" X 6" "XTREME DUTY" TWIN HAMMER IMPACT WRENCH	17
1750-K	3/4" KEVLAR™ "XTREME POWER" COMPOSITE IMPACT WRE	17
<b>1" IMPACT WRENCHES</b>		
1600-TH-A1	1" SUPER DUTY PISTOL IMPACT WRENCH	18
1870-P	1" SUPER DUTY PISTOL IMPACT WRENCH	18
1880-P-A	1" PISTOL IMPACT WRENCH	19
1890-P	1" PISTOL IMPACT WRENCH	19
1991	1" X 8" EXTENDED "SUPER DUTY" IMPACT WRENCH	20
1991-1	1" "SUPER DUTY" IMPACT WRENCH	20
1893	1" X 8" EXTENDED IMPACT WRENCH	20
1893-1	1" IMPACT WRENCH	20
1900-A	1" X 8" EXTENDED "SUPER DUTY" IMPACT WRENCH	21
1900-A-1	1" "SUPER DUTY" IMPACT WRENCH	21
1994	1" X 8" EXTENDED "SUPER DUTY" IMPACT WRENCH	21
1992	1" X 8" EXTENDED "SUPER DUTY" IMPACT WRENCH	22
1992-1	1" "SUPER DUTY" IMPACT WRENCH	22
<b>RATCHETS</b>		
807	3/8" "MINI" COMPOSITE PALM RATCHET	25
800	1/4" "MINI" COMPOSITE SINGLE PAWL RATCHET	25
801	3/8" "MINI" COMPOSITE SINGLE PAWL RATCHET	25
802	3/8" COMPOSITE TWIN PAWL RATCHET	25
802-5	1/2" COMPOSITE TWIN PAWL RATCHET	25
809-SH	3/8" SEALED FLAT HEAD RATCHET	26
809-SH-5	1/2" SEALED FLAT HEAD RATCHET	26
804	1/4" MINI RATCHET	26
806	3/8" HIGH PERFORMANCE RATCHET	26
803-RW	3/8" REACTION-LESS RATCHET	27
805-HT	3/8" HIGH TORQUE RATCHET	27
805-HT-5	1/2" HIGH TORQUE RATCHET	27
808-15	3/8" LONG REACH RATCHET	27
808-15-25	3/8" LONG REACH RATCHET	27
808-22	3/8" LONG REACH RATCHET	27

MODEL	DESCRIPTION	PAGE NO
<b>GRINDERS &amp; CUT-OFF TOOLS</b>		
6200	COMPOSITE STRAIGHT "MINI" DIE GRINDER	29
6201	COMPOSITE STRAIGHT DIE GRINDER	29
6260	COMPOSITE 1.0 HP STRAIGHT DIE GRINDER	29
6285	.75 HP 1/4" COLLET STRAIGHT DIE GRINDER	30
6290	.75 HP 1/4" COLLET REV. STRAIGHT DIE GRINDER	30
6210	COMPOSITE STRAIGHT DIE GRINDER EXT. SHANK	31
6270	1.0 HP EXT. STRAIGHT DIE GRINDER	31
6255	COMPOSITE ANGLE DIE GRINDER	32
6265	1.0 HP ANGLE DIE GRINDER	32
6280	.75 HP 1/4" COLLET ANGLE DIE GRINDER	32
6275-A	4" COMPOSITE INSIDE CUT-OFF TOOL	33
6340	4-1/2" ANGLE GRINDER	33
6380	2.3 HP 5" HEAVY DUTY ANGLE GRINDER "COMING SOON"	33
6505	3" COMPOSITE CUT-OFF TOOL	34
6560	1 HP 4" COMPOSITE CUT-OFF TOOL	34
6520	3" COMPOSITE REVERSIBLE CUT-OFF TOOL	35
6525	IN-LINE CUT-OFF TOOL	35
<b>DRILLS</b>		
4338	3/8" COMPOSITE DRILL JACOBS® CHUCK	37
4450	1/2" COMPOSITE DRILL - SIDE ASSIST HANDLE	37
4439	3/8" DRILL	38
4451	1/2" DRILL - VIBRATION DAMPED SIDE HANDLE	38
4337	3/8" ANGLE DRILL	38
<b>HAMMERS</b>		
5100-A-T	COMPOSITE AIR HAMMER	39
5200-A-T	COMPOSITE LONG STROKE AIR HAMMER	39
5300-A-T	SUPER DUTY 0.498" SHANK AIR HAMMER	39
<b>SANDERS &amp; POLISHER</b>		
6700-1-332	1" NON VAC NIB PALM SANDER	40
6700-5-336	5" NON VAC ORBITAL PALM SANDER	40
6700-6-336	6" NON VAC ORITAL PALM SANDER	40
6700-6-332	6" NON VAC ORBITAL PALM SANDER	40
6700-5-336CV	5" NON VAC ORBITAL PALM SANDER	40
6700-6-336CV	6" CENTRAL VAC ORBITAL PALM SANDER	40
6700-6-332CV	6" CENTRAL VAC ORBITAL PALM SANDER	40
6700-6-336SV	6" SELF VAC ORBITAL PALM SANDER	40
6700-6-332SV	6" SELF VAC ORBITAL PALM SANDER	40
6700-3-336	3" NON VAC ORBITAL PALM SANDER/POLISHER	40
6700-3-336CV	3" CENTRAL VAC ORBITAL PALM SANDER/POLISHER	40
6700-8GCV	8" CENTRAL VAC GEARED PLANETARY MOTION SANDER	40
6700-8G	8" NON VAC GEARED PLANETARY MOTION SANDER	40
6700-6GCV	6" CENTRAL VAC GEARED PLANETARY MOTION SANDER	40
6700-6G	6" NON VAC GEARED PLANETARY MOTION SANDER	40
6310	6" DUAL ACTION SANDER	42
6525-ABS	1/4" X 18" BELT SANDER	42
6700-DCE-6	6" DC ELECTRIC PALM SANDER	43
6700-DCE-6V	6" DC ELECTRIC PALM SANDER (VAC)	43
6700-DCE-5	6" DC ELECTRIC PALM SANDER	43
6700-DCE-5V	5" DC ELECTRIC PALM SANDER (VAC)	43
6700-DCE-3	3" DC ELECTRIC PALM SANDER	43
6700-DCE-3V	3" DC ELECTRIC PALM SANDER (VAC)	43
6320	SPOT SANDER	44
6370	LOW WEIGHT COMPOSITE VERTICAL POLISHER	44
<b>SPECIALTY TOOLS &amp; ACCESSORIES</b>		
6330	HIGH PERFORMANCE NIBBLER	45
6350	LOW VIBRATION SAW	45
6400	COMPOSITE HIGH SPEED TIRE BUFFER/DRILL	46
6402	COMPOSITE TIRE BUFFER	46
6403	COMPOSITE TIRE BUFFER	46
100-C	MECHANIC'S CREEPER	47
800-C	45" ADJUSTABLE MECHANIC'S CREEPER WITH LED LIGHT	47
	IMPACT BOOTS & ACCESSORIES	48
<b>TECHNICAL INFORMATION</b>		
	USE OF ACCESSORIES WITH AIR TOOLS	49



# IMPACT WRENCHES

## MORE POWER - LESS NOISE



AIRCAT offers the customer the most loosening torque in our impact wrench, while only creating 86 decibels of sound, compared to the industry average of

112 decibels. Most of the Pneumatic Tool industry measures tool performance on power and durability, which AIRCAT ranks in the top 2 in both categories amongst users.

AIRCAT offers a selection of 44 impact wrenches from 3/8" to 1" drive ranging from 80 ft-lb. to 2300 ft-lb. of torque.



# AIRCAT Impact Wrench Mechanisms and Performance Characteristics

**VIBROTHERM DRIVE™** is a new AIRCAT patented mechanism that provides faster blow frequency, high torque, low vibration and a longer working life than other conventional impact wrench mechanisms. In addition it reduces overall tool length. The cage is driven by the motor that drives the two hammers to generate two blows for each revolution, the elimination of hammer pins and the addition of the front hammer cage plate that retains the grease within the mechanism, reduces wear within the mechanism increasing working life



The **TWIN HAMMER** is the most widely used impact wrench mechanism that provides fast blow frequency and high torque. The mechanism is most widely used for AIRCAT 3/8", 1/2" and 3/4" impact wrenches. The cage is driven by the motor that drives the twin hammers that rock on hammer pins that pass through the hammer cage to generate two blows for each revolution.

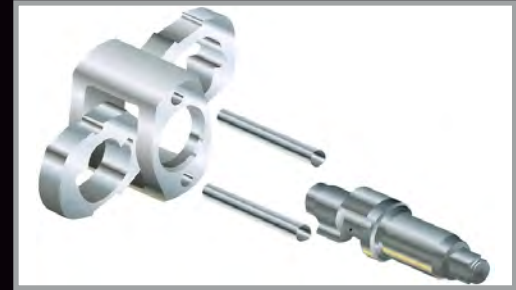

The **PIN-LESS HAMMER** is used in AIRCAT 1" impact wrenches. The PIN-LESS mechanism has a more positive drive and uses less moving parts, this design increases reliability for heavy duty applications. The large single hammer provides hard hitting power to achieve rapid high torque. The cage is driven by the motor that drives the large single hammer to generate one hard hitting blow for each revolution.



The **TWIN CLUTCH** is featured in NITROCAT 1/2" impact wrenches and is specifically designed to provide smooth and powerful operation, and to create high initial torque. This mechanism outperforms other mechanism in high torque engine service and repair work, and particularly for removal of stubborn crank shaft bolts. When the hammer rotates past the anvil a ball pushes the pins forward engaging them with the anvil, the pins are then pushed backwards by the spring, this mechanism has very fast acceleration that creates the high initial torque

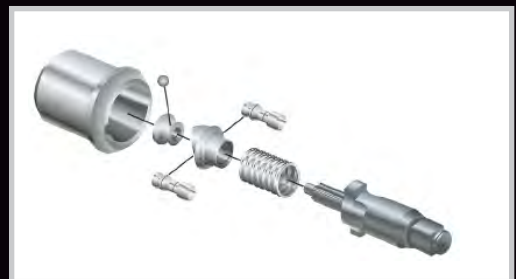

The **JUMBO HAMMER** is used in AIRCAT and NITROCAT compact impact wrenches. The JUMBO hammer enables AIRCAT to provide high torque and high reliability in its smallest impact wrenches. The cage is driven by the motor that drives the single JUMBO hammer that rocks on hammer pins that pass through the hammer cage to generate one hard hitting blow for each revolution.



The **TWO JAW CLUTCH** is featured exclusively in the AIRCAT 1890-P 1" Pistol Grip Impact Wrench. The TWO JAW clutch provides unparalleled torque output and longer life than any other mechanism. The cage is driven by the motor the jaws on the cage directly drives the anvil, this action eliminates the customary hammering increasing torque and reducing wear, the internal spring then disengages the jaws to turn to the next drive cycle. The mechanism is ideal for heavy duty off road vehicle work and steel erection



# 1320 3/8" BUTTERFLY IMPACT WRENCH



- Provides 80 ft-lb of maximum torque
- Weighing only 1.1 lb. and with an overall length of only 5.4", it fits comfortably in the operator's palm
- Ideal for work around radiators and in other very space restricted areas
- Features a three position built-in power management switch for control on the job
- Built-in swivel air inlet increases maneuverability and access to restricted work areas
- Double hammer mechanism reduces vibration while increasing reliability

# 1059-VXL / 1058-VXL 3/8" & 1/2" COMPACT IMPACT WRENCH



**VIBROTHERM**  
by **AIRCAT DRIVE™**



- Provides 550 ft-lb maximum torque
- VIBROTHERM DRIVE™ impact wrenches incorporate the completely new AIRCAT design impact wrench mechanism (patent pending)
- The new mechanism reduces vibration levels by between 30%-40% and increased the life of the mechanism by 50%
- The latest patented AIRCAT muffler system produces the characteristic AIRCAT unmatched low noise levels
- The patented grip design provide the customary AIRCAT operator comfort
- Investment into tooling and materials and a triple injection molding processes enables AIRCAT to produce cosmetic designs that are unmatched in the industry
- "Three year warranty"

## SPECIFICATIONS

Model No.	Free Speed (RPM)	Bolt Capacity (in.)	Square Drive (in.)	Impacts Per Minute	Max Torque (ft-lb)	Weight (lbs.)	Length (in)	Air Cons. (CFM)	Rec. Hose Size (in.)	Air Inlet (in.) NPT/BSP
1320	10,000	1/2	3/8	1800	80	1.1	5.4	8	3/8	1/4
1059-VXL	9,000	9/16	3/8	1700	550	2.8	4.4	8	3/8	1/4
1058-VXL	9,000	9/16	1/2	1700	550	2.8	4.4	8	3/8	1/4



# 1077-TH / 1057-TH 3/8" & 1/2" STUBBY IMPACT WRENCH



- Provides 500 ft-lb of maximum torque
- Only 3.85" overall length
- Low weight aluminum alloy housing
- Reliable Jumbo hammer mechanism delivers maximum power, while increasing reliability
- Patented "Silencing Technology" reduces the noise level to 89 dBA
- Trigger mounted combined reverse and power management switch provides ultimate control and one-hand operation

# 1076-XL / 1056-XL 3/8" & 1/2" COMPOSITE COMPACT IMPACT



- Provides 550 ft-lb maximum torque
- Low weight composite housing reduces weight to 2.5 Lbs.
- Reliable jumbo hammer mechanism delivers maximum power, while increasing reliability
- Patented "Silencing Technology" reduces the noise level to 85 dba
- Patented grip has been ergonomically designed to perfectly fit the hand, providing unmatched comfort for the user
- New patented trigger mounted combined reverse and power management switch provides ultimate control and one-hand operation

Model No.	Free Speed (RPM)	Bolt Capacity (in.)	Square Drive (in.)	Impacts Per Minute	Max. Torque (ft-lb) @90 psi	Weight (lbs.)	Length (in)	Air Cons. (CFM)	Rec. Hose Size (in.)	Air Inlet (in.) NPT/BSP
1077-TH	9,000	1/2	3/8	1600	500	2.80	3.85	6.0	3/8	1/4
1057-TH	9,000	1/2	1/2	1600	500	2.80	3.85	6.0	3/8	1/4
1076-XL	9,000	9/16	3/8	1650	550	2.5	4.25	8	3/8	1/4
1056-XL	9,000	9/16	1/2	1650	550	2.5	4.25	8	3/8	1/4

# 1300-TH-A 3/8" IMPACT WRENCH



- Provides 500 ft-lb loosening torque
- "Super Clutch" Twin Hammer Mechanism
- Durable composite housing
- Patented ergonomically designed housing
- Patented quiet tuned exhaust (86 Decibels)
- Patented easy operation flip lever forward and reverse

# 1355-XL 3/8" "XTREME POWER" IMPACT WRENCH



- Provides industry leading 700 ft-lb of loosening torque
- The NitroCat 1355-XL is a no non-sense, hard hitting 3/8" impact wrench that incorporates a twin hammer mechanism
- Provides all the torque you need and tremendous speed to get the job done
- Patented quiet tuned exhaust (86 dBA)
- Patented easy operation flip lever forward and reverse
- Great for brake calipers, transmission work
- Durable Kevlar™ reinforced "Body Armour" housing

## SPECIFICATIONS

Model No.	Free Speed (RPM)	Bolt Capacity (in.)	Square Drive (in.)	Impacts Per Minute	Max. Torque (ft-lb) @90 psi	Weight (lbs.)	Length (in)	Air Cons. (CFM)	Rec. Hose Size (in.)	Air Inlet (in.) NPT/BSP
1300-TH-A	10,000	1/2	3/8	1750	450	2.63	6.75	6	3/8	1/4
1355-XL	10,000	1/2	3/8	1350	500	2.75	6.0	6	3/8	1/4



# 1350-XL HIGH-LOW TORQUE 3/8" IMPACT WRENCH



- Provides 500 ft-lb maximum torque and 100 ft-lb low torque
- Refined design twin hammer increases blow frequency and efficiency and reduces wear
- Unique High-Low Torque switch for instant change of power in forward and reverse provides one hand operation
- Molded in buffers protects tool from side impact
- Ergonomically designed grip and trigger provide ultimate operating comfort

# 1375-XL 1/2" "XTREME POWER" IMPACT WRENCH



- Provides industry leading 700 ft-lb of loosening torque
- The NitroCat 1375-XL is a no non-sense, hard hitting 1/2" impact wrench that incorporates a twin hammer mechanism
- Provides all the torque you need and a tremendous speed to get the job done
- Patented quiet tuned exhaust (86 dBA)
- Patented easy operation flip lever forward and reverse
- Great for brake calipers, transmission work
- Durable Kevlar™ reinforced "Body Armour" housing

Model No.	Free Speed (RPM)	Bolt Capacity (in.)	Square Drive (in.)	Impacts Per Minute	Max. Torque (ft-lb)	High-Low Torque Setting (ft-lb)	Weight (lbs.)	Length (in)	Air Cons. (CFM)	Rec. Hose Size (in.)	Air Inlet (in.) NPT/BSP
1350-XL	10,000	1/2	3/8	1700	500	500 and 100	3.15	6.3	6	3/8	1/4
1375-XL	10,000	1/2	1/2	1350	500	N/A	2.75	6.0	6	3/8	1/4

# 1178-VXL 1/2" IMPACT WRENCH



## VIBROTHERM by AIRCAT DRIVE™



- Provides 1,300 ft-lb loosening torque
- VIBROTHERM DRIVE™ impact wrenches incorporate the completely new AIRCAT design impact wrench mechanism (patent pending)
- The new mechanism reduces vibration levels by between 30%-40% and increased the life of the mechanism by 50%
- The latest patented AIRCAT muffler system produces the characteristic AIRCAT unmatched low noise levels
- The patented grip design provide the customary AIRCAT operator comfort
- Investment into tooling and materials and a triple injection molding processes enables AIRCAT to produce cosmetic designs that are unmatched in the industry
- "Three year warranty"

# 1150 1/2" IMPACT WRENCH



- Provides 1,295 (ft-lb) loosening torque
- Most powerful 1/2" impact in it's class!
- Hard hitting twin hammer mechanism
- Durable composite housing
- Patented ergonomically designed handle
- Patented quiet tuned exhaust (86 Decibels)
- Patented easy operation flip lever forward and reverse



## SPECIFICATIONS

Model No.	Free Speed (RPM)	Bolt Capacity (in.)	Square Drive (in.)	Impacts Per Minute	Max. Torque (ft-lb)	Weight (lbs.)	Length (in)	Air Cons. (CFM)	Rec. Hose Size (in.)	Air Inlet (in.) NPT/BSP
1178-VXL	7,500	3/4	1/2	1400	950	4.5	6.4	8	3/8	1/4
1150	9,000	9/16	1/2	1400	900	4.5	7.5	8	3/8	1/4



# 1000-TH / 1000-TH-2 1/2" IMPACT WRENCH



- Provides 1,000 ft-lb loosening torque
- "Super Clutch" twin hammer mechanism
- Durable composite housing
- Patented ergonomically designed handle
- Patented quiet tuned exhaust (86 Decibels)
- Patented easy operation flip lever forward and reverse



**1000-TH-2**  
**2" Ext. Anvil**

# 1285-XL 1/2" IMPACT WRENCH



- 900 ft-lb maximum torque
- 1,100 ft-lb loosening torque
- Hard hitting twin hammer mechanism delivers maximum power
- Grip has been ergonomically designed to perfectly fit the hand-providing unmatched comfort for the user
- Built-in side impact buffers project the tool and increase reliability
- Push button forward/reverse buttons for fast and convenient change of direction
- The power management switch provides ultimate control



Model No.	Free Speed (RPM)	Bolt Capacity (in.)	Square Drive (in.)	Impacts Per Minute	Max. Torque (ft-lb)	Weight (lbs.)	Length (in)	Air Cons. (CFM)	Rec. Hose Size (in.)	Air Inlet (in.) NPT/BSP
1000-TH	8,000	9/16	1/2	1300	800	4.50	7.5	8	3/8	1/4
1000-TH-2	8,000	9/16	1/2 x 2	1300	800	4.75	9.5	8	3/8	1/4
1285-XL	7,500	9/16	1/2	1600	900	4.6	6.62	8	3/8	1/4

# 1200-K 1/2" KEVLAR™ TWIN CLUTCH IMPACT WRENCH



- Provides 1,295 ft-lb Loosening torque
- The NitroCat 1200-K is a no non-sense, hard hitting 1/2" impact wrench that out performs anything in its class!
- Hard hitting smooth twin clutch mechanism
- Durable Kevlar™ reinforced "Body Armor" housing
- Patented ergonomically designed handle
- Patented quiet tuned exhaust (86 dBA)
- Patented easy operation flip lever forward and reverse
- The twin clutch is better suited for heavy duty (frame work, medium to heavy duty trucks)

# 1250-K 1/2" KEVLAR™ TWIN CLUTCH IMPACT WRENCH



- Provides 1,300 ft-lb Loosening torque
- The NitroCat 1250-K is a fearless, hard hitting, 1/2" impact wrench that out performs anything in its class!
- Hard hitting smooth twin clutch mechanism
- Durable Kevlar™ reinforced "Body Armor" housing
- Patented ergonomically designed handle
- Patented quiet tuned exhaust (86 dBA)
- Patented easy operation flip lever forward and reverse
- The twin clutch is better suited for heavy duty (frame work, medium to heavy duty trucks)

## SPECIFICATIONS

Model No.	Free Speed (RPM)	Bolt Capacity (in.)	Square Drive (in.)	Impacts Per Minute	Max. Torque (ft-lb) @90 psi	Weight (lbs.)	Length (in)	Air Cons. (CFM)	Rec. Hose Size (in.)	Air Inlet (in.) NPT/BSP
1200-K	8,000	9/16	1/2	950	900	4.5	8.25	8	3/8	1/4
1250-K	8,500	9/16	1/2	1000	950	4.5	8.25	8	3/8	1/4

Kevlar™ is a trademark of IE DuPont Nemours and Company and/or its assigns.



# 1450 1/2" IMPACT WRENCH



- Provides 800 ft-lb max. torque
- Refined design twin hammer increases blow frequency and blow efficiency
- Very fast torque development
- 9,000 RPM Free speed provides fast run-down
- Ergonomically designed grip provides maximum operating comfort
- Six position power management switch in back cap provides ultimate control
- Great balance and handling comfort
- Brushed aluminum housing finish

# 1450-2 1/2" x 2" IMPACT WRENCH



- Provides 800 ft-lb max. torque
- Refined design twin hammer increases blow frequency and blow efficiency
- Very fast torque development
- 9,000 RPM free speed provides fast run-down
- Ergonomically designed grip provides maximum operating comfort
- Six position power management switch in back cap provides ultimate control
- Great balance and handling comfort
- Brushed aluminum housing finish

Model No.	Free Speed (RPM)	Bolt Capacity (in.)	Square Drive (in.)	Impacts Per Minute	Max. Torque (ft-lb)	Weight (lbs.)	Length (in)	Air Cons. (CFM)	Rec. Hose Size (in.)	Air Inlet (in.) NPT/BSP
1450	9,000	9/16	1/2	1200	800	4.87	7.0	8	3/8	1/4
1450-2	9,000	9/16	1/2 x 2	1200	800	5.13	9.0	8	3/8	1/4

# 1431 1/2" IMPACT WRENCH



- Provides 800 ft-lb maximum torque
- Hard hitting twin hammer mechanism delivers maximum power
- Grip has been ergonomically designed to perfectly fit the hand, providing unmatched comfort for the user
- Cross bolt forward/reverse and power management control
- Triple heat treated Ni-Cr-Mo alloy steel hammer mechanism parts and anvil, provide ultimate reliability

**1431-2 Features 2" Extended Anvil and includes Grey Pneumatic Thin Wall Flip Socket (19mm\21 mm)**



# 1460-XL 1/2" IMPACT WRENCH



- Provides 725 ft-lb maximum torque
- Hard hitting twin hammer mechanism
- **Designed for tire shops to operate up to 125 psi air pressure**
- Improved design ergonomic grip provides maximum operating comfort
- Molded motor housing cover protects the tool and adds reliability
- Cross bolt style forward/reverse with built-in regulator
- Triple heat treated alloy steel hammers, hammer cage and anvil
- Reliable throttle design with tease trigger

**1460-XL-2 Features 2" Extended Anvil**



## SPECIFICATIONS

Model No.	Free Speed (RPM)	Bolt Capacity (in.)	Square Drive (in.)	Impacts Per Minute	Max. Torque (ft-lb)	Weight (lbs.)	Length (in)	Air Cons. (CFM)	Rec. Hose Size (in.)	Air Inlet (in.) NPT/BSP
1431	9,000	1/2	1/2	1600	800	5.7	7.2	8	3/8	1/4
1431-2	9,000	1/2	1/2 x 2	1600	800	5.7	7.2	8	3/8	1/4
1460-XL	9,500	9/16	1/2	1600	725	5.75	7.25	8	3/8	1/4
1460-XL	9,500	9/16	1/2	1600	725	5.75	7.25	8	3/8	1/4



# 1770-XL 3/4" "SUPER DUTY" IMPACT WRENCH



- Provides 1,600 ft-lb loosening torque
- Refined design twin hammer increases blow frequency and efficiency
- Power management switch with three power settings
- Molded-in buffers protect tool from side impact
- Ergonomically designed grip and trigger provide ultimate operating comfort
- Designed for heavy duty fleet maintenance and industrial MRO work
- Combined through hole and friction ring socket retainer



Model #1770-XLK 3/4-in. Impact Wrench Kit  
Includes: 1770-XL Impact Wrench, Aircat Tool Bag and Grey Pneumatic 3/4-in. Drive "Deep Length" Impact Socket Set  
Socket Sizes: 1", 1-1/16", 1-1/8", 1-1/4", 1-5/16", 1-3/8", 1-7/6" and 1-1/2"

# 1778-VXL 3/4" IMPACT WRENCH



## VIBROTHERM by AIRCAT DRIVE™

- Provides 1,700 ft-lb loosening torque
- VIBROTHERM DRIVE™ impact wrenches incorporate the completely new AIRCAT design impact wrench mechanism (patent pending)
- The new mechanism reduces vibration levels by between 30%-40% and increased the life of the mechanism by 50%
- The latest patented AIRCAT muffler system produces the characteristic AIRCAT unmatched low noise levels
- The patented grip design provide the customary AIRCAT operator comfort
- Investment into tooling and materials and a triple injection molding processes enables AIRCAT to produce cosmetic designs that are unmatched in the industry
- "Three year warranty"

Model No.	Free Speed (RPM)	Bolt Capacity (in.)	Square Drive (in.)	Impacts Per Minute	Max. Torque (ft-lb) @90 psi	Weight (lbs.)	Length (in)	Air Cons. (CFM)	Rec. Hose Size (in.)	Air Inlet (in.) NPT/BSP
1770-XL	6,500	1	3/4	1300	1400	7.4	8.25	8	1/2	3/8
1778-VXL	5,400	1	3/4	1300	1450	7.4	7.4	8	1/2	3/8

# 1600-TH-A 3/4" "SUPER DUTY" IMPACT WRENCH



- Provides 1,600 ft-lb loosening torque
- Hard hitting "Super Clutch" twin hammer mechanism
- Best suited for bus/large automotive use, large agricultural service vehicles, large bolt assembly
- Patented ergonomically designed handle
- Patented quiet tuned exhaust (86 Decibels)
- Patented easy operation flip lever forward and reverse
- Combined through hole and friction ring socket retainer

# 1777 3/4" "SUPER DUTY" IMPACT WRENCH



- Provides 1600 ft-lb loosening torque
- Refined design twin hammer increases blow efficiency and doubles hammer mechanism life
- Hammer parts are made from triple heat treated Ni-cr-mo alloy steel for ultimate reliability
- Improved design ergonomic grip for maximum operating comfort
- Very fast torque development
- Combined six position power management and reverse knob for ultimate control



Model #1777-K 3/4-in. Impact Wrench Kit  
Includes: 1777 Impact Wrench, Aircat Tool Bag and Grey Pneumatic 3/4-in. Drive "Deep Length" Impact Socket Set  
Socket Sizes: 1", 1-1/16", 1-1/8", 1-1/4", 1-5/16", 1-3/8", 1-7/6" and 1-1/2"

## SPECIFICATIONS

Model No.	Free Speed (RPM)	Bolt Capacity (in.)	Square Drive (in.)	Impacts Per Minute	Max. Torque (ft-lb) @90 psi	Weight (lbs.)	Length (in)	Air Cons. (CFM)	Rec. Hose Size (in.)	Air Inlet (in.) NPT/BSP
1600-TH-A	4,500	7/8	3/4	900	1400	8.1	9.25	10	1/2	3/8
1777	6500	1	3/4	1600	1400	7.5	8.12	8	1/2	3/8



# 1680-A 3/4" "XTREME DUTY" TWIN HAMMER IMPACT WRENCH



- Provides 1600 ft-lb maximum torque
- Durable hard hitting twin hammer mechanism
- Improved compact design
- Patented "Silencing Technology" reduces noise to 89 dBa
- Patented AIRCAT grip
- Combined power management F/R switch
- Triple heat treated Ni-Cr-Mo alloy steel hammer mechanism
- Designed for the very toughest working conditions
- Combined through hole and friction ring socket retainer

**1680-A-6 6" Extended Anvil**

# 1750-K NITROCAT KEVLAR™ COMPOSITE 3/4" "XTREME POWER"



- Provides 1300 ft-lbs maximum torque
- Smooth twin clutch mechanism for fast torque build-up and low vibration
- Durable Kevlar™ reinforced "Body Armor" housing
- Patented "silencing technology" reduces noise to 90 dBa
- Patented ergonomic grip for comfort
- Combined through hole and friction ring socket retainer

Model No.	Free Speed (RPM)	Bolt Capacity (in.)	Square Drive (in.)	Impacts Per Minute	Max. Torque (ft-lb) @90 psi	Weight (lbs.)	Length (in)	Air Cons. (CFM)	Rec. Hose Size (in.)	Air Inlet (in.) NPT/BSP
1680-A	4,500	1	3/4	950	1600	12.5	8.9	8	1/2	3/8
1680-A-6	4,500	1	3/4 X 6	950	1600	14.8	14.8	8	1/2	3/8
1750-K	4,500	7/8	3/4	1000	1300	9	9.75	24	1/2	3/8

# 1600-TH-A1 1" SUPER DUTY PISTOL IMPACT WRENCH



- Provides 1600 ft-lb loosening torque
- Composite housing reduces weight
- Hard hitting twin hammer mechanism delivers maximum power
- Patented "Silencing Technology" reduces the noise level to 86 dBA
- The grip has been ergonomically designed to perfectly fit the hand-providing unmatched comfort for the user
- Combined reverse and power management switch provides control
- Triple heat treated Ni-Cr-Mo alloy steel hammer mechanism parts and anvil, provide ultimate reliability
- Combined through hole and friction ring socket retainer

# 1870-P 1" SUPER DUTY PISTOL IMPACT WRENCH



- Provides 2,100 ft-lb maximum torque
- Unmatched power to weight ratio - weighs only 12.95 lbs.
- 1870-P has low weight impact-resistant housing
- Features combined friction-ring and through-hole socket retainers
- Combined through hole and friction ring socket retainer
- Cranked side handle design avoids operators hand getting too close to work area

## SPECIFICATIONS

Model No.	Free Speed (RPM)	Bolt Capacity (in.)	Square Drive (in.)	Impacts Per Minute	Max. Torque (ft-lb) @90 psi	Weight (lbs.)	Length (in)	Air Cons. (CFM)	Rec. Hose Size (in.)	Air Inlet (in.) NPT/BSP
1600-TH-A1	4,500	1-1/4	1	1100	1400	8.25	9.25	10	1/2	1/2
1870-P	7,500	1-1/4	1	1400	2100	12.95	10.7	7.5	1/2	1/2



# 1880-P-A 1" PISTOL IMPACT WRENCH



- Provides 1900 ft-lb loosening torque
- Hard hitting twin hammer mechanism
- Molded hammer case protective cover
- Uniquely designed combined rear gasket/protective band prevents band from moving out of position
- Rugged bolt-on side assist handle
- Low wear pinless hammer
- Noise level to (88 dBA)
- Combined reverse and power management switch provides control
- Combined through hole and friction ring socket retainer

# 1890-P 1" PISTOL IMPACT WRENCH



- Provides 2500 ft-lb loosening torque
- Two jaw clutch provides unparalleled torque output and increases the life of the hammer beyond other impact mechanisms
- The two jaw clutch does not waste energy; this combined with the precision air motor dramatically reduces air consumption over other 1" impact wrenches to 24.5 CFM free running and 6.1 average
- Designed for fleet and off road vehicle service and steel erection
- Steel hammer case and heavy duty cast housing handle provide ultimate reliability
- Combined through hole and friction ring socket retainer

Model No.	Free Speed (RPM)	Bolt Capacity (in.)	Square Drive (in.)	Impacts Per Minute	Max. Torque (ft-lb) @90 psi	Weight (lbs.)	Length (in)	Air Cons. (CFM)	Rec. Hose Size (in.)	Air Inlet (in.) NPT/BSP
1880-P-A	4,800	1-1/4	1	900	1700	23.5	11.75	16	1/2	1/2
1890-P	4,200	1-1/4	1	1200	2000	24.0	11.0	6.1	1/2	1/2

# 1991 1" x 8" LOW WEIGHT EXTENDED IMPACT WRENCH



- Provides 2,100 ft-lb maximum torque
- Unmatched power to weight ratio
- Exhaust can be located at either the top or bottom of tool
- Rubber handle grips and rubberized trigger inserts for ultimate comfort
- Combined friction-ring and through-hole socket retainers
- Model 1991 includes two Grey Pneumatic brand deep impact sockets (33mm and 1-1/2")



**1991-1 Short anvil available**

# 1893 1" x 8" EXTENDED IMPACT WRENCH



- Provides 1800 ft-lb Maximum torque
- Unique low wear pinless hammer for ultimate reliability and added hitting power
- Combined directional change and power management switch
- Latest technology precision engineered hammer mechanism and motor
- Triple heat treated alloy steel hammer cage and anvil
- Rugged construction with reliable bolt-on assist handle
- Hammer case can be repositioned for side handle to be on right side
- Durable brushed aluminum motor housing
- Combined through hole and friction ring socket retainer



**1893-1 Short anvil available**

## SPECIFICATIONS

Model No.	Free Speed (RPM)	Bolt Capacity (in.)	Square Drive (in.)	Impacts Per Minute	Max. Torque (ft-lb) @90 psi	Weight (lbs.)	Length (in)	Air Cons. (CFM)	Rec. Hose Size (in.)	Air Inlet (in.) NPT/BSP
1991	6,000	1-1/4	1 x 8	1600	2100	20.7	19.0	8	1/2	1/2
1991-1	6,000	1-1/4	1	1600	2100	16.7	12.9	8	1/2	1/2
1893	5,000	1-1/4	1 x 8	1400	1800	26.0	22.0	12	1/2	1/2
1893-1	5,000	1-1/4	1	1400	1800	23.25	14.0	12	1/2	1/2

# 1900-A 1" x 8" EXTENDED "SUPER DUTY" IMPACT WRENCH



- Provides 1900 ft-lb maximum torque
- Unique low wear pinless hammer
- Aluminum housing with rubber over mold for increased protection
- Ergonomic trigger with rubber inlay for comfort
- Enlarged inner cavity of "D" handle grip more suitable for U.S. users
- Rugged bolt-on side assist handle can be repositioned on right or left
- Triple heat treated Ni-Cr-Mo alloy steel hammer mechanism parts and anvil provide ultimate reliability
- Combined through hole and friction ring socket retainer



**1900-A-1 Short anvil available**

# 1994 1" x 8" EXTENDED "SUPER DUTY" IMPACT WRENCH

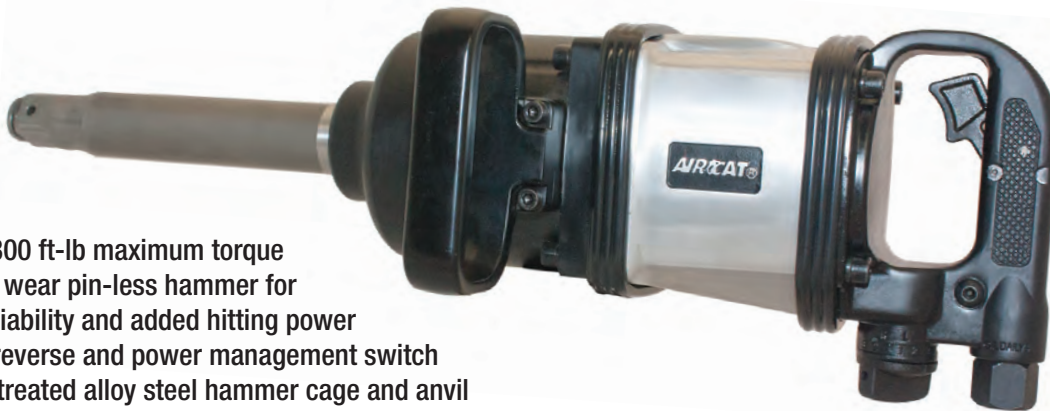

- Provides 2300 ft-lb maximum torque
- Unique low wear pin-less hammer for ultimate reliability and added hitting power
- Combined reverse and power management switch
- Triple heat treated alloy steel hammer cage and anvil
- Rugged construction with reliable bolt-on assist handle
- Hammer case can be repositioned for side handle to be on right side
- Brushed aluminum motor housing
- The most reliable 1" Impact Wrench
- Combined through hole and friction ring socket retainer

Model No.	Free Speed (RPM)	Bolt Capacity (in.)	Square Drive (in.)	Impacts Per Minute	Max. Torque (ft-lb) @90 psi	Weight (lbs.)	Length (in)	Air Cons. (CFM)	Rec. Hose Size (in.)	Air Inlet (in.) NPT/BSP
1900-A	5,500	1-1/4	1 x 8	1600	1900	26.0	22.0	12	1/2	1/2
1900-A-1	5,500	1-1/4	1	1600	1900	24.2	15.5	12	1/2	1/2
1994	4,500	1-1/4	1 x 8	1100	2300	35.0	26.0	16	1/2	1/2



# 1992 1" x 8" "SUPER DUTY" EXT. ANVIL IMPACT WRENCH



- Provides 1800 ft-lb maximum torque
- Hard hitting twin hammer
- Aluminum housing and hammer case
- Enlarged inner cavity of rotating "D" handle grip is more suitable for US users.
- Combined reverse and power management switches
- Triple heated Ni-Cr-Mo alloy steel hammer mechanism parts and anvil provide ultimate reliability
- Combined friction ring and through hole anvil for positive socket lock-on.



# 1992-1 1" "SUPER DUTY" IMPACT WRENCH



- Provides 1800 ft-lb maximum torque
- Hard hitting twin hammer
- Aluminum housing and hammer case
- Enlarged inner cavity of rotating "D" handle grip is more suitable for US users.
- Combined reverse and power management switches
- Triple heated Ni-Cr-Mo alloy steel hammer mechanism parts and anvil provide ultimate reliability
- Combined friction ring and through hole anvil for positive socket lock-on.



## SPECIFICATIONS

Model No.	Free Speed (RPM)	Bolt Capacity (in.)	Square Drive (in.)	Impacts Per Minute	Max. Torque (ft-lb) @90 psi	Weight (lbs.)	Length (in)	Air Cons. (CFM)	Rec. Hose Size (in.)	Air Inlet (in.) NPT/BSP
1992	5,000	1-1/4	1	1600	1800	26.0	23.2	12	1/2	1/2
1992-1	5,000	1-1/4	1	1600	1800	14.0	15.5	12	1/2	1/2

# HOW TO MAXIMUM YOUR TOOLS PERFORMANCE

## HOW TO MAXIMIZE YOUR AIR MOTOR PERFORMANCE AND IMPACT WRENCH TORQUE OUTPUT AND WORKING LIFE.

Compressed air is a misunderstood power source as unlike electricity that is constant and maintains constant horsepower, as compressed air drives a motor horsepower can vary dependent on how the tool is set up. The tips below will ensure that you maximize the horse power of the air motor and torque level of your impact wrench:

Air tool manufactures measure the impact wrench rated torque levels stated in there catalogs and rated horse power and RPM of the air tools stated in their catalogs based on 90 PSI are pressure entering the tool at the tool air inlet.

If the air pressure is set at the compressor or at an in-line pressure regulator at 90 PSI by the time that the air reaches the tools air inlet; the pressure will have dropped. Typically each 25' between the air pressure gauge and the tool with cause a 15% air pressure drop at the tool. In addition any restriction added to a hose hook-up, like a connector that reduces the inside diameter of the air connection will cause a severe pressure drop at the tool. Then any air leak at a connection point between the compressor and the tool will reduce air pressure. Use of the wrong air hose ID size will typically reduce tool performance by 40%-50%. Use of very small compressors to run air tools will dramatically reduce performance.

### TIPS TO MAXIMIZE TOOL PERFORMANCE:

- Always use the air hose ID size recommended by the tool manufacturer.
- For any impact wrench up to 1/2" drive and other air tools always use a 3/8" ID air hose.
- For any impact wrench 3/4" and 1" drive always use a 1/2" ID air hose.
- Reduce the hose length to the shortest length practical for use, as a guide if a 25" air hose is used the pressure at the in-line regulator should be set at 105-110 PSI this will deliver 90 PSI to the tool
- Ensure that thread tape is used on all connections from the compressor to the tool
- Do not use connectors or reducers in the air hose hook-up.
- For impact wrenches up to 1/2" drive and most other air tools a compressor with a minimum 20 gallon tank and 5 HP motor should be used. For 3/4" & 1" impact wrenches, sanders and heavy grinders a compressor with a minimum 40 gallon tank and 8 HP motor should be used. Note that all pro auto service shops have installed compressors that well exceed the above minimums.

### TIPS TO MAXIMIZE TOOL LIFE:

An air motor is no different than the internal combustion engine in your car they need oil. Inline lubricators are best. If not installed always add a few drops of air tool oil into the tools air inlet each day before use, and most importantly at the end of the day add a few drops of air tool oil, run the tool for a few seconds before storing overnight. In certain conditions compressed air generates water vapor that if entering the tool will corrode the internal motor parts, moisture traps should be fitted in to your air supply system.

Impact wrench hammer mechanisms require grease, normally it is adequate to replace the grease at the tools service interval or after six months use.

# RATCHETS





## 807 3/8" "MINI" COMPOSITE PALM RATCHET



- 35 ft-lb Maximum torque
- 300 RPM provides fast run-down
- **Built-in quick socket release button**
- Ergonomic composite over mold grip provides comfort
- Great for work around radiators and very confined spaces
- Only 5.4" long and weighs only 1.1 lbs.

## 800 1/4" "MINI" COMPOSITE SINGLE PAWL RATCHET



- 35 ft-lb Maximum torque
- Strongest 1/4" Ratchet in its class!
- Single pawl mechanism
- Fast rundown 320 RPM
- Superior internal mechanics
- Patented quiet tuned exhaust (82 dBA)
- Feather trigger for control
- Ergonomically designed housing
- Most comfortable trigger lever in the industry

**801 has 3/8" drive**

## 802 3/8" COMPOSITE TWIN PAWL RATCHET



- 70 ft-lb Maximum torque
- Durable twin pawl mechanism
- Fast rundown 280 RPM
- Patented quiet tuned exhaust (82 dBA)
- Feather trigger for control
- Ergonomically designed housing
- Most comfortable trigger lever in the industry

**802-5 available with 1/2" square drive**

## SPECIFICATIONS

Model No.	Free Speed (RPM)	Bolt Capacity (in.)	Square Drive (in.)	Working Torque	Max. Torque (ft-lb) @90 psi	Weight (lbs.)	Length (in)	Air Cons. (CFM)	Rec. Hose Size (in.)	Air Inlet (in.) NPT/BSP
807	300	3/8	3/8	5-25 ft-lb	35	1.1	5.4	3	3/8	1/4
800	320	3/8	1/4	5-35 ft-lb	35	1.63	8.5	4	3/8	1/4
801	320	3/8	3/8	5-35 ft-lb	35	1.63	8.5	4	3/8	1/4
802 / 802-5	280	3/8	3/8 / 1/2	5-70 ft-lb	70	2.75	10.5	4	3/8	1/4

# 809-SH 3/8" SEALED FLAT HEAD RATCHET



Available  
March 2019

- 60 ft-lb Maximum torque
- Low profile flat head allows access into confined work areas
- Sealed head design eliminates dirt & debris entering the ratchet mechanism increasing reliability
- Convenient and comfortable trigger operation
- Easy to access forward/reverse switch
- 360 degree rotational exhaust deflector allows exhaust air to be directed as preferred
- **809-SH-5 Available with 1/2" square drive**

# 804 1/4" MINI RATCHET



- 30 ft-lb Maximum torque
- 280 RPM provides fast run-down
- The single piece, high grade, alloy steel housing ratchet head increases reliability and eliminates "loosening" of the ratchet head
- Uniquely designed transmission gear increases the rate of torque build-up
- Ergonomic composite over mold grip provides comfort

# 806 3/8" HIGH PERFORMANCE RATCHET



- 80 ft-lb Maximum torque
- 200 RPM
- Strongest 3/8" ratchet in its class!
- Unique variable speed throttle provides unmatched control
- Enlarged ratchet head provides added reliability
- Ratchet head protective cover adds protection
- Soft touch coated handle grip increases operating comfort
- Needle bearing construction increases reliability
- 360° Rotational exhaust allows exhaust air to be directed as preferred

## SPECIFICATIONS

Model No.	Free Speed (RPM)	Bolt Capacity (in.)	Square Drive (in.)	Max. Torque (ft-lb) @90 psi	Weight (lbs.)	Length (in)	Air Cons. (CFM)	Rec. Hose Size (in.)	Air Inlet (in.) NPT/BSP
809-SH	350	1/2	3/8	60	2.9	12.4	4	3/8	1/4
809-SH-5	350	1/2	1/2	60	2.9	12.4	4	3/8	1/4
804	280	3/8	1/4	30	1.55	7.15	4	3/8	1/4
806	200	1/2	3/8	80	2.5	10.9	4	3/8	1/4

# 803-RW 3/8" REACTION-LESS RATCHET



- 80 ft-lb Maximum torque
- Internal impact mechanism eliminates torque reaction and risk of finger trapping
- 600 RPM run-down speed with built-in regulator for control
- Very quiet compared to conventional air ratchets-only 79 dBA
- Composite handle grip increases operating comfort
- Needle bearing construction increases reliability
- Push and lock reverse switch

# 805-HT 3/8" HIGH TORQUE RATCHET



- **130 ft-lb Maximum torque**
- Latest design ratchet head eliminates "spreading"
- Reliable single pawl design
- Extra large ratchet head increases reliability
- Rapid response and variable speed trigger
- Quiet for such a powerful ratchet (84 dBA)
- Ergonomically designed contoured grip and trigger provide ultimate operating comfort

**805-HT-5 Available with 1/2" square drive**

**WARNING: Use with care to avoid finger trapping.**

# 808 LONG REACH SERIES RATCHETS



- 808-15 30 ft-lb Maximum torque (15.3" Long)
- 808-15-25 30 ft-lb Maximum torque (15.3" Long)
- 808-22 65 ft-lb Maximum torque (22.5" Long)
- Exclusive AIRCAT design
- Extended drive shafts provide access for hard to reach fasteners
- High grade materials and additional support bearings provide reliability

## SPECIFICATIONS

Model No.	Free Speed (RPM)	Bolt Capacity (in.)	Square Drive (in.)	Max. Torque (ft-lb) @90 psi	Weight (lbs.)	Length (in)	Air Cons. (CFM)	Rec. Hose Size (in.)	Air Inlet (in.) NPT/BSP
803-RW	600	3/8	3/8	80	2.4	10.5	4	3/8	1/4
805-HT / 808-HT-5	180	5/8	3/8 / 1/2	130	3.3	12.45	6	3/8	1/4
808-15 / 808-15-25	200	3/8	3/8 / 1/4	30	3.1	15.3	4	3/8	1/4
808-22	160	1/2	3/8	65	4.3	22.5	6	3/8	1/4





# GRINDERS and CUT-OFF TOOLS

AIRCAT Die Grinders and Cut-off Tools feature patented internal silencing. The most comfortably designed triggers in the industry and ergonomically designed grips.

The precision collets, spindles and gears provide low service run-out and long life.

AIRCAT offers a selection of 16 die grinders and cut-off tools with a choice of 0.3 HP to 1.0 HP. Certain AIRCAT models offer spindle locks and are reversible.

## 6200 COMPOSITE STRAIGHT "MINI" DIE GRINDER



- Patented quiet tuned exhaust (82 dBA)
- Superior steel grade internal bearings for longer life
- Feather trigger for better speed control
- Ergonomically designed housing
- Most comfortable trigger in the industry

## 6201 COMPOSITE STRAIGHT DIE GRINDER



- Patented quiet tuned exhaust (82 dBA)
- Superior steel grade internal bearings for longer life
- Feather trigger for better speed control
- Ergonomically designed housing
- Most comfortable trigger in the industry

## 6260 COMPOSITE 1.0 HP STRAIGHT DIE GRINDER



- Full 1.0 HP non-stall motor
- Patented quiet tuned exhaust (82 dBA)
- Superior steel grade internal bearings for longer life
- Feather trigger for better speed control
- Ergonomically designed housing
- Most comfortable trigger in the industry

## SPECIFICATIONS

Model No.	Free Speed (RPM)	Motor (HP)	Collet Size (in)	Gears	Exhaust	Weight (lbs.)	Length (in)	Air Cons. (CFM)	Rec. Hose Size (in.)	Air Inlet (in.) NPT/BSP
6200	20,000	3/8	1/4	Direct Drive	Rear	.9	6.5	4	3/8	1/4
6201	22,000	1/2	1/4	Direct Drive	Rear	1.1	8.5	6	3/8	1/4
6260	22,000	1.0	1/4	Direct Drive	Rear	1.2	9.25	8	3/8	1/4

# 6285 .75 HP 1/4" COLLET STRAIGHT DIE GRINDER



- **Spindle lock feature for easy accessory change**
- Erickson® style precision collet
- .75 HP non stall motor
- Composite handle and grip for comfort
- Low noise only 79 dBa
- Low vibration only <2.5>m/sec<sup>2</sup>
- Speed control switch located on top of the grip for added control

# 6290 .75 HP 1/4" COLLET REVERSIBLE STRAIGHT DIE GRINDER



- Erickson® style precision collet
- .75 HP non stall motor
- Composite handle and grip for comfort
- Low noise only 79 dBa
- Low vibration only <2.5>m/sec<sup>2</sup>
- Speed control switch located on top of the grip for added control

## SPECIFICATIONS

Model No.	Free Speed (RPM)	Motor (HP)	Collet / Spindle Size (in.)	Gears	Exhaust	Weight (lbs.)	Length (in.)	Air Cons. (CFM)	Rec. Hose Size (in.)	Air Inlet (in.) NPT/BSP
6285	20,000	0.75	1/4	Direct drive	Rear	1.4	7	4.1	3/8	1/4
6290	20,000	0.75	1/4	Direct drive	Rear	1.4	7	4.1	3/8	1/4



# 6210 COMPOSITE STRAIGHT DIE GRINDER EXTENDED SHANK



- Patented quiet tuned exhaust (82 dBA)
- Superior steel grade internal bearings for longer life
- Feather trigger for better speed control
- Ergonomically designed housing
- Extended head to reach in tight spots
- Most comfortable trigger in the industry

# 6270 1.0 HP EXTENDED STRAIGHT DIE GRINDER



- 1.0 HP non stall motor
- 20,000 RPM
- Patented "Silencing technology" reduces noise to 89 dBA
- Low vibration only <2.5>m/sec<sup>2</sup>
- Composite grip and throttle trigger for comfort
- 6" Extension to reach tight areas

Model No.	Free Speed (RPM)	Motor (HP)	Collet Size (in)	Gears	Exhaust	Weight (lbs.)	Length (in)	Air Cons. (CFM)	Rec. Hose Size (in.)	Air Inlet (in.) NPT/BSP
6210	22,000	1/2	1/4	Direct Drive	Rear	2.5	13.5	6	3/8	1/4
6270	20,000	1.0	1/4	Direct Drive	Rear	3.1	14.15	4.2	3/8	1/4

## 6255 COMPOSITE ANGLE DIE GRINDER



- Superior steel grade internal bevel gears for longer life
- Feather trigger for better speed control
- Patented quiet technology (82 dBA)
- Excellent for high speed blending, smoothing, porting and deburring in confined areas
- Ergonomically designed housing
- Most comfortable trigger in the industry

## 6265 1.0 HP ANGLE DIE GRINDER



- 1 HP non stall motor
- 18,000 RPM
- Patented "Silencing technology" reduces noise to 89 dBA
- Low vibration only <2.5>m/sec<sup>2</sup>
- Composite grip and throttle trigger for comfort
- Precision bevel gears for reliability
- Includes 1 pc each 2" & 3" Roloc® style backing pads

## 6280 .75 HP 1/4" COLLET ANGLE DIE GRINDER



- **Spindle lock feature for easy accessory change**
- Erickson® style precision collet
- .75 HP non stall motor
- Composite handle and grip for comfort
- Low noise only 79 dBA
- Low vibration only <2.5>m/sec<sup>2</sup>
- Speed control switch located at the top of the grip for added control

## SPECIFICATIONS

Model No.	Free Speed (RPM)	Motor (HP)	Collet / Spindle Size (in.)	Gears	Exhaust	Weight (lbs.)	Length (in.)	Air Cons. (CFM)	Rec. Hose Size (in.)	Air Inlet (in.) NPT/BSP
6255	20,000	1/2	1/4	Spiral-Bevel	Rear	1.1	7.0	6	3/8	1/4
6265	18,000	1.0	1/4	5:1 Bevel Gears	Rear	1.8	9.5	4.2	3/8	1/4
6280	18,000	0.75	1/4	5:1 Bevel Gears	Rear	1.8	7	4.1	3/8	1/4

## 6275-A 4" COMPOSITE INSIDE CUT-OFF TOOL



- New 1.0 HP motor eliminates "stall" and increases reliability
- Extended length for better reach. Get in where other tools fail to go!
- Compact tapered gear housing with close-coupled grinding wheel
- Reaches inside corners of as little as 30° degrees with 4" wheel
- Superior steel grade internal gears for longer life
- **New spindle lock for ease of wheel change**
- **New 11 position rotational guard**
- Grinder disc sizes: 4" (1/16 x 3/8) (1/8 x 3/8)

## 6340 4-1/2" ANGLE GRINDER



- New 1.0 HP motor eliminates "stall" and increases reliability
- Spindle lock for ease of wheel change
- Multi positional rotational guard improves access
- Hi-Low speed adjustment control
- The composite grip and throttle trigger have been ergonomically designed to provide unmatched comfort for the user
- Rotational muffler mounted at rear exhaust

## 6380 2.3 HP 5" HEAVY DUTY ANGLE GRINDER



- 2.3 HP governed motor provides constant speed and unstoppable stall-less operation
- Spindle lock for ease of wheel change
- Ergonomically designed composite grip, vibration damped, side handle and throttle trigger provide unmatched comfort to the user
- Rear exhaust

## SPECIFICATIONS

Model No.	Free Speed (RPM)	Motor (HP)	Wheel Size (in)	Gears	Exhaust	Weight (lbs.)	Length (in)	Air Cons. (CFM)	Rec. Hose Size (in.)	Air Inlet (in.) NPT/BSP
6275-A	14,000	1.0	4	Spiral Bevel	Rear	3.75	15.5	6	3/8	1/4
6340	11,000	1.0	4-1/2	Spiral Bevel	Rear	2.25	8.75	6	3/8	1/4
6380	12,000	2.3	5	Spiral Bevel	Rear	3.97	9.13	10	1/2	1/4



## 6505 3" COMPOSITE CUT-OFF TOOL



- Patented quiet tuned exhaust (86 dBA)
- Feather trigger for better speed control
- Ergonomically designed housing
- Safe compact and low weight
- Most comfortable trigger in the industry

## 6560 1 HP 4" COMPOSITE CUT-OFF TOOL



- 1 HP non stall motor
- 14,000 RPM
- Patented "Silencing technology" reduces noise to 89 dBA
- Low vibration only <2.5>m/sec<sup>2</sup>
- Composite grip and throttle trigger for comfort
- Cuts 3/4" Rolled Steel/18 Gauge
- Features 4" diameter wheel

## SPECIFICATIONS

Model No.	Free Speed (RPM)	Motor (HP)	Wheel Size (in)	Gears	Cutting Capacity	Exhaust	Weight (lbs.)	Length (in)	Air Cons. (CFM)	Rec. Hose Size (in.)	Air Inlet (in.) NPT/BSP
6505	20,000	1/2	3	Direct Drive	3/4" Rolled Steel / 18 Gauge	Rear	1.75	9.0	6	3/8	1/4
6560	14,000	1.0	4	Single reduction	3/4" Rolled Steel / 18 Gauge	Rear	1.8	9.5	4.2	3/8	1/4

# 6520 3" COMPOSITE REVERSIBLE CUT-OFF TOOL



- Adjusting rotational direction increases cutting wheel life and allows operator to change the direction of sparks
- Reverse switch located in grip for easy change of direction
- Cuts 3/8" rolled steel or 18 gauge steel sheet
- Speed regulator located under throttle lever adds control
- Impact resistant, composite housing
- Extra heavy duty dual spindle bearings for added reliability
- Speed control switch located on top of the housing for added control

# 6525-A IN-LINE CUT-OFF TOOL



- 0.6 HP motor provides non-stall operation
- Side mounted wheel and in-line motor allows for straight cutting of materials
- Composite grip has been ergonomically designed to provide unmatched comfort for the user
- Rear exhaust allows exhaust air to be directed as preferred
- Manufactured from high grade material precision parts designed for industrial and heavy duty automotive use

Model No.	Free Speed (RPM)	Motor (HP)	Wheel Size (in)	Gears	Cutting Capacity	Exhaust	Weight (lbs.)	Length (in)	Air Cons. (CFM)	Rec. Hose Size (in.)	Air Inlet (in.) NPT/BSP
6520	18,000	0.5	3	Direct Drive	3/4" Rolled Steel / 18 Gauge	Rear	1.6	7.0	4	3/8	1/4
6525	18,000	0.6	3	Direct Drive	3/4" Rolled Steel / 18 Gauge	Rear	2.2	7.95	6	3/8	1/4

# DRILLS, HAMMERS, SANDERS, POLISHERS, TIRE BUFFERS, SAW and NIBBLER

AIRCAT's latest designs and innovations add reliability, reduced noise levels and weight, while providing added operator comfort.

AIRCAT drills feature precision fully caged planetary gears and trigger mounted reverse switches for instant change of direction. The AIRCAT ergonomic grip designs incorporated in the drills provide perfect balance and added operator comfort.

AIRCAT sanders feature a patented motor design that reduces vibration to  $1.8 \text{ m/sec}^2$ . These motors are also double sealed to eliminate any dust contamination of internal parts. AIRCAT sanders are the first sanders that have technology that allows the tools to be used lubrication free, eliminating any oil mist contamination of the work surface. To further extend the life and reliability of the tools; they also incorporate a double bearing design. AIRCAT sanders are built using the latest technology composite grips and handles proving lower weight and added comfort for the operator. The selection of AIRCAT sanders are designed to meet the latest market requirements for ultra fine paint finishing and spot repair work

AIRCAT hammers feature a multi-patented silencing system and internal vibration damping that reduce vibration levels to  $4.2 \text{ m/sec}^2$ . The AIRCAT ergonomic grip designs incorporated in the hammers provide perfect balance and added operator comfort.

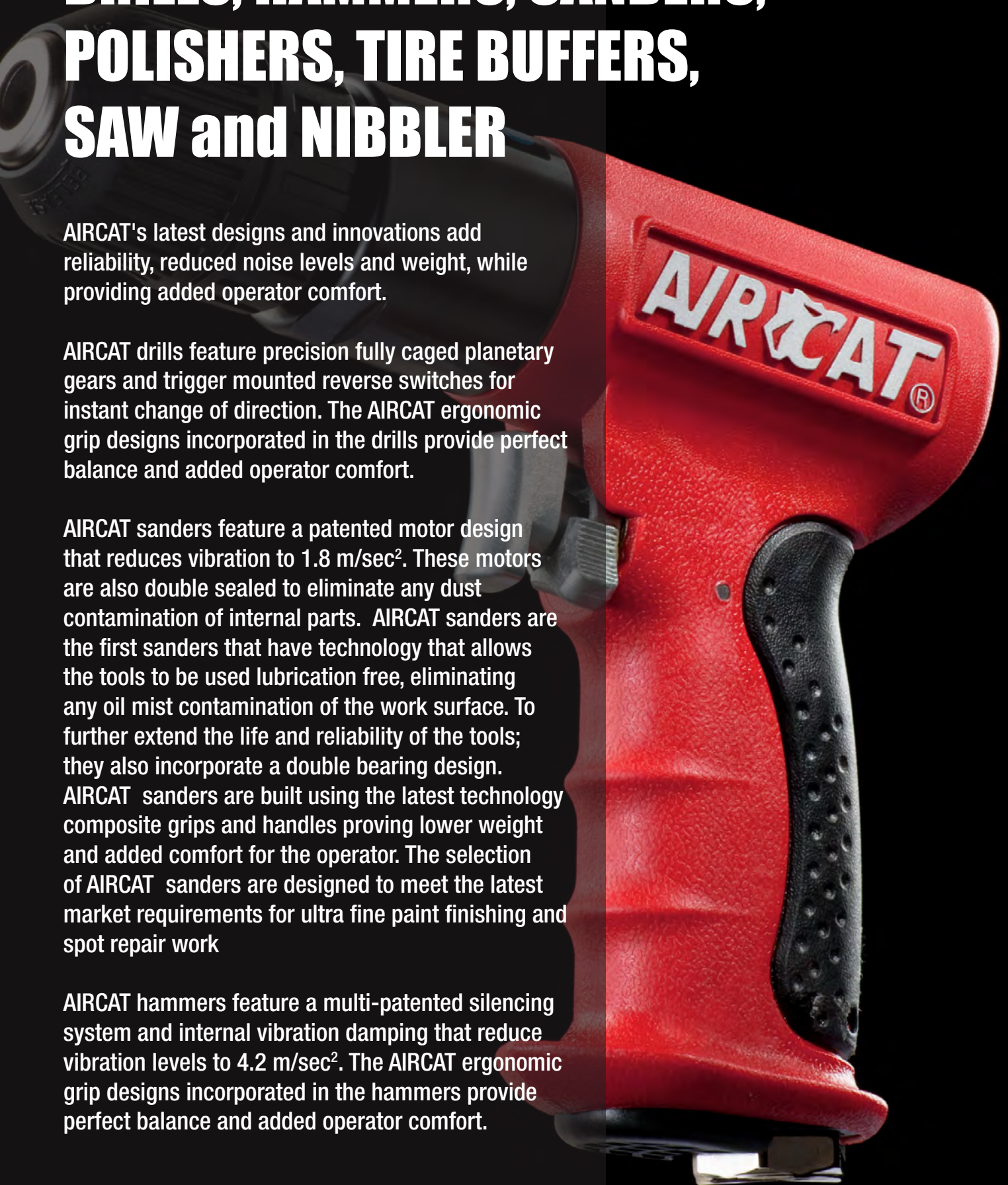



# 4338 3/8" COMPOSITE DRILL JACOBS® CHUCK



- 3/8" Reversible composite drill
- Jacobs® chuck (Keyless)
- Feather trigger for better speed control
- Trigger mounted reverse for instant change of direction
- 1,800 RPM
- Superior grade steel planetary gear for longer life
- Patented quiet tuned exhaust (85 dBA)
- Patented ergonomically designed handle
- Air flow pressure: 90 (psi)

# 4450 1/2" COMPOSITE DRILL - SIDE ASSIST HANDLE INCLUDED



- 1/2" Reversible composite drill
- Keyed chuck
- Feather trigger for better speed control
- Trigger mounted reverse for instant change of direction
- Superior grade steel planetary gear for longer life
- 400 RPM
- Patented quiet tuned exhaust (85 dBA)
- Patented ergonomically designed handle
- Air flow pressure: 90 (psi)

Model No.	Free Speed (RPM)	Motor (HP)	Chuck Size (in.)	Gears	Spindle Thread Size (in.)	Weight (lbs.)	Length (in)	Air Cons. (CFM)	Rec. Hose Size (in.)	Air Inlet (in.) NPT/BSP
4338	1,800	5/8	3/8	Planetary	3/8 x 24	2.5	7.0	6	3/8	1/4
4450	400	5/8	1/2	Planetary	3/8 x 24	3.0	8.0	6	3/8	1/4

## 4439 3/8" DRILL



- **0.7 HP motor**
- Low weight composite housing reduces weight.
- Patented one-click reverse button provides instant change of direction
- Patented "silencing technology" reduces the noise level to 83 dBA
- Patented grip has been ergonomically designed to perfectly fit the hand-providing unmatched comfort for the user
- **Forward position handle allows operator to apply increased feed force**
- Forward position handle allows more control to start hole, and more control to maintain the drilled hole axis

## 4451 1/2" DRILL - VIBRATION DAMPED SIDE HANDLE INCLUDED



- **0.7 HP motor**
- Low weight composite housing reduces weight.
- Patented one-click reverse button provides instant change of direction
- Patented "silencing technology" reduces the noise level to 83 dBA
- Patented grip has been ergonomically designed to perfectly fit the hand-providing unmatched comfort for the user
- **Forward position handle allows operator to apply increased feed force**
- Forward position handle allows more control to start hole, and more control to maintain the drilled hole axis

## 4337 3/8" ANGLE DRILL



- **0.75 HP motor**
- Precision spiral bevel gears increase reliability
- Conveniently positioned forward/reverse knob
- Built-in speed regulator for added control
- Ergonomically designed composite over-mold grip and throttle lever provide unmatched comfort for the user
- Fitted with grease nipple for gear relubrication
- Internal silencing reduces noise level to 75d(B)A
- Rear exhaust direct air away from work area
- Fitted with keyed chuck

## SPECIFICATIONS

Model No.	Free Speed (BPM)	Motor	Spindle Thread Size (in.)	Chuck Size (in)	Gears	Weight (lbs.)	Length (in)	Air Cons. (CFM)	Rec. Hose Size (in.)	Air Inlet (in.) NPT/BSP
4439	2,400	0.7	3/8 x 24	3/8	Caged Planetary	3.17	7.4	9	3/8	1/4
4451	400	0.7	3/8 x 24	1/2	Caged Planetary	4.12	9.27	9	3/8	1/4
4337	1,600	.75	3/8	3/8	Spiral Bevel	2.4	8.3	6	3/8	1/4

# 5100-A-T COMPOSITE AIR HAMMER



5100-A

- 3,000 Blows per minute for fast cutting action
- High performance and low weight
- Multi-patented muffler/exhaust system gives this tool and extremely low noise of 88 dBA and vibration level of 4.2 m/sec<sup>2</sup>
- High quality safety-lock retainer for ease of chisel change and added safety
- Model 5100-A Includes: Blow Mold Kit, 5 Pc. Chisel Set and Quick Change Retainer

# 5200-A-T COMPOSITE LONG STROKE AIR HAMMER



- 2100 blows/minute provide hard hitting cutting action
- 3-3/4" Piston Stroke
- Vibration damped technology reduces the vibration level to 4.2 m/sec<sup>2</sup>
- Patented AIRCAT design double injection composite grip has been ergonomically designed to provide unmatched comfort for the user
- Patented AIRCAT silencing technology
- Heavy duty ball-lock quick change chisel retainer adds safety and reliability

# 5300-A-T SUPER DUTY 0.498" SHANK AIR HAMMER



5300-A

- 0.498" Shank opening
- 1760 Blows / minute
- Heavy duty "Quick Change Chisel Retainer" prevents chisels by-passing conventional spring retainers
- Patented AIRCAT ergonomically designed grip provides unmatched comfort for the user
- Designed for ultra heavy duty and for driving out shackle and king-pins and cutting large bolts, nuts and fasteners
- Model 5300-A Includes: 4 Pc. Chisel Set

## SPECIFICATIONS

Model No.	Free Speed (BPM)	Pistol Stroke	Shank Opening	Retainer	Valve	Weight (lbs.)	Length (in)	Air Cons. (CFM)	Rec. Hose Size (in.)	Air Inlet (in.) NPT/BSP
5100-A-T	3,000	2-5/8	.401"	Safety-lock	Plate	3.3	7.6	6	3/8	1/4
5200-A-T	2,100	3-3/4	.401"	Safety-lock	Plate	4.4	11.0	6	3/8	1/4
5300-A-T	1,760	2-11/16	.498"	Quick Change	Plate	4.6	8.94	6	3/8	1/4



## 6700 SERIES Low Vibration "Lube Free" Orbital and Geared Sanders

AIRCAT has developed a series of "lubrication free" sanders that incorporate the latest engineering concepts, advanced materials and patented designs. The AIRCAT technology reduces weight, noise & vibration, while extending the tool life. The AIRCAT "smooth design throttle lever" and the "ergonomic grip" featured in orbital sanders provide unmatched operating comfort.

- A choice of fifteen models 3/32" and 3/16" orbit options
- Non vacuum, central vacuum and self vacuum options
- 1", 3", 5" 6", and 8" "hook & loop" pad options
- Only 1.6 CFM average air consumption and 6.2 CFM continuous running under load
- Advanced silencing technology reduces noise levels to 75-78 d(B)A
- Patented double sealed, lubrication free motor prevents dust contamination of the air motor and eliminates the need for oiling
- Orbital sanders feature the AIRCAT "smooth design" throttle lever and "ergonomic grip" providing unmatched comfort
- Patented "anti vibration" motor reduces vibration level to 0.8 m/sec<sup>2</sup>
- Low weight: Orbital sanders 2.0 lbs. and geared sanders 3.4 lbs.
- Low profile: Orbital sanders 4.3" high and geared sanders 4.5"

## SPECIFICATIONS

Model No.	Description	Pad Size (in)	Orbit (in)	Pad Type	No. Vacuum Pad Holes	Free Speed (RPM)
6700-1-332	Non Vac Nib Palm Sander	1	3/32	Hook & Loop	0	8,000
6700-5-336	Non Vac Orbital Palm Sander	5	3/16	Hook & Loop	0	11,000
6700-6-336	Non Vac Orbital Palm Sander	6	3/16	Hook & Loop	0	11,000
6700-6-332	Non Vac Orbital Palm Sander	6	3/32	Hook & Loop	0	11,000
6700-5-336CV	Central Vac Orbital Palm Sander	5	3/16	Hook & Loop	6	11,000
6700-6-336CV	Central Vac Orbital Palm Sander	6	3/16	Hook & Loop	6	11,000
6700-6-332CV	Central Vac Orbital Palm Sander	6	3/32	Hook & Loop	6	11,000
6700-6-336SV	Self Vac Orbital Palm Sander	6	3/16	Hook & Loop	6	11,000
6700-6-332SV	Self Vac Orbital Palm Sander	6	3/32	Hook & Loop	6	11,000
6700-3-336	Non Vac Orbital Palm Sander/Polisher	3	3/16	Hook & Loop	6	11,000
6700-3-336CV	Central Vac Orbital Palm Sander/Polisher	3	3/16	Hook & Loop	6	11,000
6700-8GCV	Central Vac Geared Planetary Motion Sander	8	3/16	Hook & Loop	8	900
6700-8G	Non Vac Geared Planetary Motion Sander	8	3/16	Hook & Loop	0	900
6700-6GCV	Central Vac Geared Planetary Motion Sander	6	3/16	Hook & Loop	6	900
6700-6G	Non Vac Geared Planetary Motion Sander	6	3/16	Hook & Loop	0	900

# 6700 SERIES LOW VIBRATION "LUBE FREE" ORBITAL & GEARED SANDERS



6700-8G  
6700-8GCV



6700-6G  
6700-6GCV



6700-5-336  
6700-6-336



6700-5-336CV  
6700-6-336CV



6700-1-332



6700-3-336  
6700-3-336CV



6700-6-332  
6700-6-332CV

Weight (lbs)	Length w/Pad Fitted (in)	Width w/Pad Fitted (in)	Height w/Pad Fitted (in)	Noise Level d(B)A	Vibration m/sec2	Average Air Cons. (CFM)	Air Inlet NPT/BSP (in.)
1.7	6.7	3.0	4.3	75	0.8	1.6	1/4
2.0	6.7	5.0	4.3	75	0.8	1.6	1/4
2.0	6.8	6.0	4.3	75	0.8	1.6	1/4
2.0	6.8	6.0	4.3	75	0.8	1.6	1/4
2.0	8.4	5.0	4.3	75	0.8	1.6	1/4
2.0	8.4	6.0	4.3	75	0.8	1.6	1/4
2.0	8.4	6.0	4.3	75	0.8	1.6	1/4
2.0	8.1	6.0	4.3	75	0.8	1.6	1/4
2.0	8.1	6.0	4.3	75	0.8	1.6	1/4
1.8	5.5	3.0	4.3	75	0.8	1.6	1/4
1.8	7.2	3.0	4.3	75	0.8	1.6	1/4
3.5	12.0	8.0	4.5	78	2.5	3.0	1/4
3.5	11.2	8.0	4.5	78	2.5	3.0	1/4
3.4	11.0	6.0	4.5	78	2.5	3.0	1/4
3.4	10.2	6.0	4.5	78	2.5	3.0	1/4

# 6310 6" DUAL ACTION SANDER



- 10,000 RPM
- 3/16" (2.5 mm) Orbit
- Low weight (2.3 lbs) and low air consumption (2.5 CFM average)
- Lubrication free air motor with patented double sealing to prevent dust contamination
- Isolated motor design reduces vibration to 1.8 m/sec<sup>2</sup>
- Internal silencing system reduces noise level to 82 dBA
- Built-in thumb operated speed regulator for instant control
- Rubberized comfort palm grip
- Low profile only 3-3/4" high

# 6525-ABS 1/4" x 18" Belt Sander



- 20,000 RPM
- 0.6 HP Motor provides non-stall operation
- **360° Rotational guard and belt**
- **Side assist handle provides added control and reduces fatigue**
- Ergonomically designed composite grip provides unmatched comfort
- The rear exhaust allows exhaust air to be directed as preferred
- Manufactured from high grade material and precision parts designed for industrial and heavy duty automotive use
- Shipped complete with 1 pc each 40, 60, 80 and 150 grit sanding belts
- The following additional contact arms are readily available

Part No.	Description
96V6201	1/8" X 18" Contact Arm
96X6201	1/4" X 18" Contact Arm
96W6201	1/2" X 18" Contact Arm
96U6201	3/4" X 18" Contact Arm
96S6201	1" X 18" Contact Arm

## SPECIFICATIONS

Model No.	Free Speed (RPM)	Pad /Belt Size (in.)	Spindle Thread (in.)	Gears	Exhaust	Orbit Off-set (in.)	Weight (lbs.)	Length (in)	Air Cons. (CFM)	Rec. Hose Size (in.)	Air Inlet (in.) NPT/BSP
6310	10,000	6	5/16 - 24	Direct Drive	Rear	3/16	2.25	10.5	2.5	3/8	1/4
6525-ABS	20,000	1/4 x 18	N/A	Direct Drive	Rear	N/A	2.6	15.4	6	3/8	1/4



# 6700-DCE SERIES ELECTRIC PALM SANDER / POLISHER

**Ideal for for mobile body repair technicians, boat builders/repairers and furniture/wood product manufacturing processes.**

- **FLEXIBLE:** The three “push button” speed settings of 10,000, 7,000 & 4,000 RPM, allows for sanding, compounding and polishing.
- **VERY QUIET:** 70 d(B)A noise level.
- **COMFORTABLE:** 0.5m/sec<sup>2</sup> vibration level.
- **CLEAN:** No exhaust air, no air borne oil, no blowing of dust and particles.
- **SAFE:** The DC current renders the tool shock hazard free and totally safe to use, the 20’ low voltage DC cable allows use around vehicles and in industrial fabrication and assembly areas.
- **EASE OF INSTALLATION:** Hook-up and installation is easy and flexible to relocate to any location where there is an AC power point; simply plug the DC convertor cable into your power supply to get started.
- **INCREASED PRODUCTIVITY:** Air sanders only maintain 60% of their speed under load, while the AIRCAT DC electric sander maintains 85% of its speed under load.
- **ENERGY EFFICIENT:** 80% energy savings compared to running a compressor to power an air sander.
- **COMPLETE PACKAGE:** Comes with either 6", 5" or 3" Hook and loop fastener sanding backing pad, a 4 ply 100% twisted wool 6" polishing bonnet and a 6" foam polishing/compounding pad
- Central vacuum versions available.



6700-DCE-5 / 6 SERIES



6700-DCE-3 SERIES

## SPECIFICATIONS

Model No.	Speed Settings (RPM)	Spindle Thread (in)	Pad Size (in)	Orbit (in)	Weight (lbs.)	Length (in)	Noise Level	Vibration Level	Cable Length (ft)
6700-DCE-6	10,000 - 7,000 - 4,000	5/16 x 24	6	3/16	1.98	7.0	70 dBa	0.5 m/sec <sup>2</sup>	20
6700-DCE-6V	10,000 - 7,000 - 4,000	5/16 x 24	6	3/16	1.98	7.0	70 dBa	0.5 m/sec <sup>2</sup>	20
6700-DCE-5	10,000 - 7,000 - 4,000	5/16 x 24	5	3/16	1.98	8.9	70 dBa	0.5 m/sec <sup>2</sup>	20
6700-DCE-5V	10,000 - 7,000 - 4,000	5/16 x 24	5	3/16	1.98	8.9	70 dBa	0.5 m/sec <sup>2</sup>	20
6700-DCE-3	10,000 - 7,000 - 4,000	5/16 x 24	3	3/16	1.98	8.9	70 dBa	0.5 m/sec <sup>2</sup>	20
6700-DCE-3V	10,000 - 7,000 - 4,000	5/16 x 24	3	3/16	1.98	8.9	70 dBa	0.5 m/sec <sup>2</sup>	20

# 6320 SPOT SANDER AND POLISHER



- Features internal 1/8" orbital head for ultra-fine sanding and polishing
- The combined spindle-counter balance reduces vibration levels to 1.8 m/sec<sup>2</sup> and adds reliability
- Precision alloy steel spiral-bevel gears extend tool life
- Lamb wool and sponge polishing bonnets/pads are also available separately
- The internal silencing system reduces noise levels to 78 dBA
- Supplied complete with Hook and loop fastener 1.25" and 2" round and a triangular pad Sanding discs for all three pads types are available separately in 120/180/320/600/1000/1500 grit sizes, sanding discs are packed as 10 pc. of each grit size

# 6370 LOW WEIGHT COMPOSITE VERTICAL POLISHER



- 3,500 RPM
- Stall resistant 0.6 HP motor
- Very low weight only 2.5 lbs.
- Very low air consumption only 12.0 CFM
- Incorporates internal spindle thread for fitting of upholstery cleaning brushes
- Comes complete with 7" Lambs wool polishing bonnet
- The composite housing and handles have been ergonomically designed to provide unmatched comfort for the user

## SPECIFICATIONS

Model No.	Free Speed (RPM)	Pad / Bonnet Size (in.)	Spindle Thread (in.)	Orbit Off-set (in.)	Weight (lbs.)	Length (in)	Air Cons. (CFM)	Rec. Hose Size (in.)	Air Inlet (in.) NPT/BSP
6320	13,000	1 x 2	1/4	1/8	1.1	6.1	2.5	3/8	1/4
6370	3,500	7	5/8" -11	N/A	2.5	6.75	12.0	3/8	1/4

# 6330 HIGH PERFORMANCE NIBBLER



- 2,500 stroke/minute motor provides fast cutting action in steel up to 18 gauge
- The 6350 has the smallest cut radius of any nibbler at only 3/16" allowing clean cuts in tight corners
- The "over sized" anvil and punch dramatically increase reliability of these high wear parts
- The 6350 comes complete with an additional punch
- Composite handle and throttle lever design provide comfortable and convenient operation
- The rotational rear exhaust muffler allows exhaust air to be directed as preferred
- The 6330 precision engineered components make the tool suitable for high volume

# 6350 LOW VIBRATION SAW



- 9,500 stroke/minute motor provides very fast cutting action
- The internal damping system reduces the vibration level to 2.5m/sec<sup>2</sup>
- Comes complete with 18, 24 and 32 teeth power saw blades
- The metal blade retainer increases reliability
- The rotational rear exhaust muffler allows exhaust air to be directed as preferred
- The 6350 has a short overall length of only 8" and low a weight of only 1.13 lbs. providing good work area access and comfortable operation

Model No.	Free Speed (RPM)	Motor (HP)	Cutting Capacity	Exhaust	Weight (lbs.)	Length (in)	Air Cons. (CFM)	Rec. Hose Size (in.)	Air Inlet (in.) NPT/BSP
6330	2,600	0.06	8 Gauge	Rear	2.25	7.0	3.5	3/8	1/4
6350	9,500	0.5	3/16" Steel Plate - 18 Gauge	Rear	1.13	8.0	4	3/8	1/4



# 6400 COMPOSITE HIGH SPEED TIRE BUFFER/DRILL



- 22,000 RPM
- Stall resistant 0.75 HP motor
- Built-in regulator for added control on the job
- Convenient and comfortable throttle lever design
- Ergonomic molded handle grip adds comfort and insulation in cold weather
- Complete with coaxial rear hose assembly to eliminate blowing of rubber particles/dust in the work area
- Short overall tool length of only 8" improves access in work area
- Low noise level
- Low air consumption
- 3/8" Precision keyed chuck

# 6402 / 6403 COMPOSITE TIRE BUFFER



- 2,600 and 3,600 RPM
- Stall resistant 0.60 HP motor
- Convenient and comfortable throttle lever design
- Ergonomic molded handle grip adds comfort and insulation in cold weather
- Complete with coaxial rear hose assembly to eliminate blowing of rubber particles/dust in the work area
- Low noise level
- Low air consumption
- 5/16" Hex quick change chuck with threaded arbor for mounting buffing cones and accessories
- Model 6403 is designed for tire re-capping and tire buffing

## SPECIFICATIONS

Model No.	Free Speed (RPM)	Chuck Size (in.)	Spindle Thread Size (in.)	Weight (lbs.)	Length (in)	Air Cons. (CFM)	Rec. Hose Size (in.)	Air Inlet (in.) NPT/BSP
6400	22,000	3/8	3/8 x 24	1.66	8.0	4.1	3/8	1/4
6402	2,600	5/16" Internal Hex	N/A	1.75	9.0	3.5	3/8	1/4
6403	3,600	5/16" Internal Hex	N/A	1.75	9.0	3.5	3/8	1/4

# 100-C MECHANICS CREEPER



- Rugged ergonomic plastic design
- 3 inch Casters
- Low profile design
- Oil, grease and dirt resistant

# 800-C 45" ADJUSTABLE MECHANICS CREEPER W/LIGHT



- Adjustable headrest
- Built-in LED inspection light
- Padded cushion for comfort
- Steel frame fabrication
- 3 inch Heavy duty casters
- Oil, grease and dirt resistant



Model No.	Height	Dimensions	Max Load
100-C	3.6"	40.6" x 19.7" x 3.6"	350 lbs.
800-C	6.5"	45" x 23" x 6.5"	400 lbs.

# IMPACT BOOTS



**1200-KBR**  
**Red Flame NITROCAT® Boot**  
 Fits Models: 1200-K



**1355-XLBR**  
**Red Flame NITROCAT® Boot**  
 Fits Models: 1355-XL and 1375-XL



**1056-BB**  
**Black Aircat® Boot**  
 Fits Models: 1056-XL and 1076-XL



**1150-BB**  
**Sleek Black Aircat® Boot**  
 Fits Models: 1150, 1000, 1000-TH and 1000-TH-2



**1600-THBB**  
**Sleek Black Aircat® Boot**  
 Fits Models: 1600-TH, and 1600-TH-A



**1300-THBB**  
**Black Aircat® Boot**  
 Fits Model: 1300-TH

# ACCESSORIES



**300-C**  
**AIRCAT® Magnetic Mat**



**500-C**  
**AIRCAT® Tool Bag**



## Male & Female Safety Couplers

- |            |   |
|------------|---|
| 600-C-25F  | 1/4" NPT Female Coupler with Male & Female Fittings |
| 600-C-25M  | 1/4" NPT Male Coupler with Male & Female Fittings   |
| 600-C-375F | 3/8" NPT Female Coupler with Male & Female Fittings |
| 600-C-375M | 3/8" NPT Male Coupler with Male & Female Fittings   |



## Use of Accessories with Air Tools

When selecting the correct accessory to use with your air tool(s) the following points must be carefully checked:

- The accessory is rated to run at or above the maximum rated speed of the air tool that you plan to use it on.
- Air tool Manufacturers specify these speeds in their catalogs and operator instructions.
- Accessories used on abrasive tools, impact wrenches, nut runners, ratchets, air hammers and scaling hammers must be rated for use with the relevant air tool.
- Any accessory used should be of the correct size and design for the air tool(s) that you plan to use it with.
- Worn accessories should not be used and accessories should not be modified in any way.
- Mounting and fitting instruction for any accessory to be used on an air tool must be carefully followed at all times.
- Use of worn or incorrect accessories may reduce tool performance, create excessive tool wear and can be hazardous
- Always disconnect the tool from the air supply when changing of fitting accessories, guards or other fittings.

## Operator Training for Air Tool; Air Tool Accessory and Compressed Air Use

- All operators should be trained in the correct installation and use of the air tool/s that they are required to operate.
- All operators should be trained to understand the safety instructions provided by the air tool manufacturer, for each Air tool that they are required to operate.
- All operators should be trained in the safe use of compressed air and the use of associated air hoses, connectors and air tool accessories.
- All operators should be trained to operate an air tool and accessories safely and correctly on the application that you plan to use them for.
- Operators or service personnel should be trained to ensure that the air installation, lubricators, filters, regulators, hoses and air nipples and connectors are checked regularly to ensure that they meet the requirements set on a continuous basis.

## Air Supply

Tools of this class operate on a wide range of air pressure. It is recommended that air pressure of these tools measures 90 PSI at the tool while running free. Higher pressure and unclean air will shorten the tool's life because of faster wear and may create a hazardous condition and void the warranty. Water in the air line will cause damage to the tool. Drain the air tank daily. Clean the air inlet filter screen on at least a weekly schedule.

The recommended hookup procedure can be viewed in the illustration below. The air inlet used for connecting air supply has standard 1/4" NPT for smaller tools and 3/8" NPT for larger tools as specified in the tool manual. Line pressure should be increased to compensate for unusually long air hoses (over 25 feet). Minimum hose diameter should be 3/8" I.D. for smaller tools and 1/2" for larger tools as specified in the tool manual.

